

**Blossom Street Parking Garage East Steel Stair Replacement
Project Number FP00000215**

Addendum Number Three

Date: January 11, 2019

From: Aimee B. Rish
Procurement Specialist

To: All Bidders

The following items add to, modify, clarify, or otherwise alter the Drawings and/or specifications and will become a part of the Contract Documents. Where a portion of the Drawings and/or specifications is added to, modified, clarified, or otherwise altered, the portion not so affected shall remain. Bidder shall include all effects that these items may have on his proposal.

Acknowledge receipt of this addendum in the space provided on the Bid Form. Failure to do so may subject a Bidder to disqualification.

Change of Bid Closing:

1. The closing for this project has been rescheduled to Thursday, January 17, 2019 at 3PM.
2. The revised attached SE330 Lump Sum Bid Form is attached. This form must be used when submitting a bid for this project.
3. The drawings for this project have also been revised. Please see the attached revision.

**Attachment: Revised SE330 Lump Sum Bid Form
Revised Drawings**

END OF ADDENDUM NUMBER THREE

**SE-330
LUMP SUM BID FORM**

**Revised
Addendum #3**

Bidders shall submit bids on only Bid Form SE-330.

BID SUBMITTED BY: _____
(Bidder's Name)

BID SUBMITTED TO: University of South Carolina
(Owner's Name)

FOR: PROJECT NAME: Blossom Street Parking Garage East Stair Replacement
PROJECT NUMBER: FP00000215

OFFER

§ 1. In response to the Invitation for Construction Services and in compliance with the Instructions to Bidders for the above-named Project, the undersigned Bidder proposes and agrees, if this Bid is accepted, to enter into a Contract with the Owner on the terms included in the Bidding Documents, and to perform all Work as specified or indicated in the Bidding Documents, for the prices and within the time frames indicated in this Bid and in accordance with the other terms and conditions of the Bidding Documents.

§ 2. Pursuant to SC Code § 11-35-3030(1), Bidder has submitted Bid Security as follows in the amount and form required by the Bidding Documents:

- Bid Bond with Power of Attorney** **Electronic Bid Bond** **Cashier's Check**
- (Bidder check one)*

§ 3. Bidder acknowledges the receipt of the following Addenda to the Bidding Documents and has incorporated the effects of said Addenda into this Bid:

(Bidder, check all that apply. Note, there may be more boxes than actual addenda. Do not check boxes that do not apply)

- ADDENDA:** #1 #2 #3 #4 #5

§ 4. Bidder accepts all terms and conditions of the Invitation for Bids, including, without limitation, those dealing with the disposition of Bid Security. Bidder agrees that this Bid, including all Bid Alternates, if any, may not be revoked or withdrawn after the opening of bids, and shall remain open for acceptance for a period of **60** Days following the Bid Date, or for such longer period of time that Bidder may agree to in writing upon request of the Owner.

§ 5. Bidder herewith offers to provide all labor, materials, equipment, tools of trades and labor, accessories, appliances, warranties and guarantees, and to pay all royalties, fees, permits, licenses and applicable taxes necessary to complete the following items of construction work:

§ 6.1 **BASE BID WORK** *(as indicated in the Bidding Documents and generally described as follows):* Steel staircase demolition, fabrication, and installation

\$ _____, which sum is hereafter called the Base Bid.
(Bidder to insert Base Bid Amount on line above)

**SE-330
LUMP SUM BID FORM**

§ 6.2 **BID ALTERNATES** as indicated in the Bidding Documents and generally described as follows:

ALTERNATE # 1 (Brief Description): Retain, clean and paint existing concrete landings. Remove, clean and reinstall existing aluminum railings on new stairs. Railings may be painted at owners discretion.

ADD TO or **DEDUCT FROM BASE BID: \$** _____

(Bidder to mark appropriate box to clearly indicate the price adjustment offered for each Alternate)

ALTERNATE # 2 (Brief Description): N/A

ADD TO or **DEDUCT FROM BASE BID: \$** _____

(Bidder to mark appropriate box to clearly indicate the price adjustment offered for each Alternate)

ALTERNATE # 3 (Brief Description): N/A

ADD TO or **DEDUCT FROM BASE BID: \$** _____

(Bidder to mark appropriate box to clearly indicate the price adjustment offered for each Alternate)

§ 6.3 **UNIT PRICES:**

BIDDER offers for the Agency’s consideration and use, the following **UNIT PRICES**. The **UNIT PRICES** offered by **BIDDER** indicate the amount to be added to or deducted from the **CONTRACT SUM** for each item-unit combination. **UNIT PRICES** include all costs to the Agency, including those for materials, labor, equipment, tools of trades and labor, fees, taxes, insurance, bonding, overhead, profit, etc. The Agency reserves the right to include or not to include any of the following **UNIT PRICES** in the Contract and to negotiate the **UNIT PRICES** with **BIDDER**.

<u>No.</u>	<u>ITEM</u>	<u>UNIT OF MEASURE</u>	<u>ADD</u>	<u>DEDUCT</u>
<u>1.</u>	_____	_____	<u>\$</u> _____	<u>\$</u> _____
<u>2.</u>	_____	_____	<u>\$</u> _____	<u>\$</u> _____
<u>3.</u>	_____	_____	<u>\$</u> _____	<u>\$</u> _____
<u>4.</u>	_____	_____	<u>\$</u> _____	<u>\$</u> _____
<u>5.</u>	_____	_____	<u>\$</u> _____	<u>\$</u> _____
<u>6.</u>	_____	_____	<u>\$</u> _____	<u>\$</u> _____

SE-330
LUMP SUM BID FORM

§ 7. LISTING OF PROPOSED SUBCONTRACTORS PURSUANT TO SECTION 3020(b)(i), CHAPTER 35, TITLE 11 OF THE SOUTH CAROLINA CODE OF LAWS, AS AMENDED
(See Instructions on the following page BF-2A)

Bidder shall use the below-listed Subcontractors in the performance of the Subcontractor Specialty Classification work listed:

(A) SUBCONTRACTOR SPECIALTY <i>(Completed by Owner)</i>	(B) CLASSIFICATION or SUBCLASSIFICATION ABBREVIATION <i>(Completed by Owner)</i>	(C) SUBCONTRACTOR'S or PRIME CONTRACTOR'S NAME <i>(Required - must be completed by Bidder)</i>	(D) SUBCONTRACTOR'S or PRIME CONTRACTOR'S SC LICENSE NUMBER <i>(Requested, but not Required)</i>
BASE BID			
N/A			
ALTERNATE #1			
ALTERNATE #2			
ALTERNATE #3			

If a Bid Alternate is accepted, Subcontractors listed for the Bid Alternate shall be used for the work of both the Alternate and the Base Bid work.

SE-330

LUMP SUM BID FORM

INSTRUCTIONS FOR SUBCONTRACTOR LISTING

1. Section 7 of the Bid Form sets forth an Owner-developed list of contractor/subcontractor specialties by contractor license classification or subclassification for which Bidder is required to identify the entity (subcontractor(s) and/or himself) Bidder will use to perform the work of each listed specialty.
 - a. **Columns A & B:** The Owner fills out these columns to identify the contractor/subcontractor specialty and related license abbreviation for which the Bidder must list either a subcontractor or himself as the entity that will perform this work. In Column A, the subcontractor specialty is identified by name and in Column B, the related contractor license abbreviation (per Title 40 of the SC Code of Laws) is listed. Abbreviations of licenses can be found at: <http://www.llr.state.sc.us/POL/Contractors/PDFFiles/CLBClassificationAbbreviations.pdf> . If the owner has not identified a specialty, the Bidder does not list a subcontractor.
 - b. **Columns C and D:** In these columns, the Bidder identifies the subcontractors it will use for the work of each specialty and license listed by the Owner in columns A & B. Bidder must identify only the subcontractor(s) who will perform the work and no others. Bidders should make sure that their identification of each subcontractor is clear and unambiguous. A listing that could be any number of different entities may be cause for rejection of the bid as non-responsive. For example, a listing of M&M without additional information may be problematic if there are multiple different licensed contractors in South Carolina whose names start with M&M.
2. **Subcontractor Defined:** For purposes of subcontractor listing, a subcontractor is an entity who will perform work or render service to the prime contractor to or about the construction site pursuant to a contract with the prime contractor. Bidder should not identify sub-subcontractors in the spaces provided on the bid form but only those entities with which Bidder will contract directly. Likewise, do not identify material suppliers, manufacturers, and fabricators that will not perform physical work at the site of the project but will only supply materials or equipment to the Bidder or proposed subcontractor(s).
3. **Subcontractor Qualifications:** Bidder must only list subcontractors who possess a South Carolina contractor's license that includes the license classification and/or subclassification identified by the Owner in columns A & B. The subcontractor license must also be within the appropriate license group for the work of the specialty. If Bidder lists a subcontractor who is not qualified to perform the work, the Bidder will be rejected as non-responsive.
4. **Use of Own forces:** If, under the terms of the Bidding Documents and SC Contractor Licensing laws, Bidder is qualified to perform the work of a listed specialty and Bidder does not intend to subcontract such work but to use Bidder's own employees to perform such work, the Bidder must insert its own name in the space provided for that specialty.
5. **Use of Multiple Subcontractors:**
 - a. If Bidder intends to use multiple subcontractors to perform the work of a single specialty listing, Bidder must insert the name of each subcontractor Bidder will use, preferably separating the name of each by the word **"and"**. If Bidder intends to use both his own employees to perform a part of the work of a single specialty listing and to use one or more subcontractors to perform the remaining work for that specialty listing, Bidder must insert his own name and the name of each subcontractor, preferably separating the name of each with the word **"and"**. Bidder must use each entity listed for the work of a single specialty listing in the performance of that work.
 - b. **Optional Listing Prohibited:** Bidder may not list multiple subcontractors for a specialty listing, in a form that provides the Bidder the option, after bid opening or award, to choose one or more but not all the listed subcontractors to perform the work for which they are listed. A listing, which on its face requires subsequent explanation to determine whether it is an optional listing, is non-responsive. If Bidder intends to use multiple entities to perform the work for a single specialty listing, Bidder must clearly set forth on the bid form such intent. Bidder may accomplish this by simply inserting the word **"and"** between the names of each entity listed for that specialty. Agency will reject as non-responsive a listing that contains the names of multiple subcontractors separated by a blank space, the word **"or"**, a virgule (that is a /), or any separator that the Agency may reasonably interpret as an optional listing.
6. If Bidder is awarded the contract, Bidder must, except with the approval of the Agency for good cause shown, use the listed entities to perform the work for which they are listed.
7. If Bidder is awarded the contract, Bidder will not be allowed to substitute another entity as subcontractor in place of a subcontractor listed in Section 7 of the Bid except for one or more of the reasons allowed by the SC Code of Laws.
8. Bidder's failure to identify an entity (subcontractor or himself) to perform the work of a subcontractor specialty listed in columns A & B will render the Bid non-responsive.

SE-330 LUMP SUM BID FORM

§ 8. LIST OF MANUFACTURERS, MATERIAL SUPPLIERS, AND SUBCONTRACTORS OTHER THAN SUBCONTRACTORS LISTED IN SECTION 7 ABOVE (*FOR INFORMATION ONLY*):

Pursuant to instructions in the Invitation for Construction Services, if any, Bidder will provide to Owner upon the Owner's request and within 24 hours of such request, a listing of manufacturers, material suppliers, and subcontractors, other than those listed in Section 7 above, that Bidder intends to use on the project. Bidder acknowledges and agrees that this list is provided for purposes of determining responsibility and not pursuant to the subcontractor listing requirements of SC Code § 11-35-3020(b)(i).

§ 9. TIME OF CONTRACT PERFORMANCE AND LIQUIDATED DAMAGES

a) CONTRACT TIME

Bidder agrees that the Date of Commencement of the Work shall be established in a Notice to Proceed to be issued by the Owner. Bidder agrees to substantially complete the Work within 150 Calendar Days from the Date of Commencement, subject to adjustments as provided in the Contract Documents.

b) LIQUIDATED DAMAGES

Bidder further agrees that from the compensation to be paid, the Owner shall retain as Liquidated Damages the amount of \$ 250.00 for each Calendar Day the actual construction time required to achieve Substantial Completion exceeds the specified or adjusted time for Substantial Completion as provided in the Contract Documents. This amount is intended by the parties as the predetermined measure of compensation for actual damages, not as a penalty for nonperformance.

§ 10. AGREEMENTS

- a) Bidder agrees that this bid is subject to the requirements of the laws of the State of South Carolina.
- b) Bidder agrees that at any time prior to the issuance of the Notice to Proceed for this Project, this Project may be canceled for the convenience of, and without cost to, the State.
- c) Bidder agrees that neither the State of South Carolina nor any of its agencies, employees or agents shall be responsible for any bid preparation costs, or any costs or charges of any type, should all bids be rejected or the Project canceled for any reason prior to the issuance of the Notice to Proceed.

§ 11. ELECTRONIC BID BOND

By signing below, the Principal is affirming that the identified electronic bid bond has been executed and that the Principal and Surety are firmly bound unto the State of South Carolina under the terms and conditions of the AIA Document A310, Bid Bond, included in the Bidding Documents.

ELECTRONIC BID BOND NUMBER: _____

SIGNATURE AND TITLE: _____

**SE-330
LUMP SUM BID FORM**

CONTRACTOR'S CLASSIFICATIONS AND SUBCLASSIFICATIONS WITH LIMITATION

SC Contractor's License Number(s): _____

Classification(s) & Limits: _____

Subclassification(s) & Limits: _____

By signing this Bid, the person signing reaffirms all representation and certification made by both the person signing and the Bidder, including without limitation, those appearing in Article 2 of the SCOSE Version of the AIA A701, Instructions to Bidders, is expressly incorporated by reference.

BIDDER'S LEGAL NAME: _____

ADDRESS: _____

TELEPHONE: _____

EMAIL: _____

SIGNATURE: _____ **DATE:** _____

PRINT NAME: _____

TITLE: _____

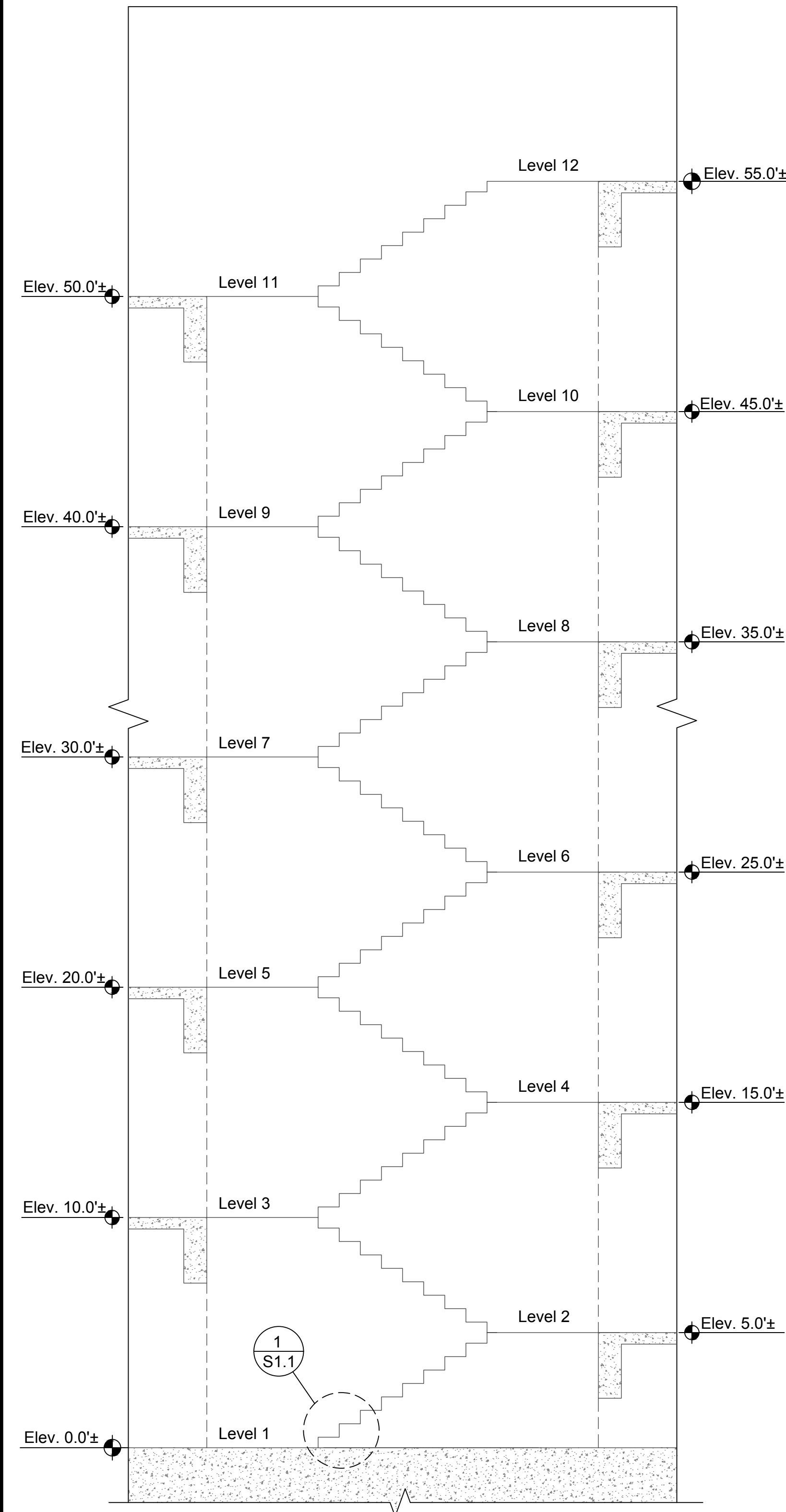

Stair Replacement Elevation

Scale: 1/4" = 1'-0"

General Notes:

- Design Specifications: International Building Code (2012 Edition).
Design Loads:
Dead load: Actual
Stair Live Load: 100 PSF
Risk Category: II
Exposure Category: B
- The construction falsework / shoring design (if any) is the responsibility of the Contractor. The design shall be performed by a Registered Engineer and shall be submitted for approval before commencing of the work.
- Where a detail is shown on Structural drawings for one condition, it shall apply to all similar or like conditions, unless noted or shown otherwise on plans.
- All items shall be tightly anchored or attached square, plumb, and true, or in other planes and shapes as shown on the drawings. Joints shall be tight, even, and free of offsets. No field altering of any members will be allowed that will cause them not to be in accordance with the drawings and specifications, without written approval of the Project Engineer.
- The dimensions shown with a suffix "±" are approximate and shall be verified by the Contractor before fabrication.
- If the Contractor finds a difference between these drawings & existing conditions, or finds any other conditions which prohibit execution of the work as directed in these drawings, the Contractor shall notify the Engineer immediately.
- Any revision/modification to the original design during the shop drawing process, the Contractor shall clearly cloud line all the changes and shall receive approval from the Engineer in writing before fabrication. Any costs associated with correcting the unapproved change shall be at the Contractor's expense.
- All products used are recommended. Any other product to be used must be equal and approved by the Engineer.
- All observed corrosion be thoroughly cleaned and the steel repainted.
- Required measures shall be taken to allow a safe work and public environment in and near the construction site.

Structural and Miscellaneous Steel Notes

- All structural and miscellaneous steel shall conform to the Fourteenth Edition of the AISC "Specification for Structural Steel Buildings" and all its supplements, and to the AISC "Code of Standard Practice for Steel Buildings and Bridges".
- All structural steel shall conform to ASTM A-36, FY=36,000 PSI unless otherwise noted.
- All welded connections shall be done with E70XX electrodes with 3/16" min. material. All welding shall comply with AWS D1-1 structural welding code the latest edition.
- All bolts shall be Group A (A325), unless otherwise noted.
- The structural steel shall have one coat of finish paint of color determined by the owner. Prior to painting, all steel surfaces shall be prepared in accordance with SSPC-SP3. The finish paint used shall be compatible for applying over hot dipped galvanized coating. For duplex coatings (galvanized + painted) the steel shall be unquenched (or ASTM approved method). All paints shall be approved by the Owner/Architect prior to their use.
- Fabrication and assembly of bolted connections shall comply with applicable sections of AISC "Specification for Structural Joints using ASTM A325 or A490 bolts."
- No openings in beams shall be permitted without the written permission of the engineer.
- The use of a gas-cutting torch in the field for cutting holes or for correcting fabrication errors will not be permitted on structural framing members except w/ the written approval of the Engineer for each specification.
- An independent inspection agency shall be employed by the owner and approved by the engineer to inspect the structural steel in the field and verify that it conforms to the requirements of the contract documents.
- All structural steel shall be hot-dipped galvanized according to ASTM 123. All connections, hardware shall be hot-dipped galvanized according to ASTM 153. All galvanizing damaged by welding shall be repaired by Z.R.C. cold galvanizing paint.

Steel Stairs:

- All stair framing shall be designed by the stair manufacturer to support all dead loads plus a minimum live loading of 100 PSF.
- Provide steel hangers, clip angles, etc. as required to support stair framing from the structure.
- Shop drawings for all stairs shall be sealed by a Professional Engineer registered in the State of South Carolina and shall state that all stair components have been designed to the specified loadings and comply with the International Building Code 2012.

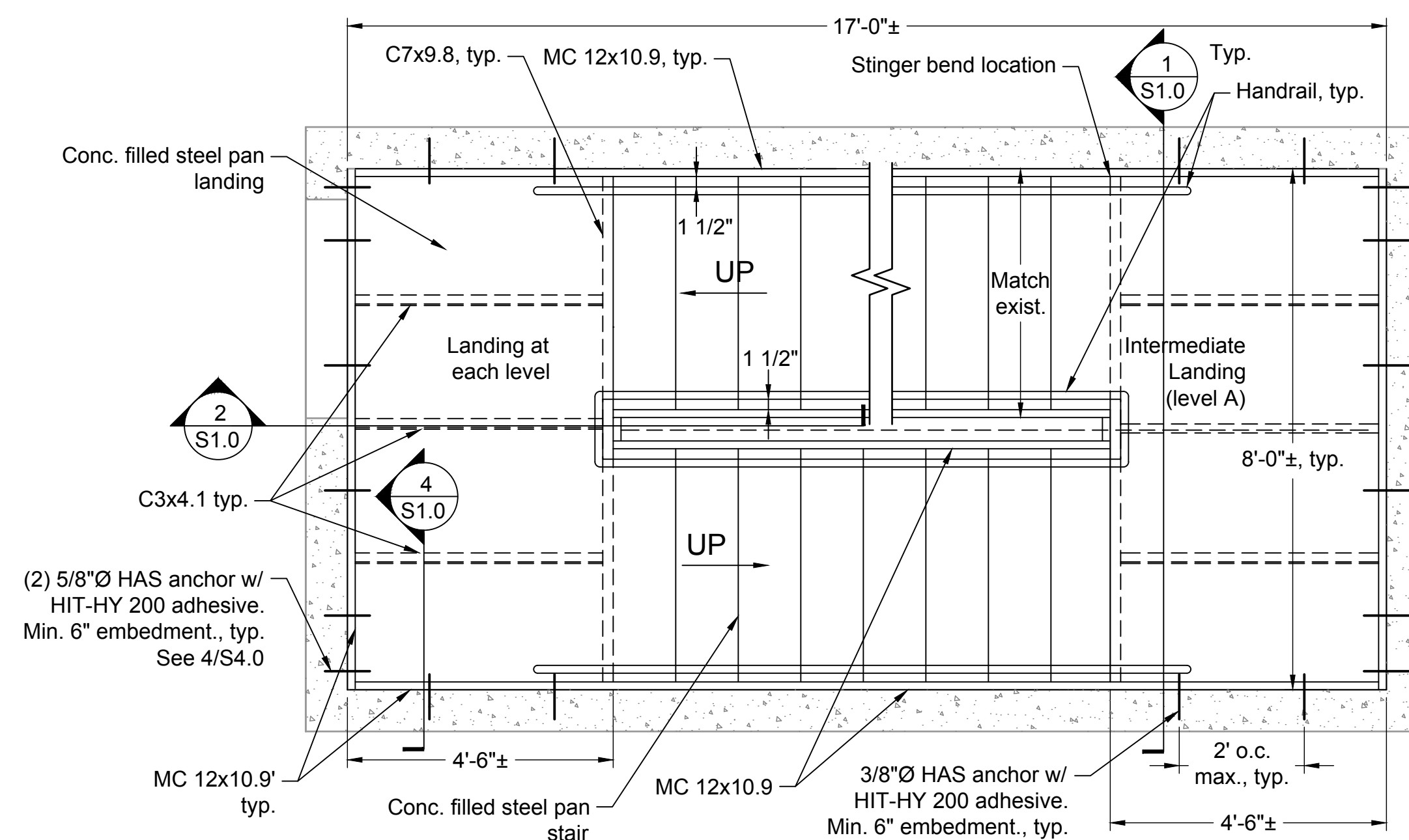

3 - Stair Replacement Plan - Levels 1-12

Scale: 1/2" = 1'-0"

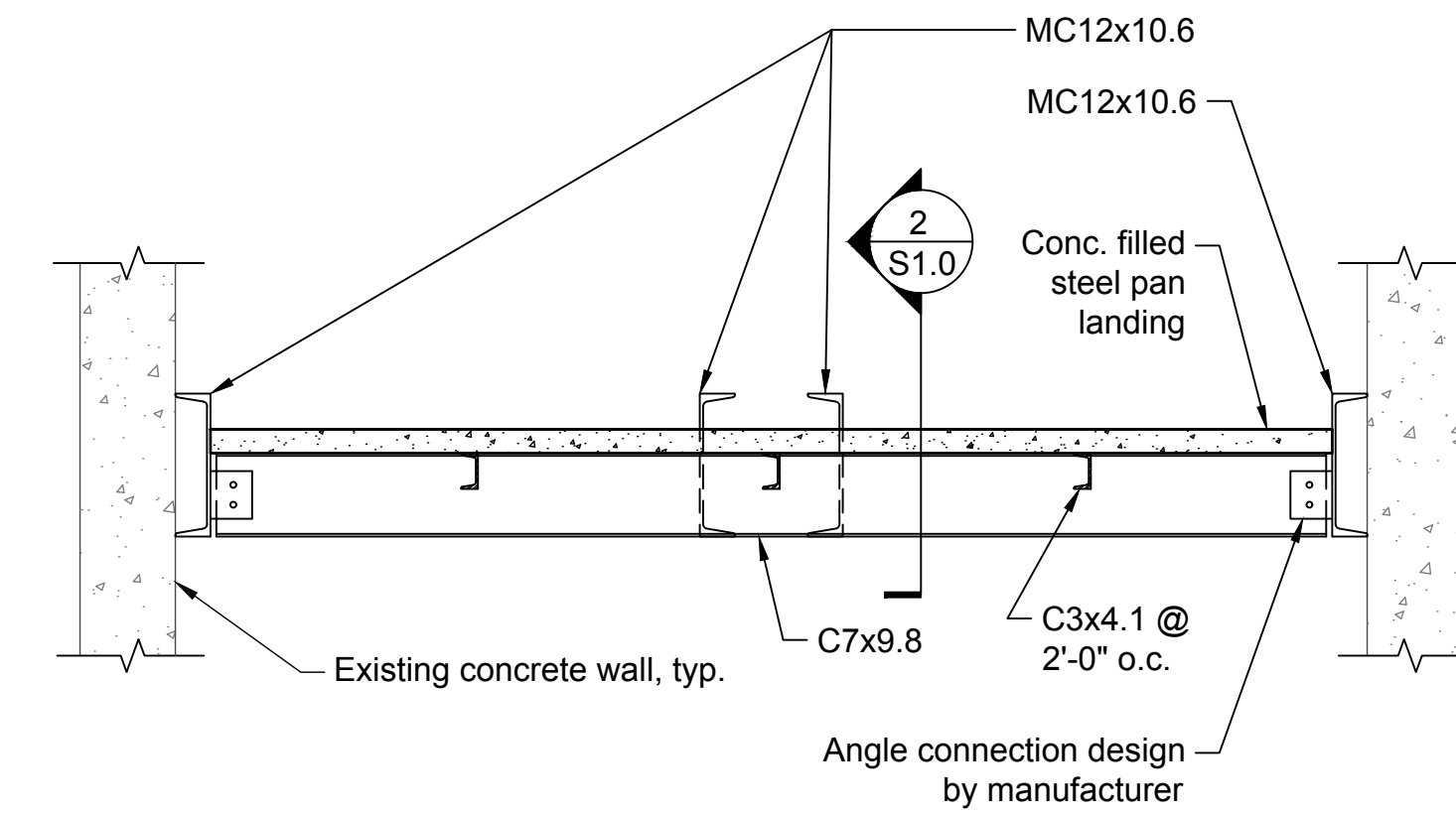

1 - Section

Scale: 3/4" = 1'-0"

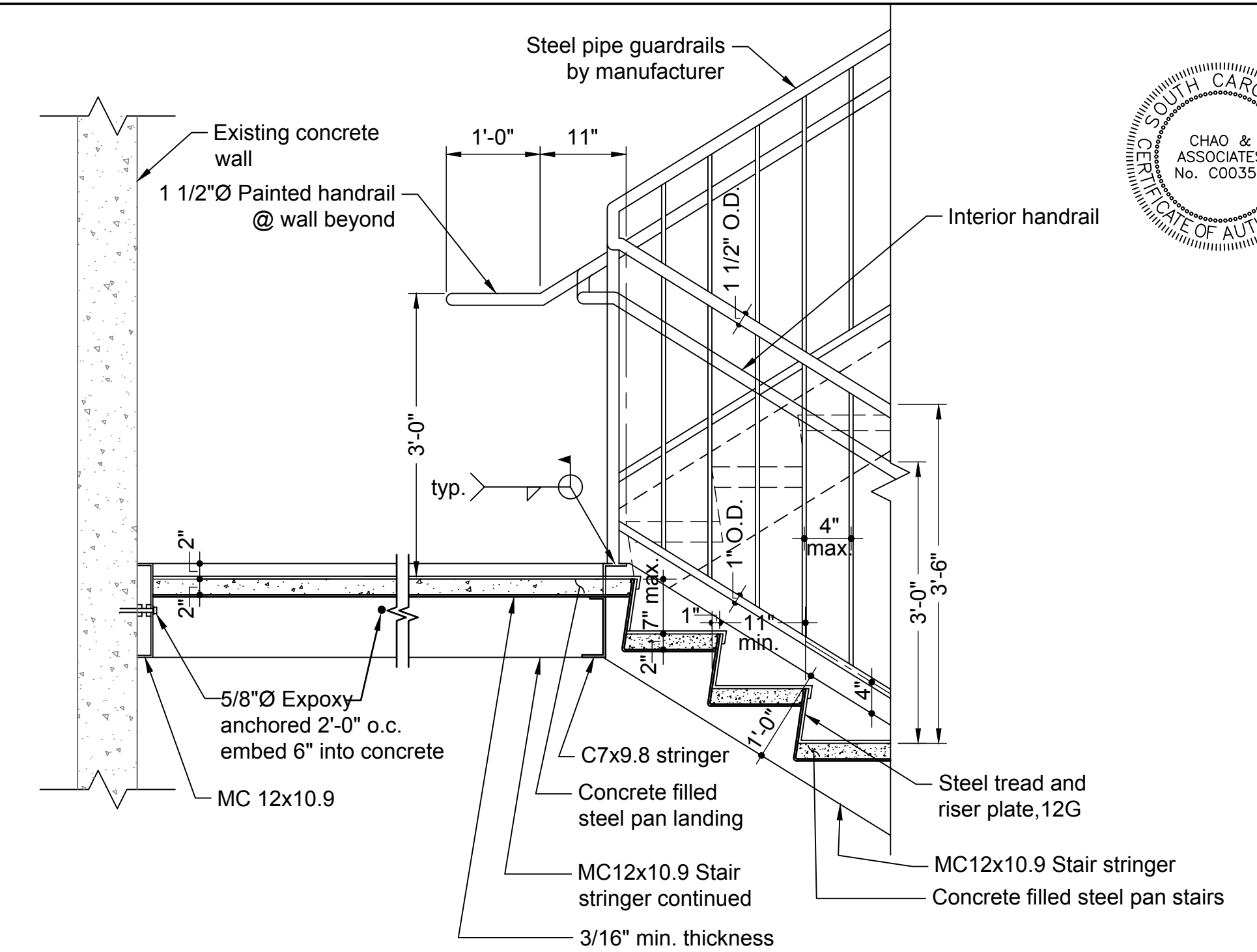

2 - Section

Scale: 3/4" = 1'-0"

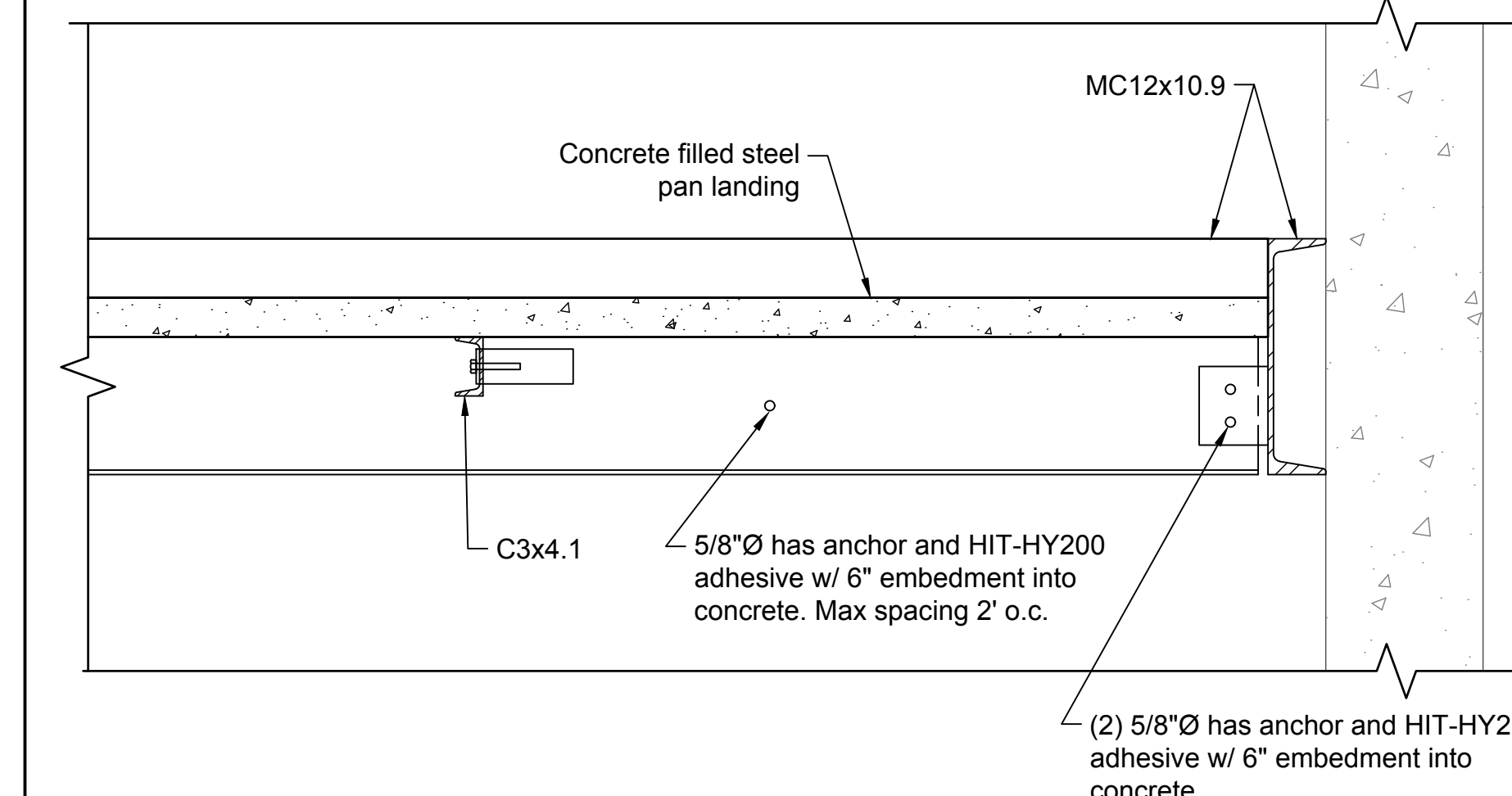

4 - Section

Scale: 1 1/2" = 1'-0"

Drawing file: 393202D-18S-ST.dwg, Plotfile: Jan 10, 2019 - 10:23am



Chao & Associates, Inc.
Civil - Structural - Survey
7 Clusters Court
Columbia, SC 29210
Voice: (803) 772-8420
Fax: (803) 772-9120
Email: consult@chaoinc.com



Replace General Notes, Plan and Elevation
Blossom Garage East Stair Replacement
Prepared For:
University of South Carolina, Columbia, SC

Drawn: LPL
Checked: JWH
Revised:
Project No.: 393239E

S1.0

Sheet Number
November 09, 2018
Date

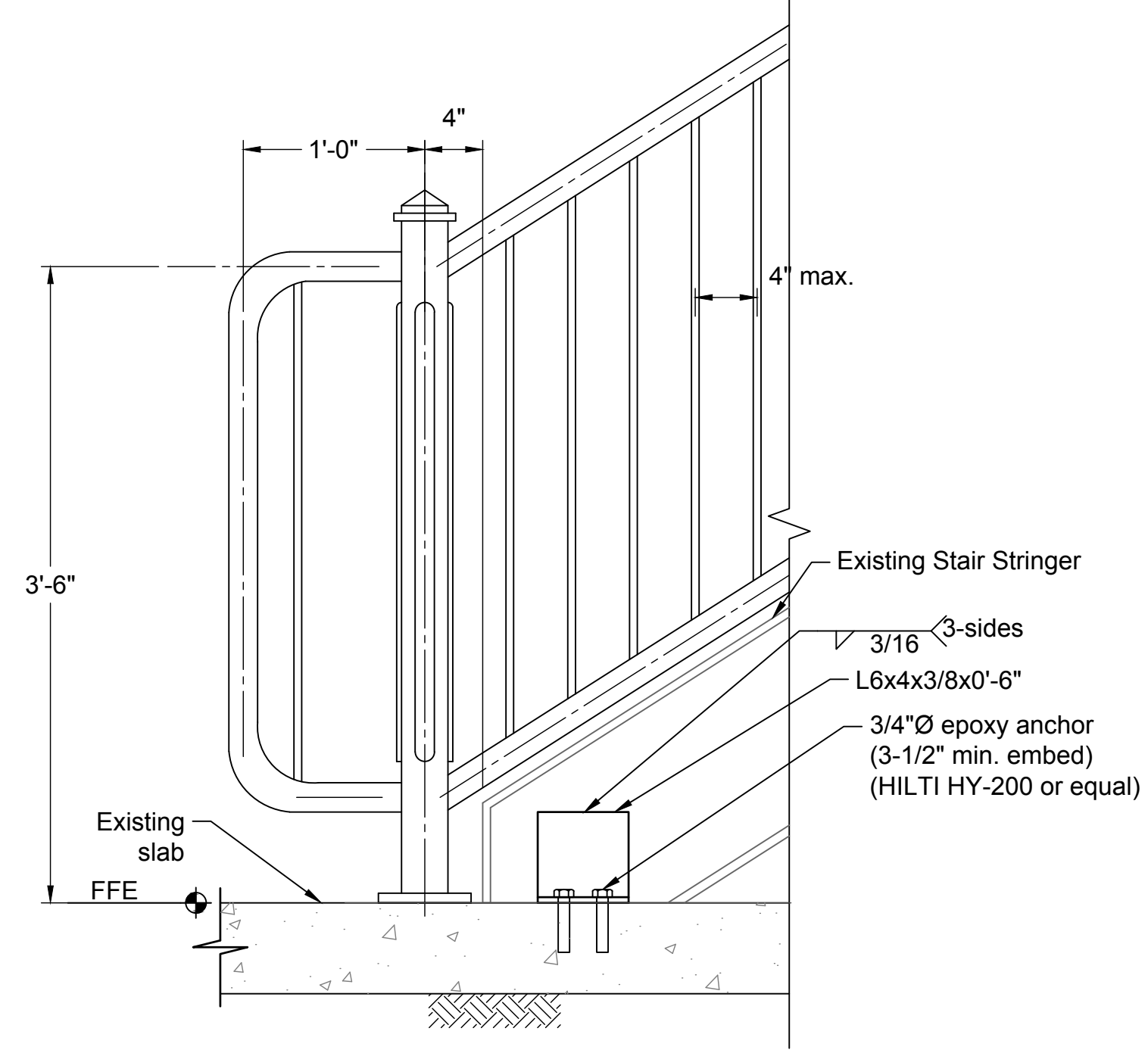

1 - Detail

Scale: 1 1/4" = 1'-0"

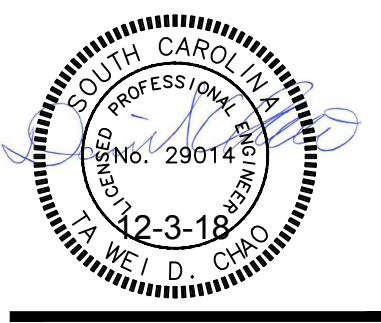
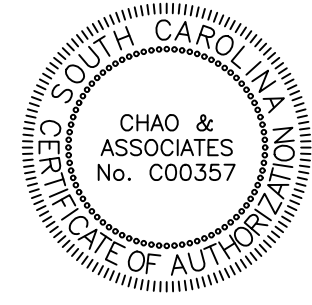

Chao & Associates, Inc.
 Civil - Structural - Survey
 7 Clusters Court
 Columbia, SC 29210
 Voice: (803) 772-8420
 Fax: (803) 772-9120
 Email: consult@chaoinc.com

Replacement Sections and Details
 Blossom Garage East Stair Replacement
 Prepared For:
 University of South Carolina, Columbia, SC

Drawn: LPL	Checked: JWH
Revised:	
File: 393202D-18S-ST.dwg Project No.: 393239E	

S1.1
 Sheet Number
 November 09, 2018
 Date

Drawing file: 393202D-18S-ST.dwg, Plotted: Jan 10, 2019 - 10:24am

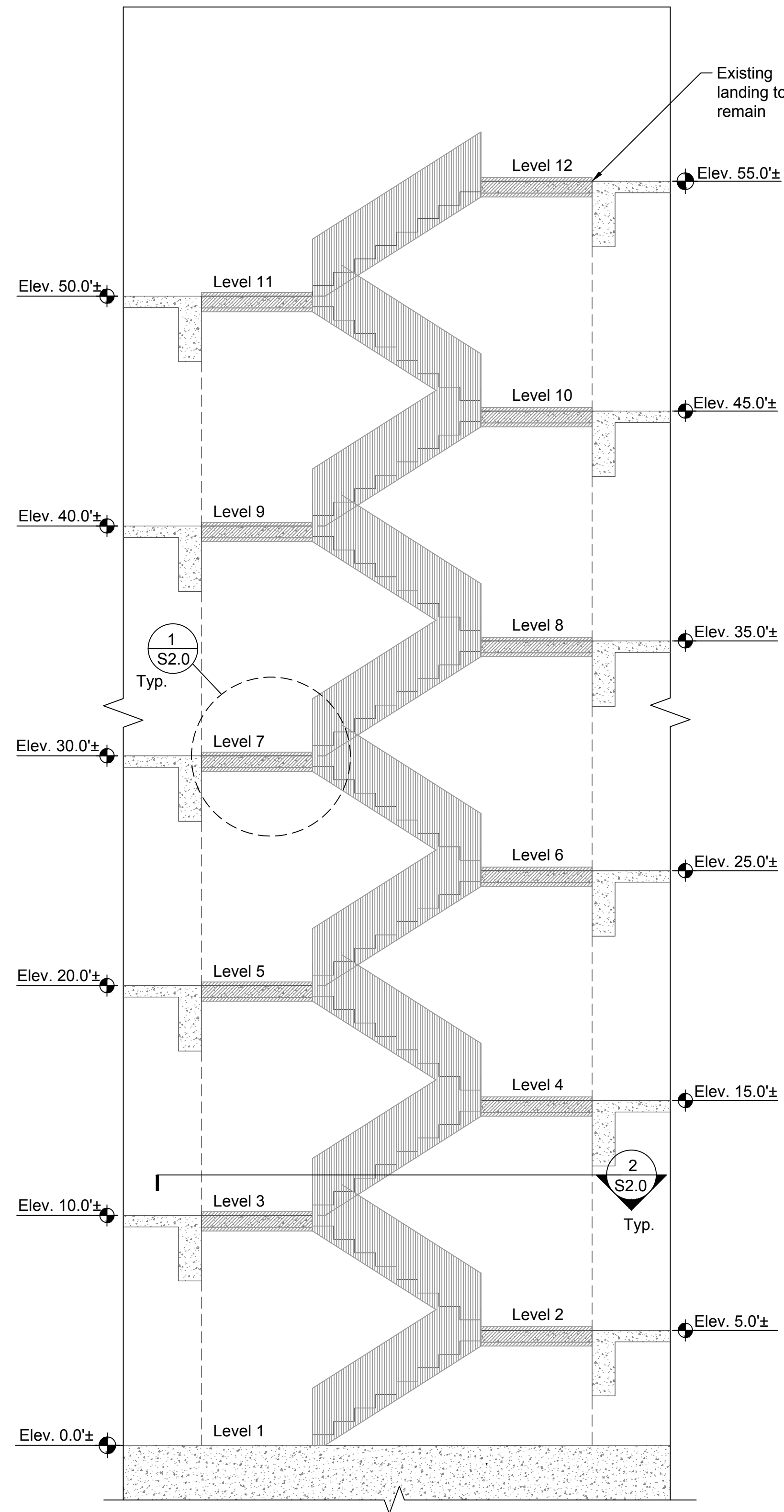

Denotes existing landing to remain and temporarily remove and reinstall existing railing and stairs once replaced. G.C. shall clean existing landing and railing and reapply paint after cleaning. Contractor shall submit paint color for owner's approval.

G.C. shall remove all temporary wood reinforcement shoring, see photo (1) and (2) on S2.1. Photos are for informational purposes only. Total quantities shall be evaluated by the contractor.

Scale: 1/4" = 1'-0"

2 - Stair Replacement Plan - Levels 1-12

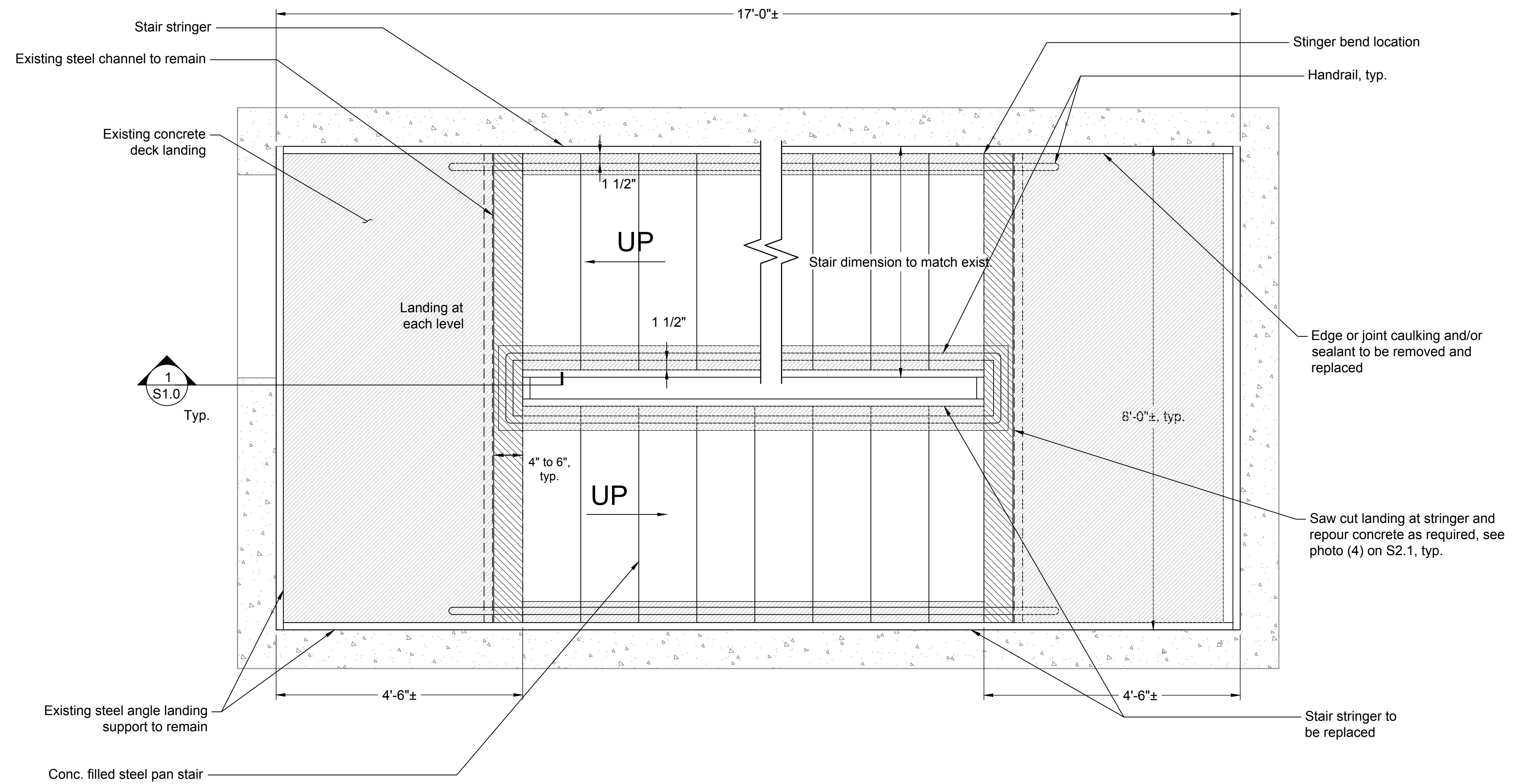

Scale: 3/4" = 1'-0"

1 - Section

Scale: 1" = 1'-0"

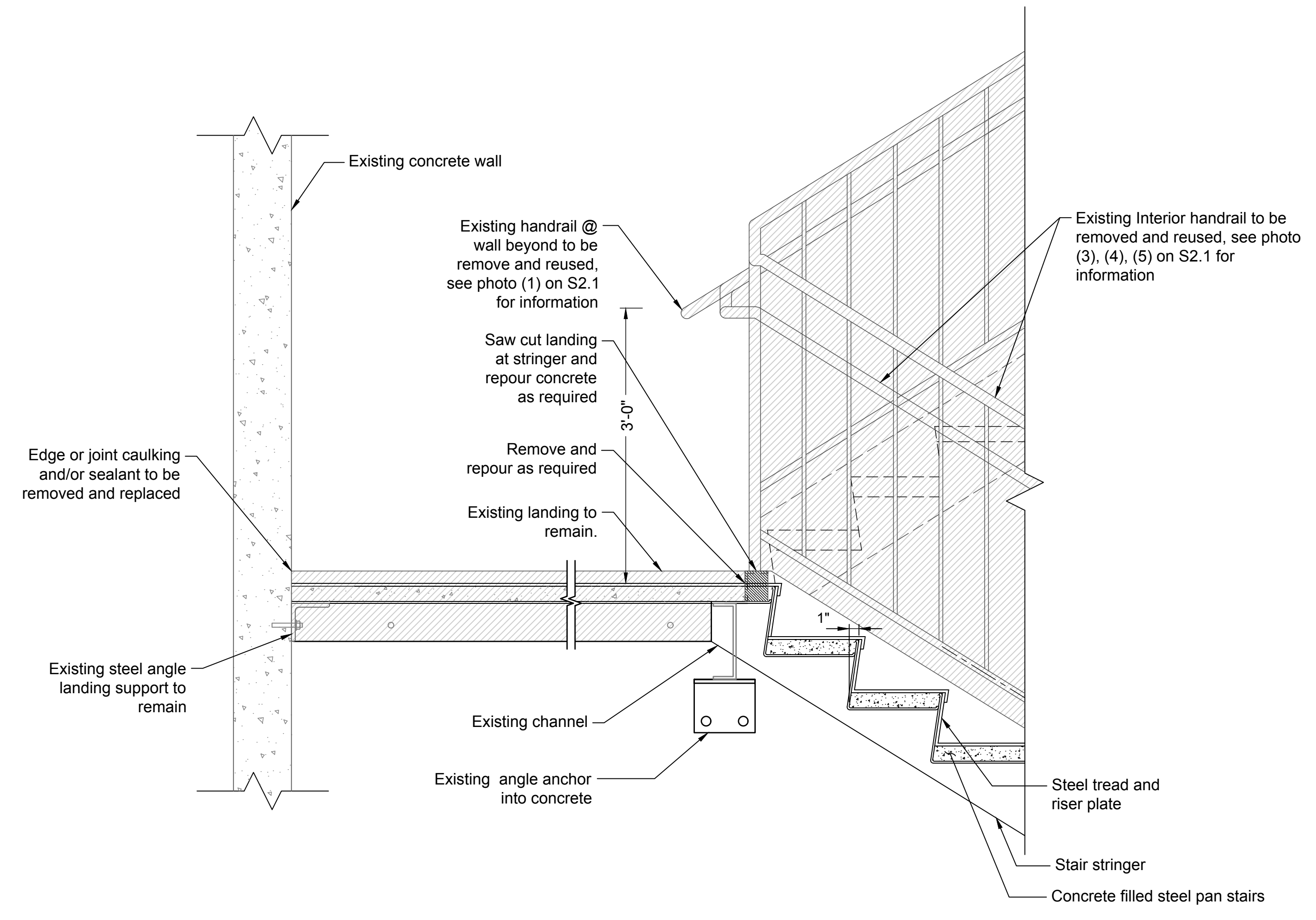

Chao & Associates, Inc.

Civil - Structural - Survey
7 Clusters Court
Columbia, SC 29210
Voice: (803) 772-8420
Fax: (803) 772-9120
Email: consult@chaoinc.com



Alternative Stair Replacement
Blossom Garage East Stair Replacement
Prepared For:
University of South Carolina, Columbia, SC

Drawn: LPL
Checked: JWH

Revised:

File: 393202D-18S-ST.dwg Project No.: 393202D

S2.0

Sheet Number
November 09, 2018
Date



(1)



(2)



(3)



(4)



(5)



Chao & Associates, Inc.
 Civil - Structural - Survey
 7 Clusters Court
 Columbia, SC 29210
 Voice: (803) 772-8420
 Fax: (803) 772-9120
 Email: consult@chaoinc.com

Reference photos
 Blossom Garage East Stair Replacement
 Prepared For:
 University of South Carolina, Columbia, SC

Drawn: LPL
 Revised:
 Checked: JWH
 File: 393202D-18S-ST.dwg Project No.: 393202D

S2.1
 Sheet Number
 November 09, 2018
 Date

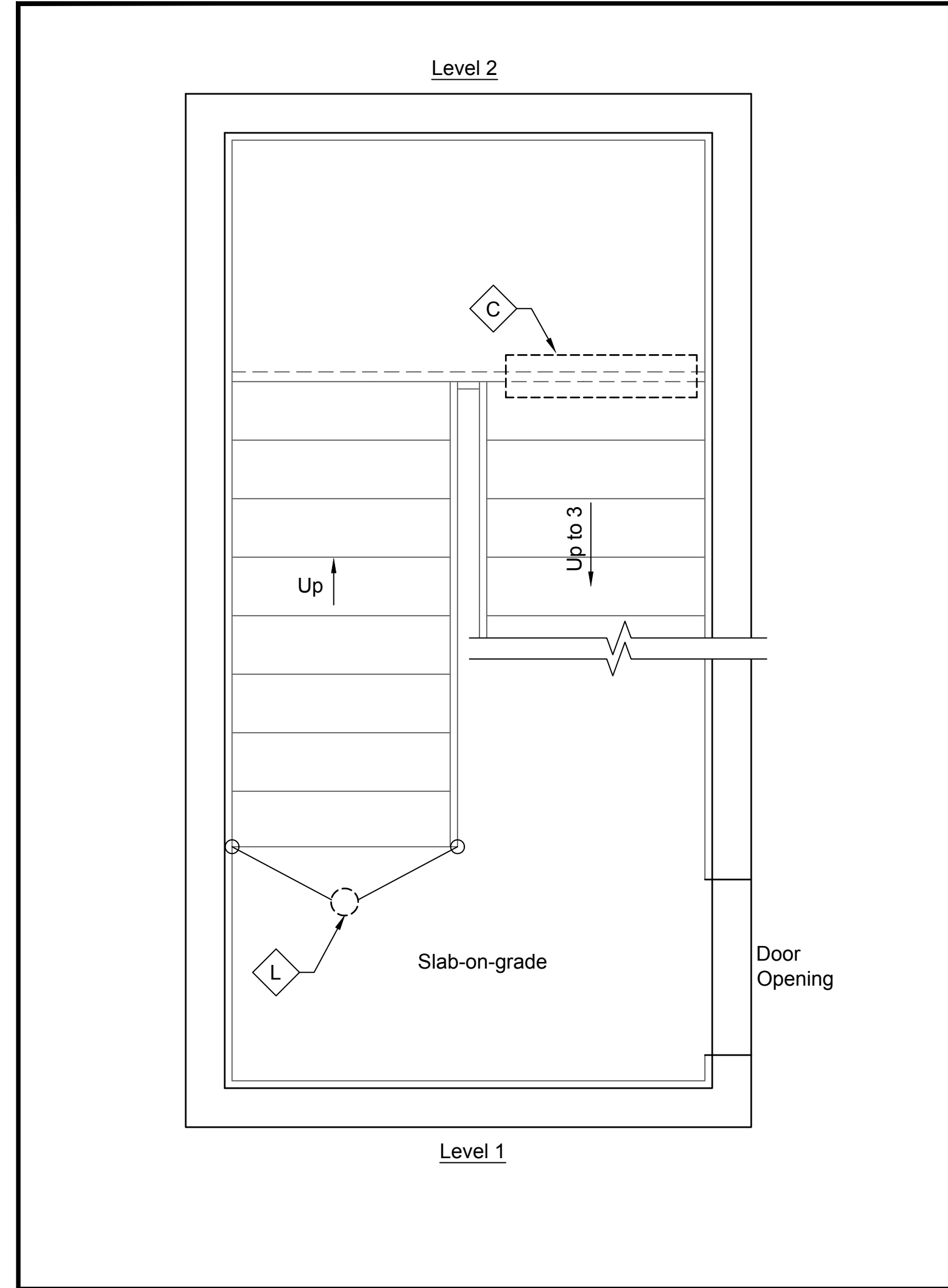

1 - Level 1 - 2 Plan Scale: 1/2" = 1'-0"

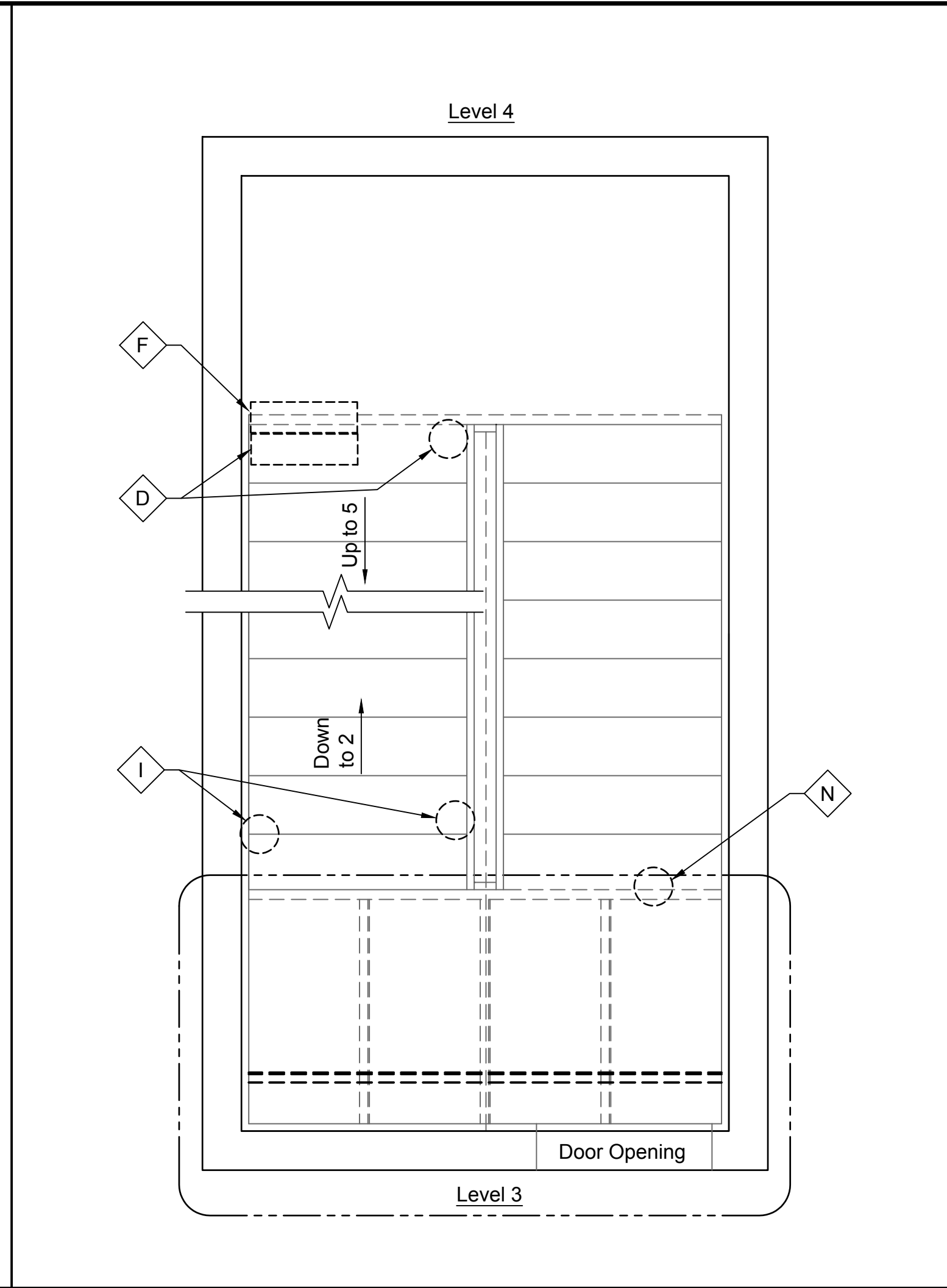

2 - Level 3-4 Plan Scale: 1/2" = 1'-0"

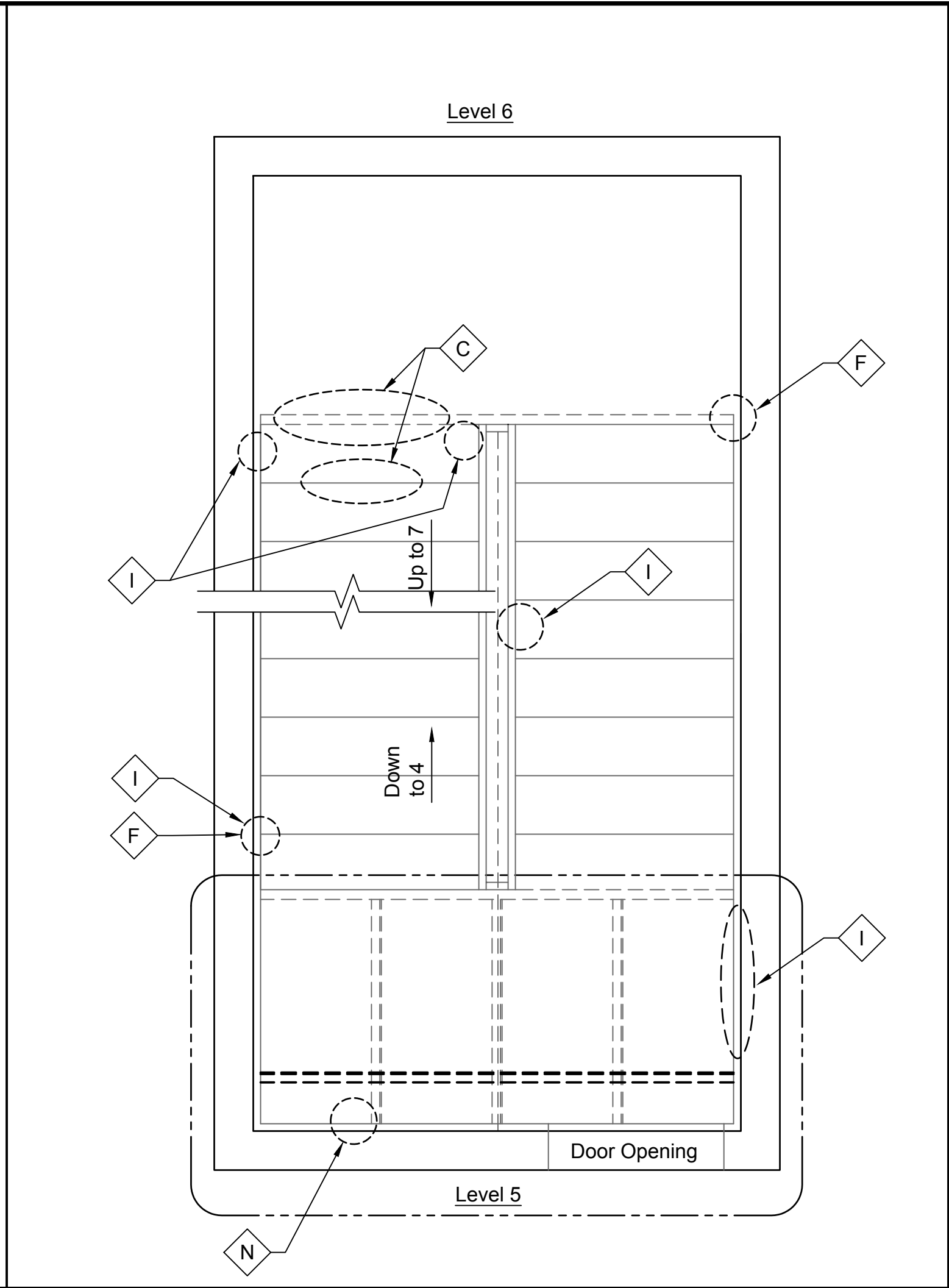

3 - Level 5-6 Plan Scale: 1/2" = 1'-0"

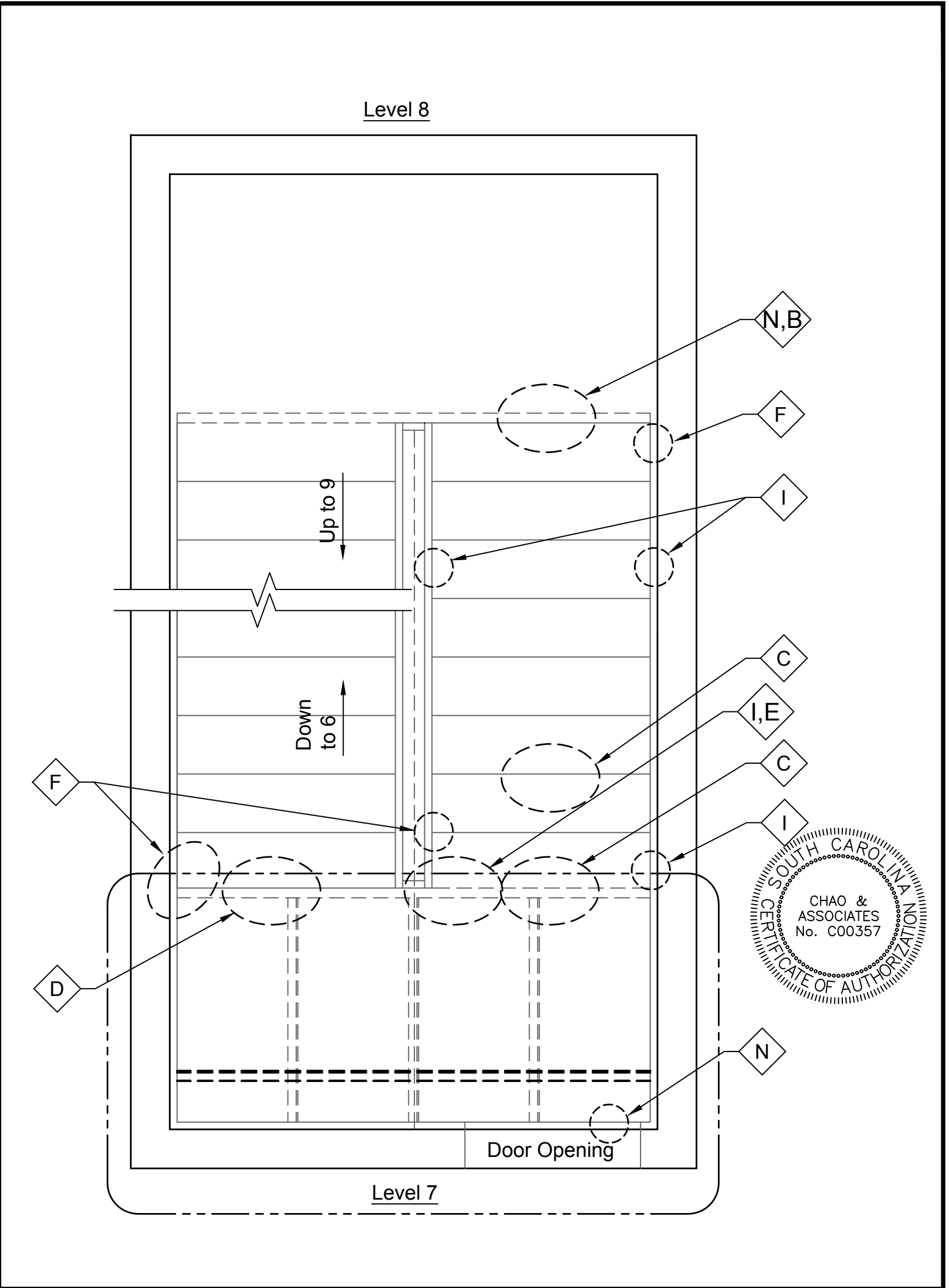

4 - Level 7-8 Plan Scale: 1/2" = 1'-0"

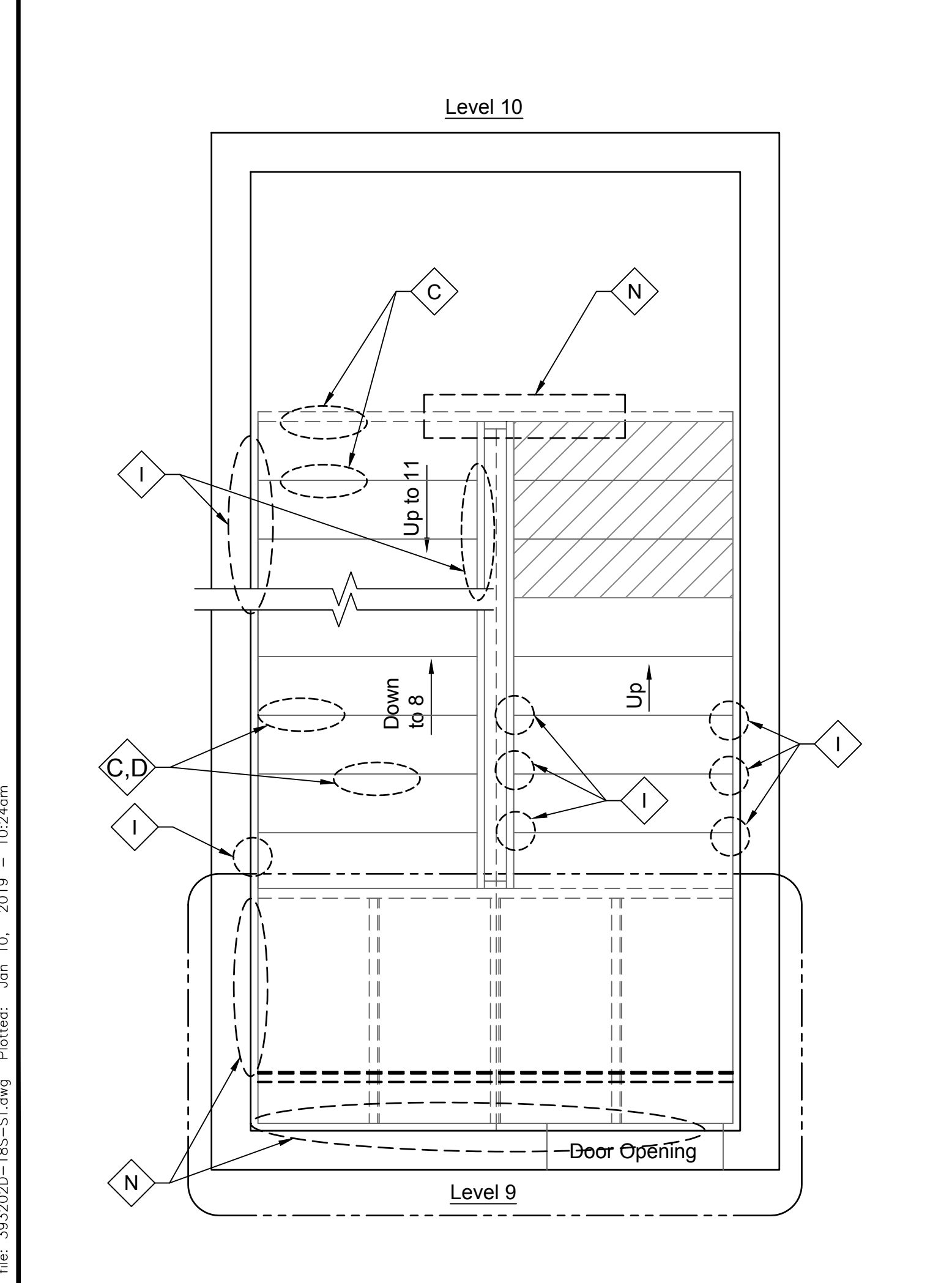

5 - Level 9-10 Plan Scale: 1/2" = 1'-0"

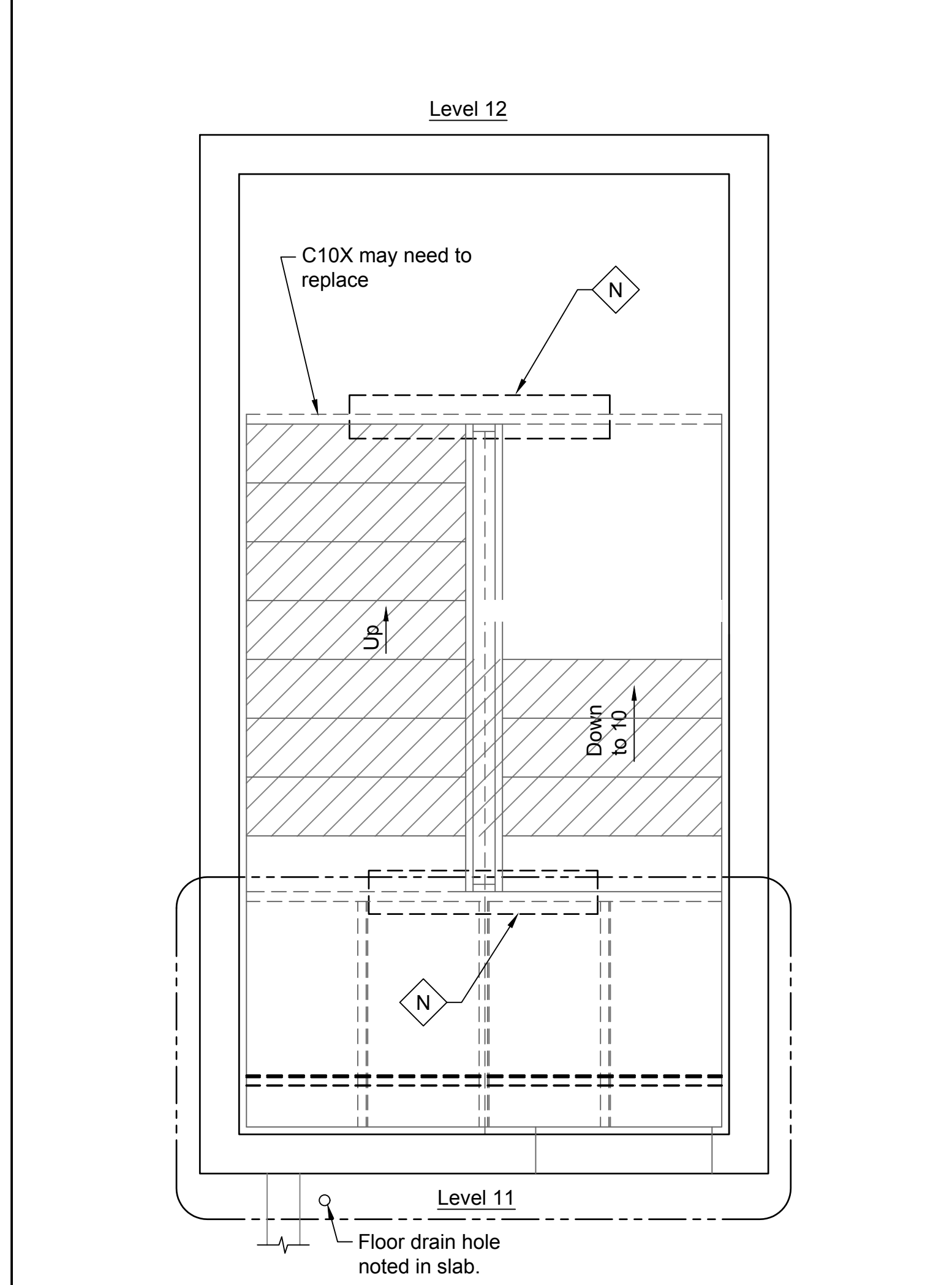

6 - Level 11-12 Plan Scale: 1/2" = 1'-0"

Deficiency Reference Schedule			
Tag	Deficiency	Applicable Levels	Repair Action
A	Standing water noted (After rain event).	1, 2, 3, 4, 5, 6, 7	Noted For Reference.
B	Riser plate severely corroded.	1, 5, 6	Remove heavily corroded portions of riser plate, clean all additional corrosion and reinforce/ replace riser plate with additional plate material (3/16" plate material)(min. weld 3/16" fillet, 2" in 6" full length, each side, typ.)
C	Tread plate severely corroded.	3, 4, 5, 6	Remove heavily corroded portions of tread plate, clean all additional corrosion and reinforce/ replace riser plate with additional plate material (3/16" plate material)(min. weld 3/16" fillet, 2" in 6" full length, each side, typ.)
D	Landing plate severely corroded.	3, 4, 5, 6, 7	Remove heavily corroded portions of landing plate, clean all additional corrosion and reinforce/ replace tread plate with additional plate material (3/16" plate material)(min. weld 3/16" fillet, 2" in 6" full length, each side, typ.)
E	Steel channel severely corroded.	2, 5	Remove heavily corroded portions of channel. (Supplementary support of landings to be provided by addition of C6x10.5 beam.)
F	Steel channel moderately corroded.	2	Clean corrosion and provide for re-evaluation of the corroded condition by the structural engineer. (Supplementary support of landings to be provided by addition of C6x10.5 beam.)
G	Bent plate cover plate severely corroded.	2, 3, 4, 5, 6	Remove all bent plate cover plating and provide for re-evaluation of the presently concealed conditions by the structural engineer. (Additional work anticipated.)
H	Exposed reinforcement in concrete slab.	5, 6	Future repair is recommended.
I	Support angle severely corroded.	2, 3, 4, 6	Remove corroded support angle, clean substrates and replace support angle with L1-1/2x1-1/2x3/16.
J	Tread plate support angle severely corroded.	1, 2, 3, 4, 5, 6, 7	Remove corroded support angle, clean substrates and replace support angle with L1-1/2x1-1/2x3/16.
K	Wall crack noted at beam bearing.	5	Not part of scope. (Future repair is recommended)
L	Rust on stringer.	1	Clean corrosion repair per 6/S2.0.
M	Slab cracking noted.	1, 2, 3, 4, 5, 6, 7	Noted for reference, does not require repair.

Drawing file: 393202D-18S-ST.dwg, Ploited: Jan 10, 2019 - 10:24am



Chao & Associates, Inc.
 Civil - Structural - Survey
 7 Clusters Court
 Columbia, SC 29210
 Voice: (803) 772-8420
 Fax: (803) 772-9120
 Email: consult@chaoinc.com

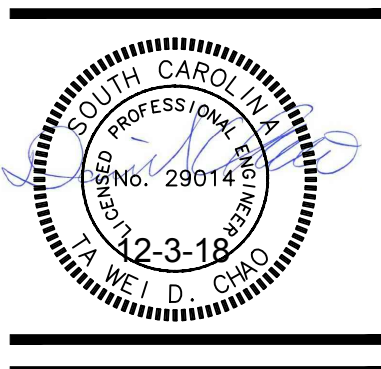

Replacement Sections and Details
Blossom Garage East Stair Replacement
 Prepared For:
University of South Carolina, Columbia, SC

Drawn: LPL Checked: JWH
 Revised:
 File: 393202D-18S-ST.dwg Project No.: 393239E

S3.0
 Sheet Number
 November 09, 2018
 Date

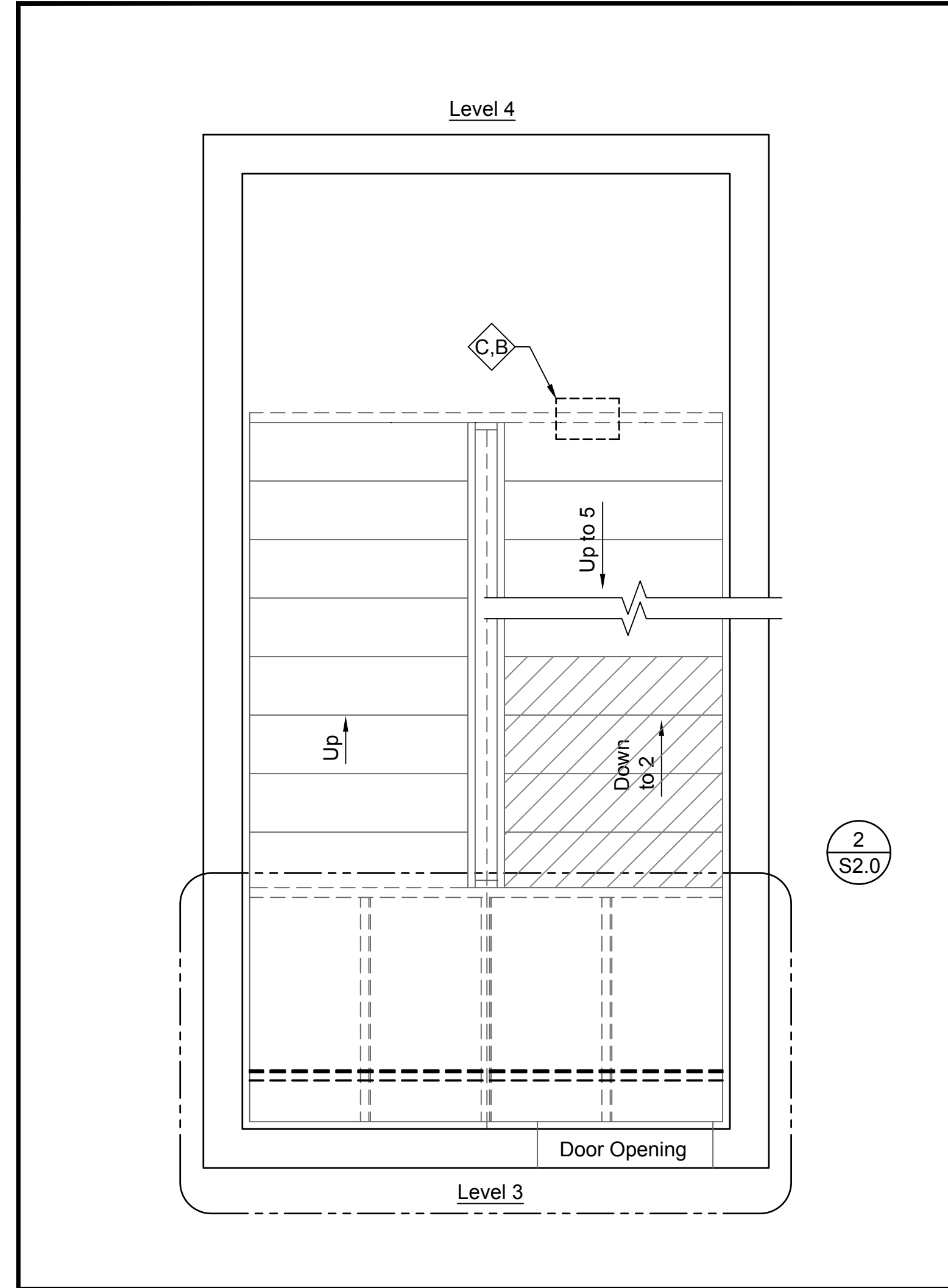

2 - Level 3 - 4 Plan Scale: 1/2" = 1'-0"

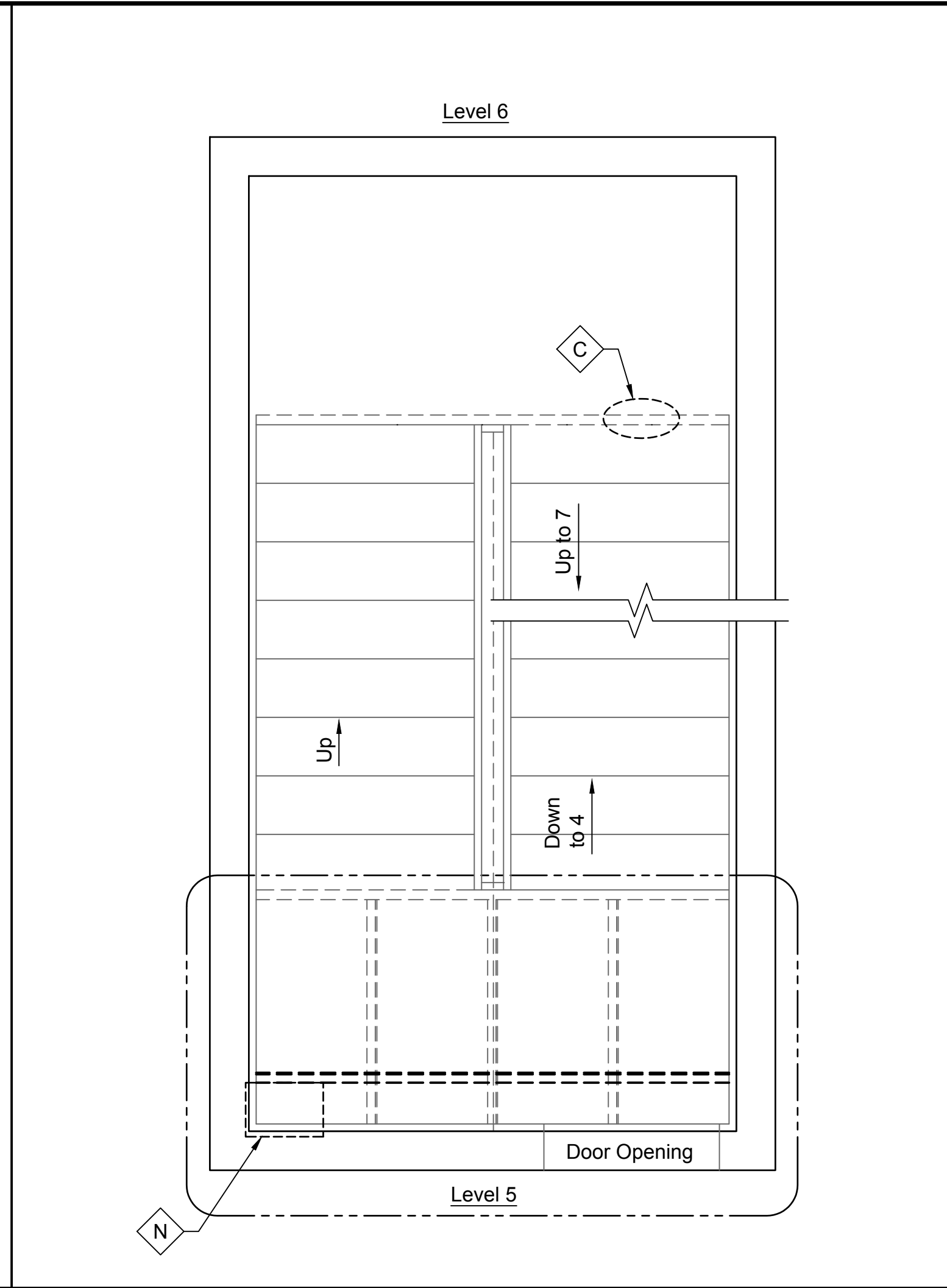

3 - Level 5 - 6 Plan Scale: 1/2" = 1'-0"

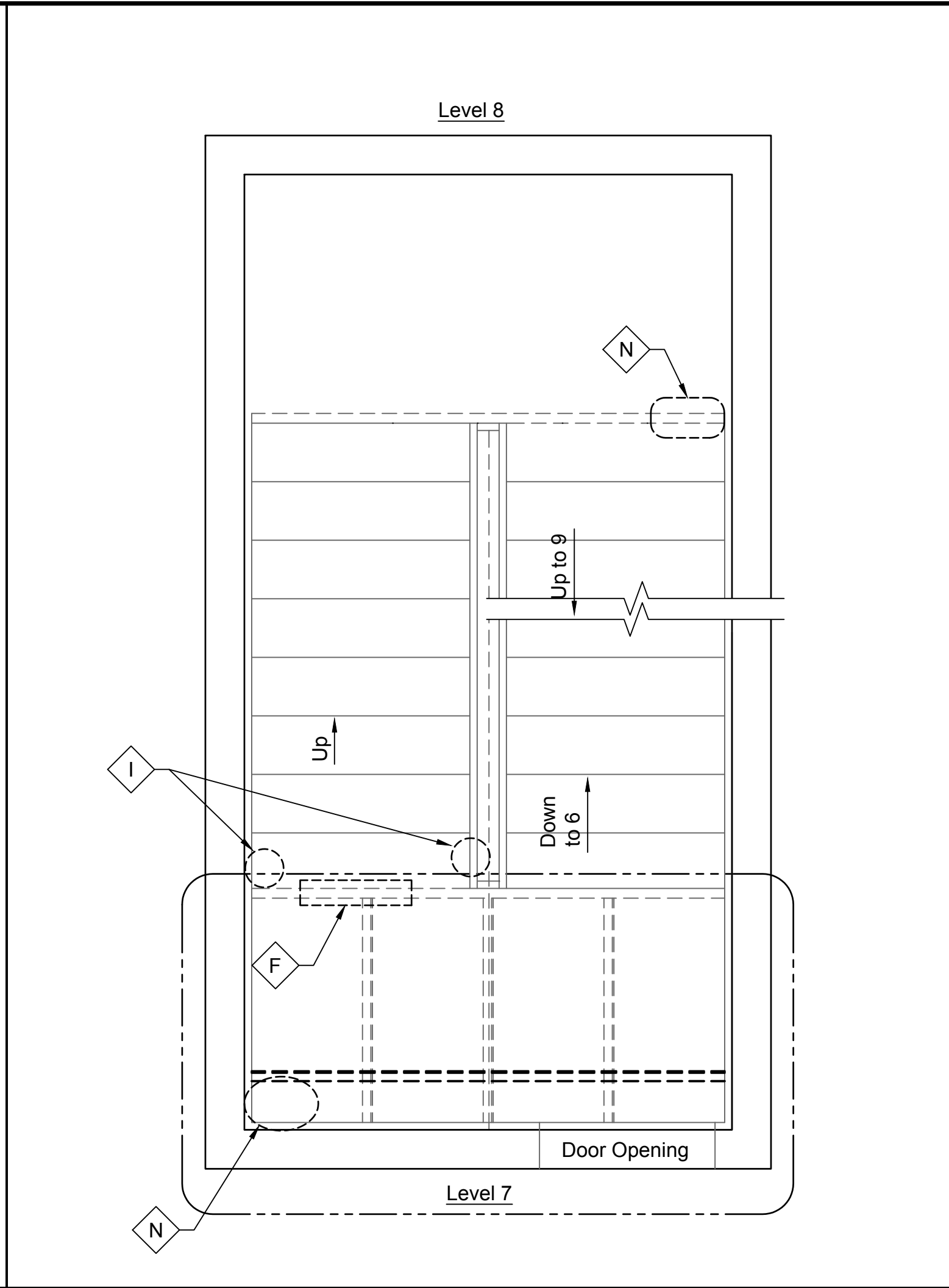

4 - Level 7 - 8 Plan Scale: 1/2" = 1'-0"

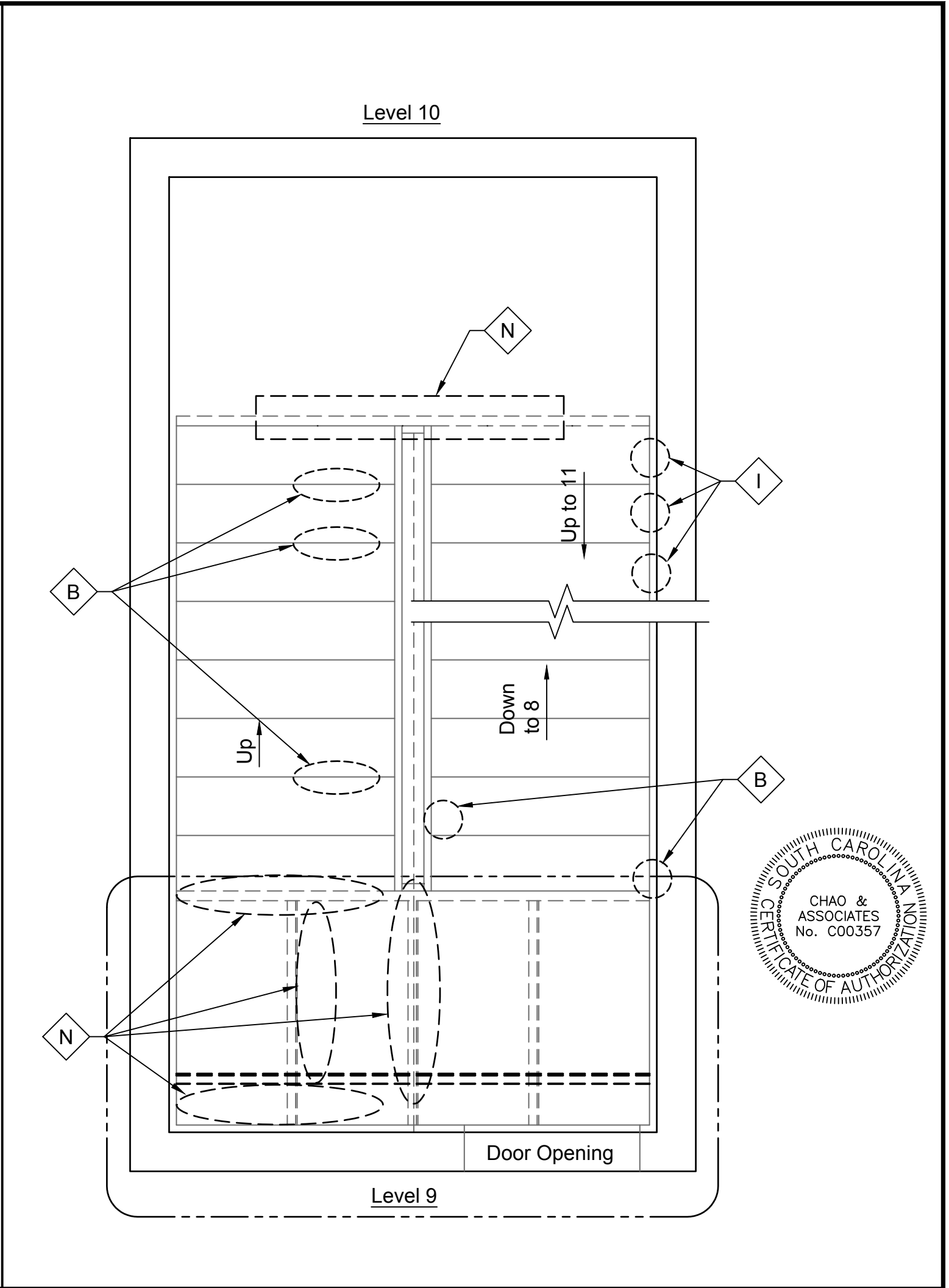

5 - Level 9 - 10 Plan Scale: 1/2" = 1'-0"

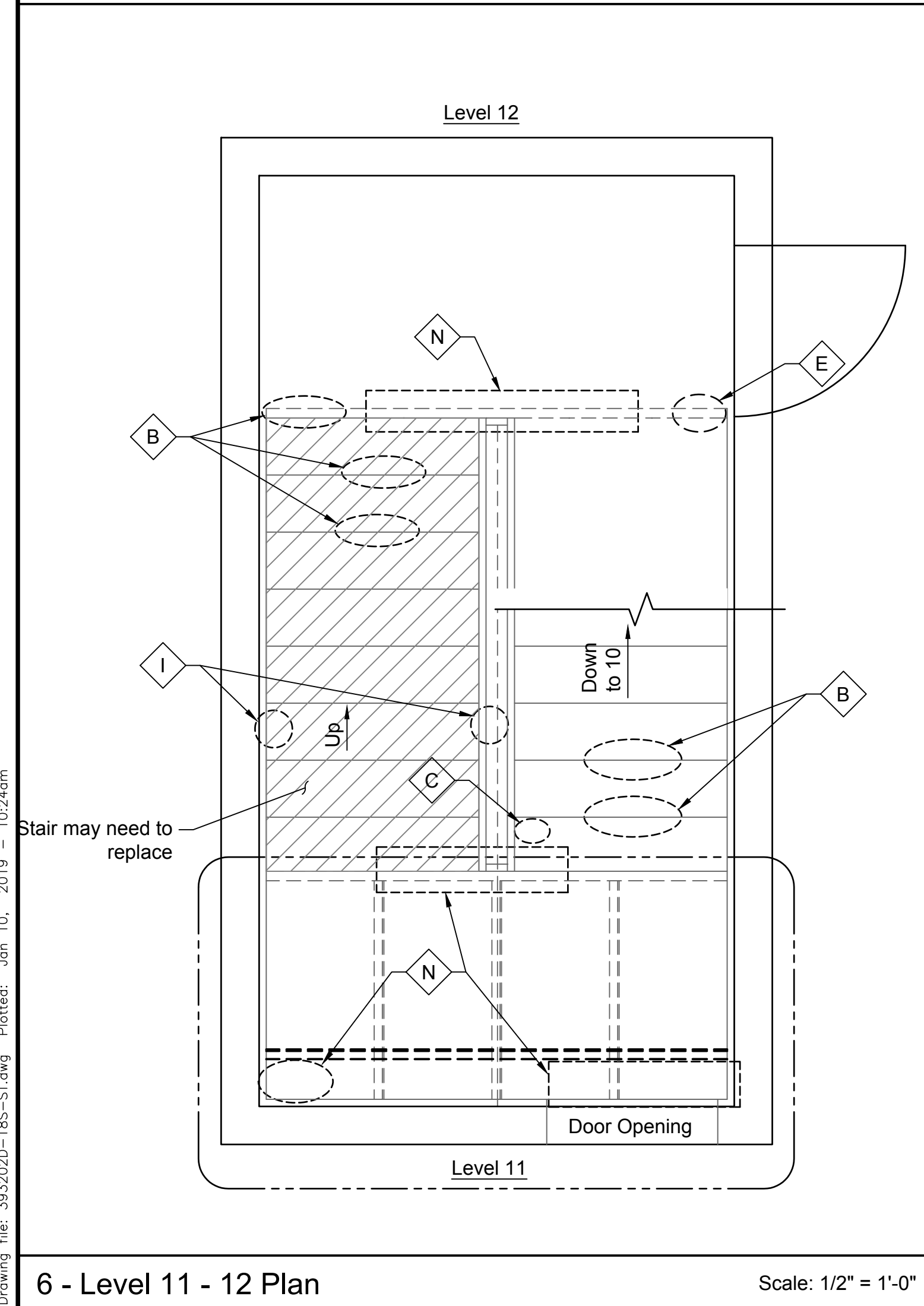

6 - Level 11 - 12 Plan Scale: 1/2" = 1'-0"

Deficiency Reference Schedule			
Tag	Deficiency	Applicable Levels	Repair Action
A	Standing water noted (After rain event).	1, 2, 3, 4, 5, 6, 7	Noted For Reference.
B	Riser plate severely corroded.	1, 5, 6	Remove heavily corroded portions of riser plate, clean all additional corrosion and reinforce/ replace riser plate with additional plate material (3/16" plate material)(min. weld 3/16" fillet, 2" in 6" full length, each side, typ.)
C	Tread plate severely corroded.	3, 4, 5, 6	Remove heavily corroded portions of tread plate, clean all additional corrosion and reinforce/ replace riser plate with additional plate material (3/16" plate material)(min. weld 3/16" fillet, 2" in 6" full length, each side, typ.)
D	Landing plate severely corroded.	3, 4, 5, 6, 7	Remove heavily corroded portions of landing plate, clean all additional corrosion and reinforce/ replace tread plate with additional plate material (3/16" plate material)(min. weld 3/16" fillet, 2" in 6" full length, each side, typ.)
E	Steel channel severely corroded.	2, 5	Remove heavily corroded portions of channel. (Supplementary support of landings to be provided by addition of C6x10.5 beam.)
F	Steel channel moderately corroded.	2	Clean corrosion and provide for re-evaluation of the corroded condition by the structural engineer. (Supplementary support of landings to be provided by addition of C6x10.5 beam.)
G	Bent plate cover plate severely corroded.	2, 3, 4, 5, 6	Remove all bent plate cover plating and provide for re-evaluation of the presently concealed conditions by the structural engineer. (Additional work anticipated).
H	Exposed reinforcement in concrete slab.	5, 6	Future repair is recommended.
I	Support angle severely corroded.	2, 3, 4, 6	Remove corroded support angle, clean substrates and replace support angle with L1-1/2x1-1/2x3/16.
J	Tread plate support angle severely corroded.	1, 2, 3, 4, 5, 6, 7	Remove corroded support angle, clean substrates and replace support angle with L1-1/2x1-1/2x3/16.
K	Wall crack noted at beam bearing.	5	Not part of scope. (Future repair is recommended)
L	Rust on stringer.	1	Clean corrosion repair per 6/S2.0.
M	Slab cracking noted.	1, 2, 3, 4, 5, 6, 7	Noted for reference, does not require repair.

Drawing file: 393202D-18S-ST.dwg, Plotfile: Jan 10, 2019 - 10:24am



Chao & Associates, Inc.
 Civil - Structural - Survey
 7 Clusters Court
 Columbia, SC 29210
 Voice: (803) 772-8420
 Fax: (803) 772-9120
 Email: consult@chaoinc.com

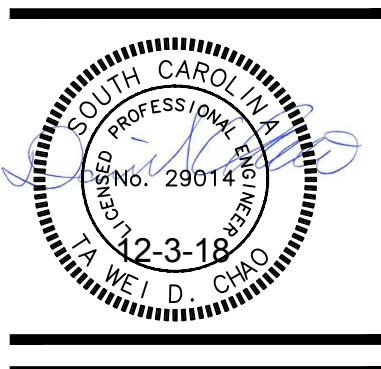

Replacement Sections and Details
Blossom Garage East Stair Replacement
 Prepared For:
University of South Carolina, Columbia, SC

Drawn: LPL
 Revised:
 Checked: JWH
 File: 393202D-18S-ST.dwg Project No.: 393239E

S3.1
 Sheet Number
 November 09, 2018
 Date