

CAPSTONE INTERIOR PAINTING MAINTENANCE PROJECT





902 BARNWELL STREET
COLUMBIA, SOUTH CAROLINA

PROJECT NO. H27-Z373

USC HOUSING PROJECT: CAPSTONE PAINTING PROJECT 2018

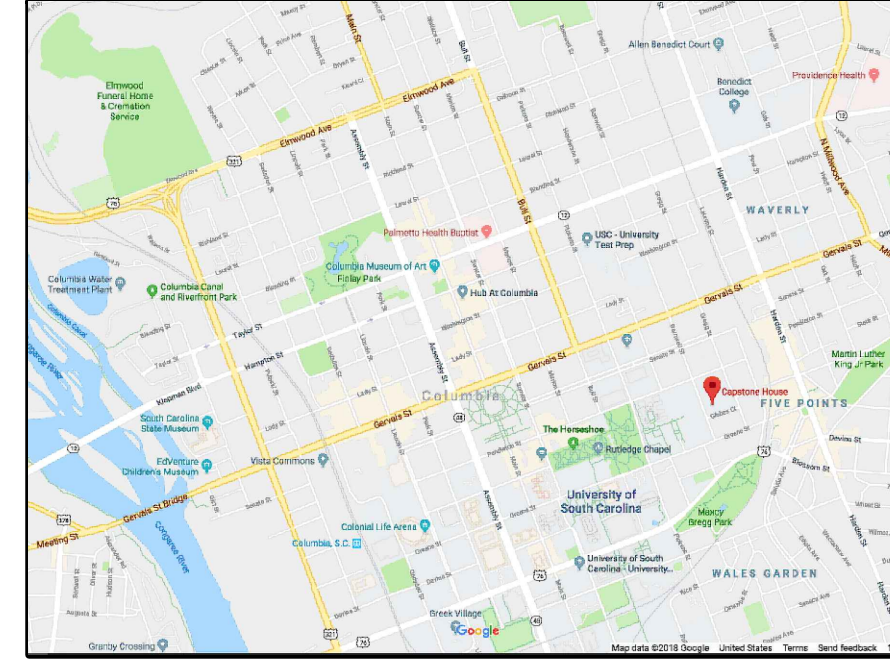
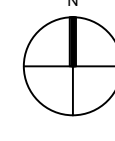
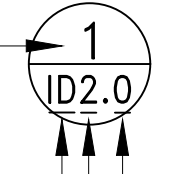
**100% BID DOCUMENTS
MARCH 22, 2018**

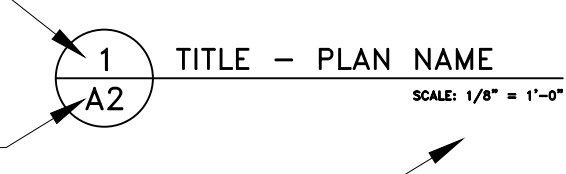
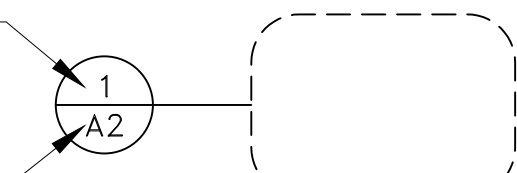
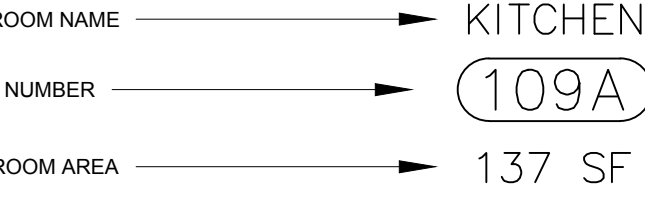
CONSTRUCTION &
RENOVATIONS
FOR UNIVERSITY HOUSING
1520 DEVINE STREET
COLUMBIA, SC 29208

LOCATION MAP	SYMBOL LEGEND	ABBREVIATIONS	FINISH SCHEDULE		GENERAL NOTES																
			CODE	SPECIFICATION																	
 <p>DOWNTOWN COLUMBIA, SC</p>	<p>NORTH INDICATOR SYMBOL</p>  <p>PLAN SHEET ORIENTATION</p> <p>DETAILING SYMBOL</p>  <p>DETAIL REFERENCE NUMBER</p>  <p>DISCIPLINE IDENTIFICATION</p> <p>PLAN IDENTIFICATION</p> <p>BUILDING FLOOR NUMBER</p> <p>PLAN REFERENCE</p>  <p>DETAIL NUMBER</p> <p>SHEET REFERENCE</p> <p>PLAN DETAIL REFERENCE</p>  <p>DETAIL NUMBER</p> <p>WHERE DETAIL IS SHOWN</p> <p>DASHES SURROUND DETAIL AREA</p> <p>ROOM TAG SYMBOL</p>  <p>ROOM NAME</p> <p>ROOM NUMBER</p> <p>ROOM AREA</p> <p>REVISION SYMBOL</p>  <p>CLOUD AROUND REVISION</p> <p>NOT-IN-SCOPE</p>  <p>SHADED LOCATIONS NOT-IN-SCOPE OF PROJECT</p>	<p>ABBREVIATIONS</p> <p>CL CENTERLINE</p> <p>CPT CARPET</p> <p>CT CERAMIC TILE</p> <p>CONC CONCRETE</p> <p>CUST CUSTODIAL CLOSET</p> <p>DN DOWN</p> <p>DWG DRAWING</p> <p>ELECT ELECTRICAL CLOSET</p> <p>EXIST EXISTING</p> <p>EXP-CONC EXPOSED CONCRETE</p> <p>LVT LUXURY VINYL TILE</p> <p>MFG MANUFACTURER</p> <p>MECH MECHANICAL ROOM</p> <p>NIC NOT IN CONTRACT</p> <p>NTS NOT TO SCALE</p> <p>P PAINT</p> <p>PB PORCELAIN BASE</p> <p>QT QUARRY TILE</p> <p>RB RUBBER BASE</p> <p>RF RUBBER TILE</p> <p>RT RUBBER TREAD</p> <p>TER TERRAZZO</p> <p>VCT VINYL COMPOSITION TILE</p> <p>FINISH LEGEND</p> <p>FLOOR FINISH ——— EXIST</p> <p>BASE FINISH ——— EXIST</p> <p>WALL FINISH ——— P-7</p> <p>CEILING FINISH ——— P-12,13</p>	P-1	MFR: SHERWIN WILLIAMS COLOR: SW 7044 - AMAZING GRAY FINISH: EG-SHEL	<p>GENERAL NOTES</p> <p>1. REFER TO CAPSTONE PAINT SPECIFICATIONS FOR PROJECT DETAILS AND ALL PAINT SYSTEMS TO BE USED.</p> <p>2. REFER TO CAPSTONE FINISH PLANS FOR PAINT COLOR LOCATIONS.</p>																
			P-2	MFR: SHERWIN WILLIAMS COLOR: SW 7043 - WORLDLY GRAY FINISH: SEMI-GLOSS		P-3	MFR: SHERWIN WILLIAMS COLOR: SW 6307 - FINE WINE FINISH: EG-SHEL	P-4	MFR: SHERWIN WILLIAMS COLOR: SW 6531 - INDIGO FINISH: SEMI-GLOSS	P-5	MFR: SHERWIN WILLIAMS COLOR: SW 6473 - SURF GREEN FINISH: SEMI-GLOSS	P-6	MFR: SHERWIN WILLIAMS COLOR: SW 6474 - RAGING SEA FINISH: SEMI-GLOSS	P-7	MFR: SHERWIN WILLIAMS COLOR: SW 6105 - DEVINE WHITE FINISH: EG-SHEL	P-8	MFR: SHERWIN WILLIAMS COLOR: SW 7043 - WORLDLY GRAY FINISH: SEMI-GLOSS	P-9	MFR: SHERWIN WILLIAMS COLOR: SW 7675 - SEALSKIN FINISH: SEMI-GLOSS	P-10	MFR: SHERWIN WILLIAMS COLOR: SW 7675 - SEALSKIN FINISH: SEMI-GLOSS
<p>PROJECT SUMMARY OF WORK</p> <p>The Contractor must furnish all labor, materials and equipment required to perform the following: Protect, prepare and Paint Interior of basement through 17th floor in the following residence hall:</p> <p>Capstone Residence Hall - This building consist of 18 Stories, including 16 residential floors, lobby and basement levels. There are 309 student suite-style resident rooms, and a small variety of common lounges.</p>					<p>INDEX OF DRAWINGS</p> <table border="1"> <thead> <tr> <th>DWG #</th> <th>DRAWING TITLE</th> </tr> </thead> <tbody> <tr> <td>T1.1</td> <td>TITLE SHEET</td> </tr> <tr> <td>ID2.0</td> <td>BASEMENT FINISH PLAN</td> </tr> <tr> <td>ID2.1</td> <td>1ST FLOOR FINISH PLAN</td> </tr> <tr> <td>ID2.2</td> <td>2ND FLOOR FINISH PLAN</td> </tr> <tr> <td>ID2.3</td> <td>TYPICAL RESIDENTIAL FLOOR FINISH PLAN (3RD - 16TH)</td> </tr> <tr> <td>ID2.4</td> <td>17TH FLOOR FINISH PLAN</td> </tr> </tbody> </table>		DWG #	DRAWING TITLE	T1.1	TITLE SHEET	ID2.0	BASEMENT FINISH PLAN	ID2.1	1ST FLOOR FINISH PLAN	ID2.2	2ND FLOOR FINISH PLAN	ID2.3	TYPICAL RESIDENTIAL FLOOR FINISH PLAN (3RD - 16TH)	ID2.4	17TH FLOOR FINISH PLAN	
DWG #	DRAWING TITLE																				
T1.1	TITLE SHEET																				
ID2.0	BASEMENT FINISH PLAN																				
ID2.1	1ST FLOOR FINISH PLAN																				
ID2.2	2ND FLOOR FINISH PLAN																				
ID2.3	TYPICAL RESIDENTIAL FLOOR FINISH PLAN (3RD - 16TH)																				
ID2.4	17TH FLOOR FINISH PLAN																				

CAPSTONE HOUSE
BUILDING #: 039
UNIVERSITY OF
SOUTH CAROLINA

NO.	DATE	DESCRIPTION

DATE: 3-22-2018

T1.1

TITLE SHEET

***NOTE: CONTRACTOR TO FIELD
VERIFY ALL MEASUREMENTS.

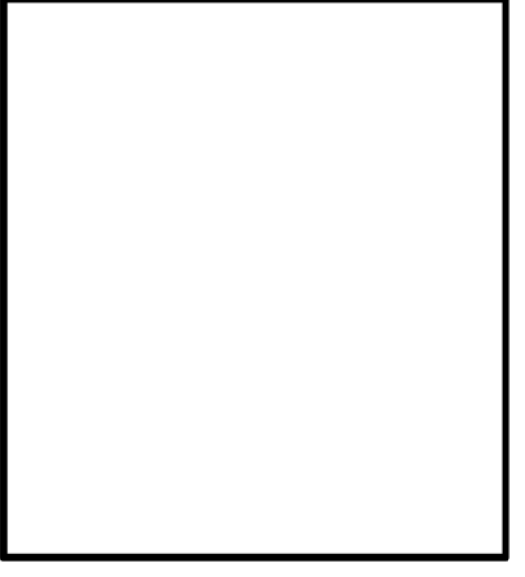

REVISIONS	
NO.	DESCRIPTION

DATE: 3-22-2018

ID2.0
BASEMENT
FINISH PLAN

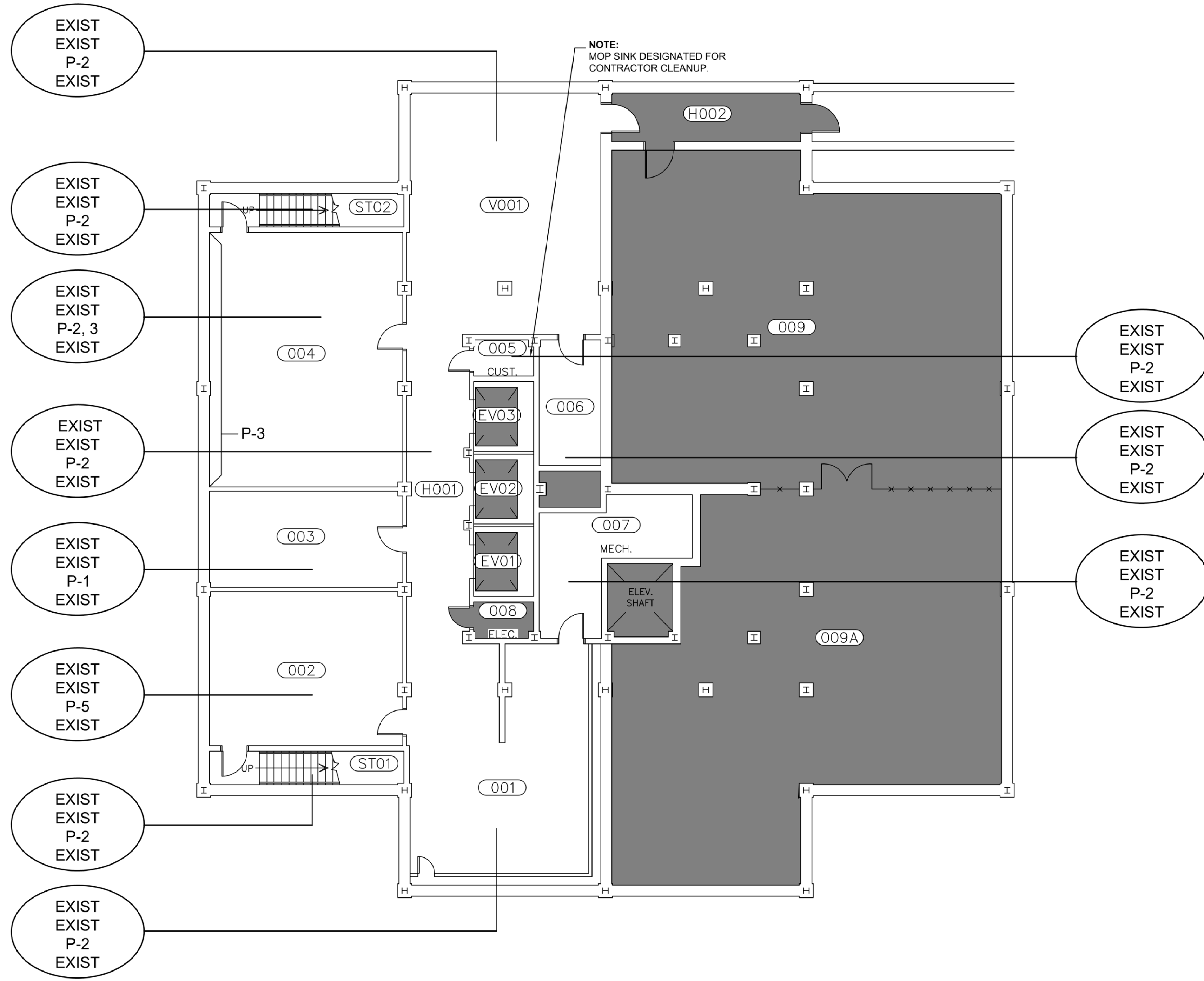

1 BASEMENT - FINISH PLAN
ID2.0

SCALE: 1/8" = 1'-0"

NOTE: FINISH PLANS CONTAIN INFORMATION FOR ENTIRE BUILDING FOR UNIVERSITY RECORDS.
THE SCOPE OF THIS PROJECT IS FOR COMPREHENSIVE PAINTING ONLY.

***NOTE: CONTRACTOR TO FIELD
VERIFY ALL MEASUREMENTS.

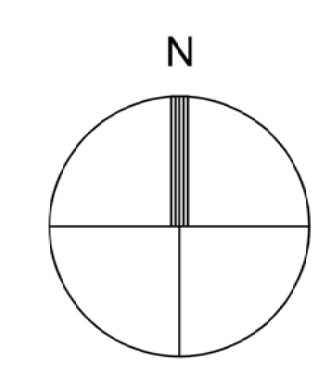

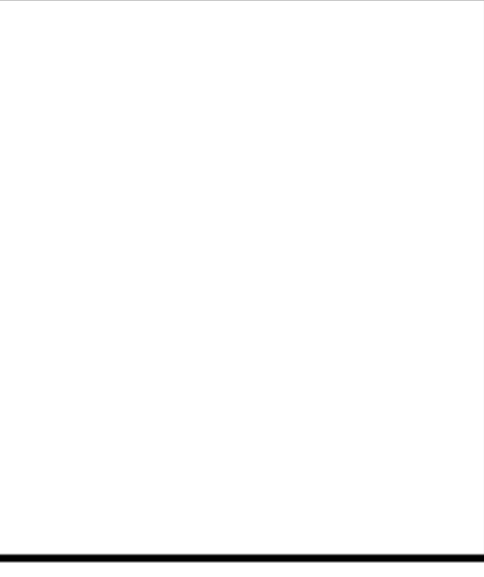

REVISIONS	
NO.	DESCRIPTION

DATE: 3-22-2018

ID2.1
1ST FLOOR
FINISH PLAN

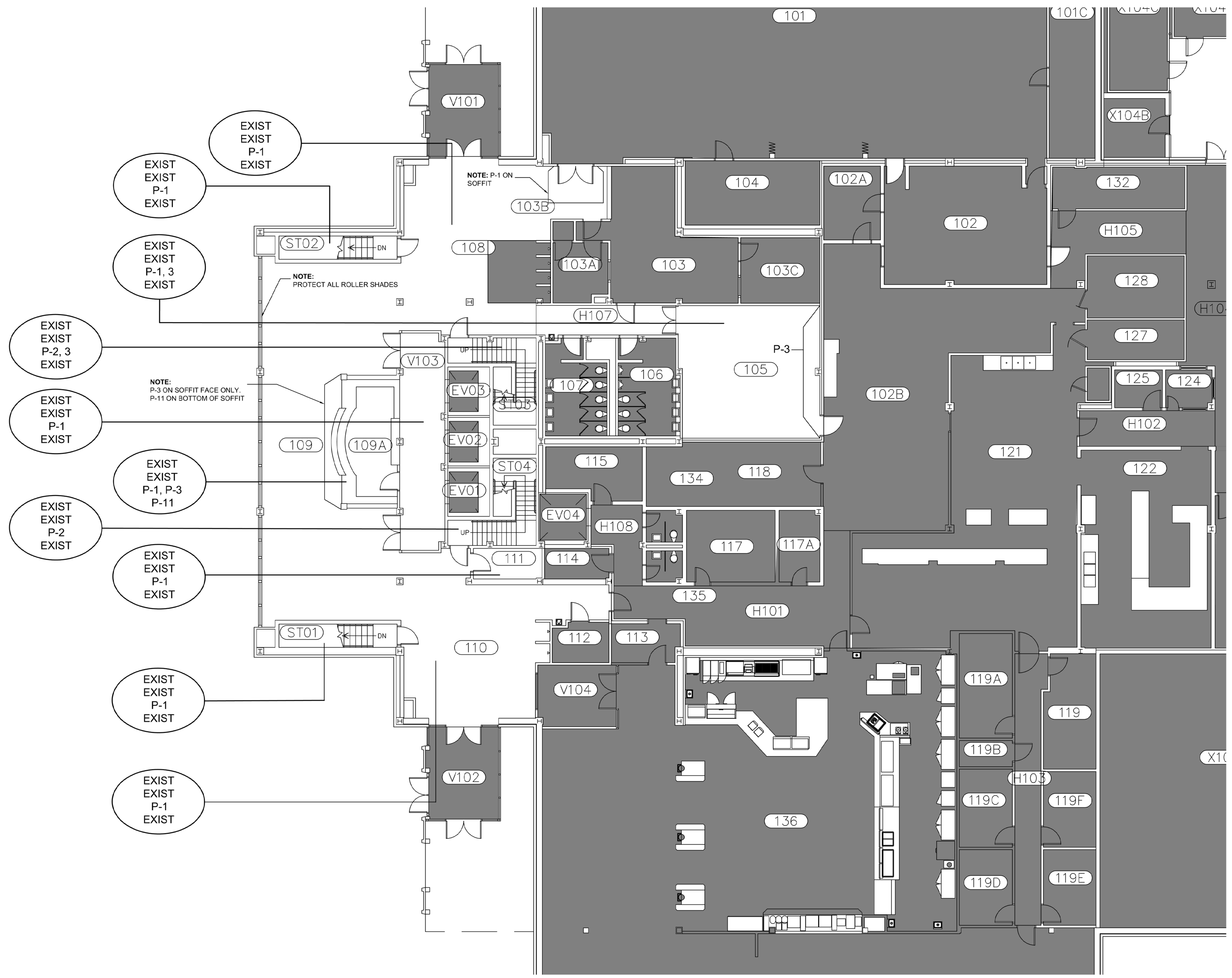

1 FIRST FLOOR - FINISH PLAN
ID2.1

SCALE: 1/8" = 1'-0"

NOTE: FINISH PLANS CONTAIN INFORMATION FOR ENTIRE BUILDING FOR UNIVERSITY RECORDS.
THE SCOPE OF THIS PROJECT IS FOR COMPREHENSIVE PAINTING ONLY.

***NOTE: CONTRACTOR TO FIELD
VERIFY ALL MEASUREMENTS.

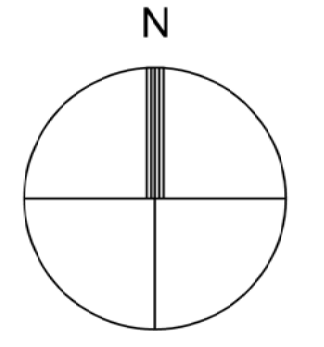

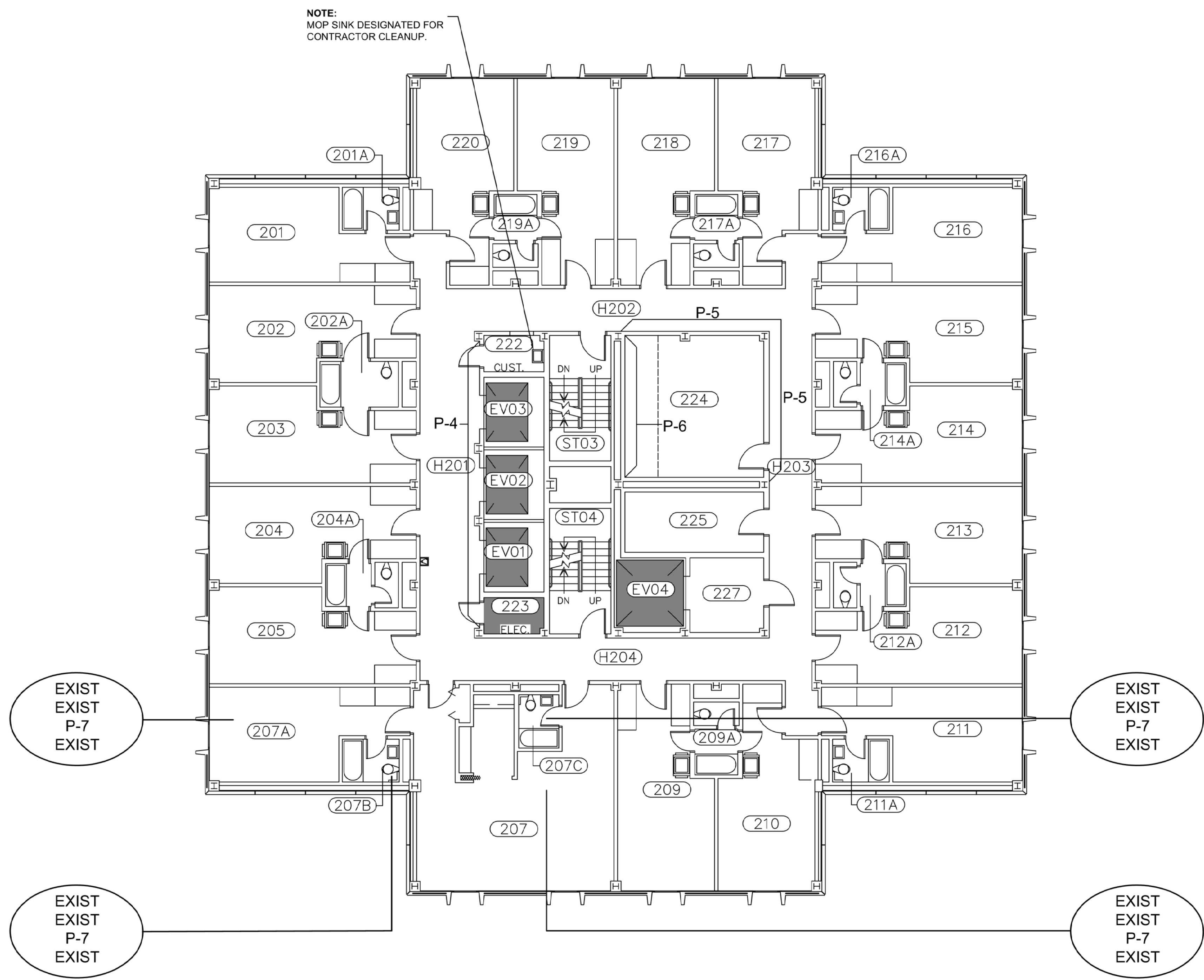

EXIST
EXIST
P-7
EXIST

EXIST
EXIST
P-7
EXIST

EXIST
EXIST
P-7
EXIST

EXIST
EXIST
P-7
EXIST

1
ID2.2 SECOND FLOOR - FINISH PLAN

SCALE: 1/8" = 1'-0"

NOTE: FINISH PLANS CONTAIN INFORMATION FOR ENTIRE BUILDING FOR UNIVERSITY RECORDS.
THE SCOPE OF THIS PROJECT IS FOR COMPREHENSIVE PAINTING ONLY.

NOTE: REFER TO ID2.3 FOR ALL OTHER TYPICAL RESIDENTIAL FLOOR FINISHES.

NOTE: REMOVE WINDOW BLINDS FROM METAL WINDOW FRAMES ONLY. DO NOT REMOVE ANY BLINDS FROM SOFFIT OR WALLS.

***NOTE: CONTRACTOR TO FIELD
VERIFY ALL MEASUREMENTS.

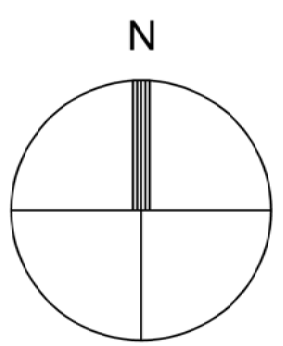

REVISIONS	
NO.	DESCRIPTION

DATE: 3-22-2018

ID2.2
2ND FLOOR
FINISH PLAN

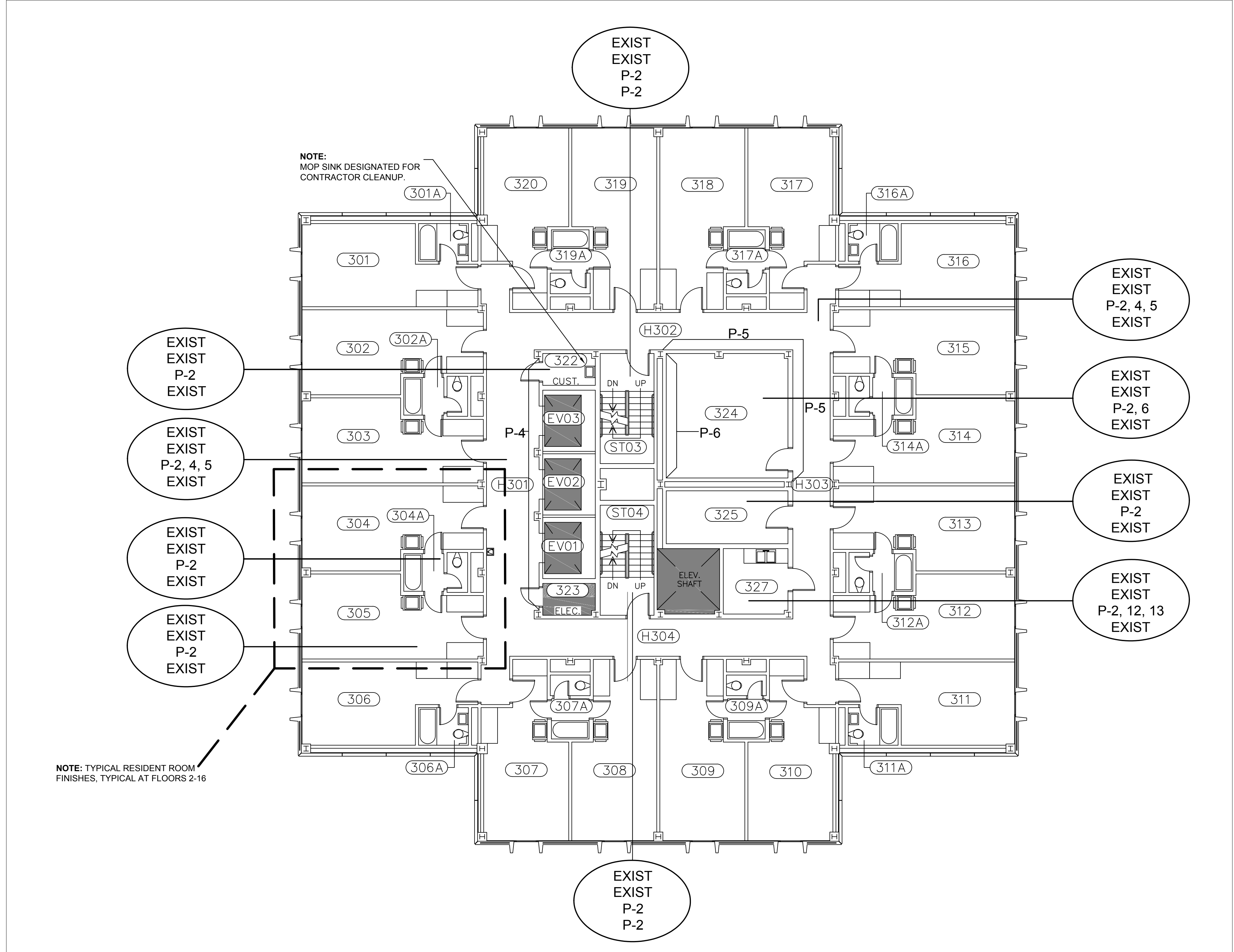

1 TYPICAL RESIDENTIAL FLOOR FINISH PLAN (FLOORS 3 - 16)
ID2.3

SCALE: 1/8" = 1'-0"

NOTE: FINISH PLANS CONTAIN INFORMATION FOR ENTIRE BUILDING FOR UNIVERSITY RECORDS. THE SCOPE OF THIS PROJECT IS FOR COMPREHENSIVE PAINTING ONLY.

NOTE: ALL FINISH DESIGNATIONS INDICATED ON THIS SHEET ARE TYPICAL FINISHES FLOORS 2-16.

NOTE: REMOVE WINDOW BLINDS FROM METAL WINDOW FRAMES ONLY. DO NOT REMOVE ANY BLINDS FROM SOFFIT OR WALLS.

***NOTE: CONTRACTOR TO FIELD VERIFY ALL MEASUREMENTS.

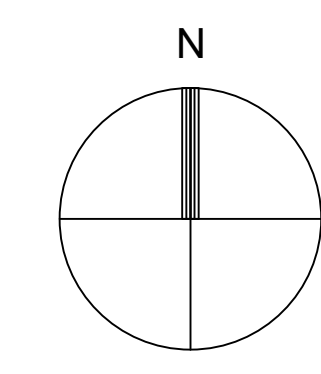

REVISIONS	
NO.	DESCRIPTION

DATE: 3-22-2018

ID2.3
TYP. RESIDENTIAL
FLOOR FINISH
PLAN FLOORS 3-16

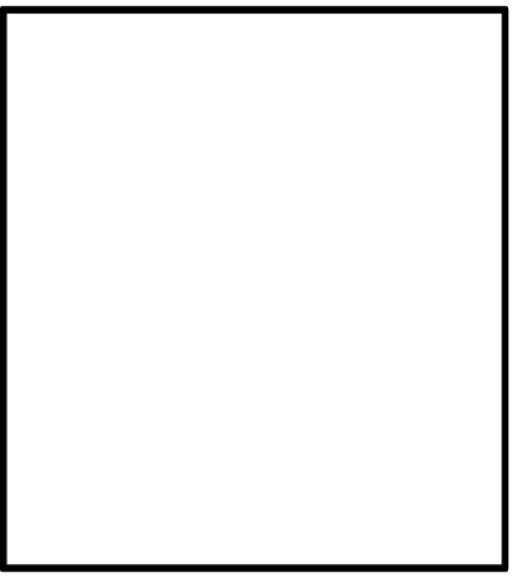

CAPSTONE
BUILDING #: 039



UNIVERSITY OF
SOUTH CAROLINA

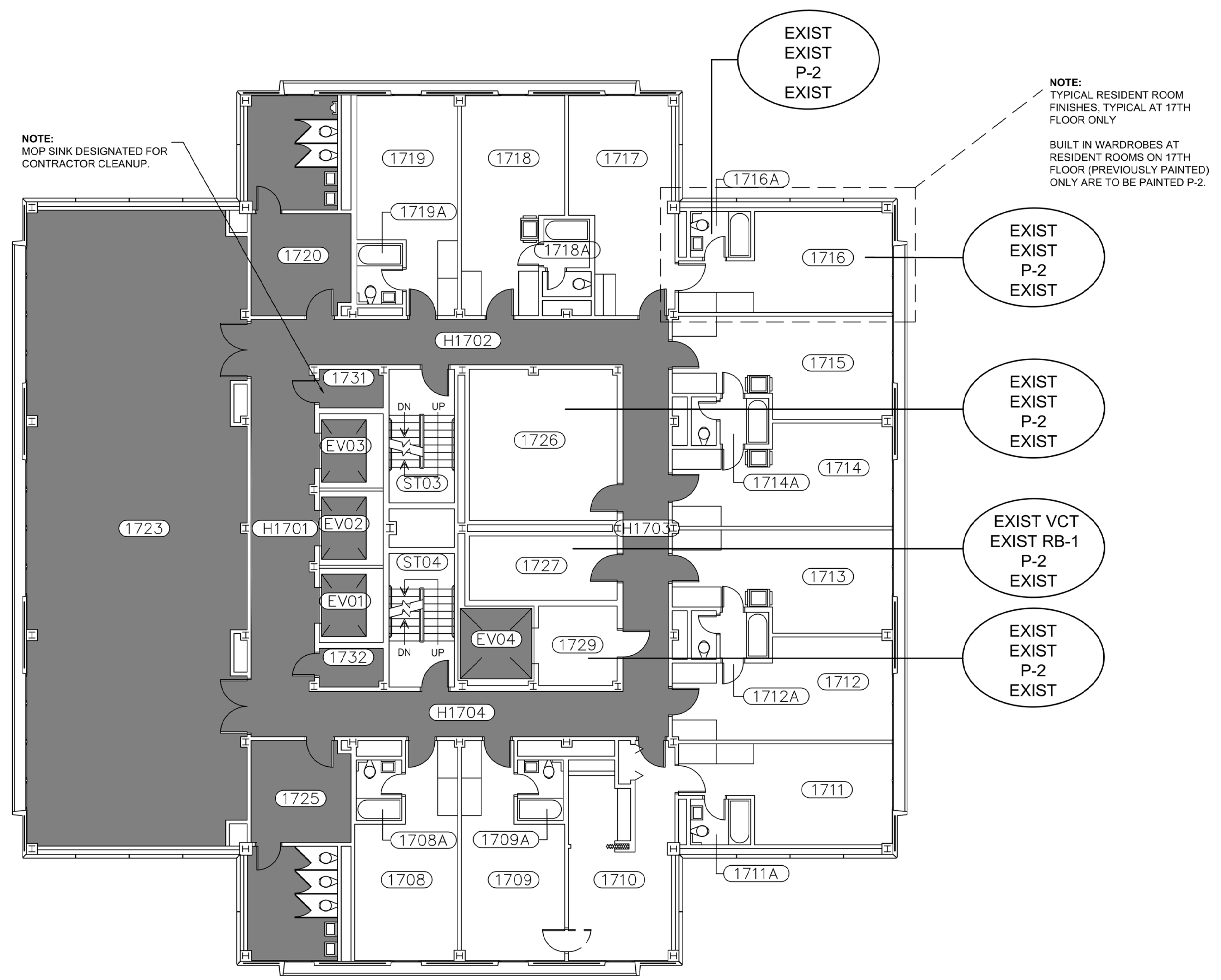

1
ID2.4 SEVENTEENTH FLOOR - FINISH PLAN

SCALE: 1/8" = 1'-0"

NOTE: FINISH PLANS CONTAIN INFORMATION FOR ENTIRE BUILDING FOR UNIVERSITY RECORDS.
THE SCOPE OF THIS PROJECT IS FOR COMPREHENSIVE PAINTING ONLY.

NOTE: REMOVE WINDOW BLINDS FROM METAL WINDOW FRAMES ONLY. DO NOT REMOVE ANY BLINDS FROM SOFFIT OR WALLS.

***NOTE: CONTRACTOR TO FIELD
VERIFY ALL MEASUREMENTS.

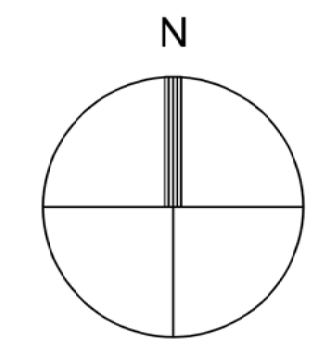

REVISIONS	
NO.	DESCRIPTION

DATE: 3-22-2018

ID2.4
17TH FLOOR
FINISH PLAN