

VICINITY MAP
NOT TO SCALE



INDEX OF DRAWINGS

CIVIL

- C1.1 EXISTING CONDITIONS AND DEMOLITION PLAN
- C2.1 OVERALL STAKING PLAN
- C2.2 STAKING PLAN / GRADING AND UTILITIES PLAN
- C3.1 SEDIMENT AND EROSION CONTROL PLAN
- C3.2 SEDIMENT AND EROSION CONTROL PLAN NOTES
- C4.1 MISC. DETAILS

LANDSCAPE

- L-1 DEMOLITION AND TREE PROTECTION PLAN
- L-2 LAYOUT PLAN
- L-3 PLANTING PLAN

UNIVERSITY OF SOUTH CAROLINA UNION - PATRON'S PARK RENOVATIONS

PROJECT NUMBER: H40-I305
UNION COUNTY, SC

NOVEMBER, 2017
CONTRACT DOCUMENTS

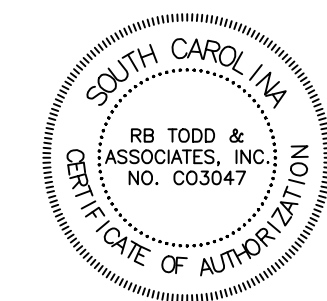

11/7/17

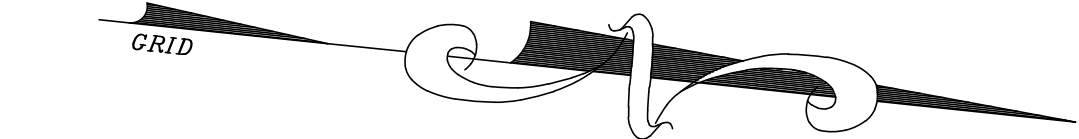

DRAWN BY	RPL
CHECKED BY	RBT
FILE:	17-573

OVERALL STAKING PLAN

PROJECT TITLE

**UNIVERSITY OF SOUTH CAROLINA
UNION PATRON'S PARK
RENOVATIONS**

A/E SEAL

A/E SEAL



11/7/17



A/E SEAL

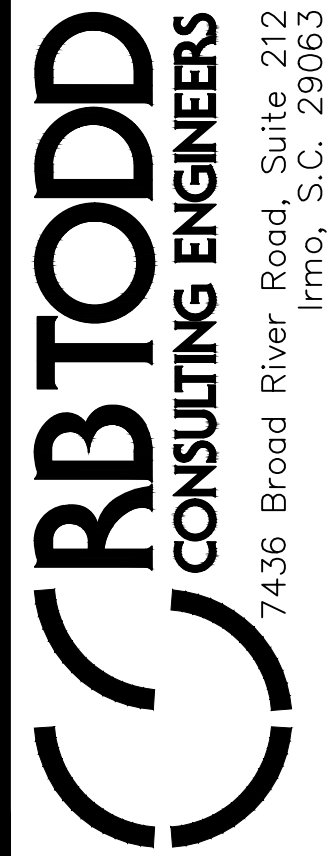

7436 Broad River Road, Suite 212
Irmo, S.C. 29063
Tel. 803.781.3141
Fax. 803.781.3142
www.rbtodd.com

www.rbtodd.com

S:\PROJECTS\17573 USC UNION PARK\DRAWINGS\CIVIL\171106\USC UNION PARK.DWG - 11/6/2017

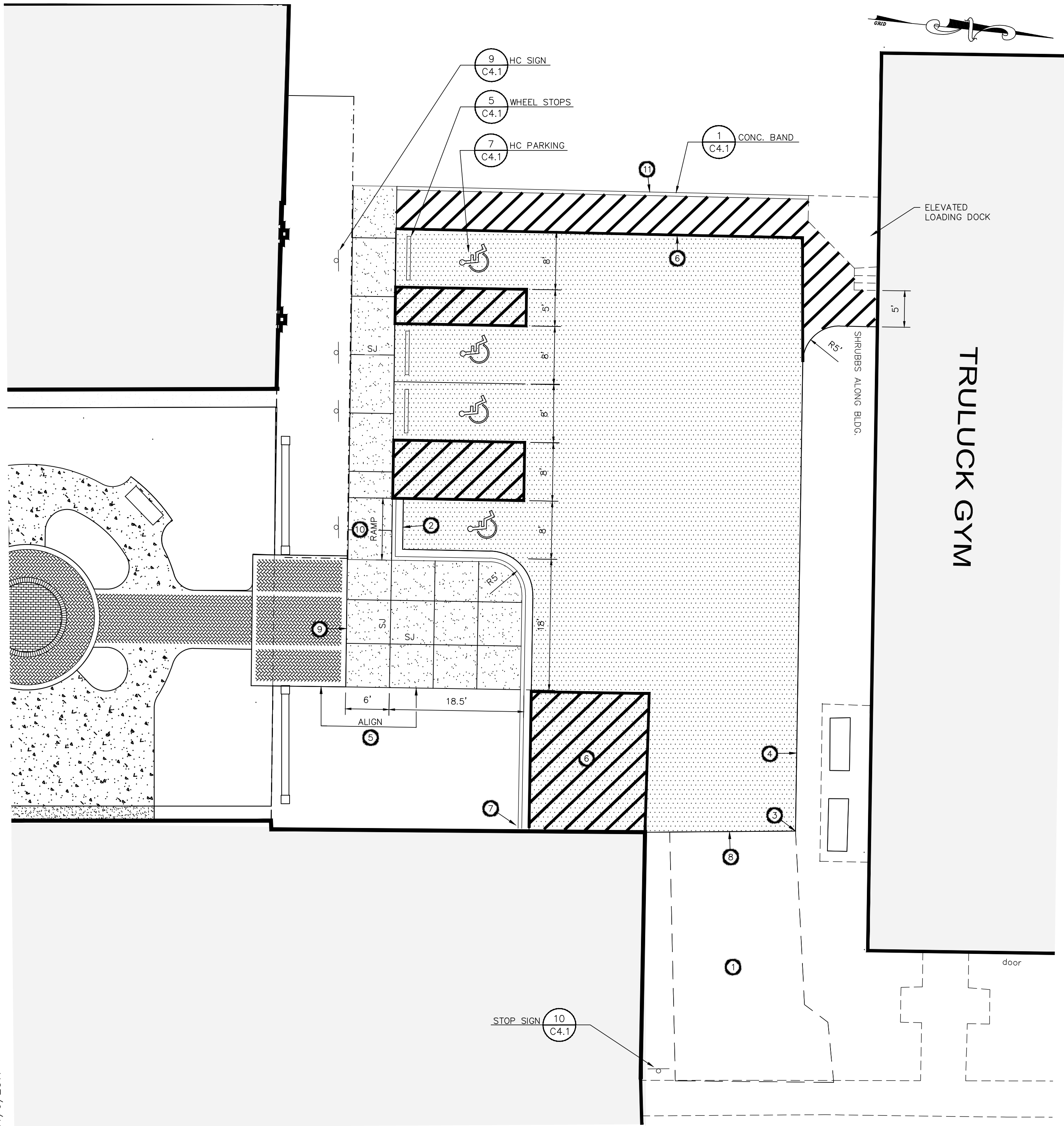

LEGEND		
NEW	EXISTING	DESCRIPTION
N/A	⊕	BENCHMARK/CONTROL POINT
N/A	⊗	BUILDING
N/A	⊙	LIGHT POLE
N/A	⊖	CURB AND GUTTER
N/A	⊘	CONCRETE SIDEWALK
N/A	⊙	LIGHT DUTY ASPHALT PAVEMENT
N/A	N/A	KEY NOTE REFERENCE

GENERAL NOTES

- SEE SHEET C1.1 FOR ADDITIONAL GENERAL NOTES.
- ALL DIMENSIONS AND COORDINATES ARE TO FACE OF BUILDING, FACE OF CURB OR EDGE OF PAVEMENT UNLESS OTHERWISE INDICATED.
- ALL PARKING LOT AND ROADWAY STRIPING SHOWN SHALL BE PERFORMED BY THE CONTRACTOR USING TRAFFIC MARKING PAINT. PAINT SHALL BE SHERWIN-WILLIAMS "PRO-MAR" TRAFFIC MARKING PAINT OR GLIDDEN TRAFFIC PAINT. PAINT SHALL BE APPLIED IN TWO COATS AND IN STRICT ACCORDANCE WITH THE MANUFACTURER'S INSTRUCTIONS. ALL PARKING LOT STRIPES TO BE 4" WIDE(BLUE). END ISLAND STRIPING TO BE 4" WIDE(YELLOW).
- THE CONTRACTOR SHALL NOTIFY THE ARCHITECT/ ENGINEER OF ANY DISCREPANCIES IN WRITING PRIOR TO CONSTRUCTION.

KEY NOTES

- CLEAN AND SEAL EXISTING ASPHALT DRIVEWAY BETWEEN SIDEWALK AND NEW PAVEMENT. APPLY GEMSEAL POLYTAR ASPHALT SEALANT AS PER MANUFACTURER'S RECOMMENDATIONS AT A MINIMUM ADD 3.5 LBS. OF MASONRY SAND PER GALLON OF SEALANT. ADD NO MORE THAN 20% OF WATER TO SEALANT. CLEAN EXISTING PAVEMENT AS PER MANUFACTURER'S RECOMMENDATIONS.
- TAPER CURB ALONG WIDTH OF HC PARKING SPACE ALONG RAMP.
- BEGIN INSTALLATION OF NEW ASPHALT PAVEMENT AT CORNER OF EXISTING SAWCUT CORNER. PLACE NEW PAVEMENT PARALLEL WITH EXISTING TRULUCK GYM.
- INSTALL 4" WIDE STRIPE (YELLOW) 4" FROM EDGE OF PAVEMENT. END AT EXISTING PAVEMENT LINE.
- ALIGN NEW CONCRETE PLAZA EDGE WITH EXITING PAVER EDGE.
- STRIPE AREA INDICATED WITH 4" WIDE STRIPES (YELLOW) AT 2' O.C./ 45 DEGREES.
- END CURB AND GUTTER AT FACE OF BUILDING.
- PLACE NEW ASPHALT FLUSH WITH EXISTING SAWCUT EDGE.
- POUR NEW CONCRETE FLUSH WITH EXISTING PAVERS.
- RAMP SIDEWALK FROM 0" TO 6" OVER 8' LENGTH ALONG HANDICAP SPACES. END CURB AND GUTTER.
- INSTALL CONCRETE BAND FROM END OF LANDING DOCK EDGE TO NEW SIDEWALK. INSTALL FLUSH WITH PAVEMENT.

GRAPHIC SCALE

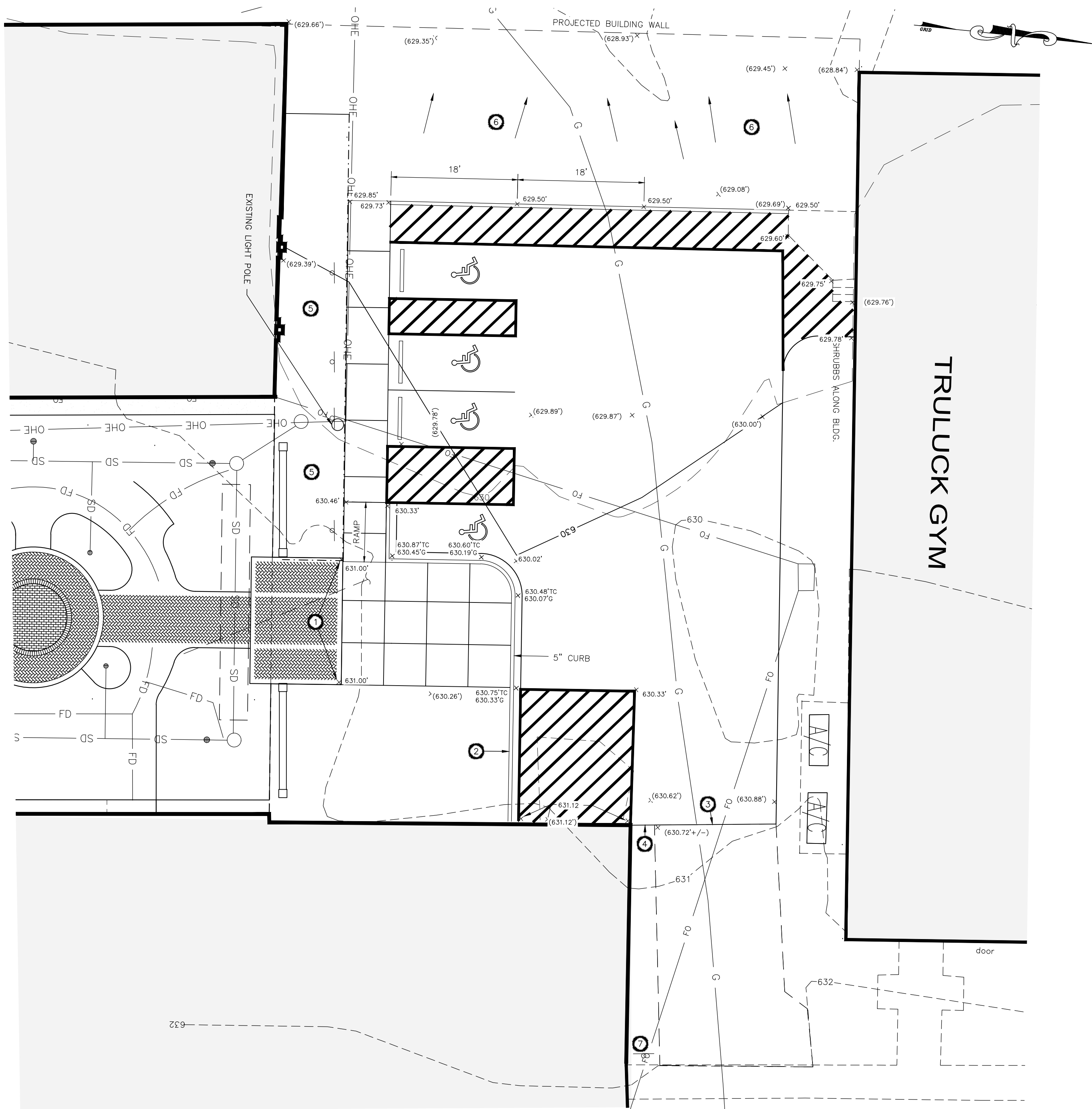
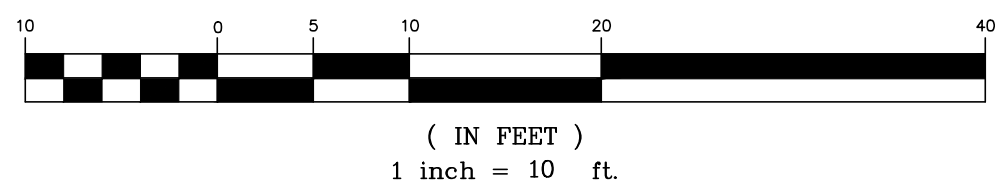

LEGEND		
NEW	EXISTING	DESCRIPTION
N/A	⊕	BENCHMARK/CONTROL POINT
N/A	⊗	PROPERTY LINE/RIGHT OF WAY
N/A	⊙	BUILDING
N/A	⊖	TREE
N/A	⊘	CONTOUR
N/A	⊙	SPOT ELEVATION
N/A	⊙	LIGHT POLE
N/A	N/A	KEY NOTE REFERENCE

KEY NOTES

- SPOT GRADE ELEVATIONS AT CORNER OF EXISTING PAD ARE DESIGN ELEVATIONS FROM RECENTLY COMPLETED COURTYARD IMPROVEMENTS. CONTRACTOR TO VERIFY ELEVATIONS PRIOR TO STARTING CONSTRUCTION.
- TAPER CURB FROM 5" HEIGHT STARTING AT CONCRETE PLAZA TO 0" AT FACE OF BUILDING. PLACE ASPHALT FLUSH WITH EXISTING SAWCUT EDGE.
- PLACE ASPHALT FLUSH WITH EXISTING SAWCUT EDGE.
- SLOPE ASPHALT FROM DOOR OPENING AT 631.12 TO EXISTING PAVEMENT EDGE AT 630.72.
- BACKFILL AREAS NEEDED FOR POSITIVE DRAINAGE.
- REMOVE VEGETATION BETWEEN END OF PAVEMENT AND PROJECTED BUILDING WALLS AND GRADE FOR POSITIVE DRAINAGE. SEE LANDSCAPE PLAN FOR GRASSING INFORMATION.
- IDENTIFY LOCATION OF FIBER OPTIC CABLE PRIOR TO INSTALLING STOP SIGN.

GRAPHIC SCALE

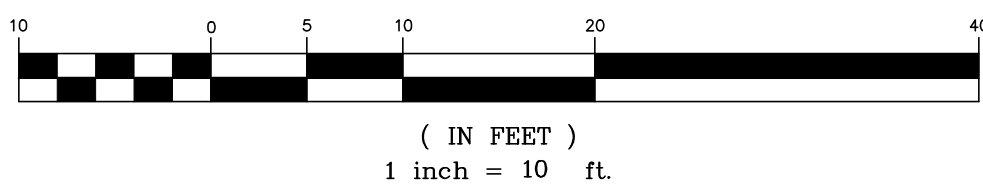

PROJECT NO.
H40-1505

DATE
6 OCT. 2017

DRAWN BY
RPL

CHECKED BY
RBT

FILE:
17-573

UNIVERSITY OF SOUTH CAROLINA
UNION PATRON'S PARK
RENOVATIONS

STAKING PLAN /
GRADING AND UTILITIES
PLAN

RB T TODD
CONSULTING ENGINEERS

7436 Broad River Road, Suite 212
Irmo, S.C. 29063
Tel. 803.781.3141
Fax. 803.781.3142
www.rb-todd.com

SOUTH CAROLINA
REGISTERED PROFESSIONAL ENGINEER
NO. 15960
R. B. TODD

11/7/17

A/E SEAL

A/E SEAL

DRAWING NO.
C2.2

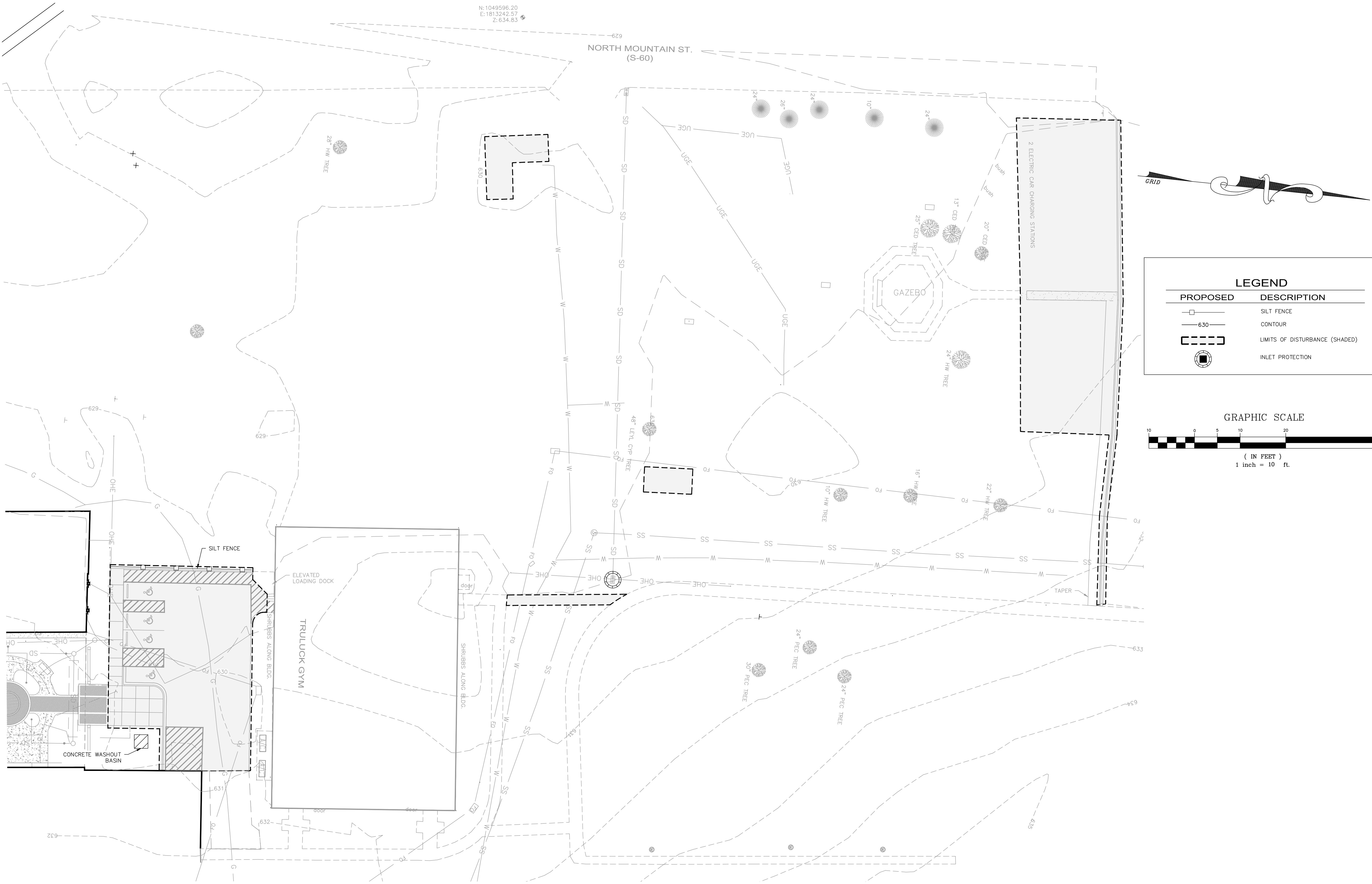

CONSTRUCTION SEQUENCE OF ENTIRE CONSTRUCTION AREA FOR EROSION AND SEDIMENT CONTROL

1. RECEIVE NPDES COVERAGE FROM DHEC
2. PRE-CONSTRUCTION MEETING (ON-SITE IF MORE THAN 10 DISTURBED AND NON-LINEAR)
3. NOTIFY DHEC EDC REGIONAL OFFICE OR CDM OFFICE 48 HOURS PRIOR TO BEGINNING LAND-DISTURBING ACTIVITIES
4. INSTALLATION OF CONSTRUCTION ENTRANCE(S)
5. CLEARING & GRUBBING ONLY AS NECESSARY FOR INSTALLATION OF PERIMETER CONTROLS
6. INSTALLATION OF PERIMETER CONTROLS (E.G., SILT FENCE)
7. CLEARING & GRUBBING OF SITE OR DEMOLITION (SEDIMENT & EROSION CONTROL MEASURES FOR THESE AREAS MUST ALREADY BE INSTALLED)
8. ROUGH GRADING
9. INSTALLATION OF UNDERGROUND DETENTION SYSTEMS, STORM DRAIN SYSTEM, AND PLACEMENT OF INLET PROTECTION AS EACH INLET IS INSTALLED
10. FINE GRADING, PAVING, ETC.
11. PERMANENT/FINAL STABILIZATION
12. REMOVAL OF TEMPORARY SEDIMENT & EROSION CONTROL MEASURES AFTER ENTIRE AREA DRAINING TO THE STRUCTURE IS FINALLY STABILIZED (THE DEPARTMENT RECOMMENDS THAT THE PROJECT OWNER/OPERATOR HAVE THE SWPPP PREPARER OR REGISTRATION EQUIVALENT APPROVE THE REMOVAL OF TEMPORARY STRUCTURES)
13. SUBMIT NOTICE OF TERMINATION (NOT) TO DHEC AS APPROPRIATE

AIRBORNE DUST CONTROL

THE CONTRACTOR SHALL IMPLEMENT DUST CONTROL MEASURES AS OUTLINED IN THE SOUTH CAROLINA DHEC STORMWATER MANAGEMENT BMP HANDBOOK AS NEEDED TO CONTROL AIRBORNE DUST DURING CONSTRUCTION. COORDINATE WITH ENGINEER PRIOR TO IMPLEMENTATION OF VARIOUS MEASURES.

PREDOMINANT SOIL TYPE

MADISON SANDY CLAY LOAM (McC2) -- CLASS B

GRASSING PER 1000 SQUARE FEET (TEMPORARY)

FROM MAY 1 TO AUGUST 30	FROM SEPTEMBER 1 TO APRIL 30
1 LB. BROWNTOP MILLET GRASS	6 LBS. ANNUAL RYEGRASS
15 LBS. 10-10-10 FERTILIZER	15 LBS. 10-10-10 FERTILIZER
5 LBS. MAGNESIUM SULFATE	5 LBS. MAGNESIUM SULFATE
10 LBS. CALCIUM (GYPSUM)	10 LBS. CALCIUM (GYPSUM)

GRASS INFORMATION (PERMANENT)

SEE LANDSCAPE PLANS

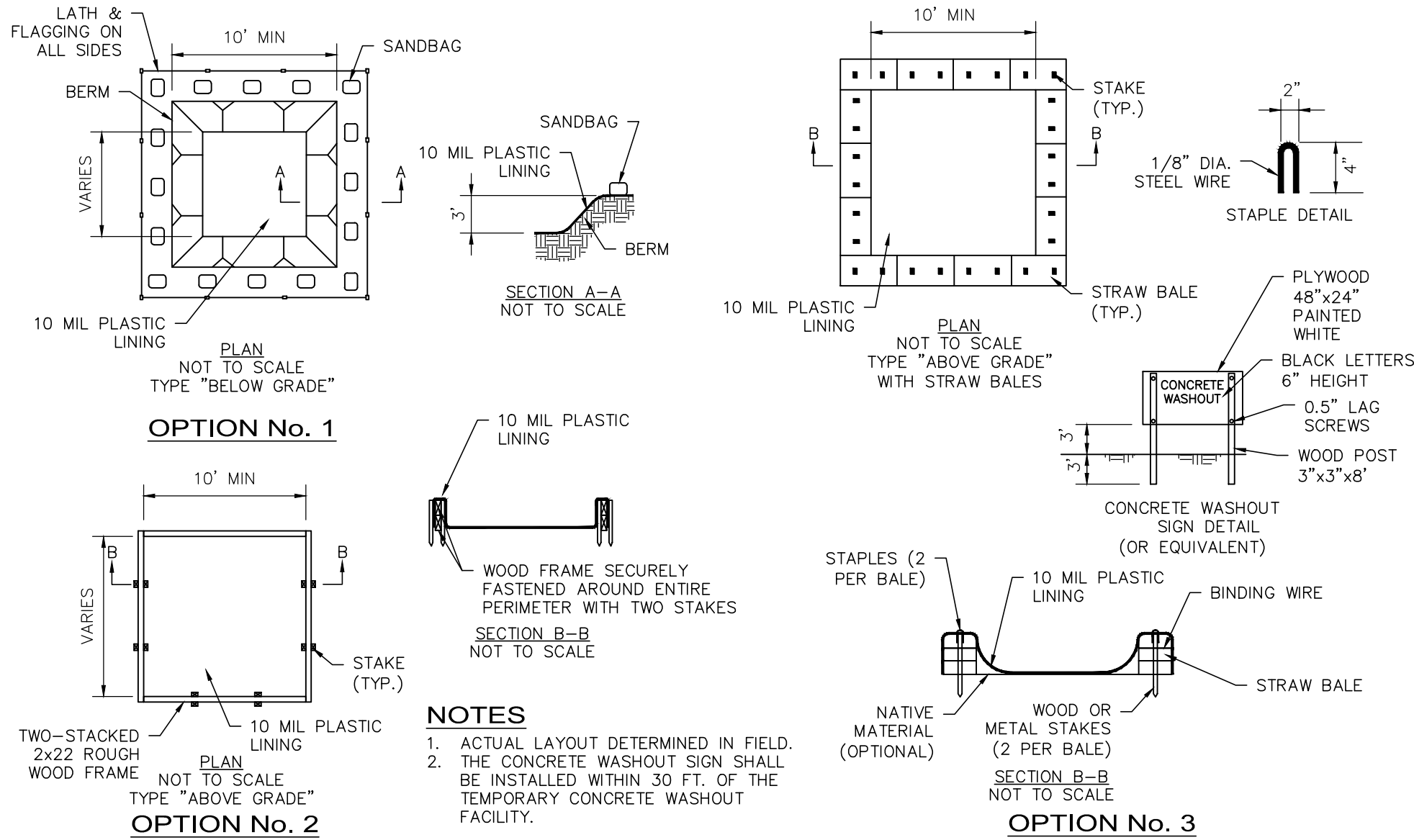
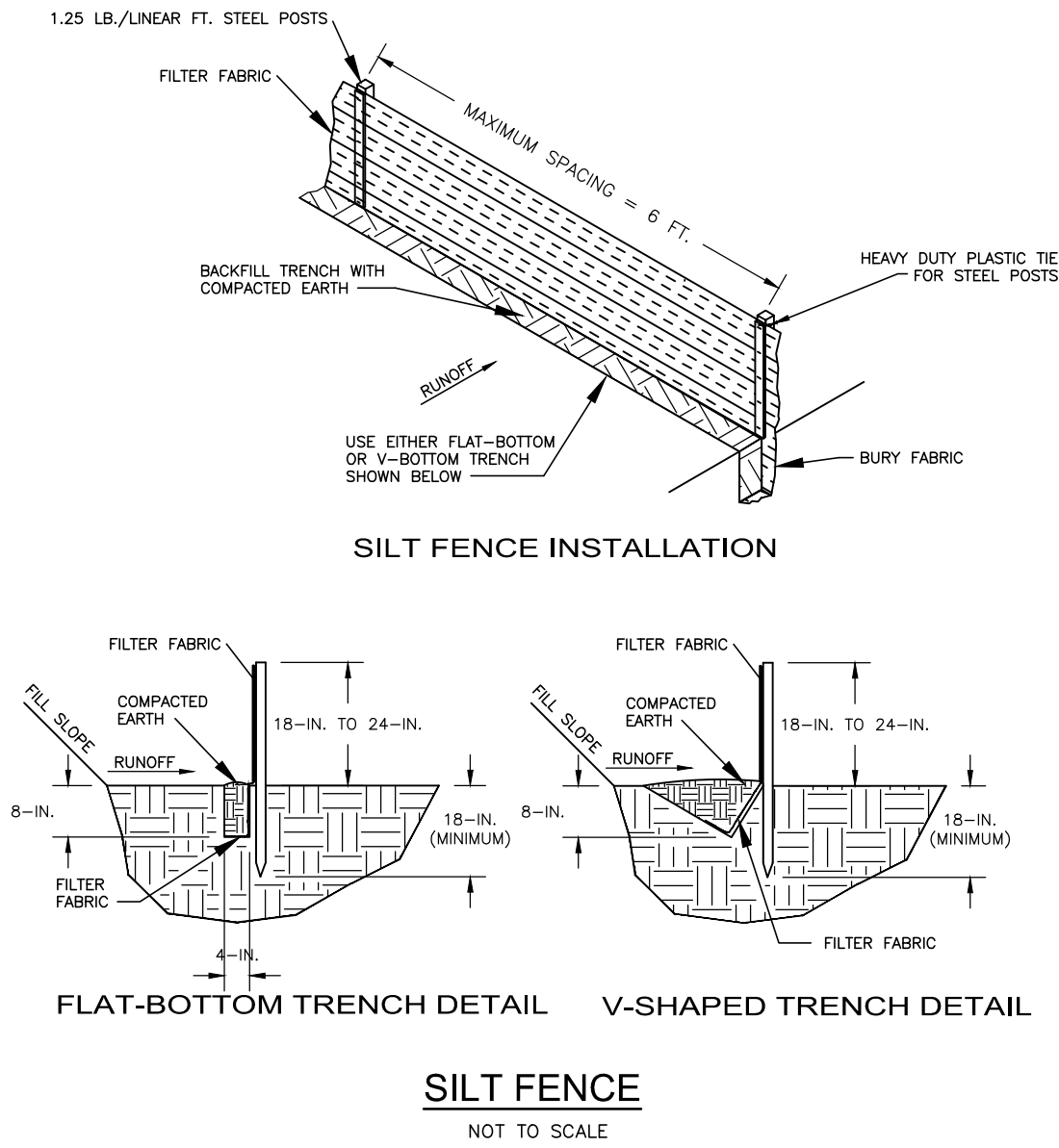

CONCRETE WASHOUT

SEDIMENT AND EROSION CONTROL NOTES

1. THE CONTRACTOR SHALL PROVIDE AND MAINTAIN THROUGHOUT THE LENGTH OF CONSTRUCTION SILT FENCES AT ALL STORM DRAINAGE STRUCTURES AND ALONG THE PERIMETER OF CONSTRUCTION AS NECESSARY TO CONTAIN ALL SEDIMENT RUNOFF WITHIN THE AREAS DISTURBED BY CONSTRUCTION.
2. STABILIZATION MEASURES SHALL BE INITIATED AS SOON AS PRACTICABLE IN PORTIONS OF THE SITE WHERE CONSTRUCTION ACTIVITIES HAVE TEMPORARILY OR PERMANENTLY CEASED, BUT IN NO CASE MORE THAN FOURTEEN (14) DAYS AFTER WORK HAS CEASED EXCEPT AS STATED BELOW.
 - > WHERE STABILIZATION BY THE 14th DAY IS PRECLUDED BY SNOW COVER OR FROZEN GROUND CONDITIONS, STABILIZATION MEASURES MUST BE INITIATED AS SOON AS PRACTICABLE.
 - > WHERE CONSTRUCTION ACTIVITY ON A PORTION OF THE SITE IS TEMPORARILY CEASED, AND EARTH-DISTURBING ACTIVITIES WILL BE RESUMED WITHIN 14 DAYS, TEMPORARY STABILIZATION MEASURES DO NOT HAVE TO BE INITIATED ON THAT PORTION OF THE SITE.
3. ALL SEDIMENT AND EROSION CONTROL DEVICES SHALL BE INSPECTED AT LEAST ONCE EVERY CALENDAR WEEK. IF PERIODIC INSPECTION OR OTHER INFORMATION INDICATES THAT A BMP HAS BEEN INAPPROPRIATELY OR INCORRECTLY INSTALLED, THE PERMITEE MUST ADDRESS THE NECESSARY REPLACEMENT OR MODIFICATION REQUIRED TO CORRECT THE BMP WITHIN 48 HOURS OR IDENTIFICATION.
4. SEDIMENT DEPOSITS SHOULD BE REMOVED WHEN THEY REACH ONE-THIRD THE HEIGHT OF THE SEDIMENT FENCE.
5. THE CONTRACTOR SHALL BE RESPONSIBLE FOR STABILIZING ALL SLOPES FROM FINISH GRADE TO NATURAL GROUND AND FOR PREVENTING EXCESSIVE EROSION FROM OCCURRING. IMMEDIATELY AFTER ESTABLISHING THE INTERMEDIATE ROUGH GRADE SLOPES AND AFTER REACHING THE FINAL GRADE SLOPES, THE CONTRACTOR SHALL PROVIDE GRASSING OF THESE SLOPES. WHEN SLOPES ARE DISTURBED BY SUBSEQUENT EXCAVATIONS FOR OTHER ITEMS, THE CONTRACTOR SHALL INSPECT THE REPAIRS AND CORRECT ANY DEFICIENCIES IN THE REPAIRS.
6. ALL GRADING WORK SHALL CONFORM SUBSTANTIALLY WITH THE GRADING PLANS. WHERE SPOT GRADES ARE INDICATED ON THE PLANS, THEY SHALL BE ESTABLISHED BY SCALING AND SHALL TAKE PRECEDENCE OVER CONTOURS. ALL GRADING BETWEEN SPOT GRADES SHALL BE SMOOTH AND UNIFORM.
7. THE CONTRACTOR SHALL ADEQUATELY COORDINATE THE INSTALLATION OF THE STORM DRAINAGE SYSTEM TO ENSURE THAT POSITIVE RUNOFF OF STORMWATER IS EFFECTED BOTH DURING CONSTRUCTION AND AFTER COMPLETION OF THE WORK.
8. IF NECESSARY, SLOPES WHICH EXCEED 8 VERTICAL FEET SHOULD BE STABILIZED WITH SYNTHETIC OR VEGETATIVE MATS. IN ADDITION TO HYDROSEEDING IT MAY BE NECESSARY TO INSTALL TEMPORARY SLOPE DRAINS DURING CONSTRUCTION. TEMPORARY BERMS MAY BE NEEDED UNTIL THE SLOPE IS BROUGHT TO GRADE.
9. PROVIDE SILT FENCE AND/OR OTHER CONTROL DEVICES, AS MAY BE REQUIRED, TO CONTROL SOIL EROSION DURING UTILITY CONSTRUCTION. ALL DISTURBED AREAS SHALL BE DRAINED, GRADED, AND STABILIZED WITH GRASS IMMEDIATELY AFTER THE UTILITY INSTALLATION. COVER, AND TEMPORARY SEEDING AT THE END OF EACH DAY ARE RECOMMENDED. IF WATER IS ENCOUNTERED WHILE TRENCHING, THE WATER SHOULD BE FILTERED TO REMOVE ANY SEDIMENTS BEFORE BEING PUMPED BACK INTO ANY WATERS OF THE STATE.
10. THE CONTRACTOR MUST TAKE NECESSARY ACTION TO MINIMIZE TRACKING OF MUD ONTO PAVED ROADWAY FROM CONSTRUCTION AREAS AND GENERATION OF DUST.
11. ALL EROSION CONTROL DEVICES SHALL BE PROPERLY MAINTAINED DURING ALL PHASES OF CONSTRUCTION UNTIL THE COMPLETION OF ALL CONSTRUCTION ACTIVITIES AND ALL DISTURBED AREAS HAVE BEEN STABILIZED. ADDITIONAL CONTROL DEVICES MAY BE REQUIRED DURING CONSTRUCTION IN ORDER TO CONTROL EROSION AND/OR OFFSITE SEDIMENTATION. ALL TEMPORARY CONTROL DEVICES SHALL BE REMOVED ONCE CONSTRUCTION IS COMPLETE AND THE SITE IS STABILIZED.
12. TEMPORARY DIVERSION BERMS AND/OR DITCHES SHALL BE PROVIDED AS NEEDED DURING CONSTRUCTION TO PROTECT WORK AREAS FROM UPSLOPE RUNOFF AND/OR DIVERT SEDIMENT-LADEN WATER TO APPROPRIATE TRAPS OR STABLE OUTLETS.
13. ALL WATERS OF THE STATE (WOS), INCLUDING WETLANDS, ARE TO BE FLAGGED OR OTHERWISE CLEARLY MARKED IN THE FIELD. A DOUBLE ROW OF SILT FENCE IS TO BE INSTALLED IN ALL AREAS WHERE A 50-FOOT BUFFER CANNOT BE MAINTAINED BETWEEN THE DISTURBED AREAS AND ALL WOS. A 10-FOOT BUFFER SHOULD BE MAINTAINED BETWEEN THE LAST ROW OF SILT FENCE AND ALL WOS.
14. LITTER, CONSTRUCTION DEBRIS, OILS, FUELS, BUILDING PRODUCTS WITH SIGNIFICANT POTENTIAL FOR IMPACT (SUCH AS STOCKPILES OF FRESHLY TREATED LUMBER), AND CONSTRUCTION CHEMICALS THAT COULD BE EXPOSED TO STORMWATER MUST BE PREVENTED FROM BECOMING A POLLUTANT SOURCE IN STORMWATER DISCHARGES.
15. A COPY OF THE SWPPP, INSPECTIONS RECORDS, AND RAINFALL DATA MUST BE RETAINED AT THE CONSTRUCTION SITE OR A NEARBY LOCATION EASILY ACCESSIBLE DURING NORMAL BUSINESS HOURS, FROM THE DATE OF COMMENCEMENT OF CONSTRUCTION ACTIVITIES TO THE DATE THAT FINAL STABILIZATION IS REACHED.
16. INITIATE STABILIZATION MEASURES ON ANY EXPOSED STEEP SLOPE (3H:1V OR GREATER) WHERE LAND-DISTURBING ACTIVITIES HAVE
17. MINIMIZE SOIL COMPACTION AND, UNLESS INFEASIBLE, PRESERVE TOPSOIL.
18. MINIMIZE DISCHARGE OF POLLUTANTS FROM EQUIPMENT AND VEHICLE WASHING, WHEEL WASH WATER, AND OTHER WASH WATERS. WASH WATERS MUST BE TREATED IN A SEDIMENT BASIN OR ALTERNATIVE CONTROL THAT PROVIDES EQUIVALENT OR BETTER TREATMENT PRIOR TO DISCHARGE.
19. MINIMIZE THE DISCHARGE OF POLLUTANTS FROM DEWATERING OF TRENCHES AND EXCAVATED AREAS. THESE DISCHARGES ARE TO BE ROUTED THROUGH APPROPRIATE BMPs (SEDIMENT BASIN, FILTER BAG, ETC.).
20. THE FOLLOWING DISCHARGES FROM SITES ARE PROHIBITED:
 - WASTEWATER FROM WASHOUT OF CONCRETE, UNLESS MANAGED BY AN APPROPRIATE CONTROL;
 - WASTEWATER FROM WASHOUT AND CLEANOUT OF STUCCO, PAINT, FROM RELEASE OILS, CURING COMPOUNDS AND OTHER CONSTRUCTION MATERIALS;
 - FUELS, OILS, OR OTHER POLLUTANTS USED IN VEHICLE AND EQUIPMENT OPERATION AND MAINTENANCE; AND
 - SOAPS OR SOLVENTS USED IN VEHICLE AND EQUIPMENT WASHING.
21. AFTER CONSTRUCTION ACTIVITIES BEGIN, INSPECTIONS MUST BE CONDUCTED AT A MINIMUM OF AT LEAST ONCE EVERY CALENDAR WEEK AND MUST BE CONDUCTED UNTIL FINAL STABILIZATION IS REACHED ON ALL AREAS OF THE CONSTRUCTION SITE.
22. IF EXISTING BMPs NEED TO BE MODIFIED OR IF ADDITIONAL BMPs ARE NECESSARY TO COMPLY WITH THE REQUIREMENTS OF THIS PERMIT AND/OR SC's WATER QUALITY STANDARDS, IMPLEMENTATION MUST BE COMPLETED BEFORE THE NEXT STORM EVENT WHENEVER PRACTICAL. IF IMPLEMENTATION BEFORE THE NEXT STORM EVENT IS IMPRACTICABLE, THE SITUATION MUST BE DOCUMENTED IN THE SWPPP AND ALTERNATIVE BMPs MUST BE IMPLEMENTED AS SOON AS REASONABLY POSSIBLE.
23. A PRE-CONSTRUCTION CONFERENCE MUST BE HELD FOR EACH CONSTRUCTION SITE WITH AN APPROVED ON-SITE SWPPP PRIOR TO THE IMPLEMENTATION OF CONSTRUCTION ACTIVITIES. FOR NON-LINEAR PROJECTS THAT DISTURB 10 ACRES OR MORE THIS CONFERENCE MUST BE HELD ON-SITE UNLESS THE DEPARTMENT HAS APPROVED OTHERWISE.
24. RESIDENTIAL SUBDIVISIONS REQUIRE EROSION CONTROL FEATURES FOR INFRASTRUCTURE AS WELL AS FOR INDIVIDUAL LOT CONSTRUCTION. INDIVIDUAL PROPERTY OWNERS SHALL FOLLOW THESE PLANS DURING CONSTRUCTION OR OBTAIN APPROVAL OF AN INDIVIDUAL PLAN IN ACCORDANCE WITH S.C. REG. 72-300 ET SEQ AND SCR100000.

EROSION AND SEDIMENT CONTROL MEASURES

GENERAL

THE CONTRACTOR IS ADVISED THAT ALL GRADING AND DRAINAGE WORK ON THE PROJECT IS PERMITTED UNDER THE REQUIREMENTS OF THE SOUTH CAROLINA DEPARTMENT OF HEALTH AND ENVIRONMENTAL CONTROL, DIVISION OF STORMWATER MANAGEMENT. COMPLIANCE WITH THE PERMITTED CONDITIONS IS MANDATORY. THE CONTRACTOR SHALL RELY ON EXPERIENCE AND CONTROL OF THE WORK TO PROVIDE ADEQUATE AND ORDERLY CONSTRUCTION METHODS TO CONTROL STORMWATER RUNOFF AND PREVENT THE EXCESSIVE MIGRATION OF SEDIMENTS FROM THE SITE. THE CONTRACTOR ALSO SHALL DIRECT INSTALLATION OF NECESSARY TEMPORARY CONSTRUCTION MEASURES TO CONTROL STORMWATER RUNOFF. ALL STORMWATER MANAGEMENT MEASURES SHALL BE INSPECTED AFTER EACH RAIN EVENT AND ANY REQUIRED MAINTENANCE SHALL BE PERFORMED.

SILT FENCES

SILT FENCES OR EQUIVALENT SEDIMENT CONTROL SHALL BE INSTALLED WHERE INDICATED AND MAINTAINED IN ACCORDANCE WITH THIS PLAN.

STORM DRAINAGE STRUCTURES

TEMPORARY BARRIERS OF EITHER SILT FENCING OR ROCK RIPRAP SHALL BE INSTALLED AND MAINTAINED AROUND STORM DRAINAGE STRUCTURES UNTIL THEIR DRAINAGE AREA IS STABILIZED. STORM DRAINAGE PIPES, INCLUDING OUTLET PROTECTION, SHALL BE INSTALLED AS SOON AS EARTH GRADING IS ADEQUATE TO ACCEPT PIPE INSTALLATION. INLET STRUCTURES SHALL BE CONSTRUCTED AS THE EARTHFILL IS PLACED AND CONSTRUCTION SHALL AT ALL TIMES PROVIDE SURFACE DRAINAGE TO THEM. TEMPORARY BARRIERS SHALL BE INSTALLED AND MAINTAINED AT EACH INLET AS THE EARTH FILL RISES.

STABILIZATION OF DISTURBED AREAS

DISTURBED AREAS SHALL RECEIVE STABILIZING MEASURES WITHIN 14 DAYS AFTER DISTURBANCES, UNLESS CONSTRUCTION WILL RESUME IN THAT AREA WITHIN 21 DAYS FROM WHEN ACTIVITIES CEASED.

INSPECTION AND MAINTENANCE

SEDIMENT CONTROL SYSTEMS SHALL BE INSPECTED AT LEAST WEEKLY AND AFTER ANY RAINFALL EVENT EXCEEDING 0.5 INCH. ANY NEEDED CORRECTIONS OR MAINTENANCE SHALL BE ACCOMPLISHED IMMEDIATELY THEREAFTER.

REMOVAL OF SEDIMENT CONTROL SYSTEMS

TEMPORARY EROSION CONTROL MEASURES SHALL BE REMOVED AFTER EACH AFFECTED AREA HAS BEEN "FINALLY STABILIZED".

TEMPORARY DIVERSIONS

TEMPORARY DIVERSION BERMS AND/OR DITCHES WILL BE PROVIDED AS NEEDED DURING CONSTRUCTION TO PROTECT WORK AREAS FROM UPSLOPE RUNOFF AND/OR DIVERT SEDIMENT LADEN WATER TO APPROPRIATE TRAPS OR STABLE OUTLETS.

TEMPORARY DIVERSIONS SHALL BE CONSTRUCTED AS NECESSARY TO PREVENT FLOW OF STORMWATER OVER DISTURBED AREA. TEMPORARY DIVERSION OUTLETS SHALL HAVE ADEQUATE CAPACITY AND TERMINATE INTO DENSE VEGETATION, ROCK RIP RAP, STORM STRUCTURES OR SIMILAR MEASURES TO REDUCE EROSION AT THE OUTLET. TEMPORARY DIVERSION CHANNELS SHALL BE CONSTRUCTED AND MAINTAINED AT A MINIMUM OF 1 PERCENT GRADE AND A MAXIMUM GRADE OF 2 PERCENT. THE CAPACITY OF TEMPORARY DIVERSIONS SHALL BE RESTORED ANYTIME THE EXCAVATED CHANNEL BECOMES FULL OF SEDIMENT AT ANY POINT IN THE LENGTH OF THE DIVERSION. THE RIDGE AND CHANNEL OF THE TEMPORARY DIVERSIONS SHALL BE STABILIZED WITH TEMPORARY VEGETATION IMMEDIATELY AFTER CONSTRUCTION AND RE-STABILIZED AFTER EACH DISTURBANCE.

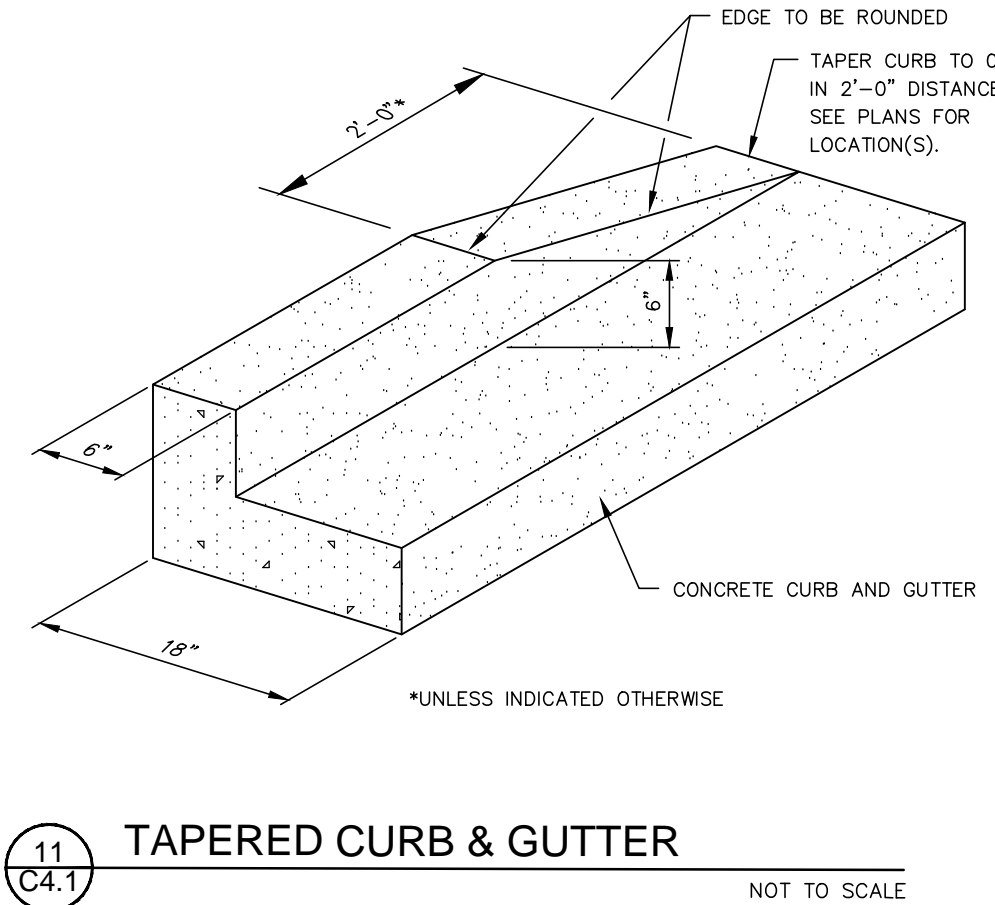
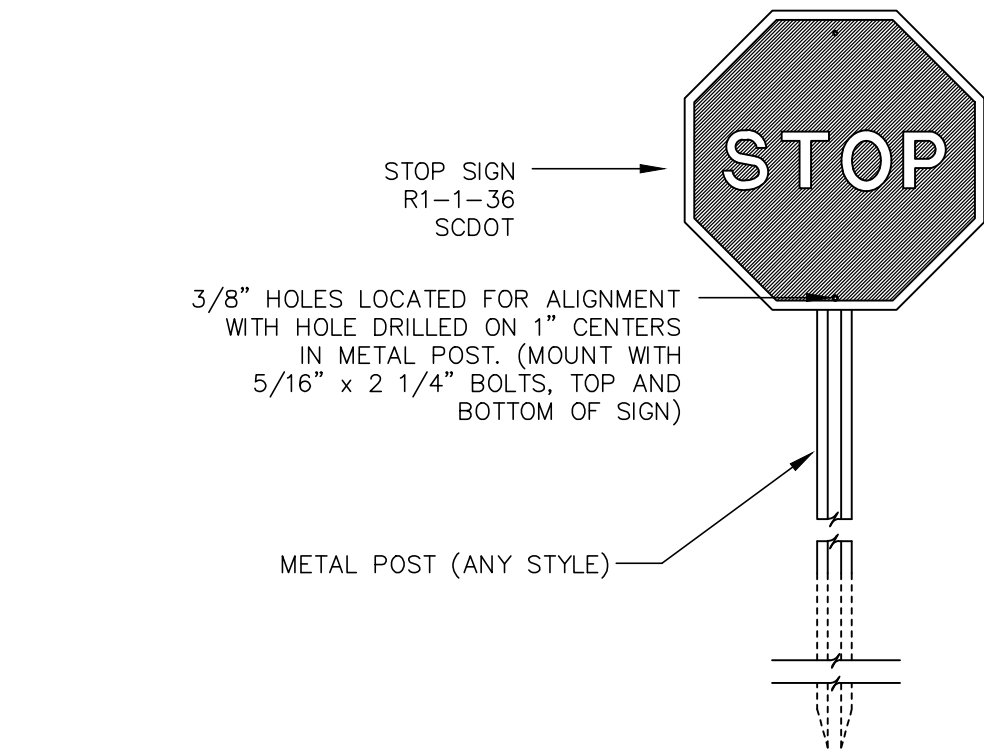
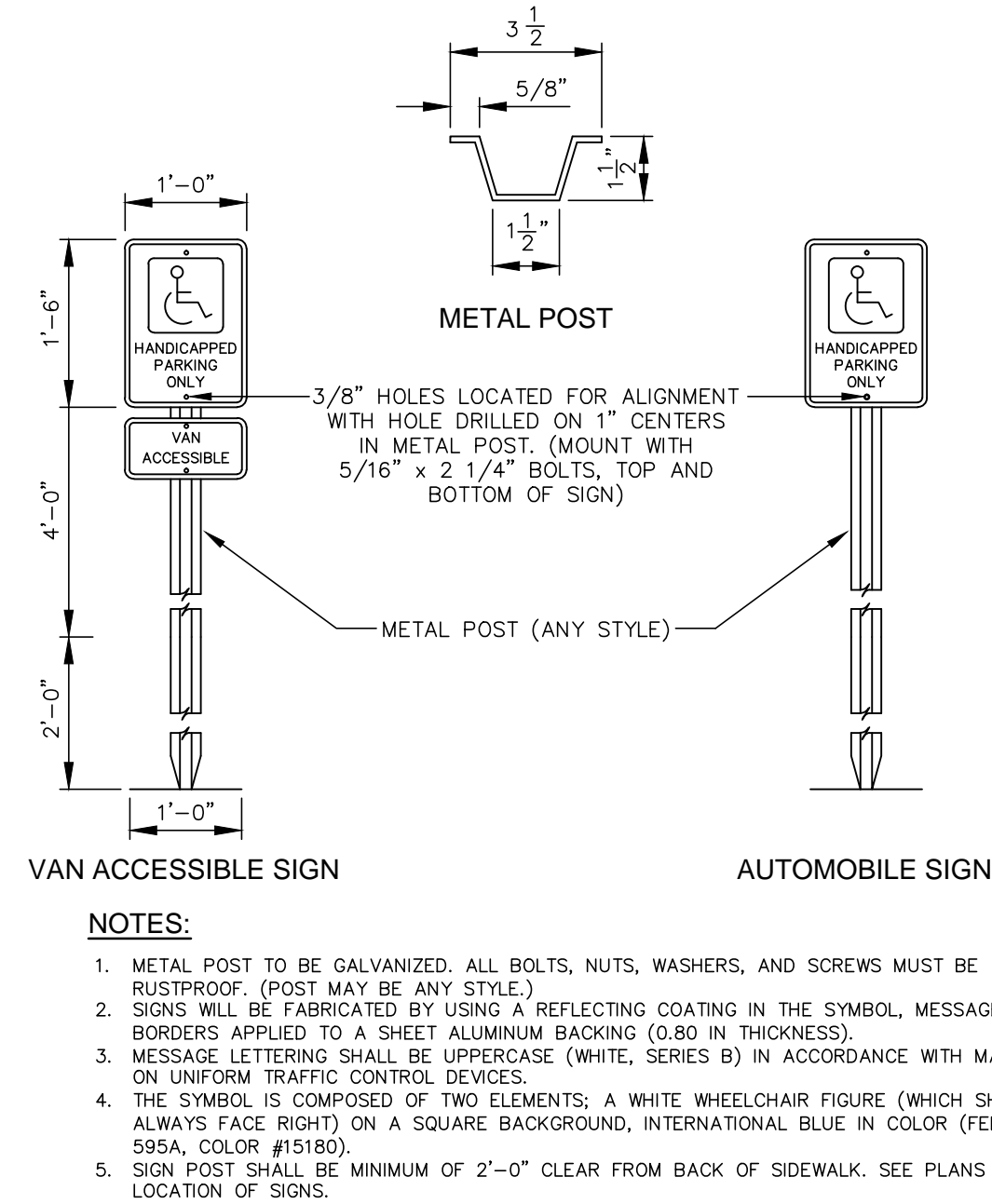
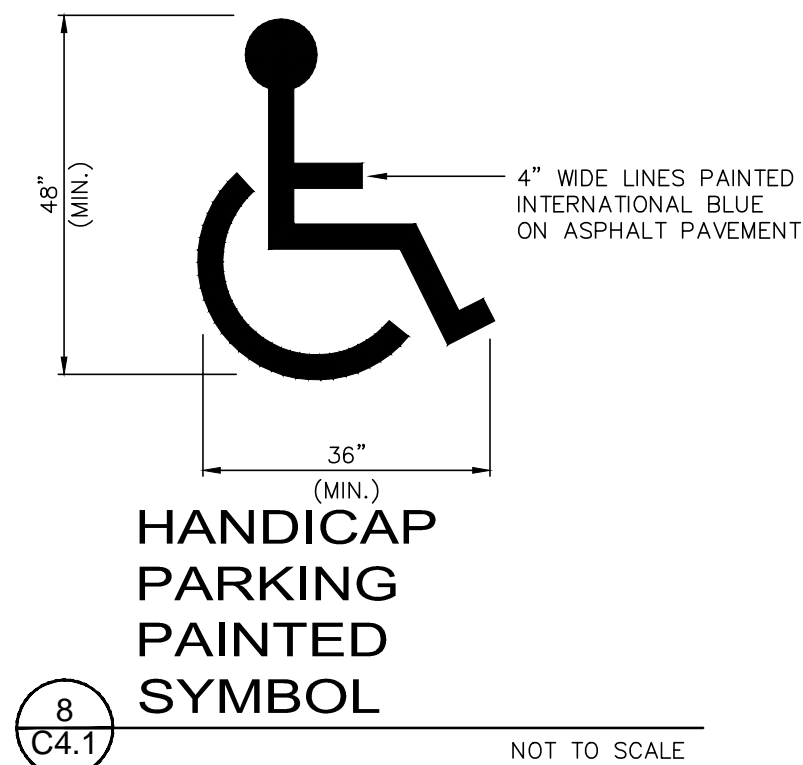
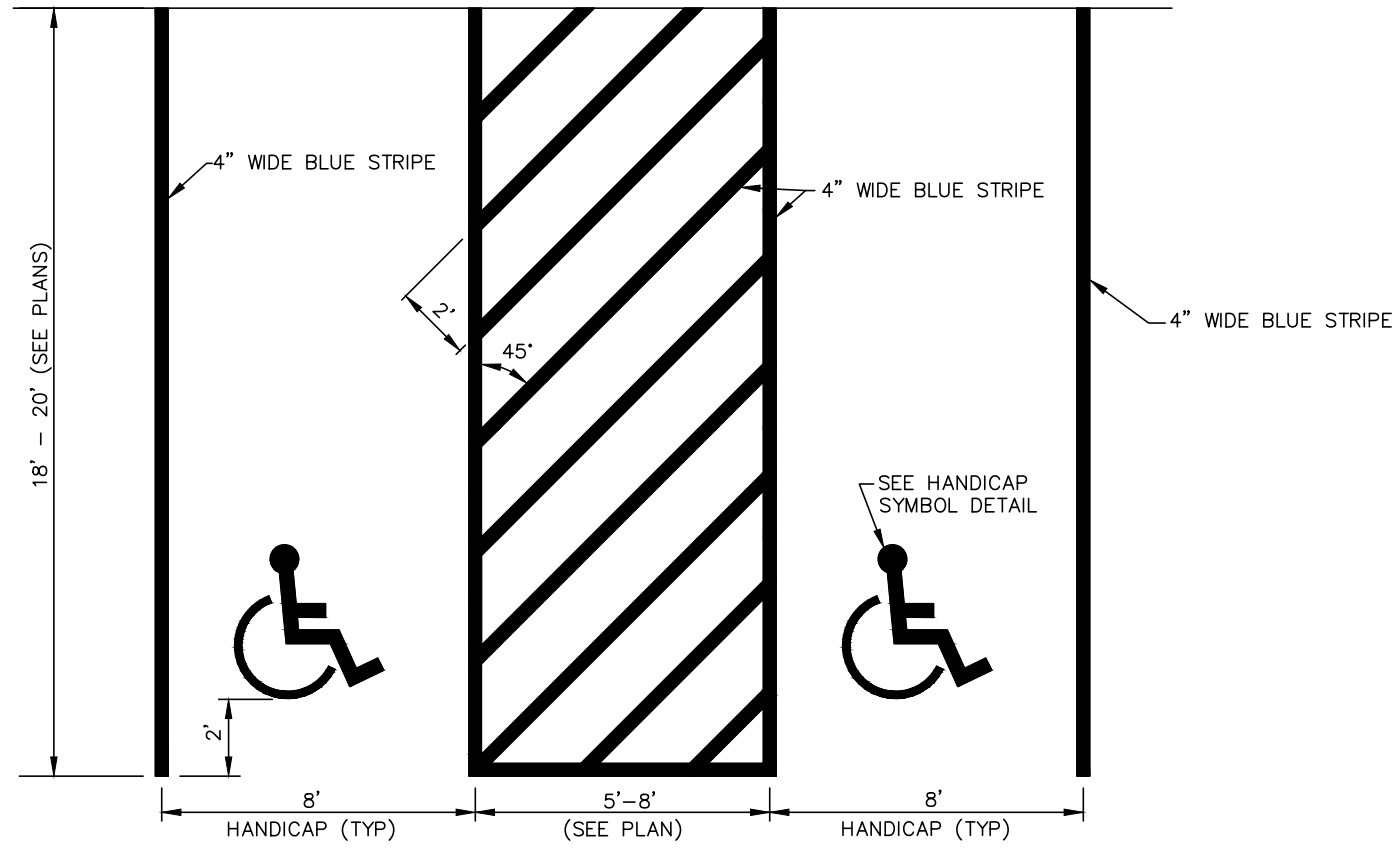
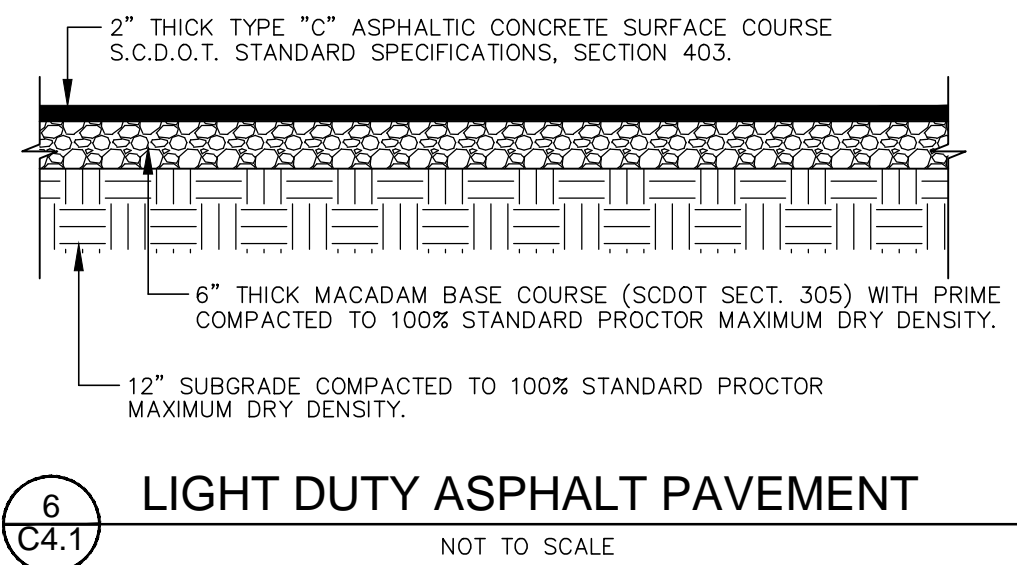
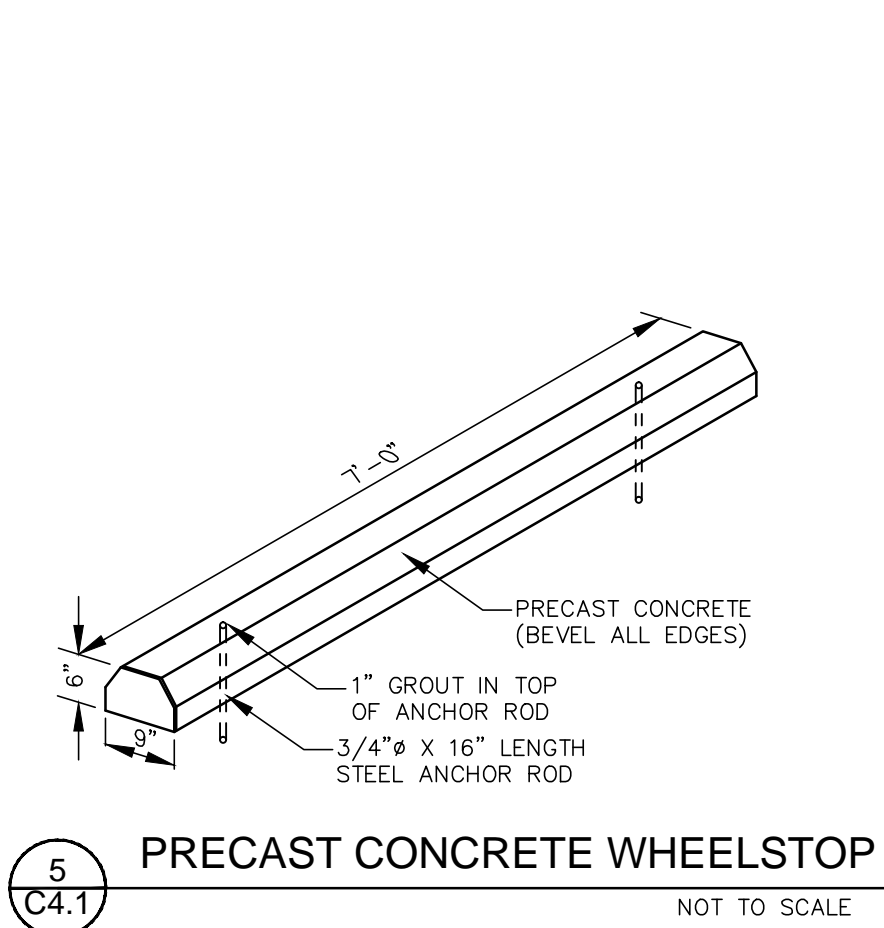
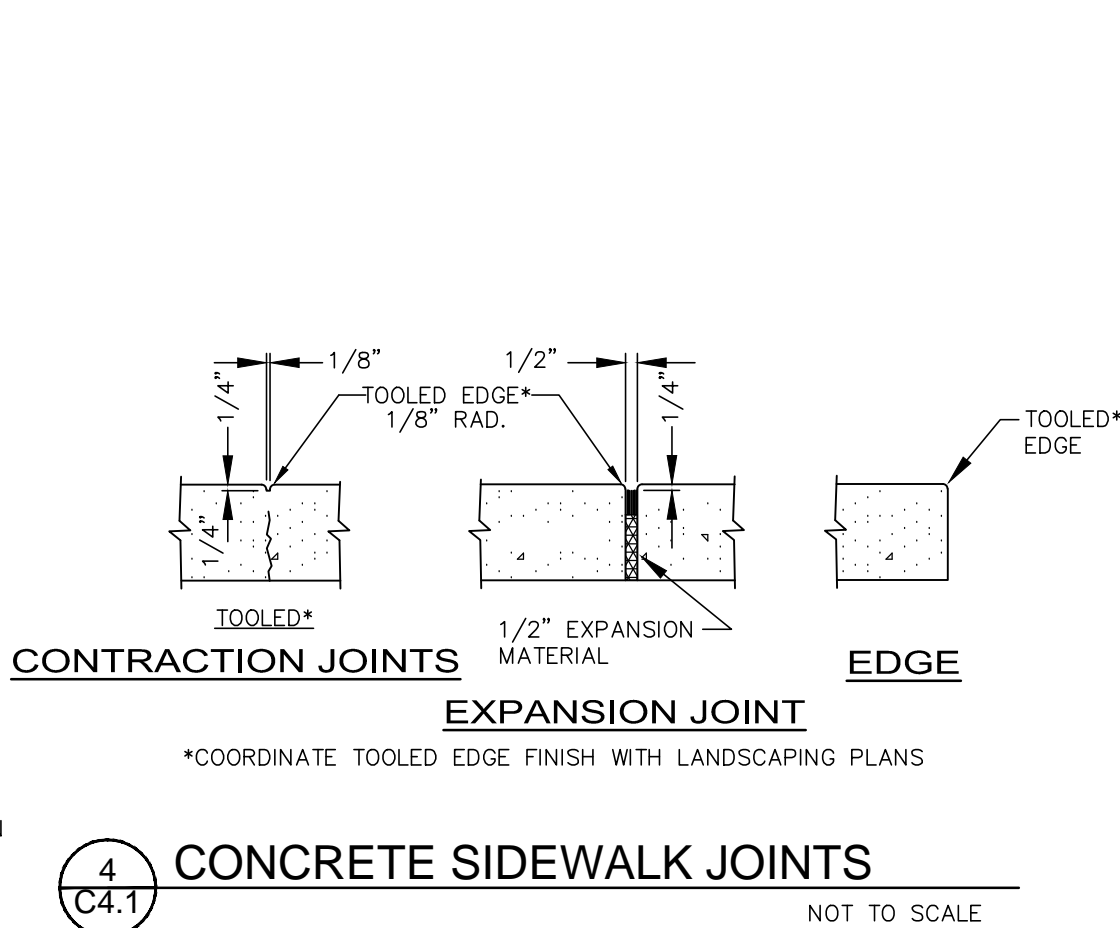
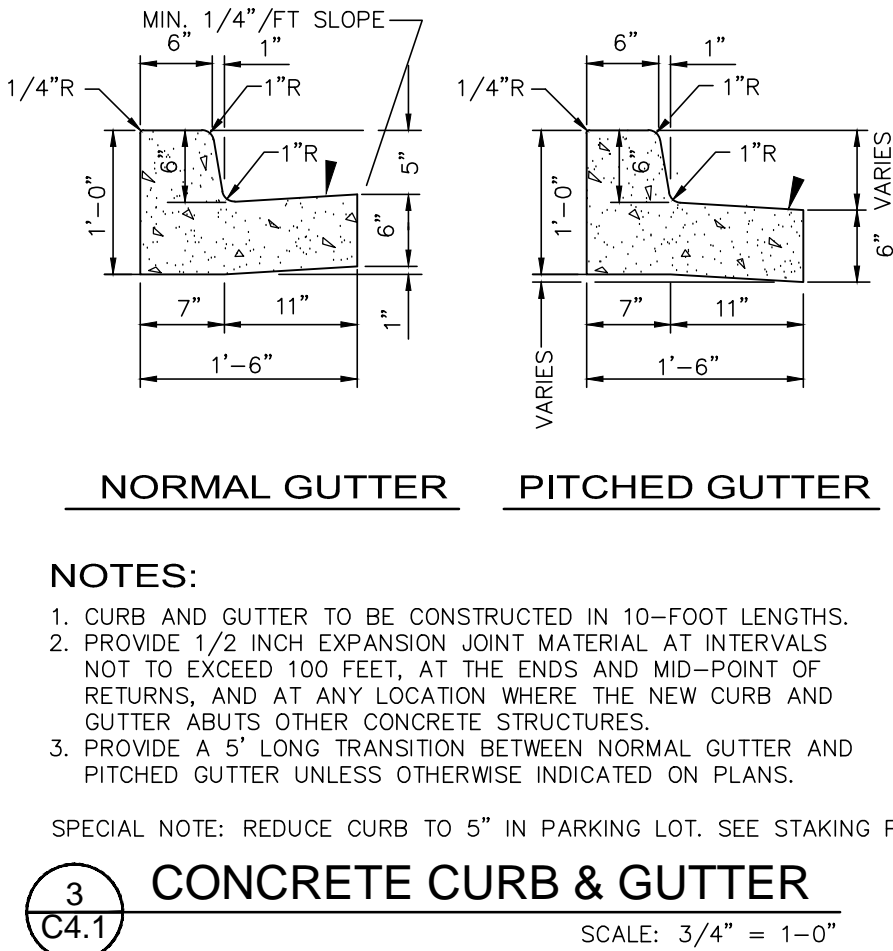
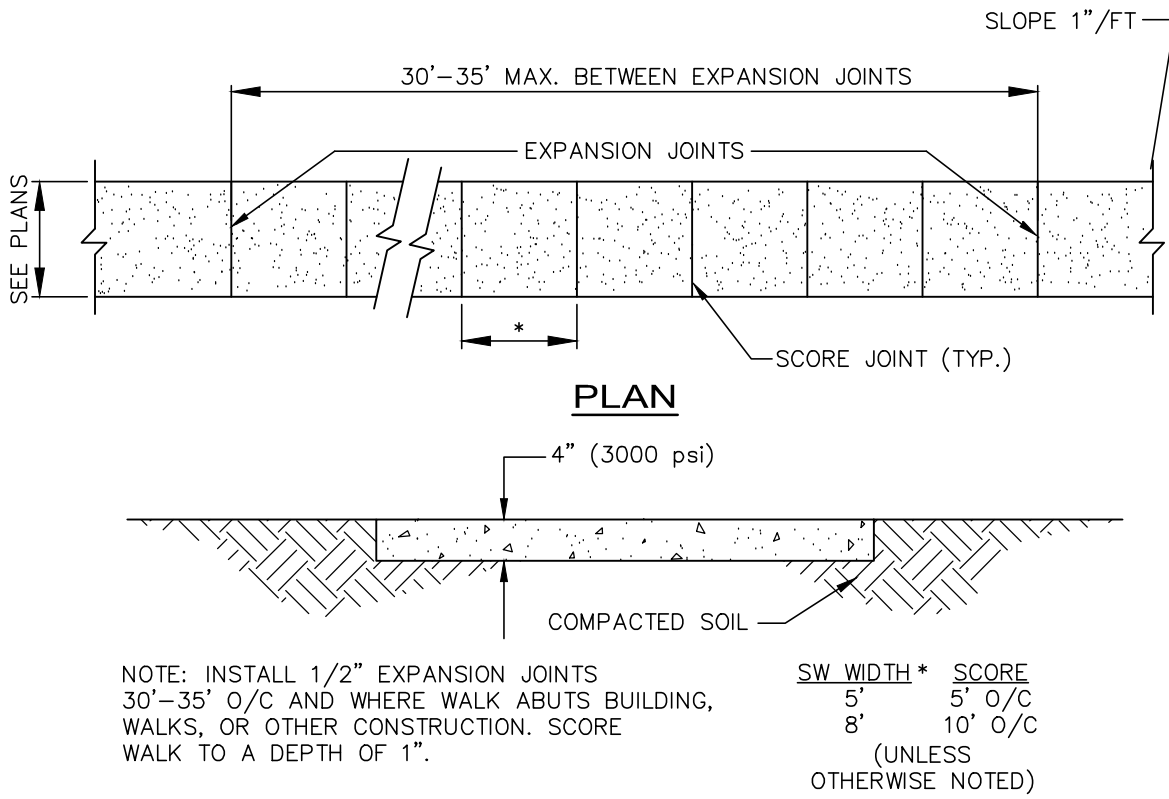
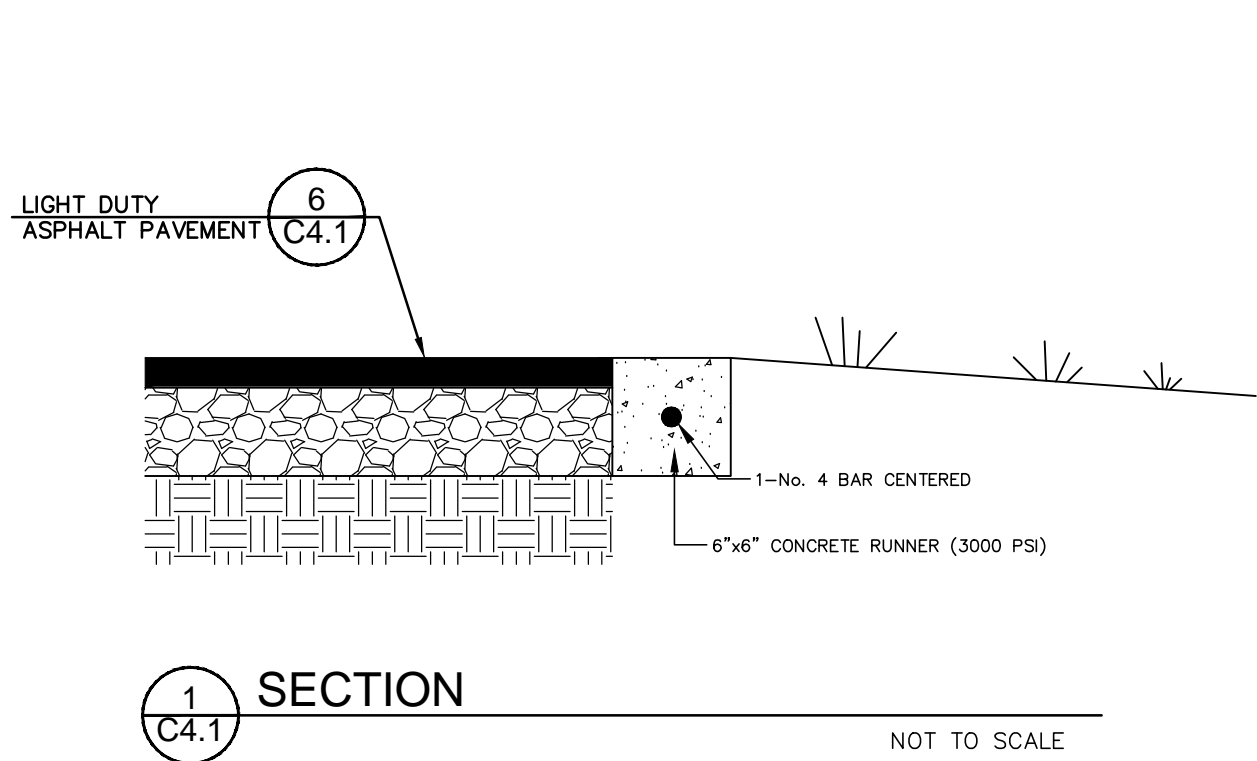

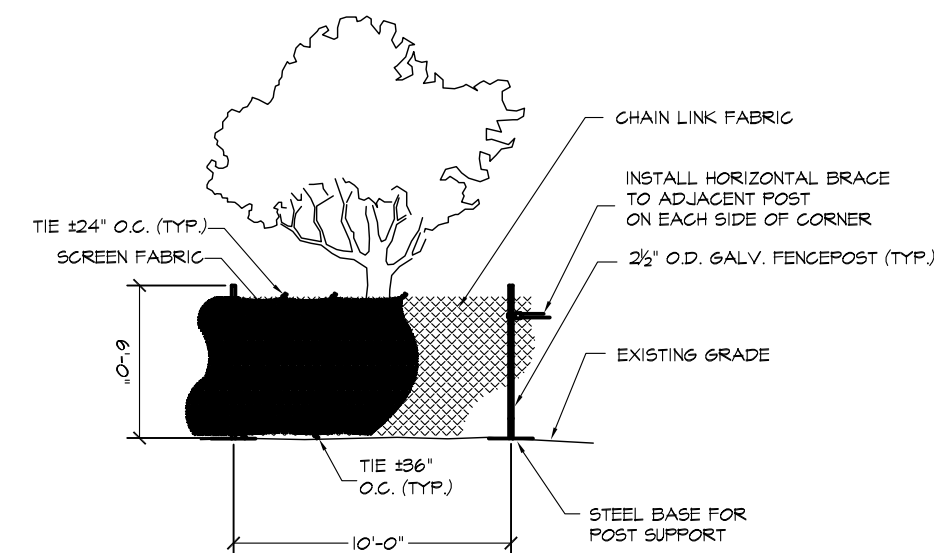



- NOTES:
1. LANDSCAPE PLANS FOR LOCATION OF TREE PROTECTION FENCINGS SHALL BE APPROVED BY THE PROJECT MANAGER.
 2. PROVIDE PROTECTION FENCE FOR ALL TREES TO REMAIN.
 3. PROTECTION FENCING TO BE PLACED OUTSIDE OF DRILLING OF THE GROUP (UNLESS OTHERWISE INDICATED ON LANDSCAPE PLAN OR APPROVED BY PROJECT MANAGER).
 4. A 4" LAYER OF HARDWOOD MULCH SHALL BE PLACED OVER TREE PROTECTION AREA.
 5. PROTECTION FENCINGS SHALL BE IN PLACE AND HARDWOOD MULCH PLACED PRIOR TO BEGINNING OF ANY CONSTRUCTION.
 6. REQUESTS FOR PAYMENT SHALL NOT BE APPROVED UNTIL PROTECTION FENCING AND MULCH IS IN PLACE.
 7. INSTALLATION OF PROTECTION FENCING SHALL BE MARKED BY ARBORIST AND APPROVED BY PROJECT MANAGER BEFORE INSTALLATION. WHERE PROTECTION FENCING IS LINED WITH PLASTIC, IT SHALL BE COVERED WITH A 4" LAYER OF MULCH.
 8. PROTECTION FENCING CONTRACTOR SHALL HAVE LIMITS OF CONSTRUCTION SURVEYED BY SURVEY BEFORE PROTECTION FENCING IS INSTALLED.
 9. GARDEN PATH SHALL BE CONSTRUCTED WITH 12" MINIMUM DRAINAGE DITCH KNIT MESH UV STABILIZED WITH BURST STRENGTH OF AT LEAST 2.0 P.S.I.

A TREE PROTECTION FENCING

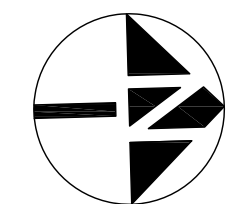
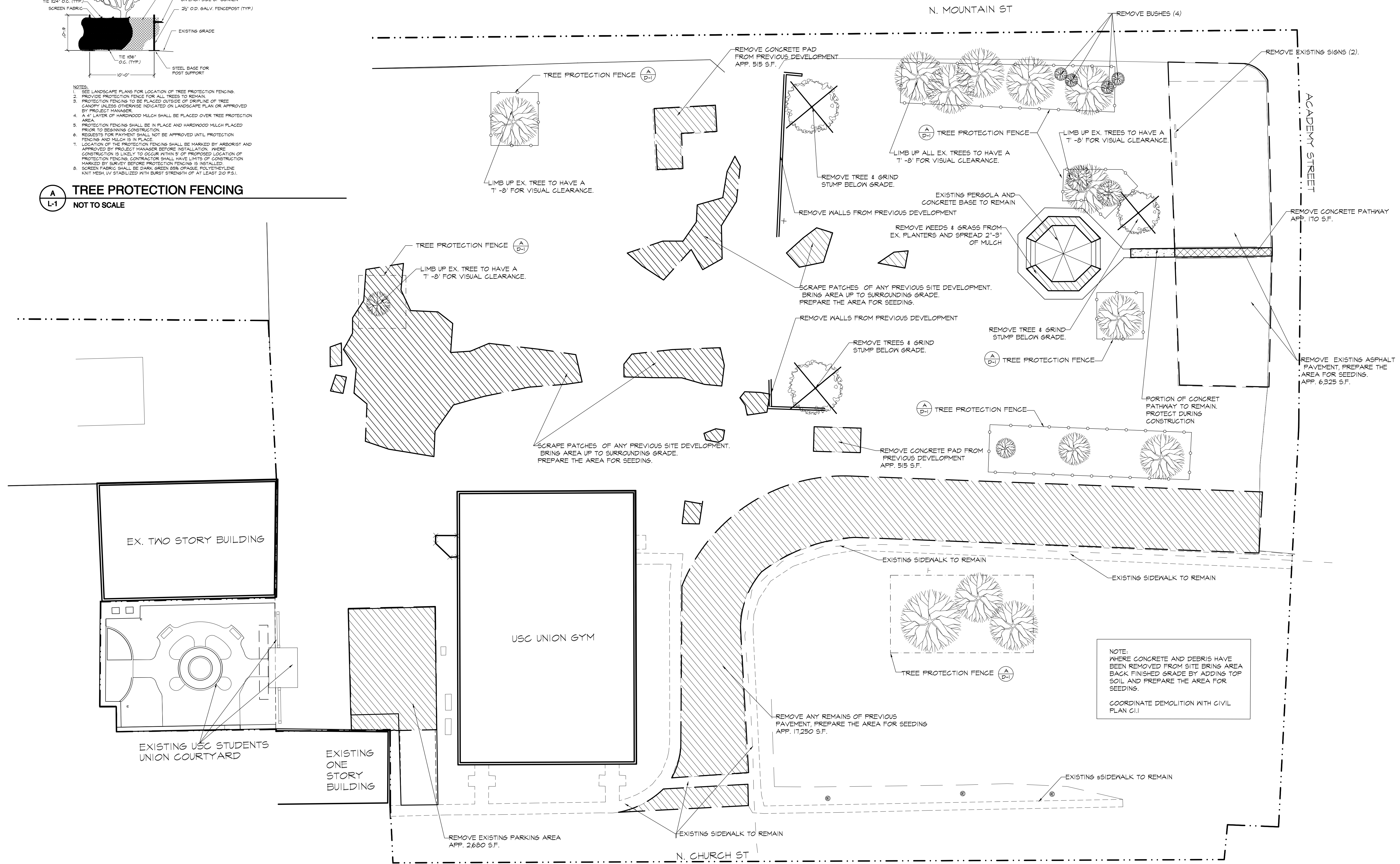
NOT TO SCALE



GRAPHIC SCALE 1" = 20'-0"



A horizontal graphic scale bar with four segments. The segments are labeled 0', 10', 20', and 40' from left to right. The first segment (0' to 10') is white, the second (10' to 20') is black, the third (20' to 30') is white, and the fourth (30' to 40') is black. The total length represents 40 feet.

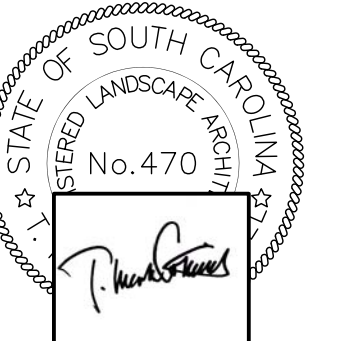

UNIVERSITY OF SOUTH CAROLINA
UNION PATRON'S PARK
RENOVATIONS

DEMOLITION & TREE PROTECTION PLAN

DRAWN BY	IGV
CHECKED BY	TMC
FILE:	

PROJECT NO:	17-573
DATE	8 OCT. 2017

L-1

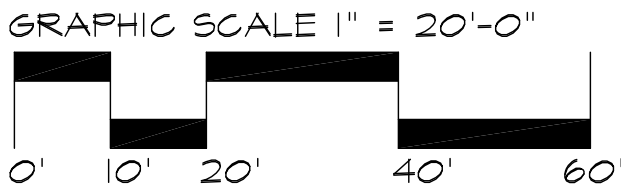
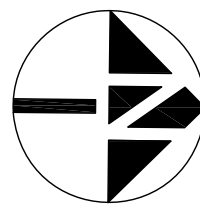
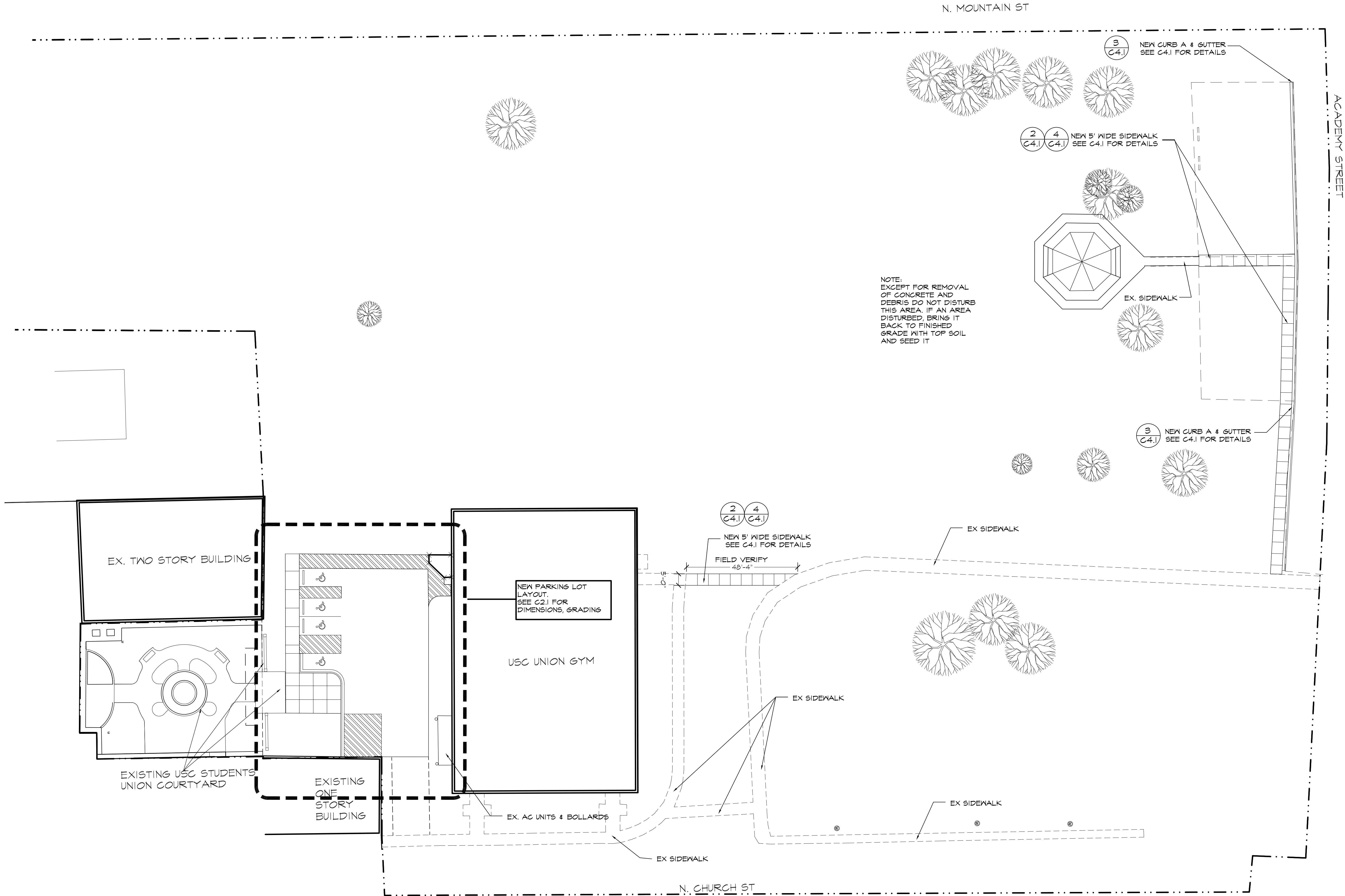

PROJECT NO.
17-573
DATE
6 OCT. 2017

DRAWING NO.
L-2

DRAWN BY
TGV
CHECKED BY
TMC
FILE:

DRAWING TITLE
LAYOUT PLAN

PROJECT TITLE

**UNIVERSITY OF SOUTH CAROLINA
UNION PATRON'S PARK
RENOVATIONS**

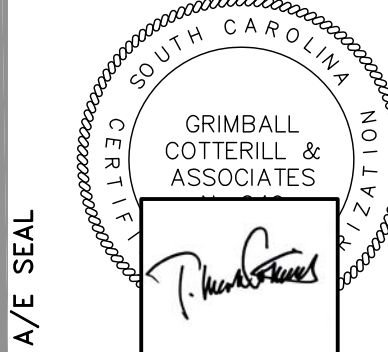

A/E SEAL



A/E SEAL

RB TODD
CONSULTING ENGINEERS
7436 Broad River Road, Suite 212
Irmo, S.C. 29063
Tel. 803.781.3141
Fax. 803.781.3142
www.rbtodd.com

ABBR.	BOTANICAL NAME	COMMON NAME	MINIMUM					COMMENTS	QTY.
			CALIPER	SPREAD	HEIGHT	BALL DIA.	NO. CANES		
LAGE N	LAGERSTROEMIA 'NATCHEZ'	'NATCHEZ' CRAPEMYRTLE	1"	6"	8'-10'	24"	3 MIN	MATCHING, SPECIMEN	1
BUXU J	BUXUS MICROPHYLLA JAPONICUM	JAPANESE BOXWOOD		24"	24"	3 GAL.	3-5	PLANT AS SHOWN	2
ROSA R	ROSA 'RADGER' PEACHY KEEN'	'PEACHY KEEN' ROSE		15"	15"	3 GAL.	3-5	PLANT AS SHOWN	10

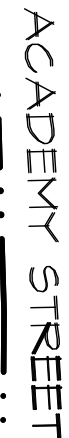

1. EXISTING EROSION AND AESTHETICS WILL OBTAIN CARE ADJUSTMENT OF THE EXISTING SLOPE TO FIT THE SITE. STABILIZATION OF THE EXISTING SLOPE BY THE LANDSCAPE ARCHITECT IS ABSOLUTELY NECESSARY.

2. LOCATIONS OF THOSE UTILITIES SHOWN ARE APPROXIMATE AND FOR INFORMATION PURPOSES ONLY. CONTRACTOR SHALL BE RESPONSIBLE FOR THE EXACT LOCATION OF ALL UTILITIES WHETHER SHOWN OR NOT SHOWN ON THESE PLANS, AND SHALL BE RESPONSIBLE FOR ANY AND ALL DAMAGE RESULTING FROM ANY AND ALL UTILITIES LOCATED BY THE LANDSCAPE ARCHITECT PRIOR TO 1-888-721-7877 AT LEAST 12 HOURS PRIOR TO COMMENCING CONSTRUCTION.

3. CONTRACTOR SHALL INFORM LANDSCAPE ARCHITECT IF PROPOSED DESIGN IS IN CONFLICT WITH EXISTING OR PROPOSED UTILITIES. CONTRACTOR SHALL COORDINATE WITH LANDSCAPE ARCHITECT PRIOR TO CONSTRUCTION TO ADJUST THE PROPOSED DESIGN OR UTILITIES NECESSARY TO RESOLVE CONFLICTS.

4. BASE PLAN DATA DERIVED FROM SITE SURVEY.

PREPARED BY: PAIRO

1. PLANTS LABELED "CN" ARE NOT IN CONTRACT AND ARE NOT A PART OF THIS PHASE OF WORKS;
2. REQUIREMENTS FOR THE MEASUREMENTS BRANCHING, GROWTH, QUALITY, SHAPE AND SURVIVAL OF PLANTS IN THE PLANT LIST GENERAL POLICY AND EXCEEDS A CODE OF STANDARDS CURRENTLY RECOMMENDED BY THE LANDSCAPE ARCHITECT AND THE CITY OF LOS ANGELES (CITY OF LOS ANGELES NURSERY) STOKES. SEE THE PLANT LIST FOR MORE RESTRICTIVE REQUIREMENTS.
3. ALL PLANTS SHALL HAVE A WELL FORMED HEAD WITH MINIMUM CALIPER, HEIGHT AND SPREAD OF THE SIZE BRANCHES AS SHOWN ON THE PLANT LIST.
4. MEASUREMENTS SHALL BE TAKEN AT THE BASE OF THE TRUNK OF THE SPECIES.
5. MEASUREMENTS: CONTRER HEIGHT SHALL INCLUDE NOT MORE THAN FIFTY (50) PER CENT OF THIS YEAR'S VERTICAL GROWTH (TOP CANDLE).
6. THE LANDSCAPE CONTRACTOR IS HEREBY NOTIFIED OF THE EXISTENCE OF UNDERGROUND UTILITIES WITHIN THE LIMITS OF THE PROJECT AREA. THE CONTRACTOR SHALL BE RESPONSIBLE FOR THE LOCATION OF ALL UTILITY LINES PRIOR TO COMMENCEMENT OF DIGGING OPERATIONS.
7. THE CONTRACTOR WILL BE RESPONSIBLE FOR STAKING AND LAYOUT OF PLANTINGS ON THIS PROJECT. THE LANDSCAPE ARCHITECT OR OWNER SHALL BE ADVISED IN WRITING OF ANY CHANGES TO THE PLANTING LAYOUT OR PLANTING AREAS. ALL LAYOUT WORK SHALL BE INSPECTED AND APPROVED BY THE LANDSCAPE ARCHITECT AND OWNER PRIOR TO OPENING ANY PLANTING TITS.
8. IT IS THE RESPONSIBILITY OF THE LANDSCAPE CONTRACTOR TO VERIFY THAT ALL PLANTING AREAS ARE SHOWN ON THE PLANT LIST. THE CONTRACTOR SHALL ADD TOPSOIL AND INSTALLING TREES OR SHRUBS. THE CONTRACTOR SHALL BE RESPONSIBLE FOR THE PROTECTION OF EXISTING TREES OR LANDSCAPE ARCHITECT. IF THE SOIL AT GIVEN AREA DOES NOT DRAIN PROPERLY, THE CONTRACTOR OR GRAVEL. SAND SHALL BE INSTALLED OR THE PLANTINGS RELOCATED.
9. SHOULD THE LANDSCAPE CONTRACTOR ENCOUNTER UNDESIRABLE PLANTING AREAS, THE CONTRACTOR SHALL BE RESPONSIBLE FOR THE REMOVAL OF WEEDS, HAZARD PEST, STEAM OR OTHER UTILITY LINES OR OTHER CONDITIONS THAT WILL ENDANGER THE HEALTH AND VIGOR OF THE PLANTS. HE MUST ADVISE THE LANDSCAPE ARCHITECT AND OWNER IMMEDIATELY. THE CONTRACTOR SHALL REMOVE THE PLANTS. OTHERWISE THE LANDSCAPE CONTRACTOR WARRANTS THAT THE PLANTS WILL BE PROTECTED AND MAINTAINED FOR PROPER GROWTH AND DEVELOPMENT OF THE PLANTS TO BE INSTALLED.
10. PLANTING TITS FOR TREES AND SHRUBS SHALL BE PREPARED AS PER DETAILS.

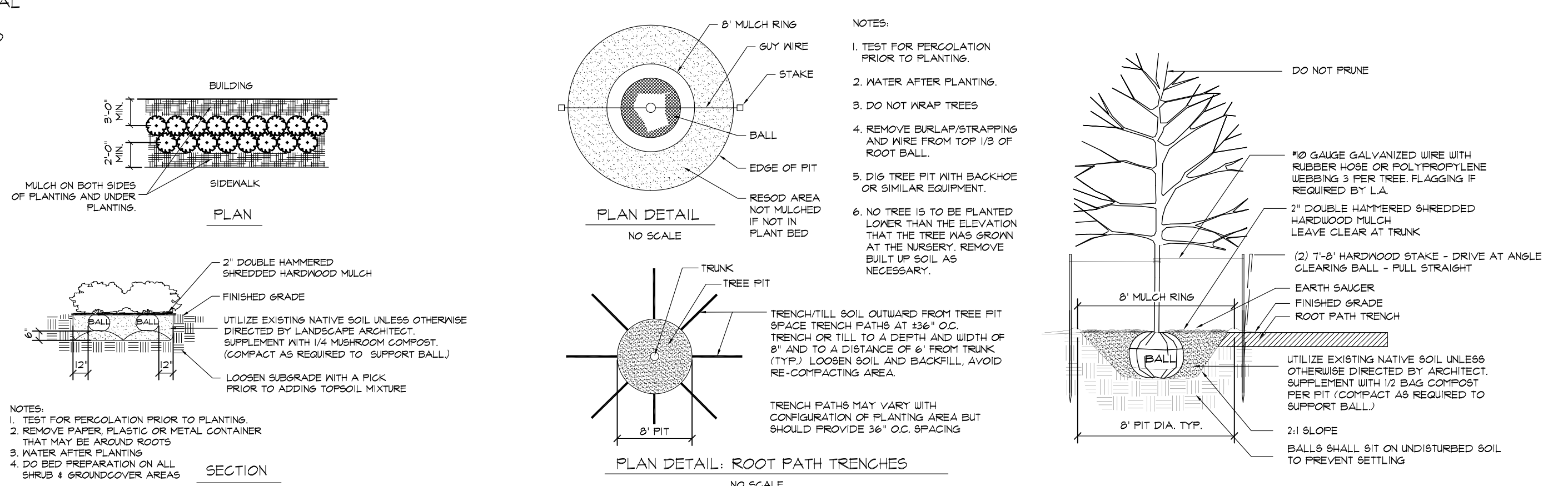

TREE PLANTING AND STAKING

SECTION

NOT TO SCALE

