

Copyright © W.K. Dickson, Inc. All rights reserved. Reproduction or use of the contents of this document, including the drawings, without the written consent of W.K. Dickson, Inc. is prohibited.

REBID USC UPSTATE SMITH CIRCLE PAVEMENT IMPROVEMENTS

FOR THE
UNIVERSITY OF SOUTH CAROLINA
SPARTANBURG COUNTY, SOUTH CAROLINA
STATE PROJECT NO. H34-I378

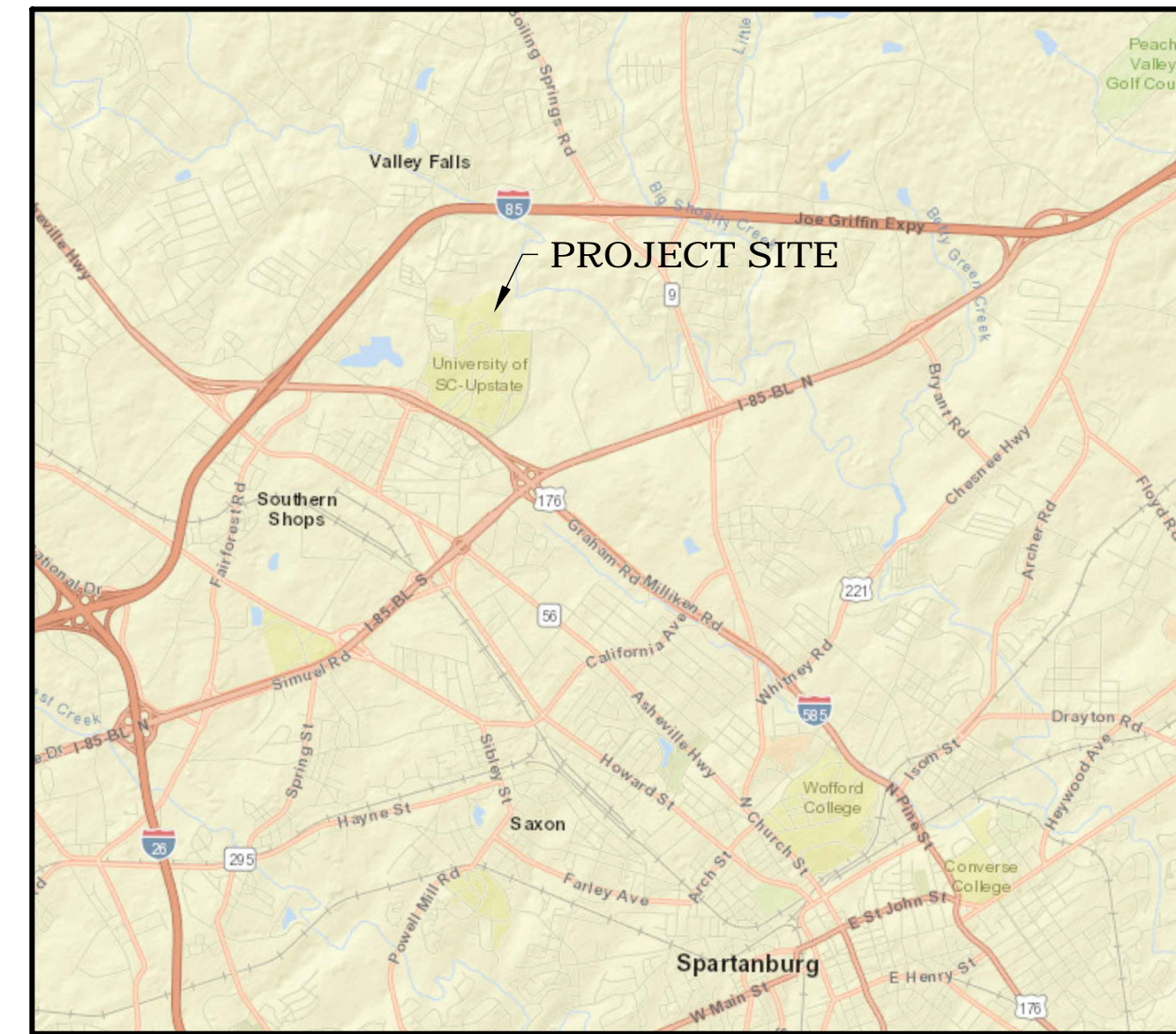

LOCATION MAP
SCALE: 1" = 1 MILE

INDEX OF DRAWINGS	
SHEET NUMBER	SHEET TITLE
1	COVER SHEET
2	GENERAL NOTES
3	SITE IMPROVEMENT PLAN
4	SITE DETAILS

NOTICE TO CONTRACTOR

- PRIOR TO CONSTRUCTION, DIGGING, OR EXCAVATION THE CONTRACTOR IS RESPONSIBLE FOR LOCATING ALL UNDERGROUND UTILITIES (PUBLIC OR PRIVATE) THAT MAY EXIST AND CROSS THROUGH THE AREA(S) OF CONSTRUCTION, WHETHER INDICATED ON THE PLANS OR NOT. CALL '811' A MINIMUM OF 72 HOURS PRIOR TO DIGGING OR EXCAVATING. REPAIRS TO ANY UTILITY DAMAGED RESULTING FROM CONSTRUCTION ACTIVITIES SHALL BE THE RESPONSIBILITY OF THE CONTRACTOR.

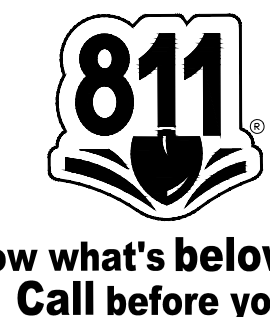

WK DICKSON
community infrastructure consultants
1320 MAIN STREET
SUITE 400
COLUMBIA, SC 29201
(803) 786-4261
(803) 786-4263
WWW.WKDICKSON.COM

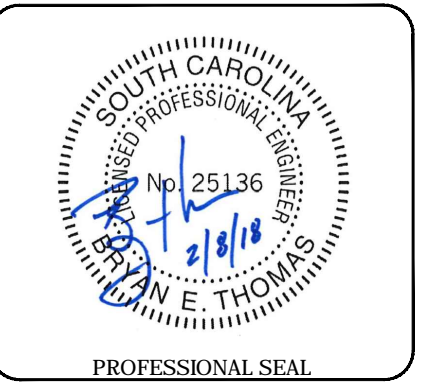
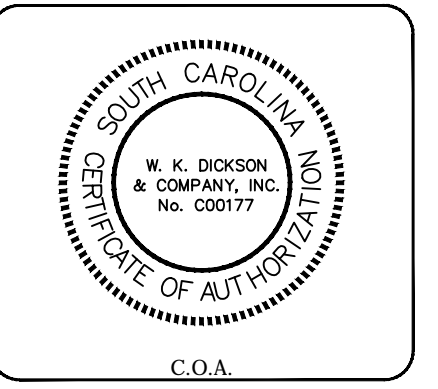

REVISION RECORD	NO.	DATE	DESCRIPTION

PROJECT NAME:
REBID
USC UPSTATE SMITH CIRCLE PAVEMENT IMPROVEMENTS
FOR THE
UNIVERSITY OF SOUTH CAROLINA
SPARTANBURG COUNTY, SOUTH CAROLINA

DRAWING TITLE:
COVER SHEET

PROJ. MGR.: BET
DESIGN BY: MDJ
DRAWN BY: MDJ
PROJ. DATE: FEB. 2018
DRAWING NUMBER:
1 OF 4
WKD PROJ. NO.:
20170108.00.CA

REBID DOCUMENTS - DO NOT USE FOR CONSTRUCTION

LEGEND

EXISTING		PROPOSED
	5-FOOT CONTOUR	
	1-FOOT CONTOUR	
	STORM DRAINAGE PIPE	
	DROP INLET or CATCH BASIN	
	RIP RAP	
	FENCE	
	ROADWAY SIGN	
	TREE LINE	
	SANITARY SEWER GRAVITY LINE	
	SANITARY SEWER MANHOLE	
	POWER/UTILITY POLE	
	GUY WIRE	
	LIGHT POLE	
	TRANSFORMER	
	UNDERGROUND GAS LINE	
	GAS VALVE	
	OVERHEAD UTILITY LINE	
	UNDERGROUND UTILITY LINE	
	TELEPHONE PEDESTAL	
	IRRIGATION LINE	
	WATER LINE	
	WATER VALVE	
	WATER METER	
	WELL	
	FIRE HYDRANT	
	TOP OF BANK	
	BOTTOM OF BANK	
	PROPERTY LINE	
	LIMITS OF DISTURBANCE	
	REMOVE EXISTING STORM DRAINAGE	
	UNDERDRAIN FLOW DIRECTION	
	AREA 1 - PAVEMENT SECTION REMOVAL AND REPLACEMENT	
	AREA 2 - PAVEMENT SECTION REMOVAL AND REPLACEMENT	

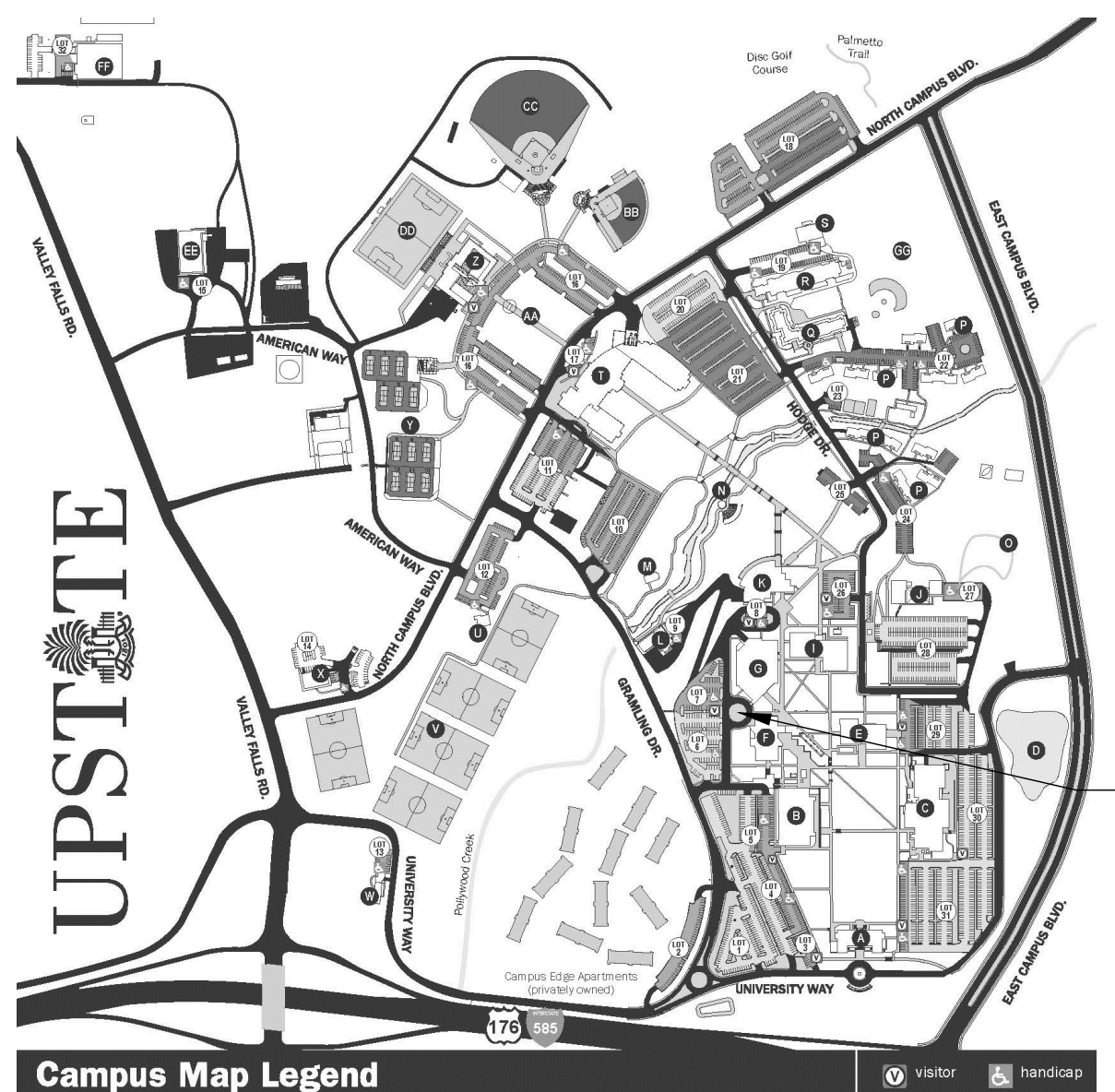

Campus Map Legend

A. John C. Stovall Administration Building	L. The P. Vintyryn Nicka Visual Arts Center	V. Soccer Fields
B. Library/Richard E. Tuley Theatre	M. Dr. Lawrence E. Rohl Garden Pavilion	W. Health Services
C. G. B. Hodge Center/Arena	N. Susan Jacobs Arboretum	X. University Public Safety
D. Upstate Rotary International Peace Park	O. Science Trail	Y. Tennis Complex
E. Media Center	P. The Villas	Z. University Readiness Center/SD National Guard
F. WRETTV	Q. Palmetto House	AA. Louis P. Howell Athletic Complex
G. Horace C. Smith Science Building	R. Magnolia House	BB. Cyril S. Stribling Stadium
H. Humanities & Performing Arts Center	S. John W. Ramsey Center	CC. Coward S. Harley Baseball Park
I. College of Arts & Sciences Building	T. Health Education Complex/Wellness Center	DD. County University Soccer Stadium
J. Barnhart Building	U. Mary Black School of Nursing	EE. Facilities Management Complex
K. Honors Program	V. School of Education	FF. University Services Building
L. International Studies	W. Enrollment Services	GG. Postals/Shipping & Receiving
M. Olin B. Searabury Jr. Campus Life Center	X. Bookstore	HH. Intramural Field
N. Olin B. Searabury Jr. Campus Life Center	U. Smith Ramhouse/Athletic Annex	

SCDHEC EROSION AND SEDIMENT CONTROL NOTES:

- IF NECESSARY, SLOPES, WHICH EXCEED EIGHT (8) VERTICAL FEET SHOULD BE STABILIZED WITH SYNTHETIC OR VEGETATIVE MATS, IN ADDITION TO HYDROSEEDING. IT MAY BE NECESSARY TO INSTALL TEMPORARY SLOPE DRAINS DURING CONSTRUCTION. TEMPORARY BERMS MAY BE NEEDED UNTIL THE SLOPE IS BROUGHT TO GRADE.
- STABILIZATION MEASURES SHALL BE INITIATED AS SOON AS PRACTICABLE IN PORTIONS OF THE SITE WHERE CONSTRUCTION ACTIVITIES HAVE TEMPORARILY OR PERMANENTLY CEASED, BUT IN NO CASE MORE THAN FOURTEEN (14) DAYS AFTER WORK HAS CEASED, EXCEPT AS STATED BELOW:
 - WHERE STABILIZATION BY THE 14TH DAY IS PRECLUDED BY SNOW COVER OR FROZEN GROUND CONDITIONS STABILIZATION MEASURES MUST BE INITIATED AS SOON AS PRACTICABLE.
 - WHERE CONSTRUCTION ACTIVITY ON A PORTION OF THE SITE IS TEMPORARILY CEASED, AND EARTH-DISTURBING ACTIVITIES WILL BE RESUMED WITHIN 14 DAYS, TEMPORARY STABILIZATION MEASURES DO NOT HAVE TO BE INITIATED ON THAT PORTION OF THE SITE.
- ALL SEDIMENT AND EROSION CONTROL DEVICES SHALL BE INSPECTED ONCE EVERY CALENDAR WEEK. IF PERIODIC INSPECTION OR OTHER INFORMATION INDICATES THAT A BMP HAS BEEN INAPPROPRIATELY OR INCORRECTLY INSTALLED, THE PERMITTEE MUST ADDRESS THE NECESSARY REPLACEMENT OR MODIFICATION REQUIRED TO CORRECT THE BMP WITHIN 48 HOURS OF IDENTIFICATION.
- PROVIDE SILT FENCE AND/OR OTHER CONTROL DEVICES, AS MAY BE REQUIRED, TO CONTROL SOIL EROSION DURING UTILITY CONSTRUCTION. ALL DISTURBED AREAS SHALL BE CLEANED, GRADED, AND STABILIZED WITH GRASSING IMMEDIATELY AFTER THE UTILITY INSTALLATION. FILL, COVER, AND TEMPORARY SEEDING AT THE END OF EACH DAY ARE RECOMMENDED. IF WATER IS ENCOUNTERED WHILE TRENCHING, THE WATER SHOULD BE FILTERED TO REMOVE ANY SEDIMENTS BEFORE BEING PUMPED BACK INTO ANY WATERS OF THE STATE.
- ALL EROSION CONTROL DEVICES SHALL BE PROPERLY MAINTAINED DURING ALL PHASES OF CONSTRUCTION UNTIL THE COMPLETION OF ALL CONSTRUCTION ACTIVITIES AND ALL DISTURBED AREAS HAVE BEEN STABILIZED. ADDITIONAL CONTROL DEVICES MAY BE REQUIRED DURING CONSTRUCTION IN ORDER TO CONTROL EROSION AND/OR OFFSITE SEDIMENTATION. ALL TEMPORARY CONTROL DEVICES SHALL BE REMOVED ONCE CONSTRUCTION IS COMPLETE AND THE SITE IS STABILIZED.
- THE CONTRACTOR MUST TAKE NECESSARY ACTION TO MINIMIZE THE TRACKING OF MUD ONTO PAVED ROADWAY(S) FROM CONSTRUCTION AREAS AND THE GENERATION OF DUST. THE CONTRACTOR SHALL DAILY REMOVE MUD/SOIL FROM PAVEMENT, AS MAY BE REQUIRED.
- RESIDENTIAL SUBDIVISIONS REQUIRE EROSION CONTROL FEATURES FOR INFRASTRUCTURE AS WELL AS FOR INDIVIDUAL LOT CONSTRUCTION. INDIVIDUAL PROPERTY OWNERS SHALL FOLLOW THESE PLANS DURING CONSTRUCTION OR OBTAIN APPROVAL OF AN INDIVIDUAL PLAN IN ACCORDANCE WITH S.C. REG. 72-300 ET SEQ. AND SCR100000.
- TEMPORARY DIVERSION BERMS AND/OR DITCHES WILL BE PROVIDED AS NEEDED DURING CONSTRUCTION TO PROTECT WORK AREAS FROM UPSLOPE RUNOFF AND/OR TO DIVERT SEDIMENT-LADEN WATER TO APPROPRIATE TRAPS OR STABLE OUTLETS.
- ALL WATERS OF THE STATE (WOS), INCLUDING WETLANDS, ARE TO BE FLAGGED OR OTHERWISE CLEARLY MARKED IN THE FIELD. A DOUBLE ROW OF SILT FENCE IS TO BE INSTALLED IN ALL AREAS WHERE A 50-FOOT BUFFER CAN'T BE MAINTAINED BETWEEN THE DISTURBED AREA AND ALL WOS. A 10-FOOT BUFFER SHOULD BE MAINTAINED BETWEEN THE LAST ROW OF SILT FENCE AND ALL WOS.
- LITTER, CONSTRUCTION DEBRIS, OILS, FUELS, AND BUILDING PRODUCTS WITH SIGNIFICANT POTENTIAL FOR IMPACT (SUCH AS STOCKPILES OF FRESHLY TREATED LUMBER) AND CONSTRUCTION CHEMICALS THAT COULD BE EXPOSED TO STORM WATER MUST BE PREVENTED FROM BECOMING A POLLUTANT SOURCE IN STORM WATER DISCHARGES.
- A COPY OF THE SWPPP, INSPECTIONS RECORDS, AND RAINFALL DATA MUST BE RETAINED AT THE CONSTRUCTION SITE OR A NEARBY LOCATION EASILY ACCESSIBLE DURING NORMAL BUSINESS HOURS, FROM THE DATE OF COMMENCEMENT OF CONSTRUCTION ACTIVITIES TO THE DATE THAT FINAL STABILIZATION IS REACHED.
- INITIATE STABILIZATION MEASURES ON ANY EXPOSED STEEP SLOPE (3H:1V OR GREATER) WHERE LAND DISTURBING ACTIVITIES HAVE PERMANENTLY OR TEMPORARILY CEASED, AND WILL NOT RESUME FOR A PERIOD OF 7 CALENDAR DAYS.
- MINIMIZE SOIL COMPACTION AND, UNLESS INFEASIBLE, PRESERVE TOPSOIL.
- MINIMIZE THE DISCHARGE OF POLLUTANTS FROM EQUIPMENT AND VEHICLE WASHING, WHEEL WASH WATER, AND OTHER WASH WATERS. WASH WATERS MUST BE TREATED IN A SEDIMENT BASIN OR ALTERNATIVE CONTROL THAT PROVIDES EQUIVALENT OR BETTER TREATMENT PRIOR TO DISCHARGE;
- MINIMIZE THE DISCHARGE OF POLLUTANTS FROM DEWATERING OF TRENCHES AND EXCAVATED AREAS. THESE DISCHARGES ARE TO BE ROUTED THROUGH APPROPRIATE BMPS (SEDIMENT BASIN, FILTER BAG, ETC.).
- THE FOLLOWING DISCHARGES FROM SITES ARE PROHIBITED:
 - WASTEWATER FROM WASHOUT OF CONCRETE, UNLESS MANAGED BY AN APPROPRIATE CONTROL;
 - WASTEWATER FROM WASHOUT AND CLEANOUT OF STUCCO, PAINT, FORM RELEASE OILS, CURING COMPOUNDS AND OTHER CONSTRUCTION MATERIALS;
 - FUELS, OILS, OR OTHER POLLUTANTS USED IN VEHICLE AND EQUIPMENT OPERATION AND MAINTENANCE; AND
 - SOAPS OR SOLVENTS USED IN VEHICLE AND EQUIPMENT WASHING.
- AFTER CONSTRUCTION ACTIVITIES BEGIN, INSPECTIONS MUST BE CONDUCTED AT A MINIMUM OF AT LEAST ONCE EVERY CALENDAR WEEK AND MUST BE CONDUCTED UNTIL FINAL STABILIZATION IS REACHED ON ALL AREAS OF THE CONSTRUCTION SITE.
- IF EXISTING BMPS NEED TO BE MODIFIED OR IF ADDITIONAL BMPS ARE NECESSARY TO COMPLY WITH THE REQUIREMENTS OF THIS PERMIT AND/OR SC'S WATER QUALITY STANDARDS, IMPLEMENTATION MUST BE COMPLETED BEFORE THE NEXT STORM EVENT WHENEVER PRACTICABLE. IF IMPLEMENTATION BEFORE THE NEXT STORM EVENT IS IMPRACTICABLE, THE SITUATION MUST BE DOCUMENTED IN THE SWPPP AND ALTERNATIVE BMPS MUST BE IMPLEMENTED AS SOON AS REASONABLY POSSIBLE.
- A PRE-CONSTRUCTION CONFERENCE MUST BE HELD FOR EACH CONSTRUCTION SITE WITH AN APPROVED ON-SITE SWPPP PRIOR TO THE IMPLEMENTATION OF CONSTRUCTION ACTIVITIES. FOR NON-LINEAR PROJECTS THAT DISTURB 10 ACRES OR MORE THIS CONFERENCE MUST BE HELD ON-SITE UNLESS THE DEPARTMENT HAS APPROVED OTHERWISE.

14 DAY STABILIZATION CLAUSE

ALL DISTURBED AREAS WHICH ARE TO BE LEFT IDLE FOR A PERIOD OF 14 DAYS OR LONGER ARE TO RECEIVE TEMPORARY VEGETATION OR MULCH.

EROSION CONTROL MAINTENANCE SCHEDULE

ALL SEDIMENT AND EROSION CONTROLS ARE TO BE INSPECTED AT LEAST EVERY SEVEN (7) CALENDAR DAYS. CONTRACTOR TO DOCUMENT WITH SCDHEC APPROVED INSPECTION REPORTS AND LOGGED IN THE PROJECT SWPPP.

GENERAL NOTES

- REFERENCE IS MADE TO THE FOLLOWING:
 - TOPOGRAPHIC SURVEY PREPARED FOR USC UPSTATE BY W.K. DICKSON, COMPLETED IN APRIL 2017.
- ALL ELEVATIONS REFER TO NAVD 88 DATUM.
- THE LOCATIONS OF EXISTING UNDERGROUND UTILITIES ARE SHOWN IN AN APPROXIMATE WAY ONLY. VERIFY ALL FIELD CONDITIONS AND THE EXACT LOCATIONS OF ALL UNDERGROUND UTILITIES PRIOR TO BEGINNING DEMOLITION AND CONSTRUCTION. IF CONDITIONS ARE DIFFERENT FROM THAT SHOWN ON THE PLANS, STOP WORK AND NOTIFY THE ENGINEER.
- ALL WORK FOR THE PROJECT SHALL CONFORM TO THE PROJECT SPECIFICATIONS FOUND IN THE PROJECT MANUAL (CONTRACT DOCUMENTS AND SPECIFICATIONS).
- PROMPTLY INFORM THE ENGINEER OF ANY ERROR OR DISCREPANCY DISCOVERED IN THESE DRAWINGS OR SPECIFICATIONS OR CONFLICT BETWEEN THE DRAWINGS OR SPECIFICATIONS.
- ALL EXCESS TOPSOIL FROM THE PROJECT SITES SHALL BE THE PROPERTY OF THE OWNER AND SHALL BE PLACED AT A LOCATION ON CAMPUS DETERMINED BY THE OWNER.
- CONTRACTOR IS RESPONSIBLE FOR THE LAYOUT OF THE PROPOSED SITE AND LIMITS OF WORK.
- ANY UTILITIES OR FACILITIES DAMAGED DURING THE PROJECT BY THE CONTRACTOR'S PERSONNEL OR EQUIPMENT SHALL BE PROMPTLY REPAIRED AT THE CONTRACTOR'S EXPENSE. HAND DIGGING TO PROTECT UTILITIES FROM DAMAGE SHOULD BE ANTICIPATED.
- THE CONTRACTOR IS RESPONSIBLE FOR CONDUCTING WORK IN ACCORDANCE WITH THE LATEST REQUIREMENTS AND REGULATIONS OF THE OCCUPATIONAL SAFETY AND HEALTH ADMINISTRATION (OSHA).
- ALL DEMOLITION DEBRIS SHALL BE DISPOSED OF OFF-SITE IN ACCORDANCE WITH ALL LOCAL, STATE AND FEDERAL REGULATIONS AND SPECIFICATIONS, LATEST REVISION.
- PROMPTLY INFORM THE ENGINEER OF ANY ERROR OR DISCREPANCIES DISCOVERED IN THE DRAWINGS OR SPECIFICATIONS OR CONFLICTS BETWEEN THE DRAWING AND SPECIFICATIONS IN ORDER FOR CORRECTIONS TO BE MADE.
- ALL WORK AND MATERIALS MUST CONFIRM WITH SPARTANBURG COUNTY REGULATIONS AND SPECIFICATIONS, LATEST REVISIONS AT THE BEGINNING OF CONSTRUCTION.
- KEEP ALL ADJACENT AREAS TO THE LIMITS OF WORK CLEAN AND FREE OF DEBRIS/MATERIALS/EQUIPMENT AT ALL TIMES.

GRADING AND EROSION CONTROL NOTES:

- WHEN GRADING BETWEEN CONTOURS AND BETWEEN POINTS OF SPOT ELEVATIONS, GRADE ON A UNIFORM SLOPE. PROPOSED GRADES SHOWN ARE FINAL SURFACE ELEVATIONS.
- EACH SECTION OF STORM DRAINAGE PIPE SHALL BE LAID TO SPECIFIED GRADE AND LAID UPGRADE.
- ALL VEGETATION TOPSOIL SHALL BE STRIPPED AND STOCKPILED PRIOR TO PLACING FILL, PROTECT STOCKPILE FROM EROSION.
- CONTRACTOR SHALL, FOR ALL GRASSED AREAS, BE RESPONSIBLE FOR REPLACING ERODED SOIL AND GRASS SEED UNTIL AN APPROVED STAND OF GRASS IS ESTABLISHED.
- PROPOSED FILL SOILS SHALL BE SUITABLE MATERIAL AND FREE OF ORGANIC MATERIAL, RUBBLE, DEBRIS, AND HIGHLY PLASTIC CLAYS OR SILTS.
- CONTRACTOR SHALL, BEFORE BEGINNING GRADING WORK ON SITE, STAKE SILT FENCE AND INSTALL ALL PERIMETER EROSION CONTROLS AS SHOWN IN THESE PLANS.
- CONTRACTOR SHALL BE AWARE OF EXISTING UTILITY LINES DURING PIPE LINE INSTALLATION. CONTRACTOR SHALL NOTIFY UTILITY COMPANIES SUCH AS THE LOCAL ELECTRIC COMPANY, AT&T, ETC. FOR LOCATION OF OTHER UTILITIES NOT SHOWN ON PLAN. CALL PALMETTO UTILITIES PROTECTION SERVICES 811 FOR UNDERGROUND UTILITY LINES LOCATION. THE CONTRACTOR IS RESPONSIBLE FOR LOCATING ALL UNDERGROUND UTILITIES PRIOR TO CONSTRUCTION.
- ALL NEWLY CONSTRUCTED SLOPES WHICH ARE STEEPER THAN 2.5 TO 1 MUST BE STABILIZED BY INSTALLATION OF EROSION CONTROL MATTING. OTHER AREAS SUCH AS CHANNEL BOTTOMS, CHANNEL SIDESLOPES, AND SLOPES NEAR SENSITIVE WETLAND AREAS MAY ALSO REQUIRE EROSION CONTROL MATTING WHERE SHOWN ON PLANS. USE NORTH AMERICAN GREEN S150 OR APPROVED EQUAL. EQUAL PRODUCTS MUST BE APPROVED BY THE ENGINEER PRIOR TO INSTALLATION.
- PROVIDE SILT FENCE AND/OR OTHER CONTROL DEVICES AS MAY BE REQUIRED TO CONTROL SOIL EROSION DURING CONSTRUCTION. ALL DISTURBED AREAS SHALL BE CLEANED, GRADED AND STABILIZED WITH GRASSING IMMEDIATELY AFTER THE UTILITY INSTALLATION.
- ALL AREAS WHICH ARE DISTURBED BY CONSTRUCTION ACTIVITIES SHALL BE SEEDED AT NO ADDITIONAL EXPENSE TO THE OWNER.
- INSTALL PERMANENT VEGETATIVE COVER AND THE LONG-TERM EROSION PROTECTION MEASURES OR STRUCTURES AS SOON AS PRACTICAL IN THE DEVELOPMENT PROCESS.
- ALL DISTURBED AREAS NOT PAVED SHALL BE GRASSED OR LANDSCAPED. USE TEMPORARY PLANT COVER, MULCHING, AND/OR STRUCTURES TO CONTROL RUNOFF AND PROTECT AREA SUBJECT TO EROSION DURING CONSTRUCTION.
- ALL SEDIMENT AND EROSION CONTROLS ARE TO BE INSPECTED AT LEAST ONCE EVERY SEVEN CALENDAR DAYS AND AFTER ANY STORM EVENT OF GREATER THAN 0.5 INCHES OF PRECIPITATION DURING ANY 24-HOUR PERIOD. MAINTENANCE OF SEDIMENT TRAPPING DEVICES SHALL BE PERFORMED AS NECESSARY PER THESE INSPECTIONS. DAMAGED OR INEFFECTIVE DEVICES SHALL BE REPAIRED OR REPLACED, AS NECESSARY.
- ADDITIONAL EROSION CONTROL DEVICES MAY BE REQUIRED DURING CONSTRUCTION TO CONTROL EROSION AND/OR OFF SITE SEDIMENTATION. CONTRACTOR IS RESPONSIBLE FOR MAINTAINING THE STABILITY OF ALL GRADED AND/OR CLEARED AREAS UNTIL PERMANENT GROUND COVER IS ESTABLISHED. ANY AREAS DAMAGED BY EROSION SHALL BE REPAIRED TO ITS ORIGINAL CONDITION AND PROTECTED FROM FURTHER EROSION AT NO ADDITIONAL COST TO THE OWNER.
- ALL EROSION CONTROL DEVICES SHALL BE PROPERLY MAINTAINED DURING ALL PHASES OF CONSTRUCTION UNTIL THE COMPLETION OF ALL CONSTRUCTION ACTIVITIES AND ALL DISTURBED AREAS HAVE BEEN STABILIZED. ALL TEMPORARY CONTROL DEVICES SHALL BE REMOVED ONCE CONSTRUCTION IS COMPLETED AND THE SITE STABILIZED.
- ALL EROSION CONTROL METHODS SHALL BE IN ACCORDANCE WITH "SCDHEC STORM WATER MANAGEMENT & SEDIMENT CONTROL BMP HANDBOOK FOR LAND DISTURBANCE ACTIVITY".
- ALL DISTURBED AREAS, INCLUDING THE CONTRACTORS STAGING AREA, HAUL ROUTES, GRADING LIMITS, ETC., SHALL BE RESTORED TO A SMOOTH LINE AND GRADE WITH POSITIVE DRAINAGE. THE CONTRACTOR SHALL PERMANENTLY SEED ALL DISTURBED AREAS.
- CONTRACTORS ARE REQUIRED TO HAVE RAIN GAUGES AT THE CONSTRUCTION SITE AND THE RAIN TOTALS DOCUMENTED FOR REVIEW BY SPARTANBURG COUNTY AND SCDHEC.
- A PRE-CONSTRUCTION CONFERENCE MUST BE HELD WITH SPARTANBURG COUNTY AT LEAST 48 HOURS PRIOR TO BEGINNING ANY LAND DISTURBING ACTIVITIES. THE OWNER, DESIGN ENGINEER AND CONTRACTOR MUST BE PRESENT AND HAVE OBTAINED THE STORMWATER PERMIT, STAMPED APPROVED PLANS AND THE NOI APPROVAL LETTER FROM SCDHEC BEFORE CALLING SPARTANBURG COUNTY TO SCHEDULE THIS MEETING.

WK DICKSON
community infrastructure consultants
1320 MAIN STREET
SUITE 400
COLUMBIA, SC 29201
(803) 786-4261
(803) 786-4263
WWW.WKDICKSON.COM

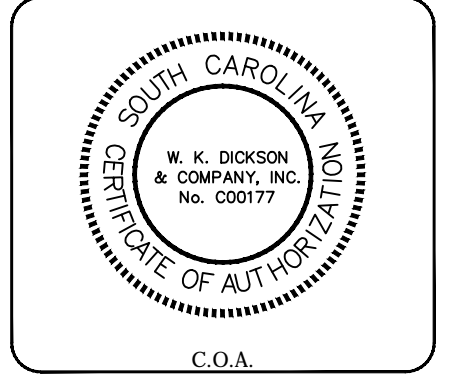

NO.	DATE	DESCRIPTION

PROJECT NAME: REBID USC UPSTATE SMITH CIRCLE PAVEMENT IMPROVEMENTS FOR THE UNIVERSITY OF SOUTH CAROLINA SPARTANBURG COUNTY, SOUTH CAROLINA

DRAWING TITLE: GENERAL NOTES

PROJ. MGR.: BET
DESIGN BY: MDJ
DRAWN BY: MDJ
PROJ. DATE: FEB. 2018
DRAWING NUMBER:
2 OF 4
WKD PROJ. NO.: 20170108.00.CA

REBID DOCUMENTS - DO NOT USE FOR CONSTRUCTION

COPYRIGHT © W.K. DICKSON & COMPANY, INC. ALL RIGHTS RESERVED. REPRODUCTION OR USE OF THE CONTENTS OF THIS DOCUMENT WITHOUT THE WRITTEN PERMISSION OF W.K. DICKSON & COMPANY, INC. IS PROHIBITED. THIS DOCUMENT IS THE PROPERTY OF W.K. DICKSON & COMPANY, INC. AND IS NOT TO BE REPRODUCED OR TRANSMITTED IN ANY FORM OR BY ANY MEANS, ELECTRONIC OR MECHANICAL, INCLUDING PHOTOCOPYING, RECORDING, OR BY ANY INFORMATION STORAGE AND RETRIEVAL SYSTEM.

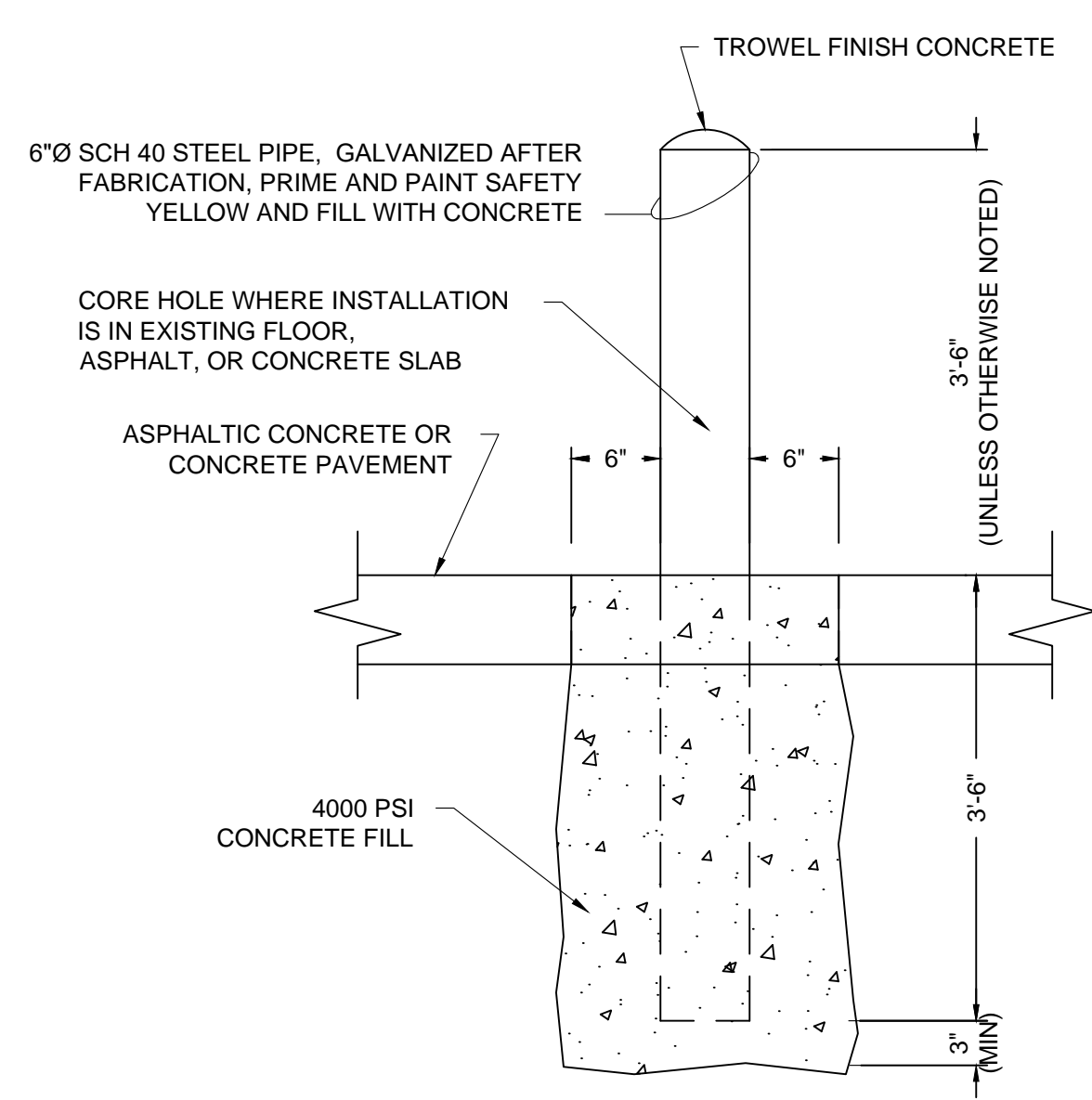
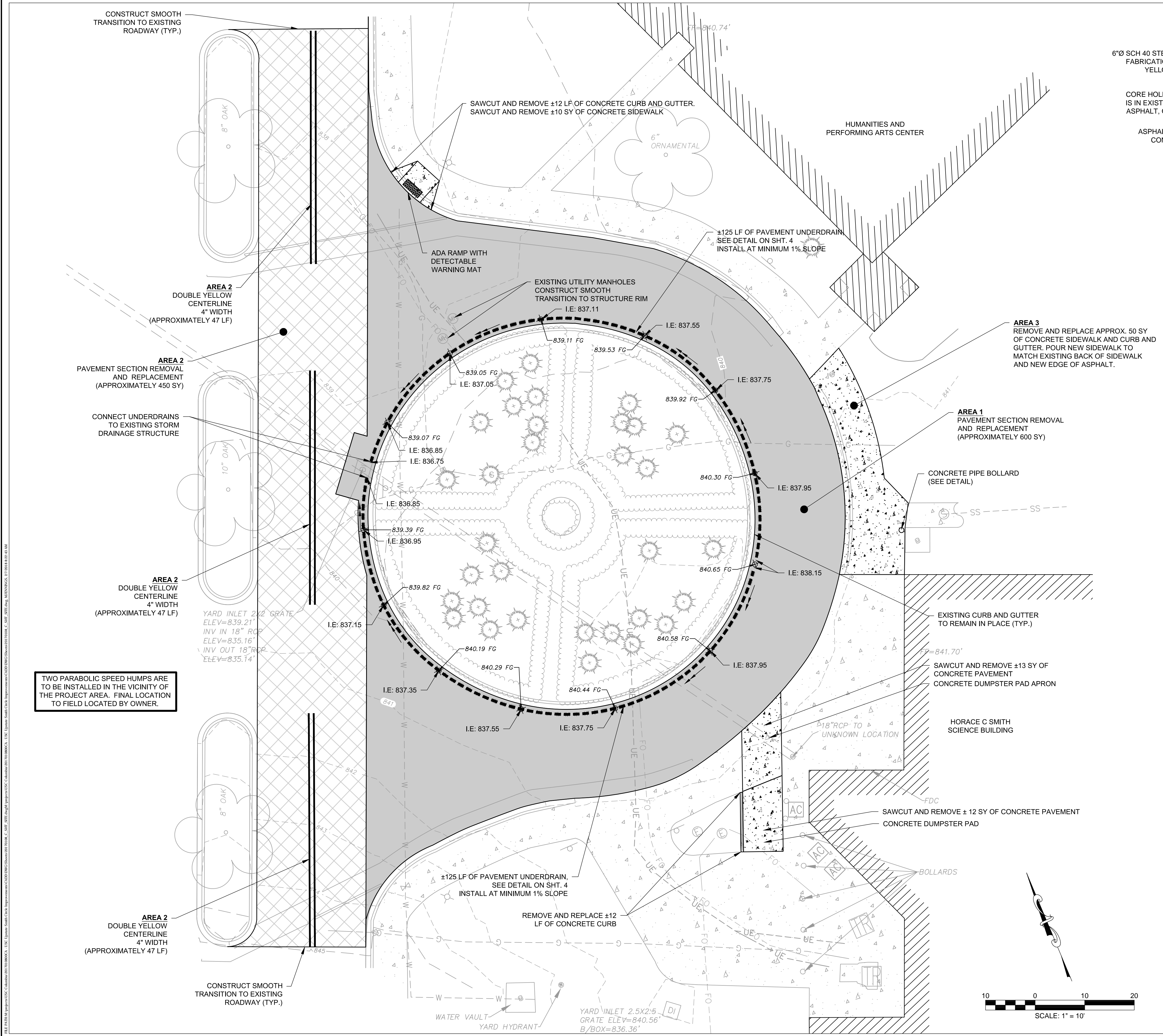

PIPE BOLLARD
NOT TO SCALE

TWO PARABOLIC SPEED HUMPS ARE TO BE INSTALLED IN THE VICINITY OF THE PROJECT AREA. FINAL LOCATION TO FIELD LOCATED BY OWNER.

The Palmetto Utility Protection Service, Inc.
 810 Dutch Square Blvd. Suite 320 Columbia, South Carolina 29210 (803) 939-1117

 Call 811 Before you Dig
 3 DAYS BEFORE DIGGING IN SOUTH CAROLINA
CALL 811
 CONTRACTOR SHALL CONTACT THE UNDERGROUND LOCATORS EVERY 10 DAYS FOR AN UPDATE TO UTILITY LOCATIONS.

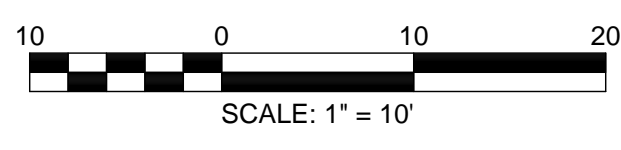

WK DICKSON
 community infrastructure consultants
 1320 MAIN STREET
 SUITE 400
 COLUMBIA, SC 29201
 (803) 786-4261
 (803) 786-4263
 WWW.WKDICKSON.COM

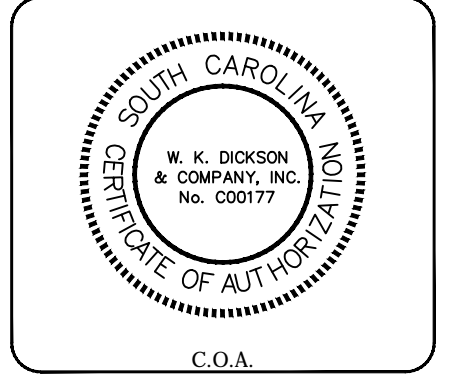

NO.	DATE	DESCRIPTION	BY

PROJECT NAME: **REBID UPSTATE SMITH CIRCLE PAVEMENT IMPROVEMENTS FOR THE UNIVERSITY OF SOUTH CAROLINA SPARTANBURG COUNTY, SOUTH CAROLINA**
 DRAWING TITLE: **SITE IMPROVEMENT PLAN**

PROJ. MGR.: BET
 DESIGN BY: MDJ
 DRAWN BY: MDJ
 PROJ. DATE: FEB. 2018
 DRAWING NUMBER:
3 OF 4
 WKD PROJ. NO.: 20170108.00.CA

REBID DOCUMENTS - DO NOT USE FOR CONSTRUCTION

COPYRIGHT © W.K. DICKSON & COMPANY, INC. ALL RIGHTS RESERVED. REPRODUCTION OF ANY PART OF THIS DRAWING WITHOUT THE WRITTEN PERMISSION OF W.K. DICKSON & COMPANY, INC. IS STRICTLY PROHIBITED. THE INFORMATION CONTAINED HEREIN IS FOR GENERAL INFORMATION ONLY AND DOES NOT CONSTITUTE A CONTRACT. THE CONTRACTOR SHALL BE RESPONSIBLE FOR VERIFYING ALL DIMENSIONS AND CONDITIONS BEFORE BEGINNING WORK.

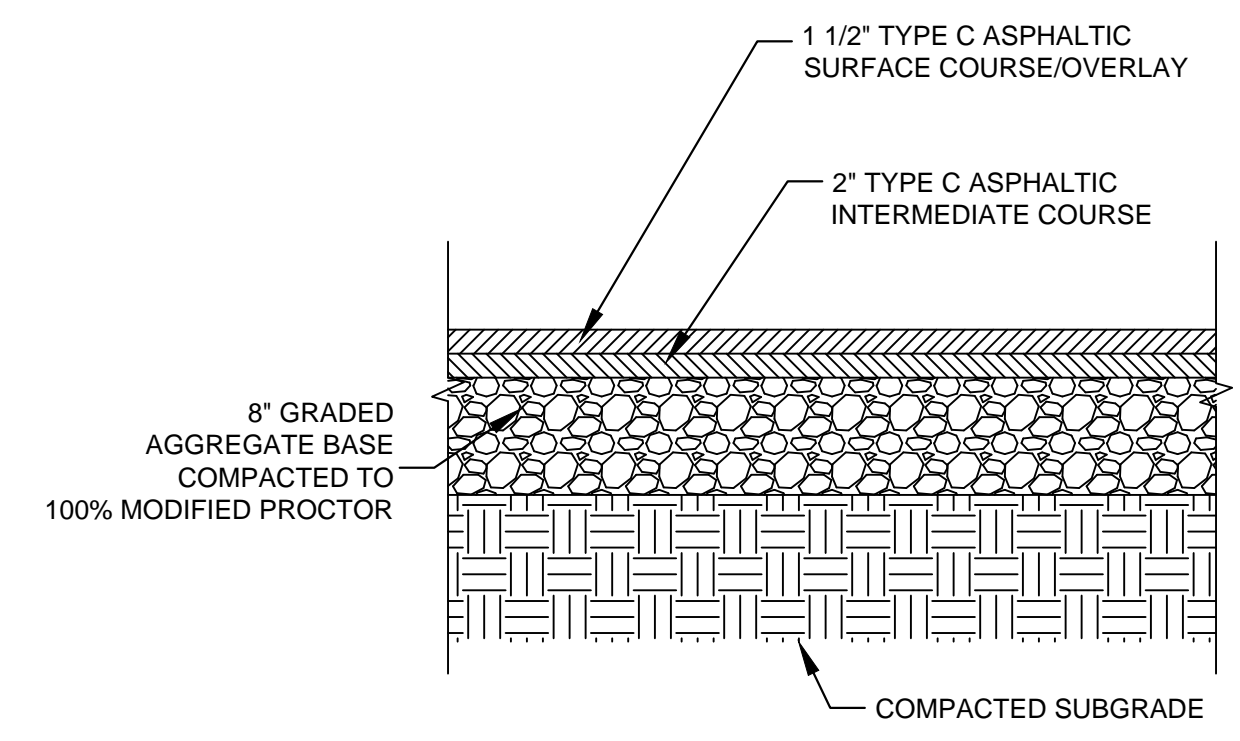

- NOTES:**
- ASPHALT THICKNESS NOTED SHALL BE THE FINAL COMPACTED MATERIAL THICKNESS.
 - SECTION TO BE USED FOR BOTH AREA 1 AND AREA 2 PAVEMENT SECTIONS.

FULL DEPTH ASPHALT PAVEMENT
NOT TO SCALE

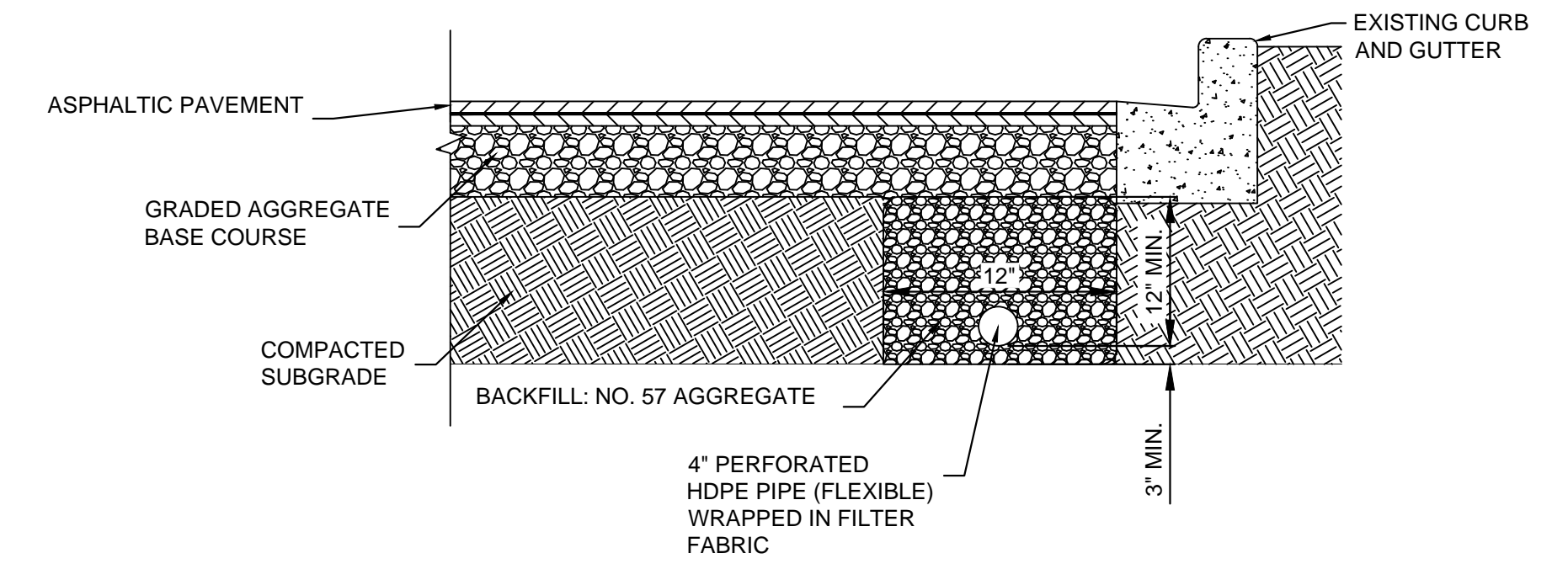

PAVEMENT UNDERDRAIN
NOT TO SCALE

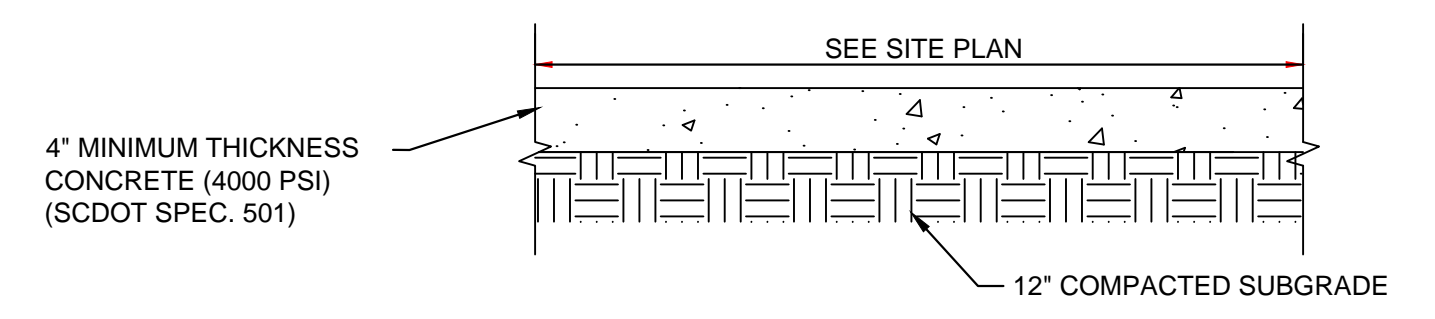

SIDEWALK DETAIL
NOT TO SCALE

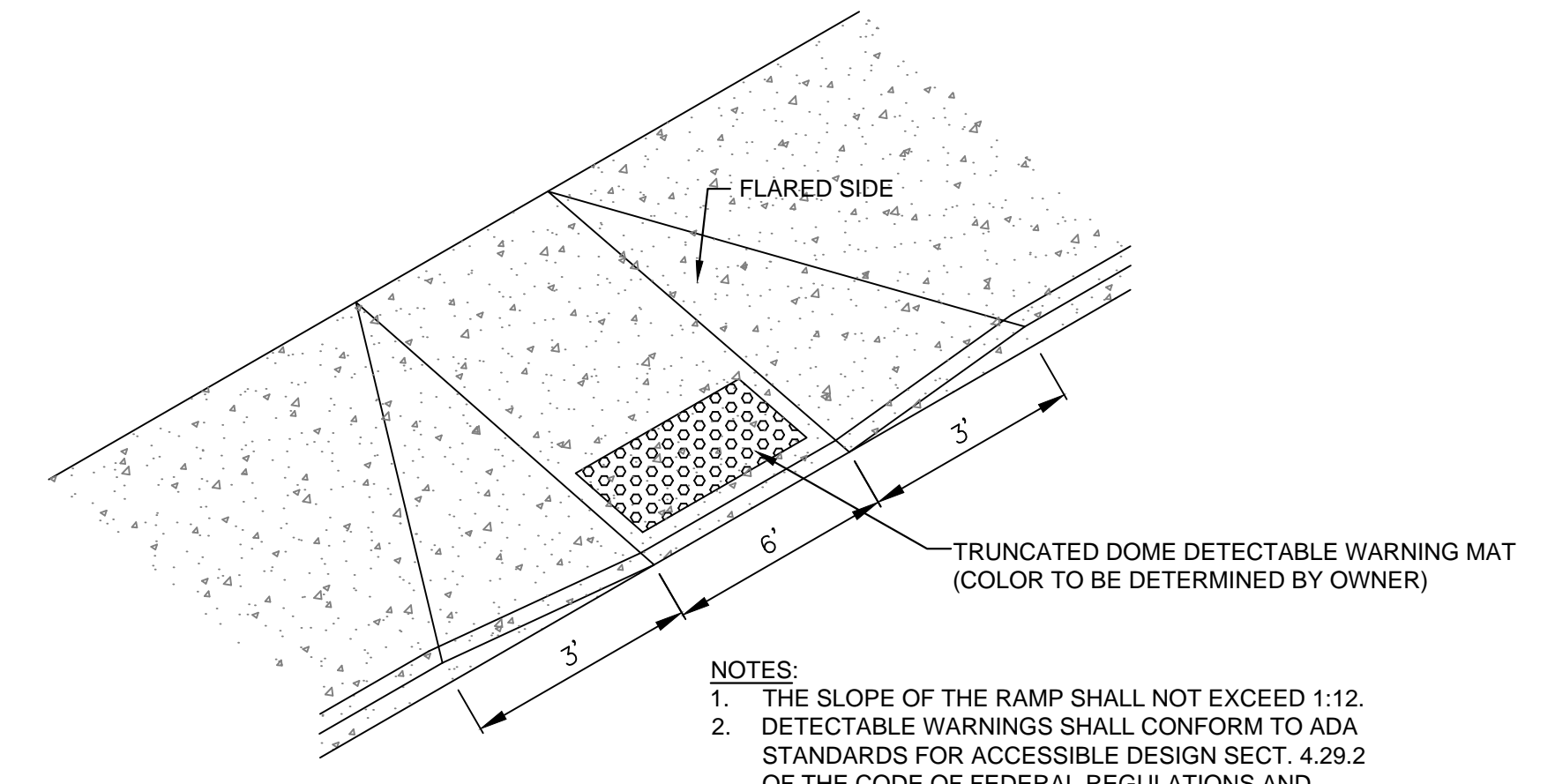

- NOTES:**
- THE SLOPE OF THE RAMP SHALL NOT EXCEED 1:12.
 - DETECTABLE WARNINGS SHALL CONFORM TO ADA STANDARDS FOR ACCESSIBLE DESIGN SECT. 4.29.2 OF THE CODE OF FEDERAL REGULATIONS AND SCDOT REQUIREMENTS.

ADA RAMP
NOT TO SCALE

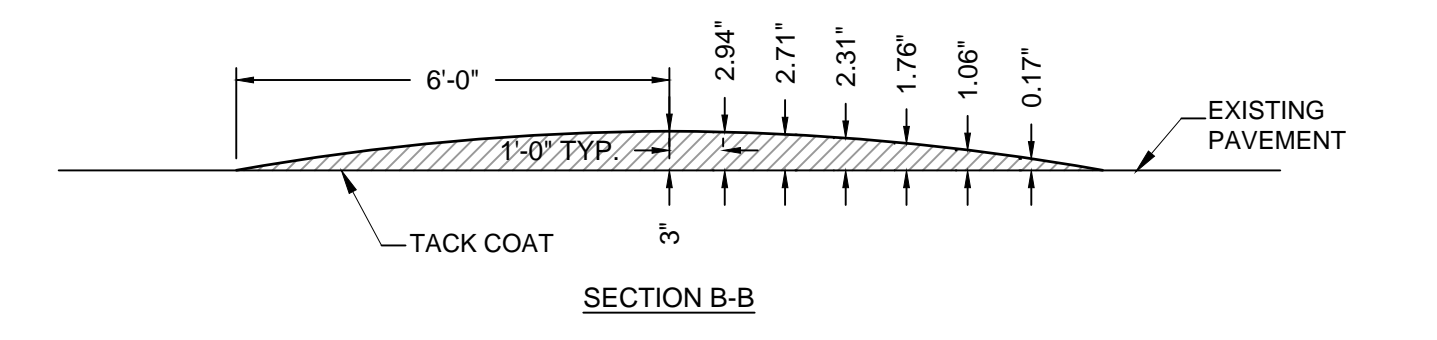
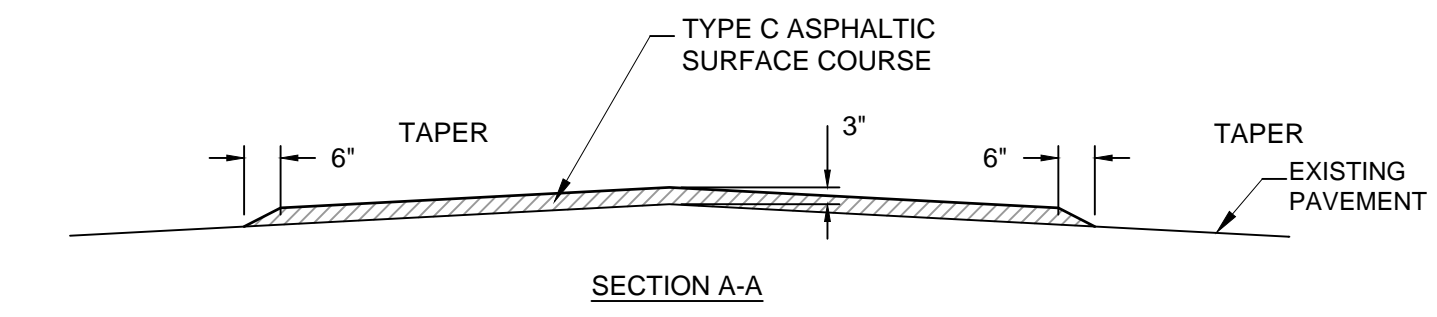
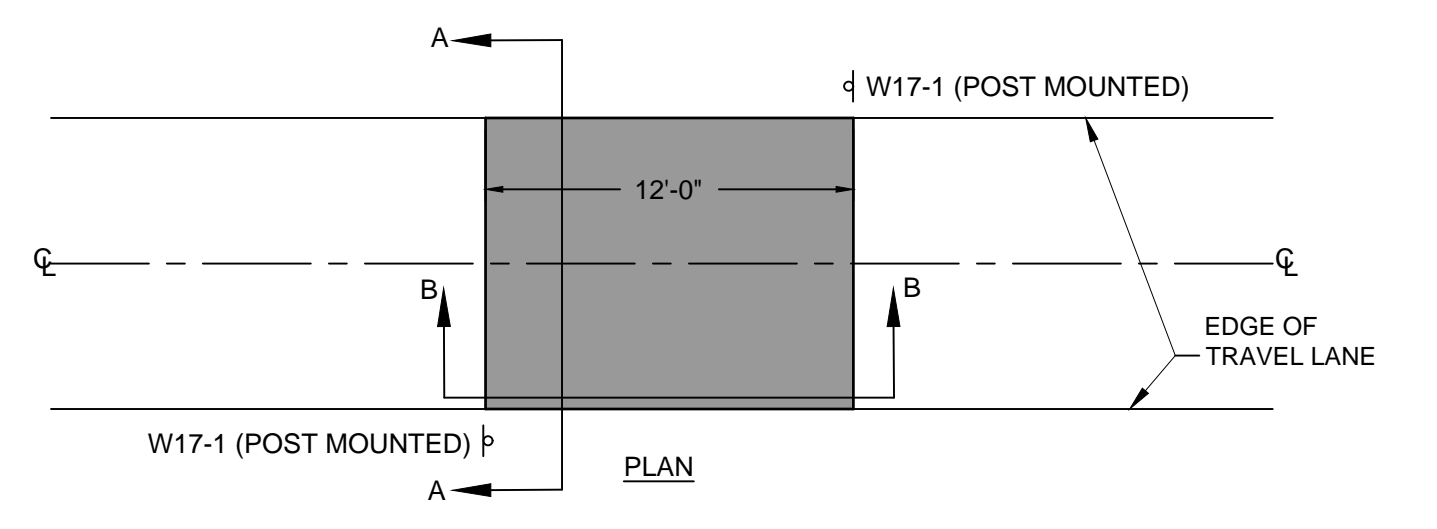

- SIGNAGE LOCATION NOTES:**
- ALL SIGNAGE SHALL BE INSTALLED A MINIMUM OF 6 FEET FROM EDGE OF PAVEMENT IN RURAL LOCATIONS AND A MINIMUM OF 2 FEET FROM EDGE OF PAVEMENT IN URBAN LOCATIONS.
 - FACE ALL SIGNS IN APPROPRIATE DIRECTION.
 - ALL TRAFFIC SIGNS AND PAVEMENT MARKINGS SHALL MEET ALL REQUIREMENTS OF THE MANUAL ON UNIFORM TRAFFIC CONTROL DEVICES (MUTCD).
 - ROAD SIGNAGE SHALL BE MOUNTED ON GALVANIZED STEEL 2"x2" SQUARE BASE POST. ADA SIGNAGE SHALL BE MOUNTED ON U-POST. IN STREET PEDESTRIAN CROSSING SIGN (MUTCD R1-6) SHALL BE MOUNTED ON A SELF-RIGHTING FIXED BASE AT THE CROSSWALK ON THE CENTER LINE.
 - SPEED HUMP AND ADVISORY SPEED SIGNS TO BE MOUNTED ON THE SAME POST.
 - REFER TO MUTCD REQUIREMENTS FOR MOUNTING HEIGHT.

PARABOLIC SPEED HUMP
NOT TO SCALE

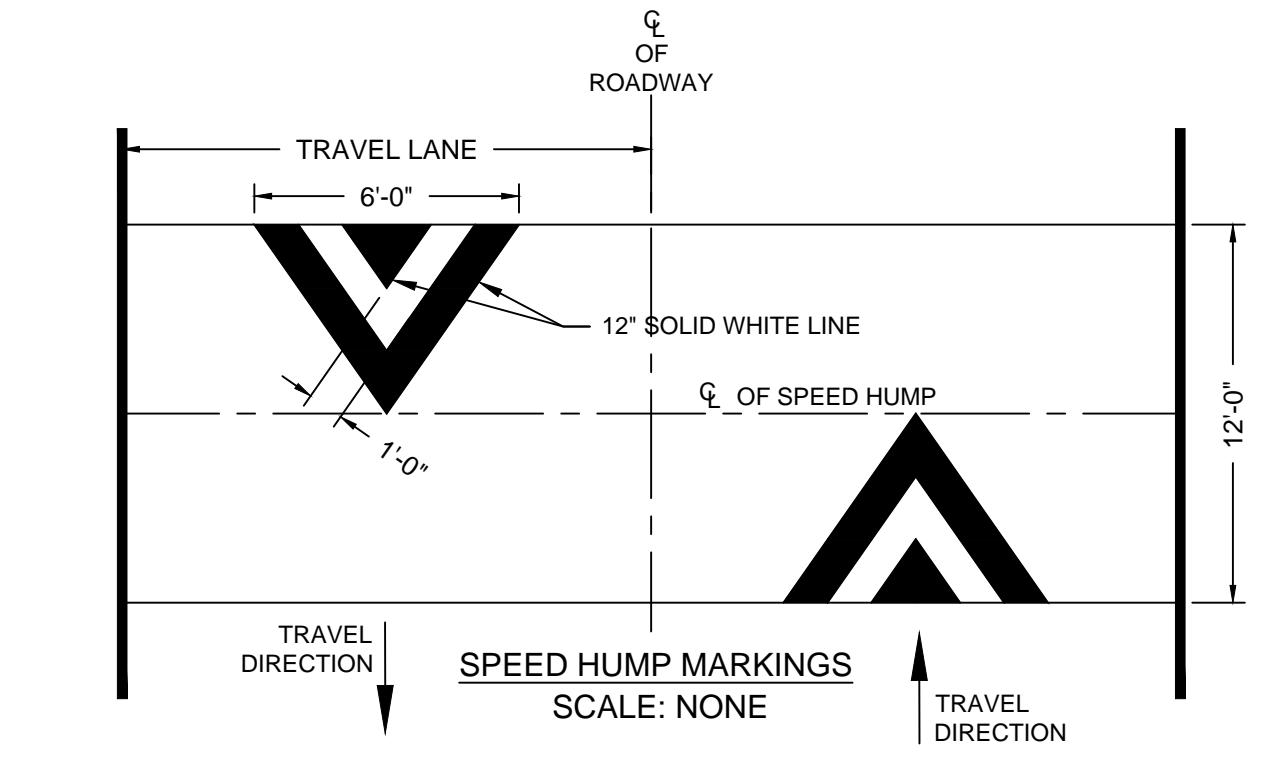

- NOTES:**
- ALL TRAFFIC SIGNS AND PAVEMENT MARKINGS SHALL MEET ALL REQUIREMENTS OF THE MANUAL ON UNIFORM TRAFFIC CONTROL DEVICES.
 - APPLY ALL ROADWAY STRIPING AND MARKINGS AS TEMPORARY PAINT IMMEDIATELY AFTER APPLICATION OF FINAL SURFACE.
 - APPLY ALL ROADWAY STRIPING AND MARKINGS AS PERMANENT THERMOPLASTIC WITH REFLECTIVE GLASS SPHERES NOT LESS THAN TWO WEEKS, AND NOT GREATER THAN FOUR WEEKS AFTER APPLICATION OF FINAL SURFACE COURSE.
 - PARKING SPACE STRIPING MAY BE NON-REFLECTIVE ACRYLIC PAINT.

PAVEMENT STRIPING AND MARKING STANDARDS
NOT TO SCALE

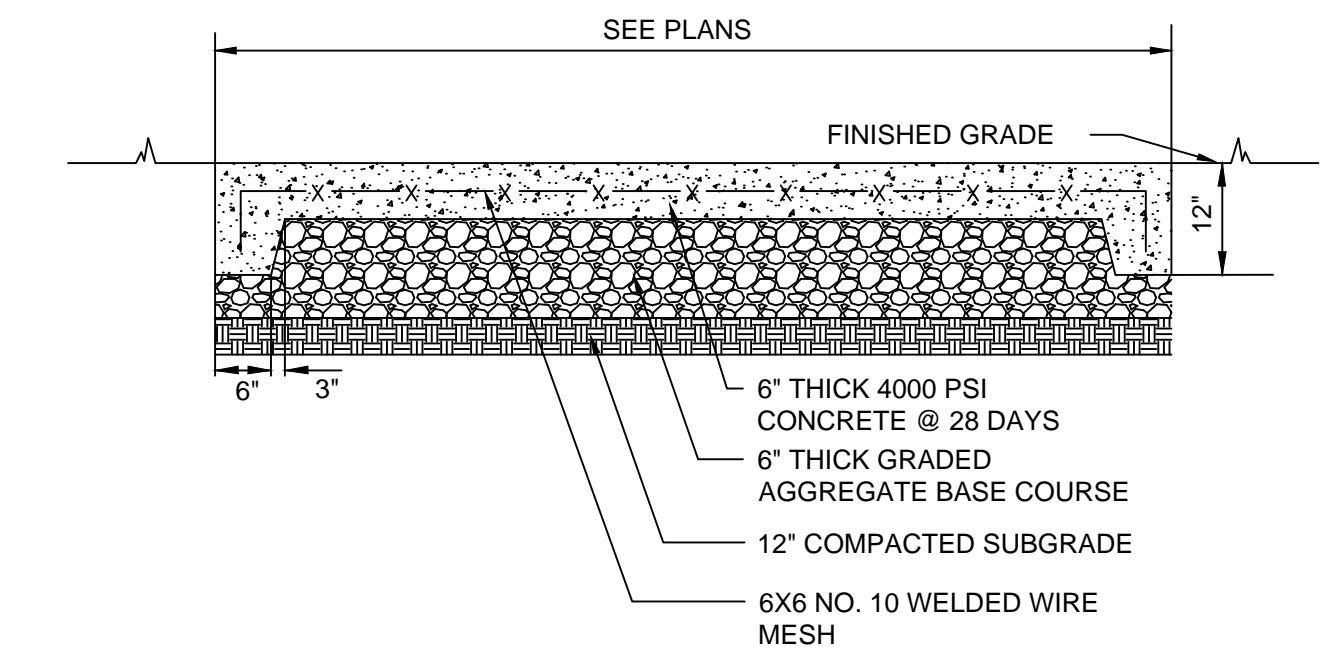

CONCRETE DUMPSTER PAD AND APRON
NOT TO SCALE

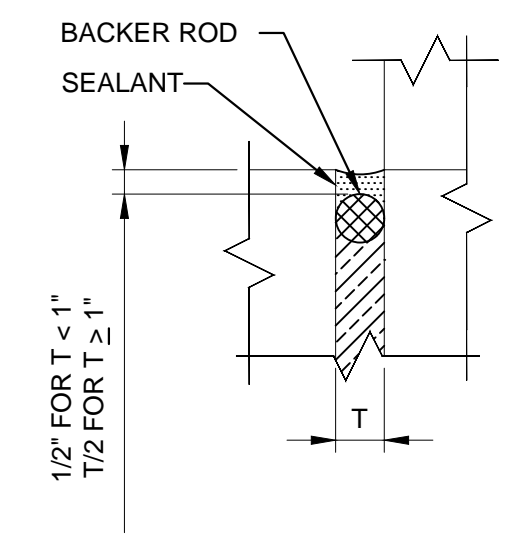

- NOTES:**
- USE T=1" FOR NEW CONCRETE ADJACENT TO BUILDINGS OR EXISTING SAW-CUT PAVEMENT/CONCRETE.
 - PROVIDE 1/2" EXPANSION JOINT WHERE CONCRETE PAVING AND SIDEWALK ABUTS ADJACENT STRUCTURES AND DISSIMILAR SURFACES.

EXPANSION JOINT
NOT TO SCALE

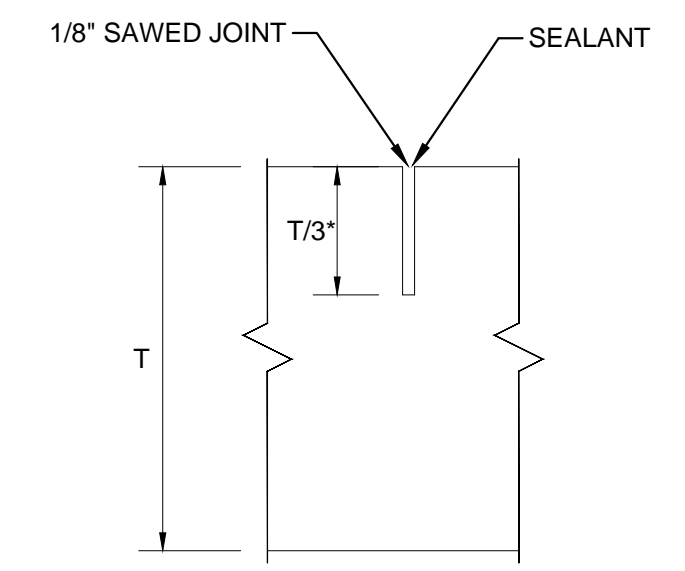

- NOTES:**
- JOINTS SHALL BE LOCATED AS SHOWN ON THE PLANS OR 15'-0" OC EW (MAX).
 - JOINT DEPTH = 2 1/2" (MAX)

CONTROL JOINT
NOT TO SCALE

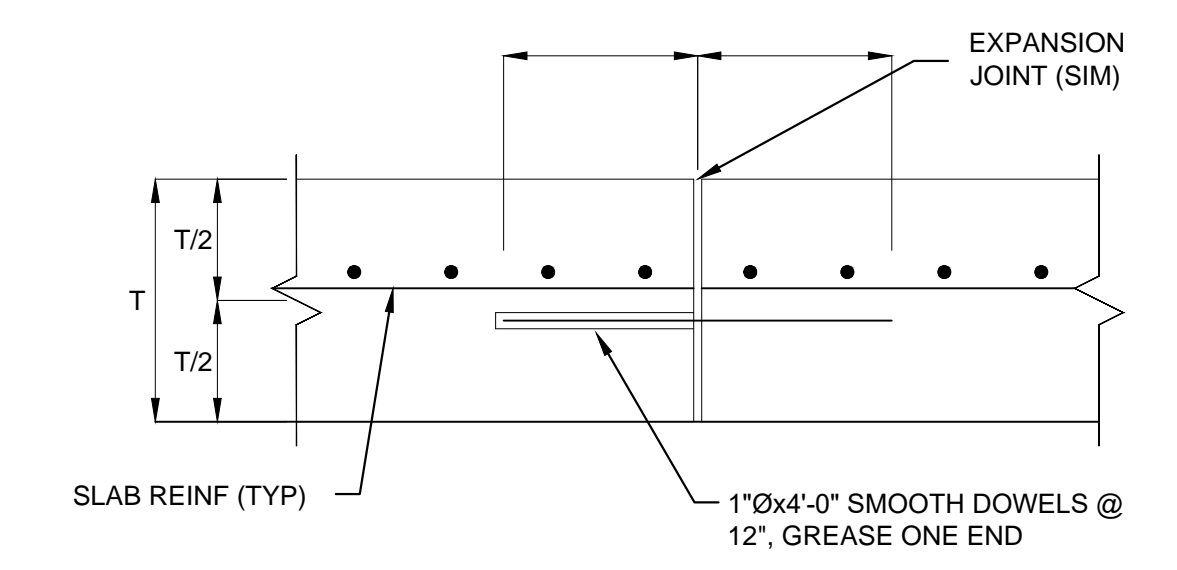

- NOTES:**
- JOINTS SHALL BE LOCATED AS SHOWN ON THE PLANS OR 30'-0" OC EW (MAX).

CONSTRUCTION JOINT
NOT TO SCALE

WK DICKSON
community infrastructure consultants
1320 MAIN STREET
SUITE 400
COLUMBIA, SC 29201
(803) 786-4261
(803) 786-4263
WWW.WKDICKSON.COM

SOUTH CAROLINA
W. K. DICKSON & COMPANY, INC.
No. C00177
STATE OF SOUTH CAROLINA
COMMISSION OF AUTOMATIC REGISTRATION
C.O.A.

SOUTH CAROLINA
W. K. DICKSON & COMPANY, INC.
No. 25136
DATE: 2/18/18
STATE OF SOUTH CAROLINA
COMMISSION OF AUTOMATIC REGISTRATION
PROFESSIONAL SEAL

REVISION RECORD	DESCRIPTION	BY	DATE

PROJECT NAME: REBID US STATE SMITH CIRCLE PAVEMENT IMPROVEMENTS FOR THE UNIVERSITY OF SOUTH CAROLINA SPARTANBURG COUNTY, SOUTH CAROLINA
DRAWING TITLE: SITE DETAILS

PROJ. MGR.: BET
DESIGN BY: MDJ
DRAWN BY: MDJ
PROJ. DATE: FEB. 2018
DRAWING NUMBER:

4 OF 4
WKD PROJ. NO.: 20170108.00.CA

REBID DOCUMENTS - DO NOT USE FOR CONSTRUCTION