



ISSUE DATE: MARCH 29, 2017  
PHASE: CONSTRUCTION DOCUMENTS

#	DATE	REVISION

FIRE PROTECTION  
- LEVELS 100 &  
200

**SPECIFICATIONS**

SPRINKLER PIPING

ALL PIPING 2-1/2" AND LARGER SHALL BE SCHEDULE 10 STEEL PIPING AND ALL PIPING SMALLER THAN 2-1/2" SHALL BE SCHEDULE 40 STEEL PIPING.

HEAT TRACE

THERMON, OR APPROVED EQUAL, MODEL SFUX 1-0J WITH AMBIENT SENSING CONTROL (84X-1540). CONNECT TO EXISTING HEAT TRACE AND SPLICE IN AS REQUIRED FOR A FULLY OPERATIONAL SYSTEM.

INSULATION

ALL SPRINKLER PIPING NOTED ON PLAN TO BE INSULATED SHALL BE INSULATED WITH HEAVY DENSITY FIBERGLASS WITH ALL SERVICE JACKET OWENS CORNING DOWLE SEW SEALING LAP ABUSER 4. ONE PIECE TO BE USED ON ALL LINES ABOVE AND BELOW AMBIENT TEMPERATURE FROM 0" TO 80". ALL INSULATION SHALL BE PROTECTED WITH ALUMINUM JACKETING WITH FACTORY APPLIED MOISTURE BARRIER. THE ALUMINUM JACKETING SHALL BE APPLIED WITH 1/2" INCH CIRCUMFERENTIAL AND 1-1/2" INCH LONGITUDINAL LAP AND SECURED WITH 30-WHICH ALUMINUM BANDS 8 INCHES ON CENTER.

**NOTES TO SHEET**

- CONNECT TO EXISTING PIPING AT THIS APPROXIMATE LOCATION. MAKE ANY REQUIRED CHANGES IN SIZE, COORDINATE ROUTING WITH EXISTING PIPING, ELECTRICAL CONDUIT, ETC. INSULATION SHALL BE INSTALLED UP TO HEATED ENVELOPE.
- FIRE SPRINKLER PIPING TO BE HEAT TRACED AND WRAPPED WITH 1" THICK FIBERGLASS INSULATION AND COVERED WITH METAL JACKETING. ENTIRE ASSEMBLY SHALL BE MARKED WITH IDENTIFICATION TAPE EVERY 20'-0". COORDINATE ROUTING WITH PIPING, ELECTRICAL CONDUIT, ETC.

**GENERAL NOTES**

- SUBMIT DRAWINGS INDICATING EXACT LOCATION OF ALL SPRINKLER HEADS FOR ARCHITECT'S REVIEW AND BRING ALL FIELD CORRECTIONS AND REQUIRED ADJUSTMENTS TO THE ARCHITECT'S ATTENTION FOR VERIFICATION OF FINAL LOCATION OF ALL SPRINKLER HEADS.
- SPRINKLER DRAWINGS PROVIDED ARE TO ASSIST THE CONTRACTOR. SUCCESSFUL CONTRACTOR IS RESPONSIBLE FOR THE DESIGN AND INSTALLATION OF A COMPLETE SYSTEMS WITH THESE PLANS AND SPECIFICATIONS AND IN COMPLIANCE WITH ALL APPLICABLE CODES. CONTRACTOR SHALL BE RESPONSIBLE FOR SUBMITTING TO THE OFFICE OF THE STATE FIRE MARSHAL.
- THE DESIGN TEAM TO INSURE COMPATIBILITY WITH THE BUILDING DESIGN INTENT. WILL CAREFULLY REVIEW SPRINKLER PLANS. CORRECTIONS WILL BE MADE BY THE CONTRACTOR AT NO ADDITIONAL EXPENSE TO THE OWNER.
- SYSTEM DRAINS SHALL BE INSTALLED AS REQUIRED PER NFPA. DRAINS SHALL BE EXTENDED OUTSIDE THE BUILDING. DRAIN LOCATIONS SHALL BE APPROVED BY THE A/E TEAM AND SHALL BE INDICATED ON THE SHOP DRAWINGS.
- PROVIDE NECESSARY GUARDS OVER EQUIPMENT IN ELECTRICAL ROOMS WHERE REQUIRED BY NFPA 13.
- WHERE PIPING IS TO BE RUN EXPOSED, SUCH AS STAIRWELLS, CARE SHALL BE TAKEN TO MINIMIZE THE ABILITY OF BUILDING OCCUPANTS TO TOUCH, HANG FROM, OR OTHERWISE VANDALIZE FIRE PROTECTION.
- SPRINKLER HEADS SHALL BE LOCATED A MINIMUM OF 6" AWAY FROM CEILING GRID IN ALL ACoustICAL CEILING TILES. HEADS IN PUBLIC SPACES SHALL BE RECESSED HEADS WITH CHROME FINISH.
- SPRINKLER PIPING SHALL BE INSTALLED TO MEET SEISMIC REQUIREMENTS WITH LATERAL SWAY BRACING, LONGITUDINAL SWAY BRACING, AND FOUR-WAY BRACING AS REQUIRED BY NFPA AND THE INTERNATIONAL BUILDING CODES.
- ALL PIPING 2-1/2" AND LARGER SHALL BE SCHEDULE 10 STEEL PIPING AND ALL PIPING SMALLER THAN 2-1/2" SHALL BE SCHEDULE 40 STEEL PIPING.

NOTE:  
PROVIDE NEW NFPA 13 - 2013 EDITION COMPLIANT SPRINKLER SYSTEM FOR AREA OF WORK INDICATED ON PLAN.

**LEGEND**

□ LIGHT HAZARD

**FIRE PUMP INFORMATION**

NOTE:  
THE MOST RECENT FLOW TEST DATA FROM THE EXISTING FIRE PUMP INDICATES A PUMP CAPACITY OF 1250 GPM WITH A RATED PRESSURE OF 120 PSI. PUMP TEST PERFORMED ON 8/8/16 BY PALMETTO AUTOMATIC SPRINKLER INDICATES:

FLOW	SUCTION PRESSURE	DISCHARGE PRESSURE	NET PUMP PRESSURE	ACTUAL FLOW
100%	58	172	114	...
150%	53	165	112	1262
150%	50	154	104	1889

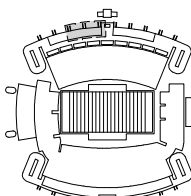

KEY PLAN

Swygert & Associates  
CONSULTING ENGINEERS  
201 S. State St. Suite 1000  
Columbia, SC 29201  
Tel: 803.799.1111 Fax: 803.799.1112

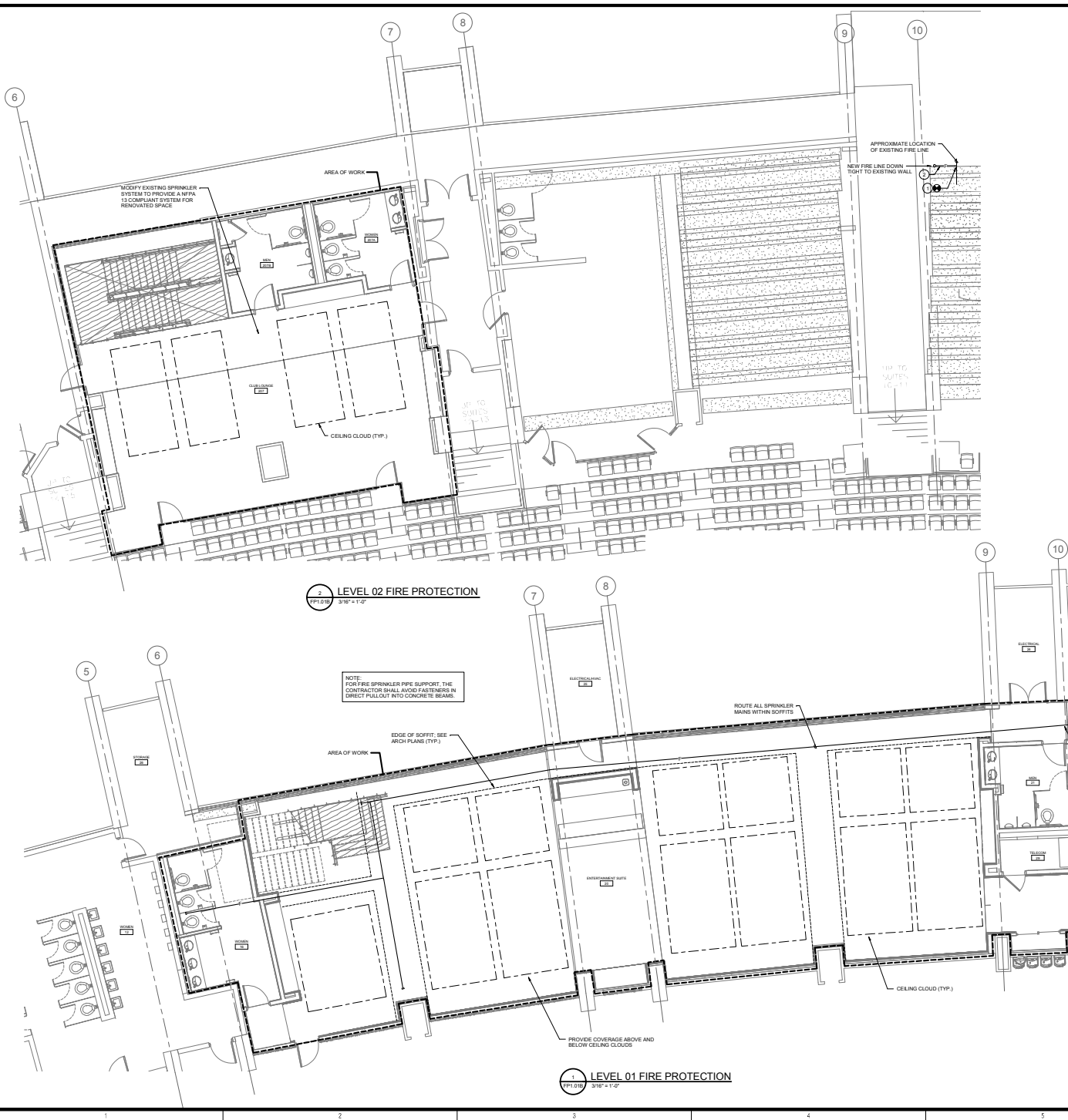

**2 LEVEL 02 FIRE PROTECTION**  
FP1.01B 3/18 - 3/19

**1 LEVEL 01 FIRE PROTECTION**  
FP1.01B 3/18 - 3/19

NOTE:  
FOR FIRE SPRINKLER PIPE SUPPORT, THE CONTRACTOR SHALL AVOID FASTENERS IN DIRECT PULLOUT INTO CONCRETE BEAMS.

Swygert & Associates  
CONSULTING ENGINEERS  
201 S. State St. Suite 1000  
Columbia, SC 29201  
Tel: 803.799.1111 Fax: 803.799.1112