



UNIVERSITY OF SOUTH CAROLINA

AMENDMENT NO. 1 TO SOLICITATION

DATE: March 23, 2017

TO: ALL VENDORS

FROM: Juaquana Brookins, Procurement Officer

SUBJECT: USC-IFB-3075-JB

DESCRIPTION: Landscape/Grounds Maintenance Services for USC Law School

This Amendment No.1 modifies the Requests for Proposals only in the manner and to the extent as stated herein.

**Questions and Answers from Contractors
Drawings L.2 and L.3
Revised Bid Schedule**

OFFERORS SHALL ACKNOWLEDGE RECEIPT OF AMENDMENT NO. 1 IN THE SPACE PROVIDED BELOW AND RETURN IT WITH THEIR BID RESPONSE. FAILURE TO DO SO MAY SUBJECT BID TO REJECTION.

Authorized Signature

Name of Offeror

Date

Questions and Answers

1. The buildings are in various states of construction. Will there be a bid for each of the three buildings or will there be one all-encompassing bid?

One bid for entire site prorated for Horry Guignard and Taylor House to be added as completed prior to August 2017.

2. How many irrigation controllers and how many zones per controller?

There are two(2) controllers, one at the interior courtyard which runs 1 zones. The exterior controller currently runs nine (9) zones, with future expansions with a total of 13 or 14 zones.

3. Will the property be pre emerged prior to the contract start date?

No, the property will not be pre emerged prior to start of contract.

4. Can we obtain a copy of the landscape blueprint?

See Attached Plans L.2 and L.3.

5. Does the contract include curb to curb or sidewalk to sidewalk the drawing is unclear?

This contract requires curb to curb maintenance.

6. Are there time restrictions for the contractor to perform the work on the inside court yards and are there any other time restrictions that the work can be performed?

Yes. The work will be performed without interruption of operation of the school. Normal business hours will normally prevail, however, there will be times when the work will be restricted such as during exams or special events.

7. Can the contractor use gas powered equipment inside the courtyards?

No.

8. Where will the contractor be allowed to park vehicles on equipment?

The contractor will be park on site in designated areas, determined at the kick off meeting prior to commencing work.

VIII. BIDDING SCHEDULE / PRICE-BUSINESS PROPOSAL

Item	Qty	Unit of Measure	Description	Unit Price
1	1	YR	Annual Cost for Grounds Maintenance services for the USC Law School, per specifications herein. (~208,000 SF)	\$

Resident Contractor Preference _____
 Resident Sub-Contractor Preference (2%) _____ Number of Sub-Contractors _____
 Resident Sub-Contractor Preference (4%) _____ Number of Sub-Contractors _____

For information purposes only. Please provide annual/yearly pricing for the below areas.

Law School 171, 000 SF _____
 Taylor House 20, 000 SF _____
 Horry Guignard 17,000 SF _____

Note: The SF includes the building footprint and all hardscape.

Note: The service preferences do not apply to a bid for an item of work by the bidder if the annual price of the bidder’s work exceeds \$50,000 or the total potential price of the bidder’s work exceeds \$500,000. [11-35-1524(E)(3)]

Please refer to the preference clauses listed in the additional conditions of this solicitation to ensure that you qualify to select the above preferences.

Bidder is to submit the following for preferences requested above:

- 1) Identify the subcontractor to perform the work:
- 2) Identify the work the subcontractor is to perform:
- 3) Bidder’s factual basis for concluding that the subcontractor’s work constitutes the required percentage of the work to be performed in the procurement.

No.	Description	Date
6	Planting Update	12/22/14
7	Planting Update	1/22/16

UNIVERSITY OF SOUTH CAROLINA
 EARLY STRUCTURAL / TAYLOR MANSION RENOVATIONS (BP-1)
 1531 SENATE STREET, COLUMBIA, SC 29201

THE BOUDREAUX GROUP
 1370 14th St., Suite 600 (N700)
 P.O. Box 9905
 Columbia, SC 29220
 803.798.0517
 info@boudreauxgroup.com

SMITHGROUPJJR
 100 New York Avenue NW, Suite 100
 Washington, DC 20004
 T: 202.842.4000
 www.smithgroupjr.com

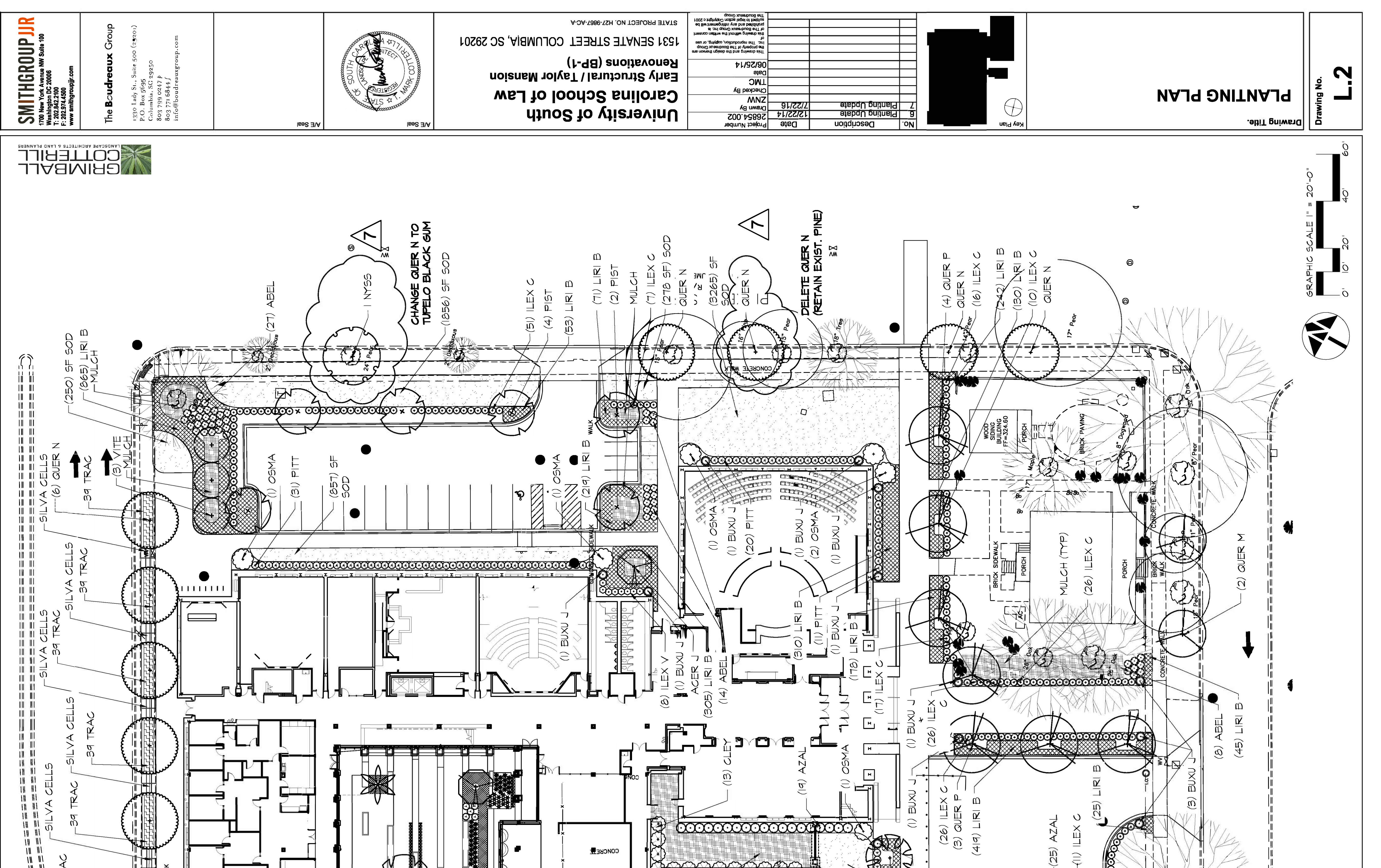

GENERAL NOTES

- EXISTING ECOLOGY AND AESTHETICS WILL OFTEN CAUSE ADJUSTMENT OF THESE PLANS TO FIT THE SITE. STAKE-OUT BY THE CONTRACTOR AND ADJUSTMENT BY THE LANDSCAPE ARCHITECT IS ABSOLUTELY NECESSARY.
- LOCATIONS OF THOSE UTILITIES SHOWN ARE APPROXIMATE AND FOR INFORMATION PURPOSES ONLY. CONTRACTOR SHALL BE RESPONSIBLE FOR THE EXACT LOCATION OF ALL UTILITIES WHETHER SHOWN OR NOT SHOWN ON THESE PLANS, AND SHALL BE RESPONSIBLE FOR ANY AND ALL DAMAGE RESULTING FROM THE FAILURE TO DO SO. CONTACT PALMETTO UTIL PROTECTION SERVICE AT 1-888-721-7671 AT LEAST 72 HOURS PRIOR TO COMMENCING CONSTRUCTION.
- CONTRACTOR SHALL INFORM LANDSCAPE ARCHITECT OF PROPOSED DESIGN IS IN CONFLICT WITH EXISTING OR PROPOSED UTILITIES. CONTRACTOR SHALL COORDINATE WITH LANDSCAPE ARCHITECT PRIOR TO CONSTRUCTION TO ADJUST PROPOSED DESIGN OR UTILITIES AS NECESSARY TO RESOLVE CONFLICTS.
- BASE PLAN DATA DERIVED FROM SITE SURVEY PROVIDED BY LUCIUS COBB IN 2005 AND UPDATED ON JULY 2013 BY SURVEY ONE LLC.

