

ROOF PLAN

LEGEND	
(X##)	= ROOF AREA DESIGNATION
→	= SLOPE IN DECK
—S—D—	= NEW GUTTER & DOWNSPOUT
⊙ _{GV}	= Gravity Vent

Shepard & Associates, LLC
 3547 Disher Shoals Road, Suite 6
 Irmo, South Carolina 29063
 Phone: (803) 407-8284 E-mail: bob@shepa.com Fax: (803) 407-8286

SHEET TITLE: ROOF PLAN
 PROJECT DESCRIPTION: Re-Roofing, Painting & Repairs
 CLIENT NAME: USC-Union Central Building

REVISIONS	DATE	APPROVED

PF No. 11012.013.004
 DATE: 5/26/2016
 SCALE: NTS
 DRAWN: KAS
 CHECKED: WBS

SHEET
R1

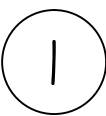
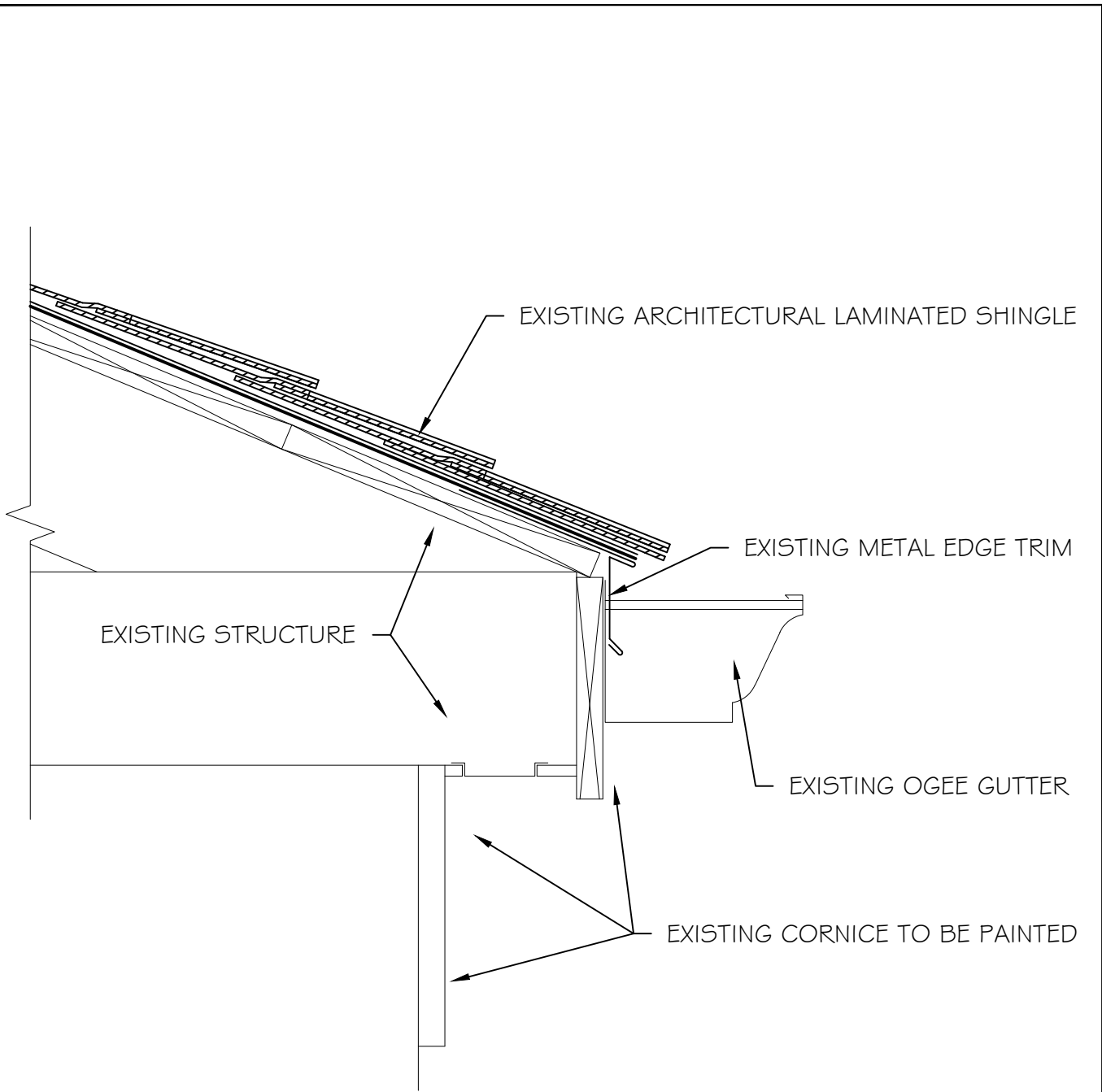

TYPICAL EAVE DETAIL

Shepard & Associates, LLC
 3547 Dreher Shoals Road, Suite 6
 Irmo, South Carolina 29063
 Phone: (803) 407-8284 E-mail: bshep@sc.rr.com Fax: (803) 407-8206

SHEET TITLE:	EAVE DETAIL
PROJECT DESCRIPTION:	Metal Re-Roofing, Painting & Repairs
CLIENT NAME:	USC-Union Central Building

PF No. 11012.013.004
DATE: 5/27/2016
SCALE: NTS
DRAWN BY: KAS
CHECKED BY: WBS

SHEET
D1

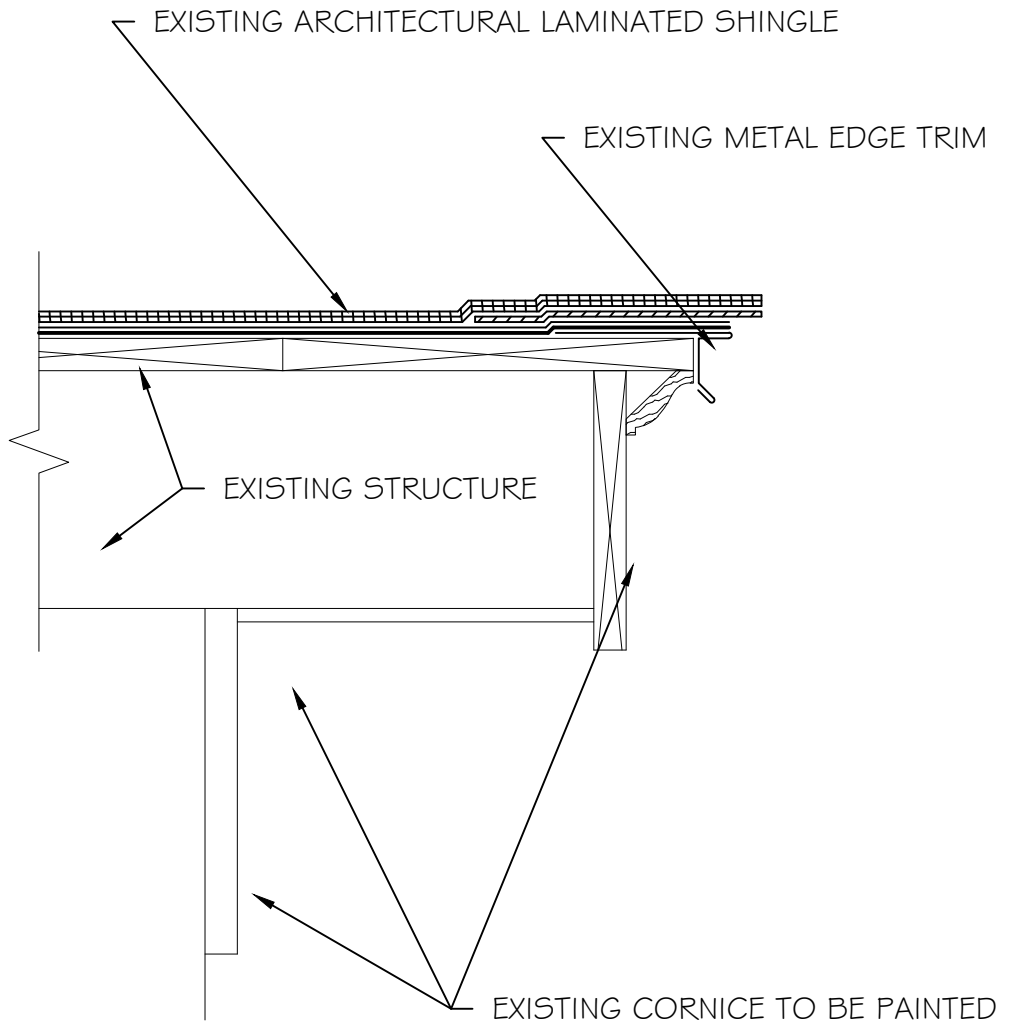

① TYPICAL RAKE SHINGLE DETAIL

Shepard & Associates, LLC
 3547 Dreher Shoals Road, Suite 6
 Irmo, South Carolina 29063
 Phone: (803) 407-8284 E-mail: bshep@sc.rr.com Fax: (803) 407-8206

SHEET TITLE: **RAKE SHINGLE DETAIL**
 PROJECT DESCRIPTION: **Metal Re-Roof, Painting & Repairs**
 CLIENT NAME: **USC-Union Central Building**

PF No. 11012.013.004
 DATE: 5/27/2016
 SCALE: NTS
 DRAWN BY: KAS
 CHECKED BY: WBS

SHEET
D2

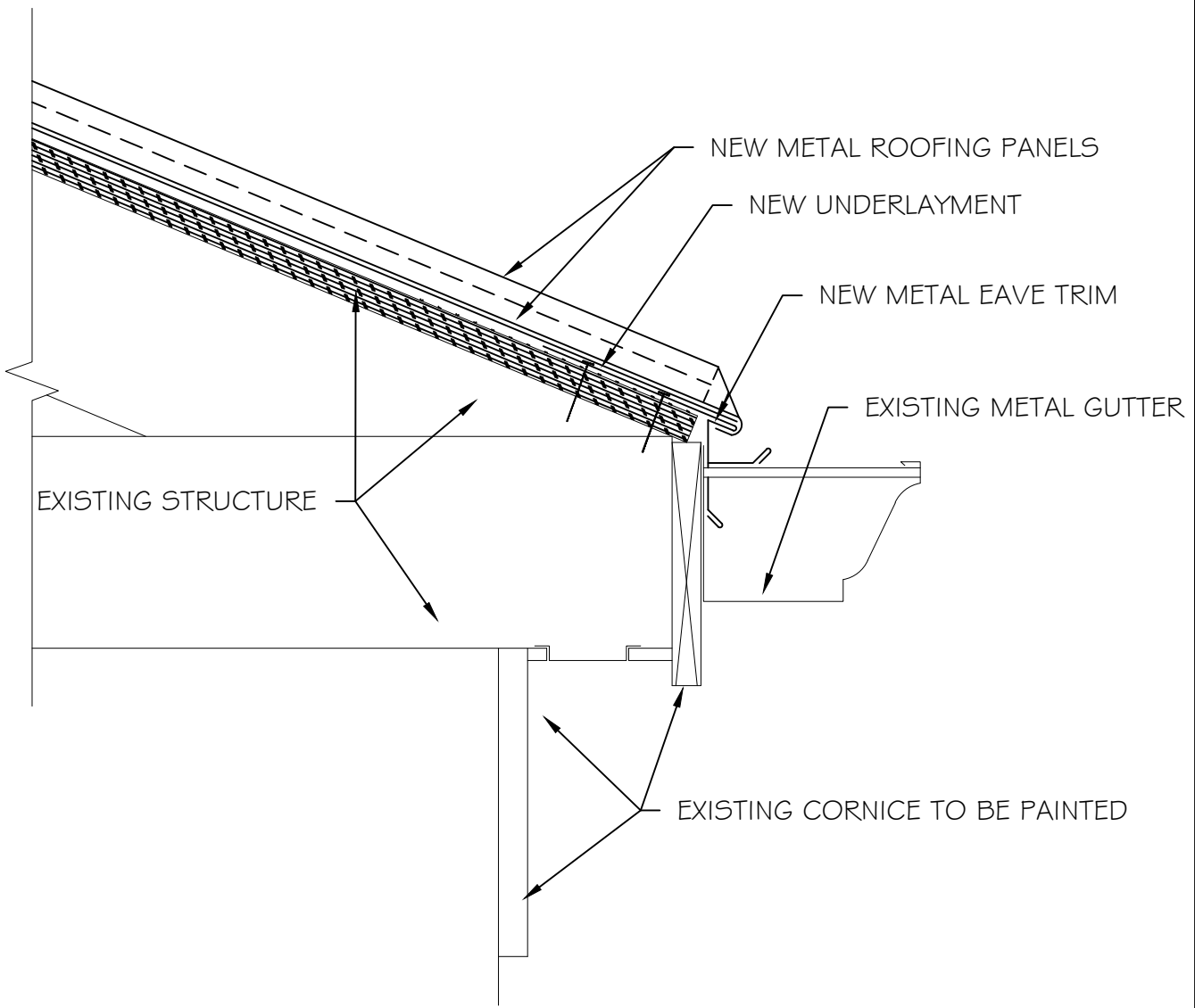

NEW METAL ROOFING PANELS

NEW UNDERLAYMENT

NEW METAL EAVE TRIM

EXISTING METAL GUTTER

EXISTING STRUCTURE

EXISTING CORNICE TO BE PAINTED

1 TYPICAL EAVE DETAIL

Shepard & Associates, LLC
 3547 Dreher Shoals Road, Suite 6
 Irmo, South Carolina 29063
 Phone: (803) 407-8284 E-mail: bshep@sc.rr.com Fax: (803) 407-8206

SHEET TITLE: **EAVE DETAIL**

PROJECT DESCRIPTION: **Metal Re-Roof, Painting & Repairs**

CLIENT NAME: **USC-Union Central Building**

PF No. 11012.013.004
 DATE: 5/27/2016
 SCALE: NTS
 DRAWN BY: KAS
 CHECKED BY: WBS

SHEET
D3

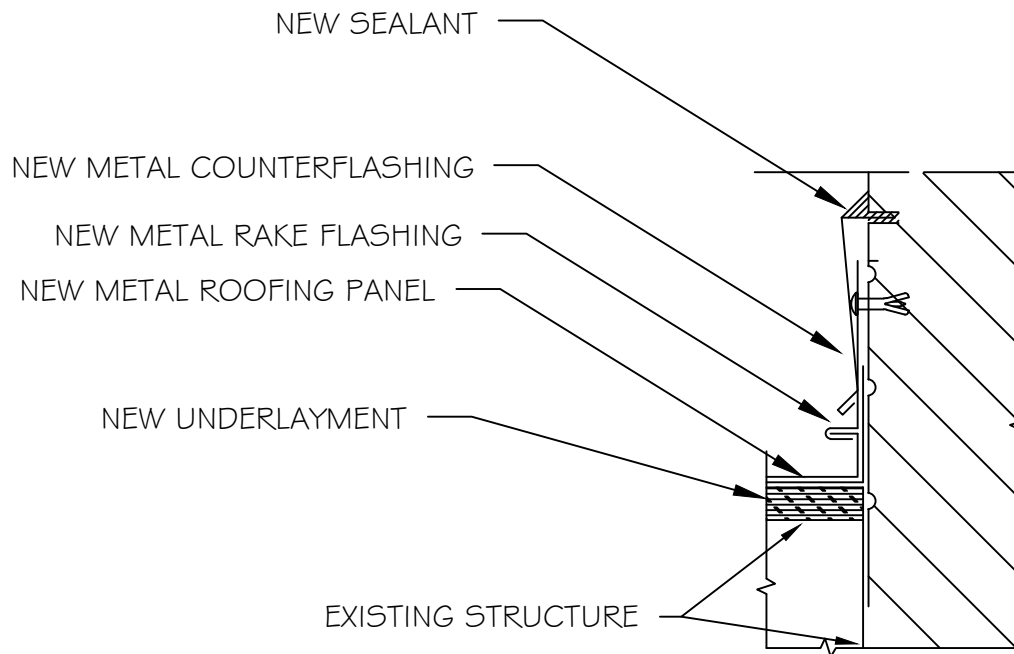

1 Rake Detail

Shepard & Associates, LLC 3547 Dreher Shoals Road, Suite 6 Irmo, South Carolina 29063 Phone: (803) 407-8284 E-mail: bshep@sc.rr.com Fax: (803) 407-8206	SHEET TITLE: RAKE DETAIL	PF No. 11012.013.004 DATE: 5/27/2016	SHEET D4
	PROJECT DESCRIPTION: Metal Re-Roofing, Painting & Repairs	SCALE: NTS	
	CLIENT NAME: USC-Union Central Building	DRAWN BY: KAS	
		CHECKED BY: WBS	

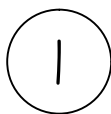
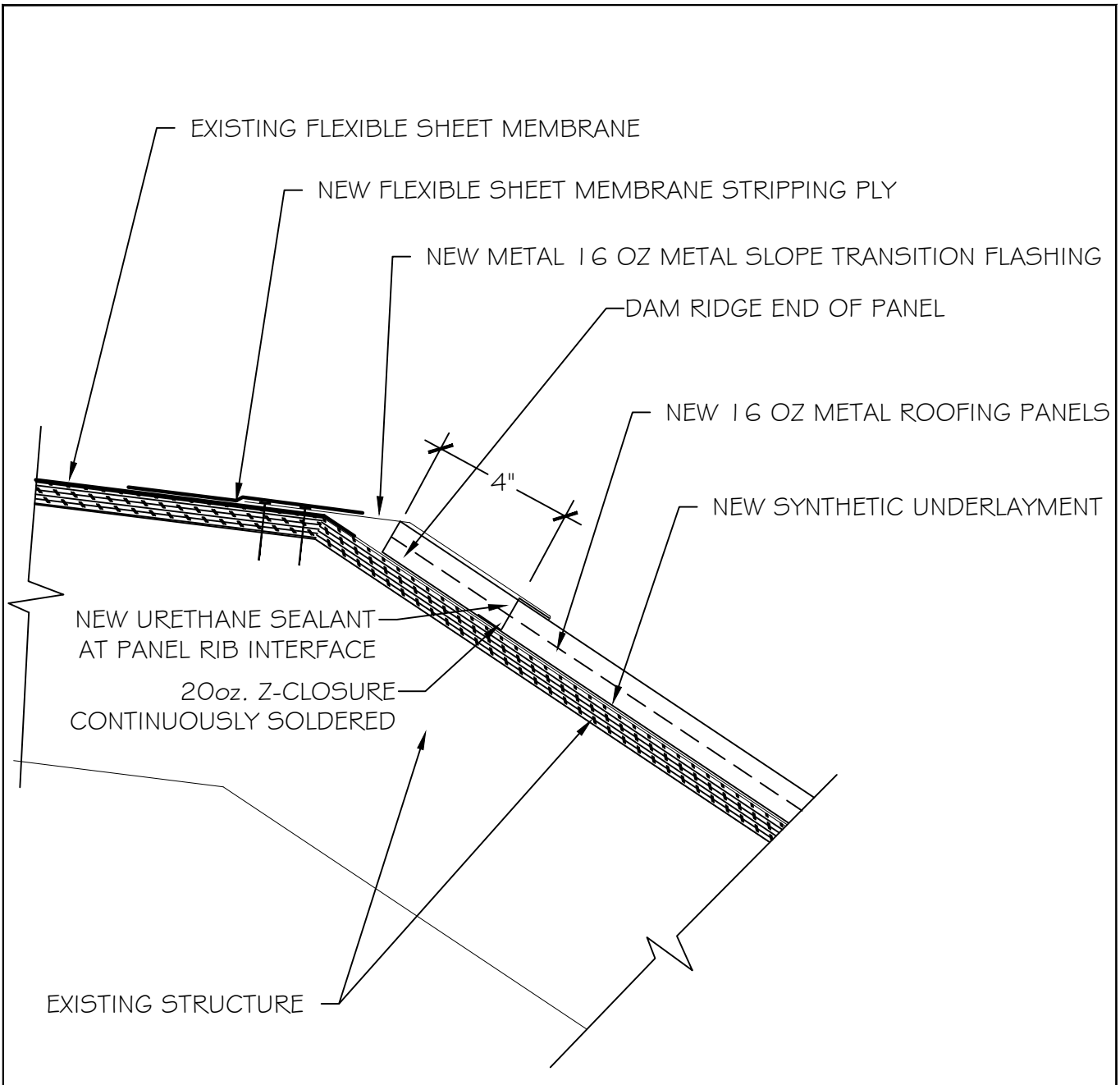

TYPICAL SLOPE TRANSITION DETAIL

Shepard & Associates, LLC
 3547 Dreher Shoals Road, Suite 6
 Irmo, South Carolina 29063
 Phone: (803) 407-8284 E-mail: bshep@sc.rr.com Fax: (803) 407-8206

SHEET TITLE: **SLOPE TRANSITION DETAIL**
 PROJECT DESCRIPTION: **Metal Re-Roof, Painting & Repairs**
 CLIENT NAME: **USC-Union Central Building**

PF No. 11012.013.004
 DATE: 5/27/2016
 SCALE: NTS
 DRAWN BY: KAS
 CHECKED BY: WBS

SHEET
D5

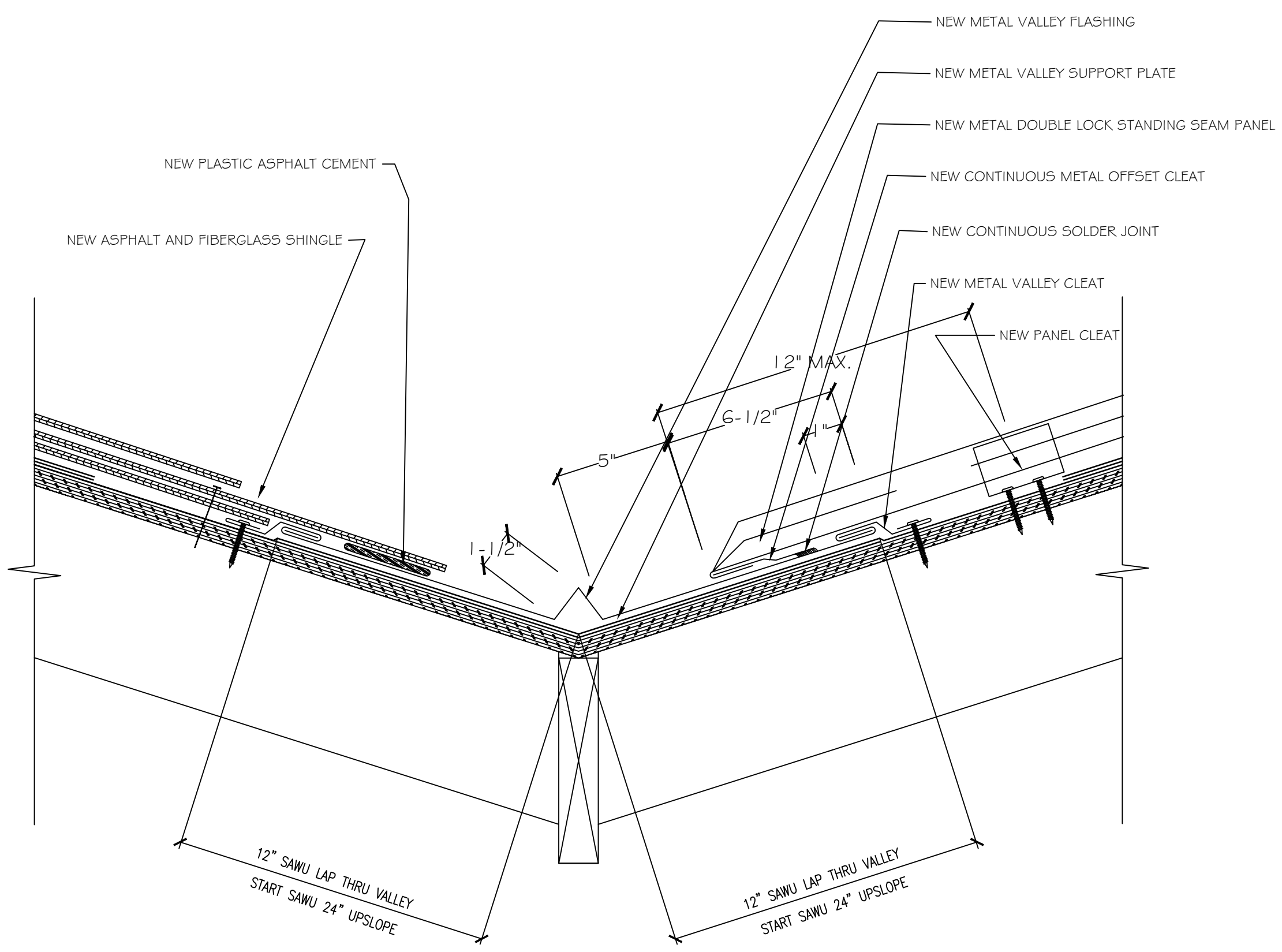

1 TYPICAL VALLEY DETAIL

Shepard & Associates, LLC
 3547 Dreher Shoals Road, Suite 6
 Irmo, South Carolina 29063
 Phone: (803) 407-8284 E-mail: bshp@sc.rr.com Fax: (803) 407-8206

SHEET TITLE: **METAL VALLEY DETAIL**
 PROJECT DESCRIPTION: **Re-Roofing, Painting & Repairs**
 CLIENT NAME: **USC-Union Central Building**

REVISIONS	DATE	APPROVED

PF No. 11012.013.004
 DATE: 5/27/2016
 SCALE: NTS
 DRAWN: KAS
 CHECKED: WBS

SHEET
D6

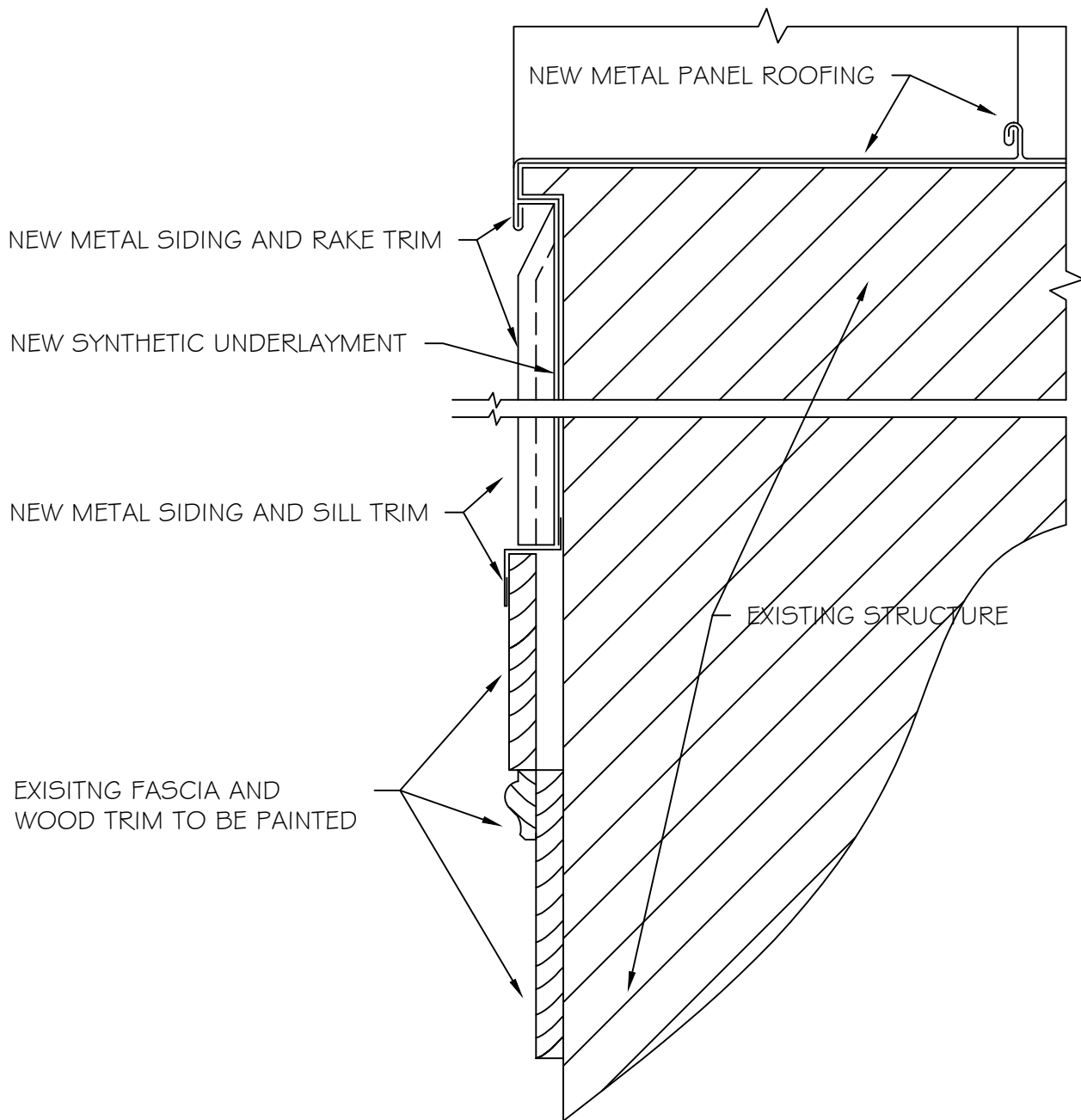

1 GABLE RAKE RAKE DETAIL
 (BOTTOM LOCKING TO WALL PANEL HEAD)

Shepard & Associates, LLC

3547 Dreher Shoals Road, Suite 6
 Irmo, South Carolina 29063

Phone: (803) 407-8284 E-mail: bshep@sc.rr.com Fax: (803) 407-8206

SHEET TITLE:

GABLE RAKE DETAIL

PROJECT DESCRIPTION:

Metal Re-Roof, Painting & Repairs

CLIENT NAME:

USC-Union Central Building

PF No. 11012.013.004

DATE: 5/27/2016

SCALE: NTS

DRAWN BY: KAS

CHECKED BY: WBS

SHEET

D7