

CONSTRUCTION DOCUMENTS
JUNE 16, 2016
STATE PROJECT NO: H27-6052-AC
PROJECT NO: U-676-09

The Boudreaux Group
1000 Lady St., Suite 600 (29202)
P.O. Box 600
Columbia, SC 29950
803.799.0247 f
803.771.6844 f
info@boudreauxgroup.com

UNIVERSITY OF SOUTH CAROLINA
HEALTH SCIENCES RENOVATION -
ADDITIONAL DISPLAY CASES
COLUMBIA, SC
STATE PROJECT NO: H27-6052-AC

No.	Description	Date	Project Number
			U-476-09
			Inventory
			Author
			Checked By
			Checker
			Date
			JUNE 16, 2016

This inventory and its contents are loaned to the user for the purpose of conducting research. The user agrees to return the contents of this report to the National Center of the National Archives and Records Administration and any expenses and fees incurred by the National Archives and Records Administration in the process of preparing this report.

**TITLE SHEET, LOCATION MAP,
SYMBOLS, APPLICABLE
CODES, INDEX OF DRAWINGS**

Drawing No.

T1.1

6/16/2016 8:48:07 AM

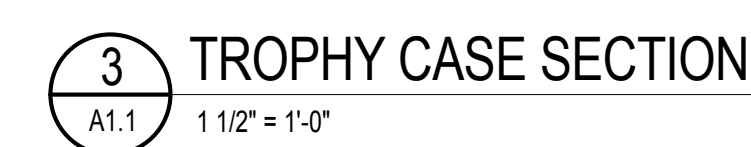
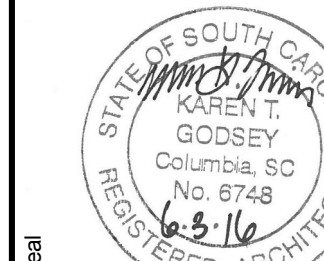
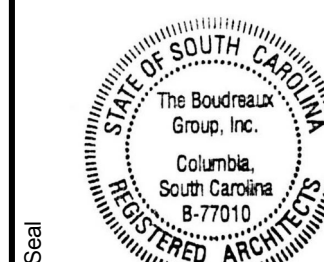
The **Boudreaux** GroupUNIVERSITY OF SOUTH CAROLINA
HEALTH SCIENCES RENOVATION -
ADDITIONAL DISPLAY CASES

STATE PROJECT NO: H27-6052-AC

No.	Description	Date	Project Number
			U-676-09
			Drawn By
			MS
			Checked By
			Date
			JUNE 16, 2016

This document and the content herein are the property of the University of Maryland System. The production, copying, or reuse of this document without the express written permission of the Board of Regents and the University of Maryland System is prohibited. Copyright © 2001 The Board of Regents.

Drawing Title. **FIRST FLOOR PLAN, TROPHY CASE ELEVATIONS, SECTIONS & DETAILS**

Drawing No.

A1.1

THIS AREA IS NOT TO RECEIVE INTERMEDIATE CABLE

ALL BAYS OF CABLE SHELVING TO INCLUDE INTERMEDIATE CABLE FOR 4" DEEP 3/8" THICK TEMPERED GLASS SHELVING

1'-0"

3'-4"

3'-4"

3'-4"

3'-4"

3'-4"

3'-4"

3'-4"

3'-4"

1'-0"

8'-0"

5'-10"

7'-7"

1'-5 1/2"

1/8" THICK STAINLESS STEEL TOE KICK

EQ

6'-8"

6'-8"

6'-8"

EQ

ALL INTERIOR SURFACES OF DISPLAY CASE TO RECEIVE PL-2

3/8" THICK TEMPERED GLASS SHELVES - RADIUS EDGES

GRIPLOCK SYSTEMS CABLE SHELVING SYSTEM (3/32" DIAMETER CABLE) WITH UNIVERSAL SIZE CLIPS FOR 3/8" TEMPERED GLASS SHELVING

SERIES 1301 CM DISPLAY CASE DOORS WITH CONTINUOUS MOUNTING BARS FOR 3/8" TEMPERED GLASS OR EQUAL

PL-1

3

A1.2

CONTRACTOR TO VERIFY SHELVING LOCATION, PATTERN, INSTALLATION, AND MOUNTING HEIGHTS WITH ART CONSULTANT

CONTACT: RHONDA DOUGLAS: 864-894-3333

2 DISPLAY CASE ELEVATION

PAINTED GYP BD SOFFIT (P-1) WITH METAL STUD FRAMING @ 16" O.C. MAX

LED STRIP LIGHT - PART OF ELECTRICAL PACKAGE

PLASTIC LAMINATE (PL-1) OVER 1X WOOD FRAMING

INTERMEDIATE CABLE FOR 4" DEEP 3/8" THICK TEMPERED GLASS SHELVING - SEE 2/A1.2 FOR LOCATIONS

SERIES 1301-CM DISPLAY CASE DOORS WITH CONTINUOUS MOUNTING BARS FOR 3/8" TEMPERED GLASS OR EQUAL

GRIPLOCK SYSTEMS CABLE SHELVING SYSTEM (3/32" DIAMETER CABLE) WITH UNIVERSAL SIDE CLIPS FOR 3/8" TEMPERED GLASS SHELVING

3/8" THICK TEMPERED GLASS SHELVES - RADIUS EDGES

PL-2

#7301 BLUMCRAFT CONCEALED LOCK OR EQUAL

HINGED ACCESS PANEL (PL-1)

LED STRIP LIGHT - PART OF ELECTRICAL PACKAGE

PLASTIC LAMINATE (PL-1) OVER 1/2" PLYWOOD

RB-1

1'-2" 1'-0" 1'-0" 4" 10" 3 1/2" 6'-5" 8'-0"

4 A1.2 5 A1.2

3 A1.2 1 1/2" = 1'-0"

DISPLAY CASE SECTION

3/8" TEMPERED GLASS

1/4" x 1/4" RAIL

#7301 BLUMCRAFT CONCEALED LOCK OR EQUAL

HINGED ACCESS PANEL

110 DEGREE CONCEALED HINGES

LED STRIP LIGHTING - PART OF ELECTRICAL PACKAGE

INTERMEDIATE CABLE FOR DEEP 3/8" THICK TEMPERED GLASS SHELVING - SEE 2/A1 FOR LOCATIONS

MOUNT CABLES PER MANUFACTURER'S INSTRUCTIONS, TYP

HAFELE LID STAY FOR WOOD DOORS - 373.73.710 / 373.73.70 OR EQUAL

5/8" PAINTED GYPSUM BD, TYP.

CORNER BEAD 1-1/2" LEGS, BOTH SIDES

5/8" PAINTED GYPSUM BD, TYP.

TOP PIVOT

ROLLER CATCH STOP

1/4" x 1/4" CONTINUOUS RAIL

3/8" TEMPERED GLASS

3 5/8" METAL STUDS @ 16" O.C. MAX

5

MOUNT CABLES PER MANUFACTURER'S INSTRUCTIONS, TYP

LED STRIP LIGHTING - PART OF ELECTRICAL PACKAGE

INTERMEDIATE CABLE FOR DEEP 3/8" THICK TEMPERED GLASS SHELVING - SEE 2/A1 FOR LOCATIONS

<p>SECOND FLOOR PLAN, DISPLAY CASE ELEVATIONS, SECTIONS & DETAILS</p>				<p>UNIVERSITY OF SOUTH CAROLINA HEALTH SCIENCES RENOVATION - ADDITIONAL DISPLAY CASES COLUMBIA, SC</p>		<p>The Boudreaux Group 1930 Lusk St., Suite 600 (apex) Columbia, SC 29204 803.799.0247 info@boudreauxgroup.com</p>	
<p>Drawing Title.</p>				<p>AE Seal</p>		<p>AE Seal</p>	
<p>Drawing No.</p>				<p>STATE PROJECT NO: H27-6052-AC</p>		<p>Interdisciplinary Design Architecture Interiors Planning</p>	
<p>A1.2</p>				<p>UNIVERSITY OF SOUTH CAROLINA HEALTH SCIENCES RENOVATION - ADDITIONAL DISPLAY CASES COLUMBIA, SC</p>		<p>The Boudreaux Group 1930 Lusk St., Suite 600 (apex) Columbia, SC 29204 803.799.0247 info@boudreauxgroup.com</p>	

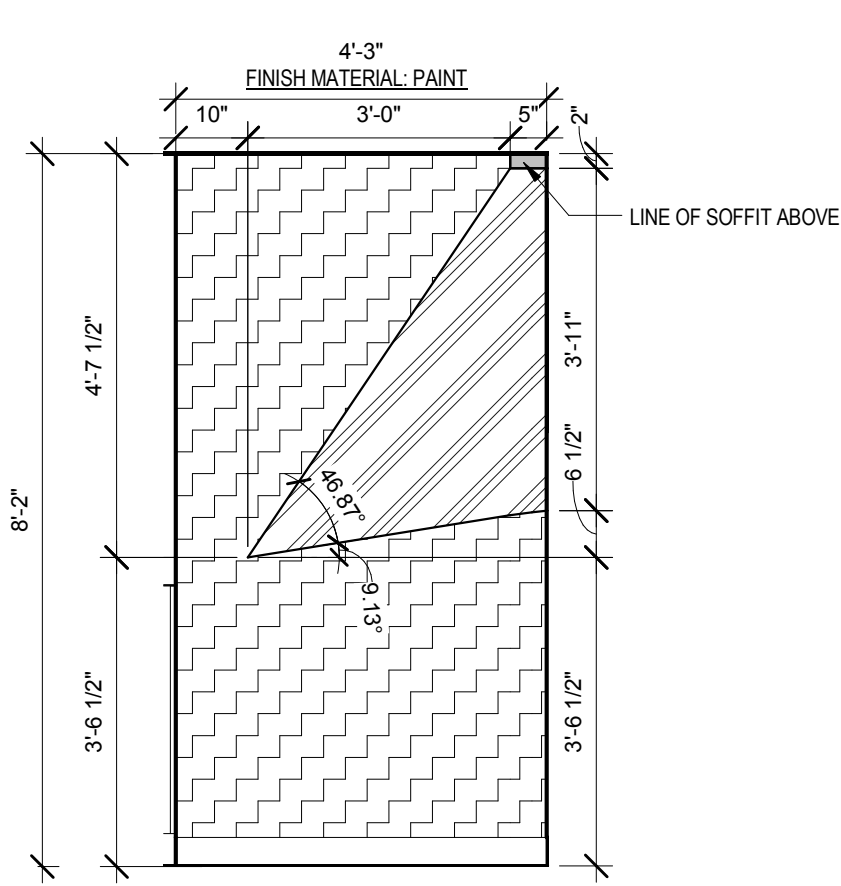

1 GRAPHICS - A
A2.1 1/2" = 1'-0"

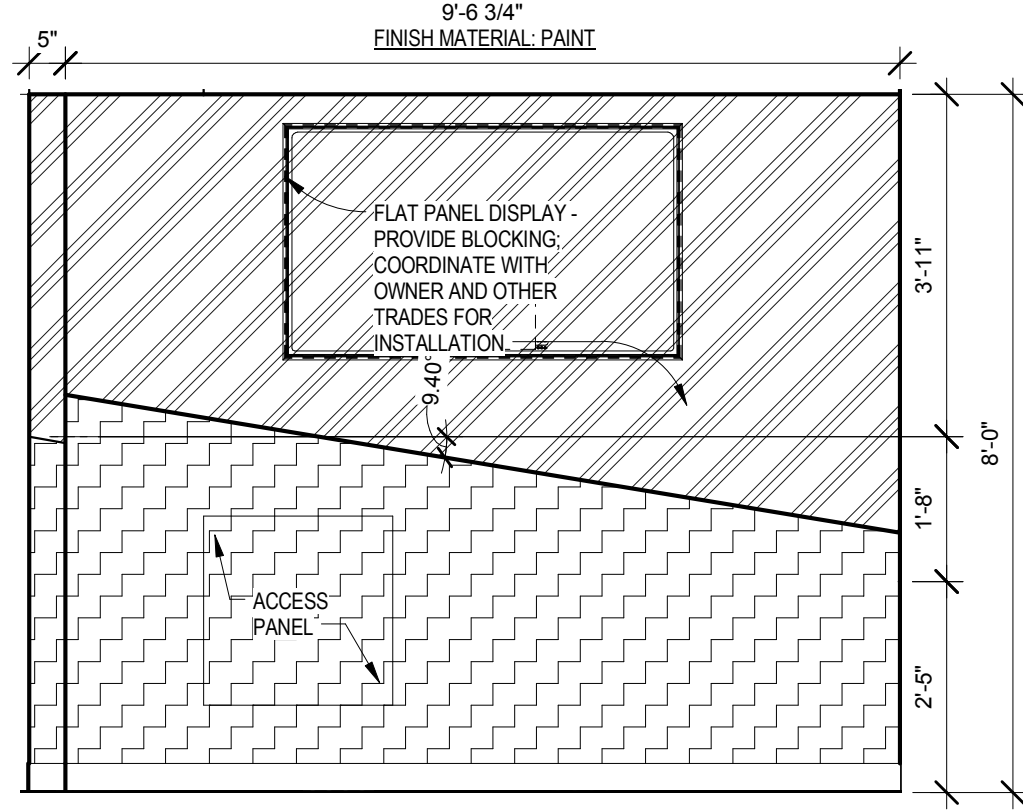

2 GRAPHICS - B
A2.1 1/2" = 1'-0"

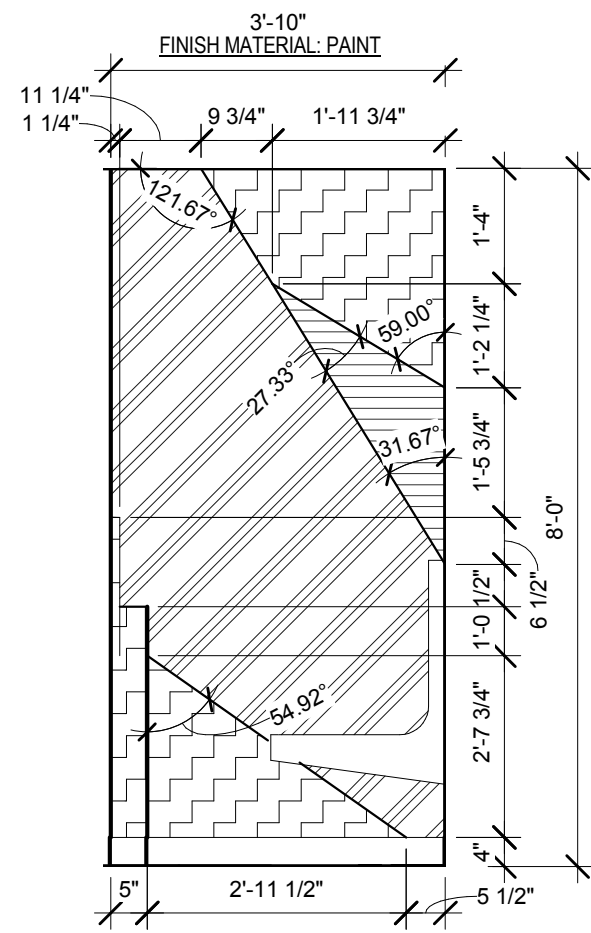

3 GRAPHICS - C
A2.1 1/2" = 1'-0"

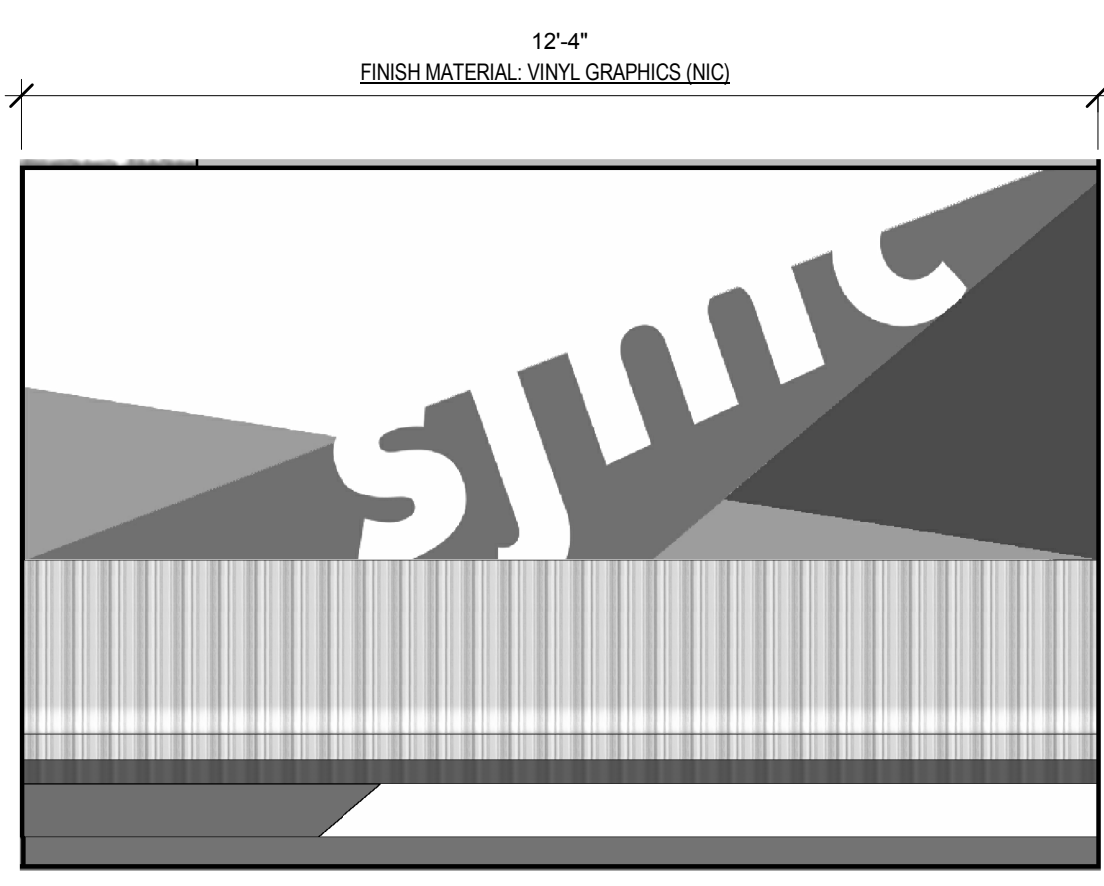

4 GRAPHICS - D
A2.1 1/2" = 1'-0"

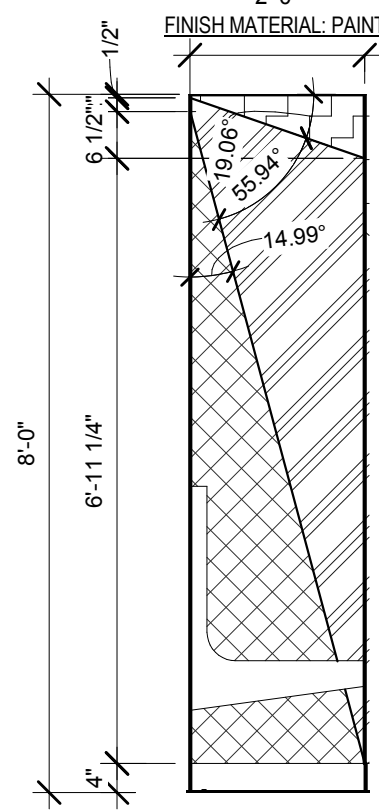

5 GRAPHICS - E
A2.1 1/2" = 1'-0"

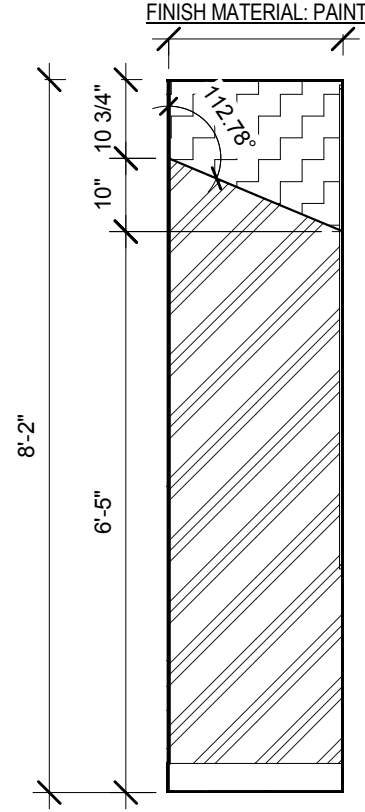

6 GRAPHICS - F
A2.1 1/2" = 1'-0"

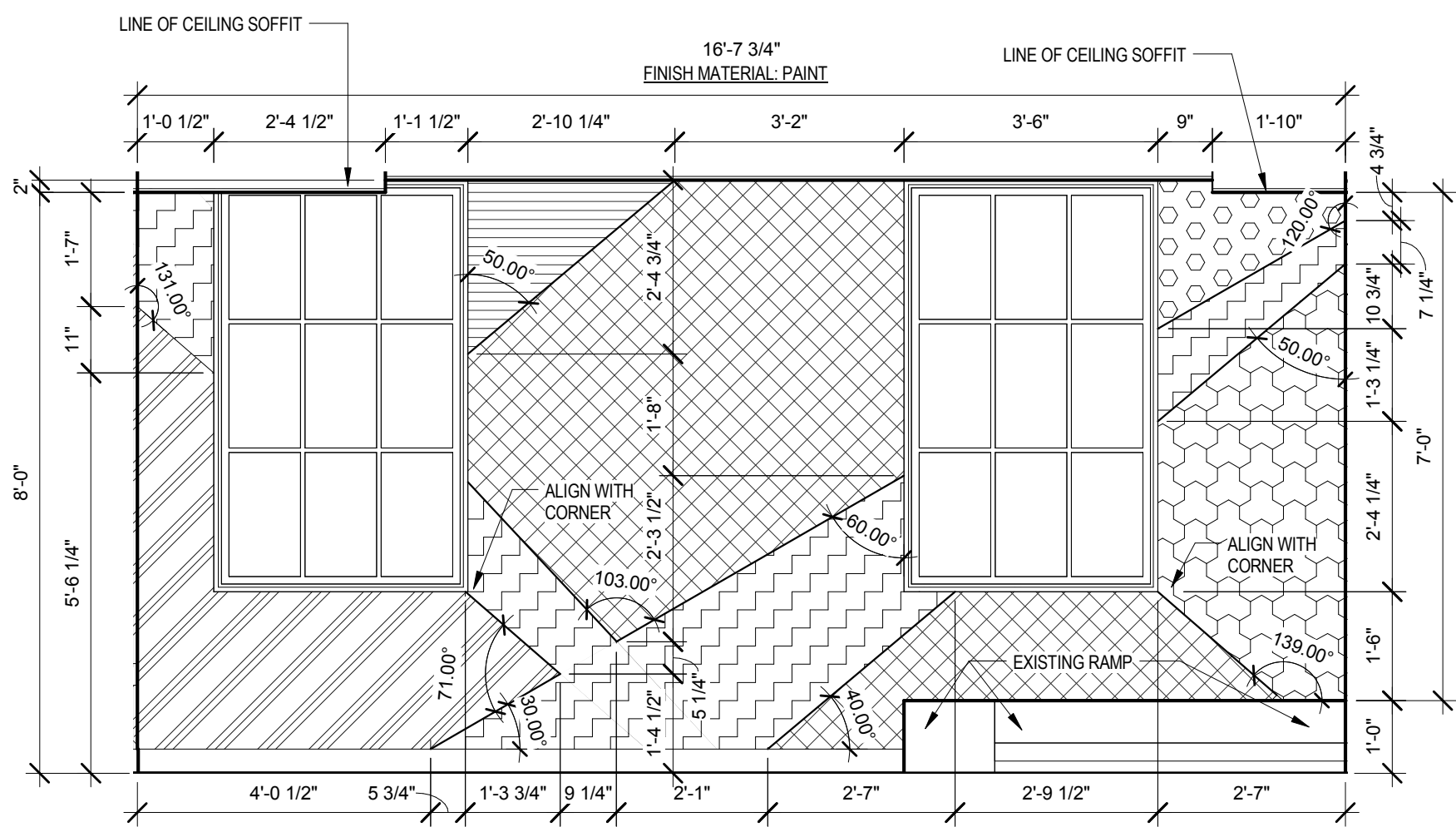

7 GRAPHICS - G
A2.1 1/2" = 1'-0"

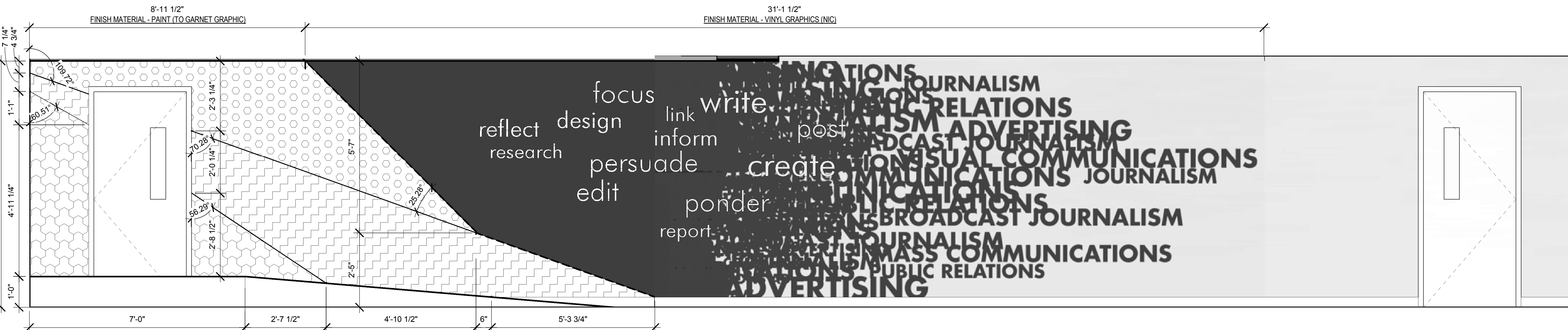

8 GRAPHICS - H
A2.1 1/2" = 1'-0"

INTERIOR FINISH MATERIALS

PAINT (P)

- P-1 MANUFACTURER: SHERWIN WILLIAMS
COLOR: SW7042 SHOJI WHITE
- P-2 MANUFACTURER: SHERWIN WILLIAMS
COLOR: SW7044 AMAZING GRAY
- P-3 MANUFACTURER: SHERWIN WILLIAMS
COLOR: SW7046 ANONYMOUS
- P-4 MANUFACTURER: SHERWIN WILLIAMS
COLOR: SW2802 ROOKWOOD RED
- P-5 MANUFACTURER: SHERWIN WILLIAMS
COLOR: SW6774 FRESHWATER
- P-6 MANUFACTURER: SHERWIN WILLIAMS
COLOR: SW6438 DILL

PLASTIC LAMINATE (PL)

- PL-1 MANUFACTURER: ARPA FOR AMERICAS
PATTERN: 0254 GRIGIO GABBIANO
FINISH: ERRE FINISH
- PL-2 MANUFACTURER: ARPA FOR AMERICAS
PATTERN: 0001 BIANCO
FINISH: ERRE FINISH

RUBBER BASE (RB)

- RB-1 MANUFACTURER: MATCH EXISTING
COLOR: MATCH EXISTING

GRAPHICS LEGEND

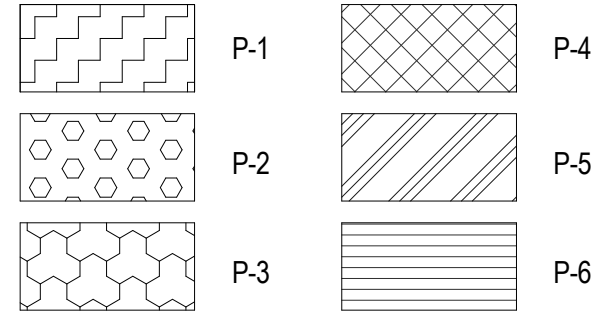

ALL AREAS INDICATED IN PATTERNS INCLUDED IN GRAPHICS LEGEND TO BE PAINT AS SCHEDULED. ALL WALL GRAPHICS IN ELEVATIONS NOT INDICATED BY PATTERNS INCLUDED IN GRAPHICS LEGEND ARE TO BE VINYL GRAPHICS - VINYL GRAPHICS COVERED IN SEPARATE GRAPHICS PACKAGE. COORDINATE WITH VINYL GRAPHICS INSTALLER FOR SCOPE OF WORK.

CONTRACTOR TO FIELD VERIFY ALL DIMENSIONS

The Boudreaux Group

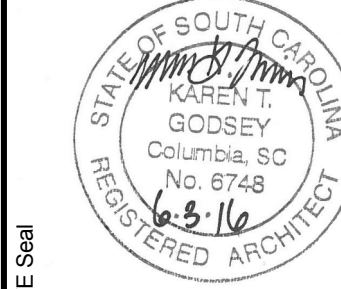
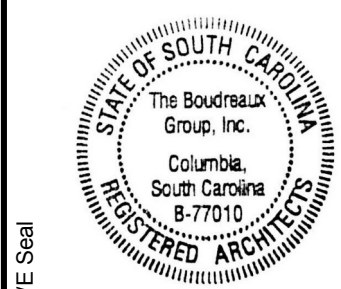

UNIVERSITY OF SOUTH CAROLINA
HEALTH SCIENCES RENOVATION -
ADDITIONAL DISPLAY CASES
COLUMBIA, SC

STATE PROJECT NO: H27-6052-AC

No.	Description	Date	Project Number
1	Drawn By	6/16/2016	U-676-09
2	Checked By		
3	Checked By		
4	Checked By		
5	Checked By		
6	Checked By		
7	Checked By		
8	Checked By		
9	Checked By		
10	Checked By		
11	Checked By		
12	Checked By		
13	Checked By		
14	Checked By		
15	Checked By		
16	Checked By		
17	Checked By		
18	Checked By		
19	Checked By		
20	Checked By		
21	Checked By		
22	Checked By		
23	Checked By		
24	Checked By		
25	Checked By		
26	Checked By		
27	Checked By		
28	Checked By		
29	Checked By		
30	Checked By		
31	Checked By		
32	Checked By		
33	Checked By		
34	Checked By		
35	Checked By		
36	Checked By		
37	Checked By		
38	Checked By		
39	Checked By		
40	Checked By		
41	Checked By		
42	Checked By		
43	Checked By		
44	Checked By		
45	Checked By		
46	Checked By		
47	Checked By		
48	Checked By		
49	Checked By		
50	Checked By		
51	Checked By		
52	Checked By		
53	Checked By		
54	Checked By		
55	Checked By		
56	Checked By		
57	Checked By		
58	Checked By		
59	Checked By		
60	Checked By		
61	Checked By		
62	Checked By		
63	Checked By		
64	Checked By		
65	Checked By		
66	Checked By		
67	Checked By		
68	Checked By		
69	Checked By		
70	Checked By		
71	Checked By		
72	Checked By		
73	Checked By		
74	Checked By		
75	Checked By		
76	Checked By		
77	Checked By		
78	Checked By		
79	Checked By		
80	Checked By		
81	Checked By		
82	Checked By		
83	Checked By		
84	Checked By		
85	Checked By		
86	Checked By		
87	Checked By		
88	Checked By		
89	Checked By		
90	Checked By		
91	Checked By		
92	Checked By		
93	Checked By		
94	Checked By		
95	Checked By		
96	Checked By		
97	Checked By		
98	Checked By		
99	Checked By		
100	Checked By		

INTERIOR GRAPHIC
ELEVATIONS, INTERIOR FINISH
MATERIALS

Drawing No.
A2.1

Interdisciplinary Design Architecture Interiors Planning