

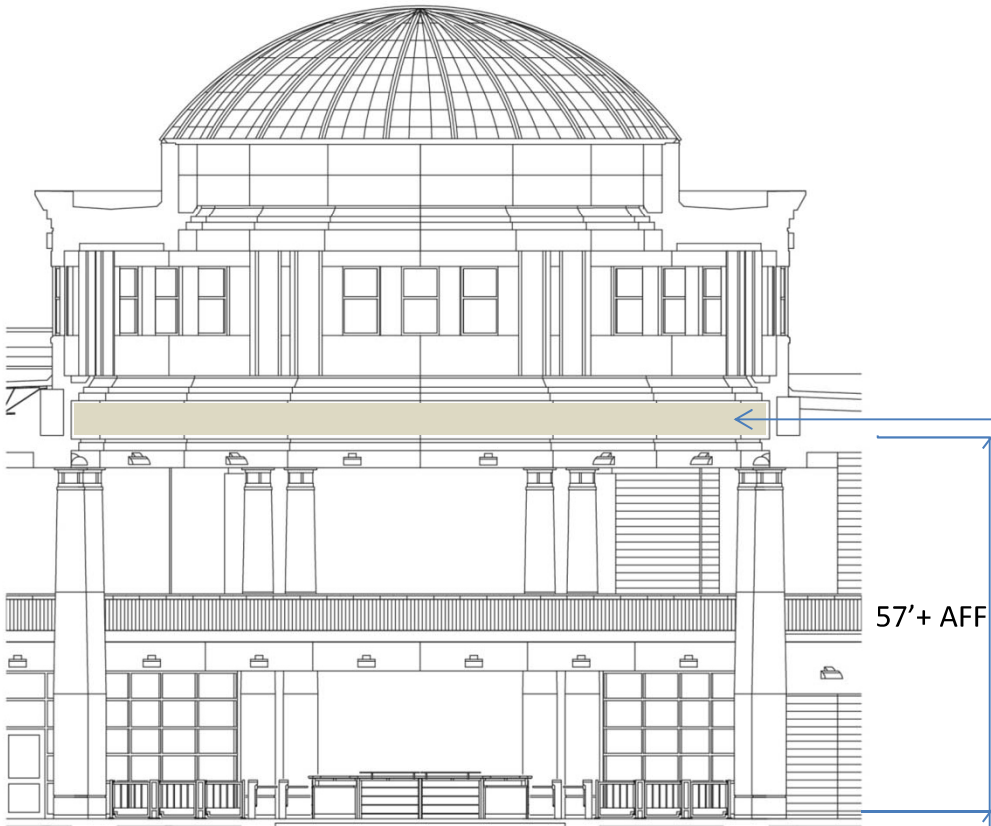

**USC - Strom Thurmond Wellness & Fitness Center
Interior Renovations: Painting and Casework
Contract Documents
05.06.16**



PAINTING SCOPE, BASE BID:

3'-4" BAND AROUND

ROTUNDA

COLOR TO MATCH:

SW#7642 PAVESTONE

LIFT REQUIRED, SEE PAINTING SPEC.

ATTACHMENT:

SPEC SECTION 099123

INTERIOR PAINTING

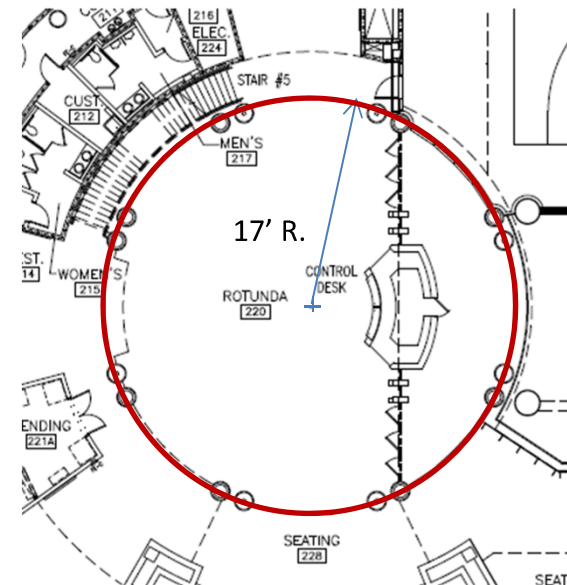

PAINTING SCOPE- ADD ALT. NO. 1:

6' H BAND AROUND

CONCOURSE

COLOR TO MATCH:

SW#7642 PAVESTONE

LIFT REQUIRED, SEE PAINTING SPEC.

ATTACHMENT:

SPEC SECTION 099123

INTERIOR PAINTING

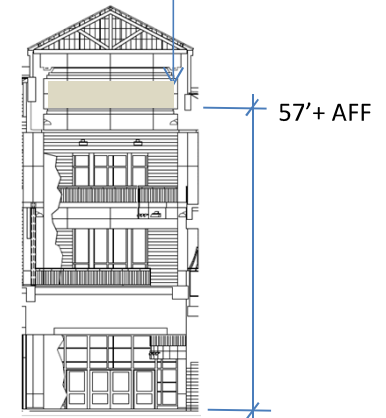
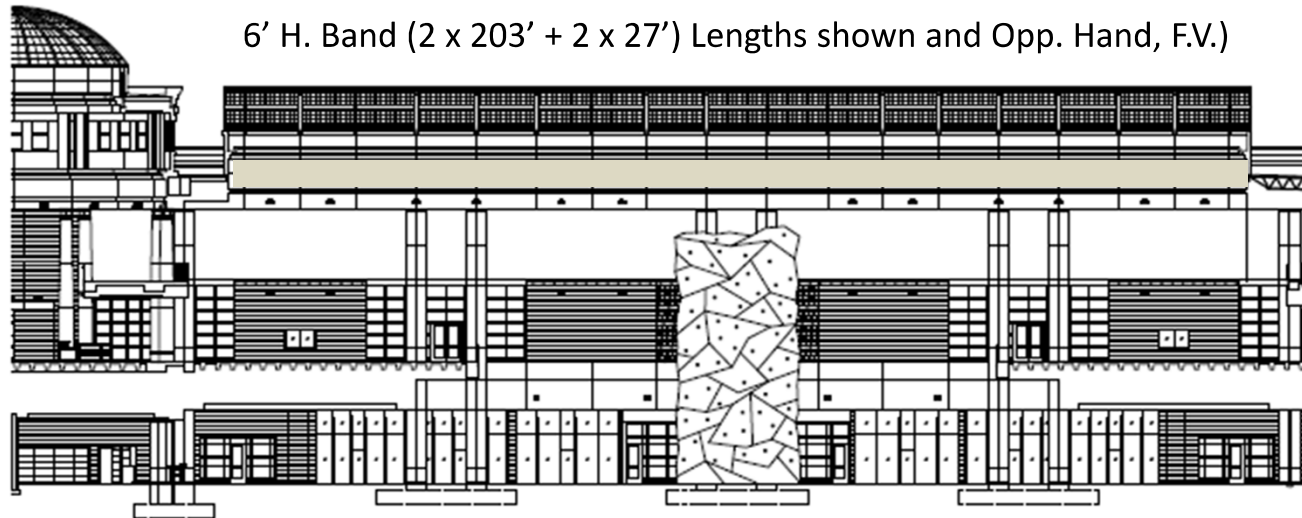
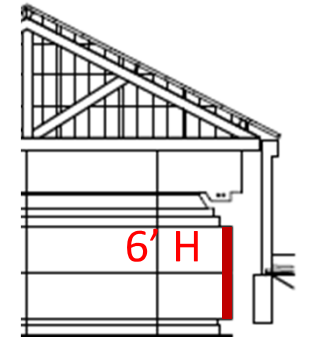

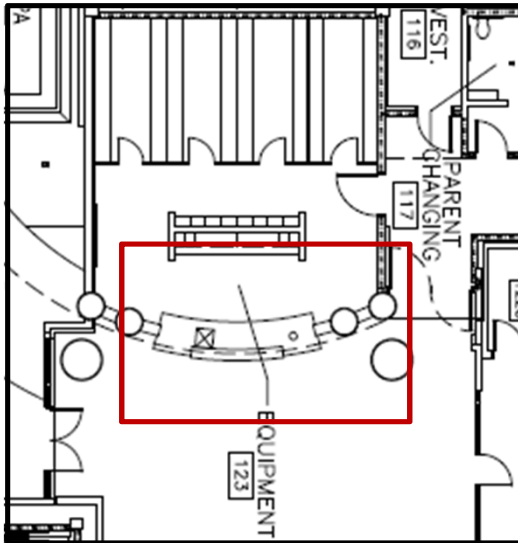

FIRST FLOOR EQUIPMENT DESK

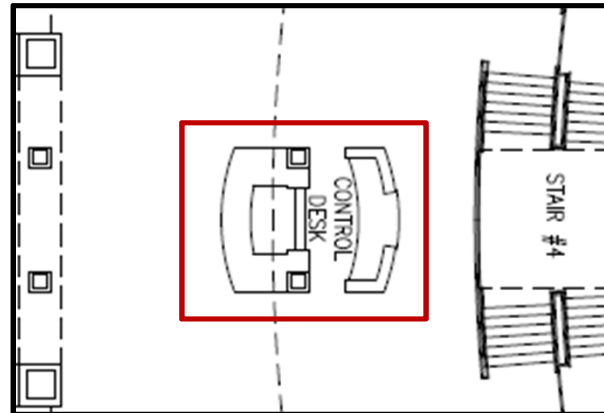

SECOND FLOOR WEIGHT RM DESK

Plex Argent

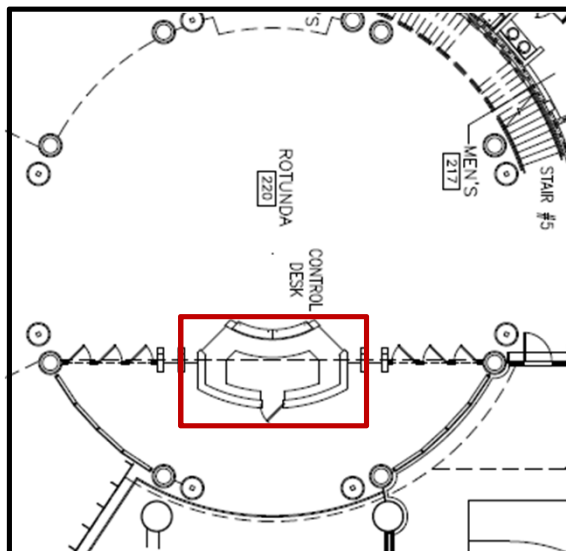
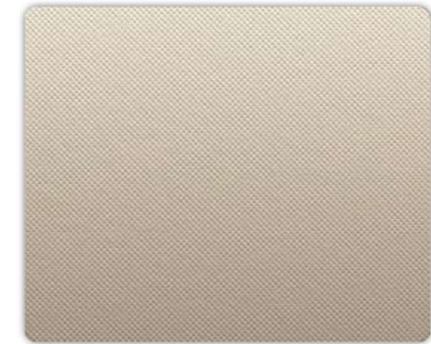

SECOND FLOOR MAIN CONTROL DESK

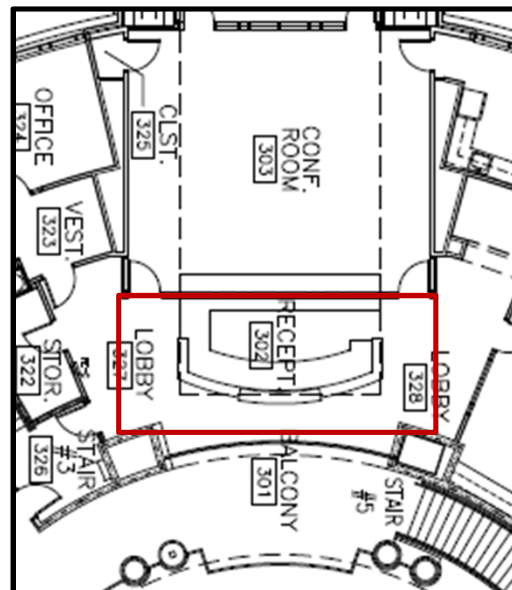

THIRD FLOOR RECEPTION DESK

CASEWORK SPECIFICATIONS:

AT (4) DESK LOCATIONS, AS INDICATED ON PLANS AND IN IMAGE ELEVATIONS: REPLACE ALL MAPLE WOOD LAMINATE, AND OTHER, AS NOTED, WITH NEW **'PL-1': FORMICA DECO METAL, #M5306 PLEX ARGENT**

CONTRACTOR'S OPTION:

DIRECT GLUE TO EXISTING LAMINATE, AND FILL/REPAIR AS NECESSARY FOR FLUSH CONDITIONS AT DAMAGED CORNERS, OR, REMOVE EXISTING WOOD LAMINATE.

ATTACHMENT:

SPEC SECTION 06402
ARCHITECTURAL WOODWORK

OVERALL CASEWORK SCOPE

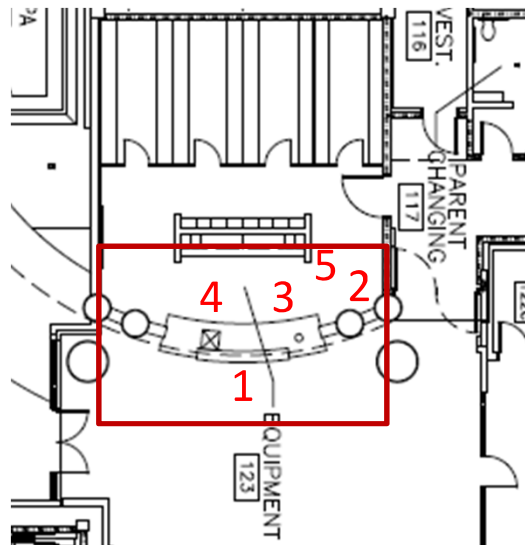

FIRST FLOOR EQUIPMENT DESK



View 1

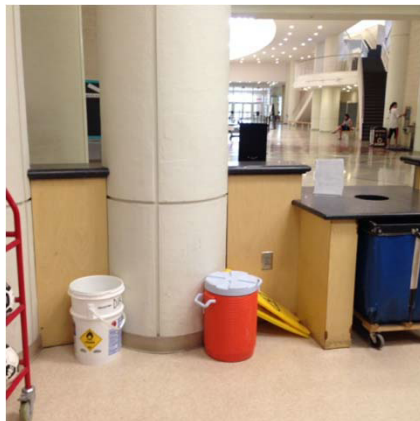

View 2



View 3



View 4



View 5

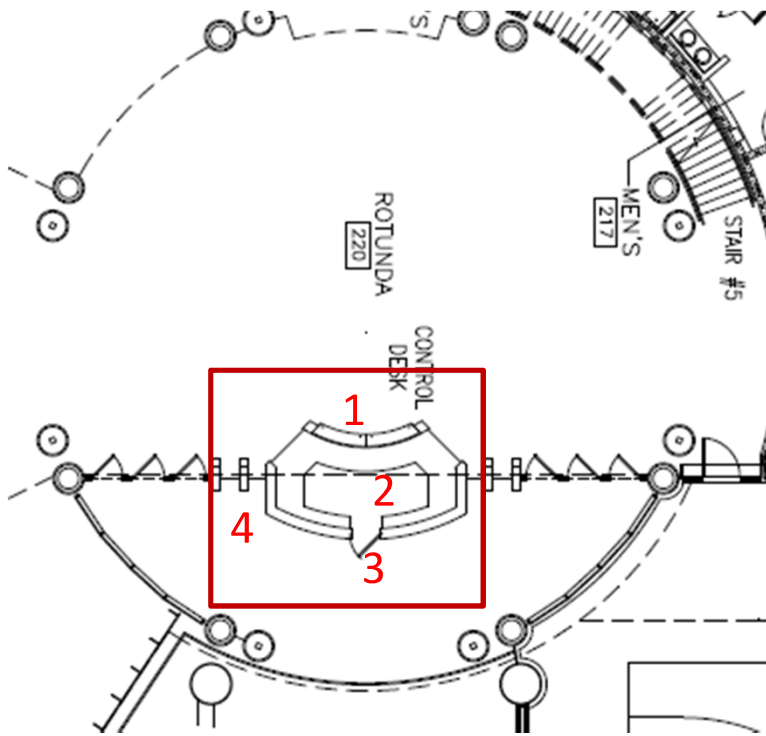

SECOND FLOOR MAIN CONTROL DESK

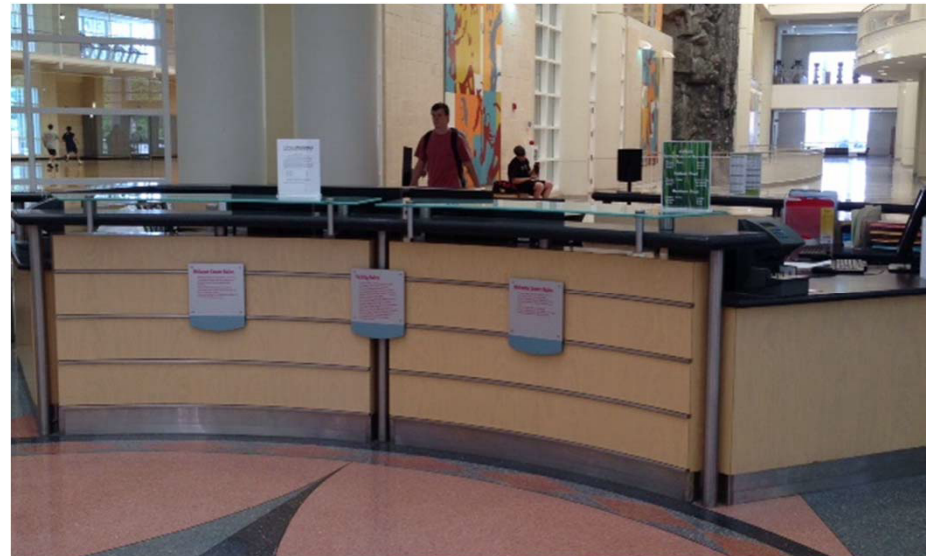

View 1

REPLACE ALL EXPOSED 'WOOD LAMINATE,' TYP.



View 2

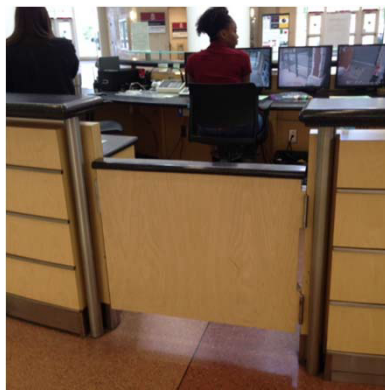

View 3



View 4

SECOND FLOOR

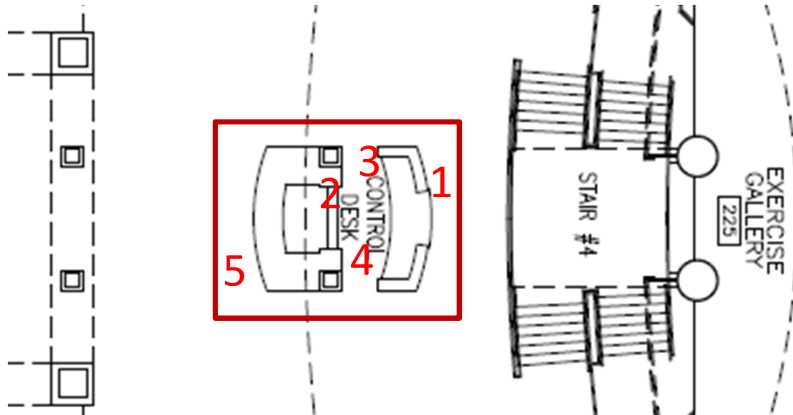

SECOND FLOOR WEIGHT RM DESK



View 1

REPLACE ALL EXPOSED 'WOOD LAMINATE,' TYP.



View 2

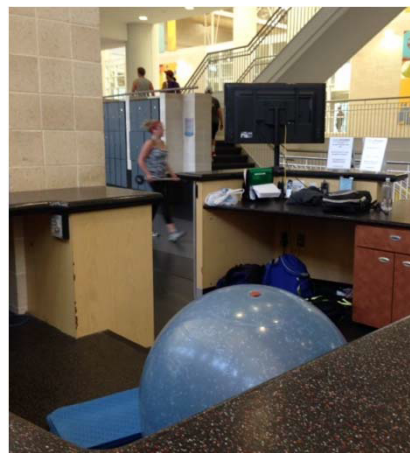

View 3

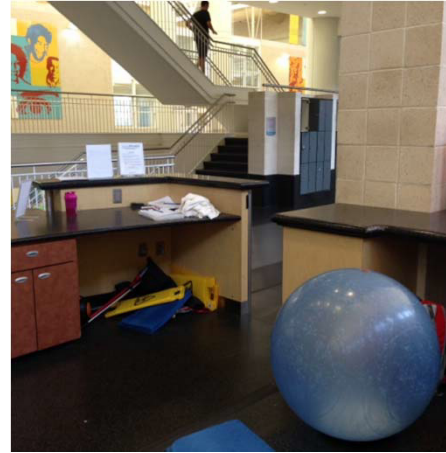

View 4

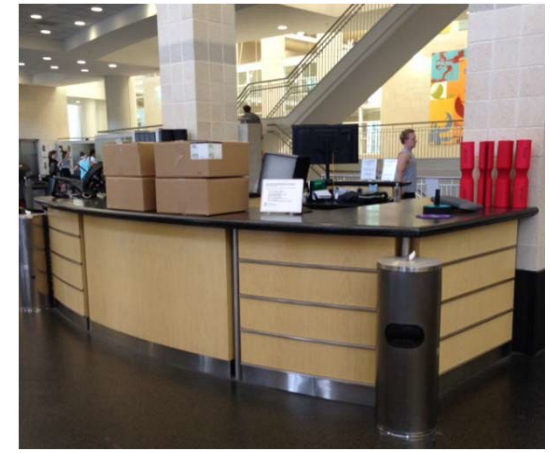

View 5

SECOND FLOOR

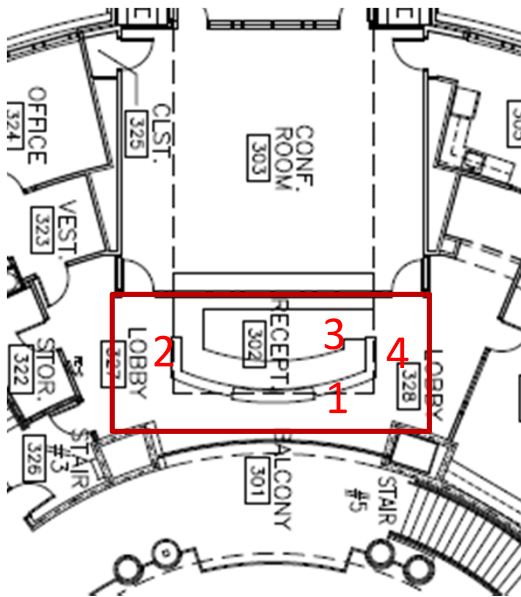

THIRD FLOOR RECEPTION DESK



View 1

REPLACE ALL EXPOSED 'WOOD LAMINATE,' TYP.



View 2



View 3

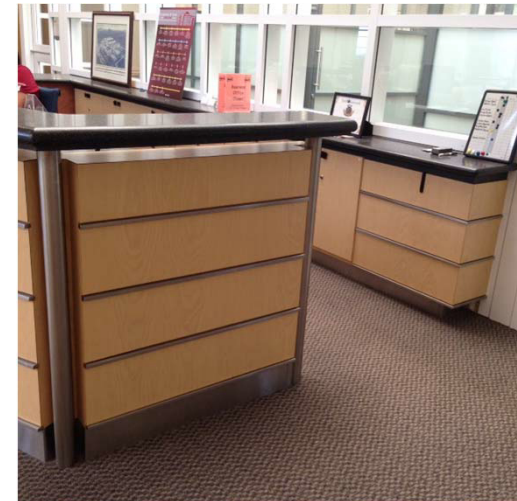

View 4

THIRD FLOOR