

University of South Carolina Close Hippi Building Main Floor Doors Replacement Project

Project Number: CP00430454

Project Manager: Geen Khoo

Addendum Number Two (2)

DATE: March 22, 2016

FROM: Aimee B. Rish, Procurement Specialist

TO: All Bidders

The following items add to, modify, clarify, or otherwise alter the Drawings and/or specifications and will become a part of the Contract Documents. Where a portion of the Drawings and/or specifications is added to, modified, clarified, or otherwise altered, the portion not so affected shall remain. Bidder shall include all effects that these items may have on his proposal.

General/Clarifications

1. The previous Addendum Number One (March 21, 2016) has been replaced with the current, correct information for this project.
2. Please see the attached revised drawing A2 for this project.

Attachment: Drawing A2

END OF ADDENDUM Number Two (2)

J:\ACFILES\50-11636\036.dwg, 8/18/2009 13:15 PM

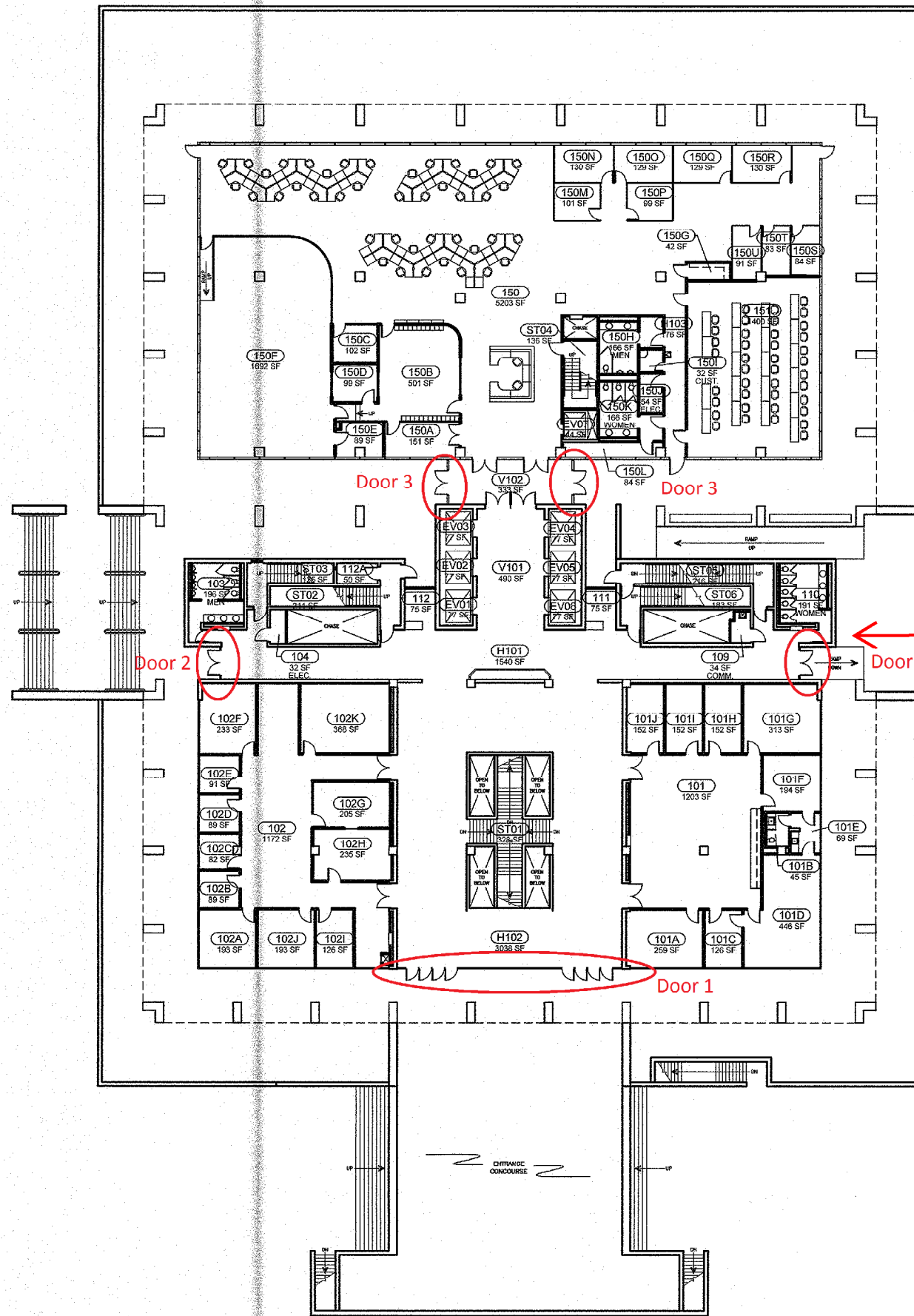

FIRST FLOOR PLAN - 036
SCALE: 1/16" = 1'-0"

CLOSE-HIPP BUILDING DOOR REPLACEMENT PROJECT REFERENCE DRAWING

Scope of work includes
replacement of the following
indicated door assemblies:

- Door Type 1 (two locations)
- Door Type 2 (two locations)
- Door Type 3 (two locations)

Alternate No. 1
Applicable to this
door location only

036-01-05-008

FIELD VERIFY DRAWING

PROJECT TITLE: SQFT PLAN - FIRST FLOOR
CLOSE/HIPP BUILDING (B.A. SCHOOL)

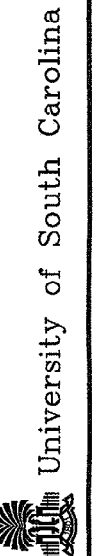

CAMPUS PLANNING
AND CONSTRUCTION
COLUMBIA, SC 29208

BUILDING:	DRAWING:	DATE:	DRAWN BY:	CHECKED BY:	SEAL:
036	SF1	30SEP97	JSG		
REV:	DESCRIPTION	DATE	BY	DATE	BY
1	UPDATED LATEST WALK-THROUGH	09APR01			
2	UPDATED LATEST WALK-THROUGH	23MAR07			
3	DRAWING CONVERTED BY ACAD-PLUS FOR FANISCAD	28MAR08			
4	UPDATED LATEST WALK-THROUGH	13OCT08			
5	UPDATED LATEST WALK-THROUGH	17AUG09			

A2
OF 9
SHEET IN SET:
2 OF 9