



U N I V E R S I T Y O F
SOUTH CAROLINA

AMENDMENT NO. 1

TO: ALL VENDORS
FROM: Lana Widener
SUBJECT: USC-RFQ-2555-LW
Relocate Five Research Labs and Equipment
DATE: March 4, 2014

This Amendment No. 1 modifies the Request for Quotes only in the manner and to the extent as stated herein.

- ITEM ONE:** CORRECTION TO SOLICITATION DESCRIPTION FROM: RELOCATE SIX RESEARCH LABS AND EQUIPMENT
To Read: **Relocate Five Research Labs and Equipment**
- ITEM TWO:** REVISED BID SCHEDULE
- ITEM THREE:** DELETE "CARSON & MURPHY" ITEMS TO BE MOVED FROM "DISCOVERY SPACE ASSIGNMENTS" TABLE
Carson and Murphy will move their own research lab(s) and equipment.
- ITEM FOUR:** ATTACHMENT, RESEARCH SPACE ASSIGNMENTS DRAWING 3RD FLOOR (1 PAGE)
- ITEM FIVE:** ATTACHMENT, EQUIPMENT LIST PROVIDED AT SITE VISIT (7 PAGES)
-

BIDDER SHALL ACKNOWLEDGE RECEIPT OF AMENDMENT NO. 1 IN THE SPACE PROVIDED BELOW AND RETURN IT **WITH THEIR BID RESPONSE**. FAILURE TO DO SO MAY SUBJECT BID TO REJECTION.

Authorized Signature

Firm

Date

REVISED BID SCHEDULE

COMMODITY (MATERIALS)

Item	Qty	Unit of Measure	Description	Extended Price
1	1	lot	Material to relocate office equipment, supplies, and miscellaneous office items from 4 research labs in Barnwell College and 1 lab in Graduate Science Research building to the Discovery building conforming to the specifications.	\$ _____

Resident Vendor Preference _____
SC End Product Preference _____
US End Product Preference _____

Note: The commodity preferences do not apply to a single unit of an item with a price in excess of \$50,000 or a single award with a total potential value in excess of \$500,000. [11-35-1524(E)(2)]

SERVICES (LABOR)

Item	Qty	Unit of Measure	Description	Extended Price
2	1	Job	Labor to relocate office equipment, supplies, and miscellaneous office items from 4 research labs in Barnwell College and 1 lab in Graduate Science Research building to the Discovery building conforming to the specifications. Some offices may require that the Contractor pack boxes.	\$ _____

Resident Contractor Preference _____
Resident Sub-Contractor Preference (2%) _____ Number of Sub-Contractors _____
Resident Sub-Contractor Preference (4%) _____ Number of Sub-Contractors _____

Note: The service preferences do not apply to a bid for an item of work by the bidder if the annual price of the bidder's work exceeds \$50,000 or the total potential price of the bidder's work exceeds \$500,000. [11-35-1524(E)(3)]

Please refer to the preference clauses listed in the additional conditions of this solicitation to ensure that you qualify to select the above preferences. Bidder is to submit the following for preferences requested above:

- 1) Identify the subcontractor to perform the work:
- 2) Identify the work the subcontractor is to perform:
- 3) Bidder's factual basis for concluding that the subcontractor's work constitutes the required percentage of the work to be performed in the procurement.

TOTAL FOR MATERIAL AND LABOR (Items 1-2): \$ _____

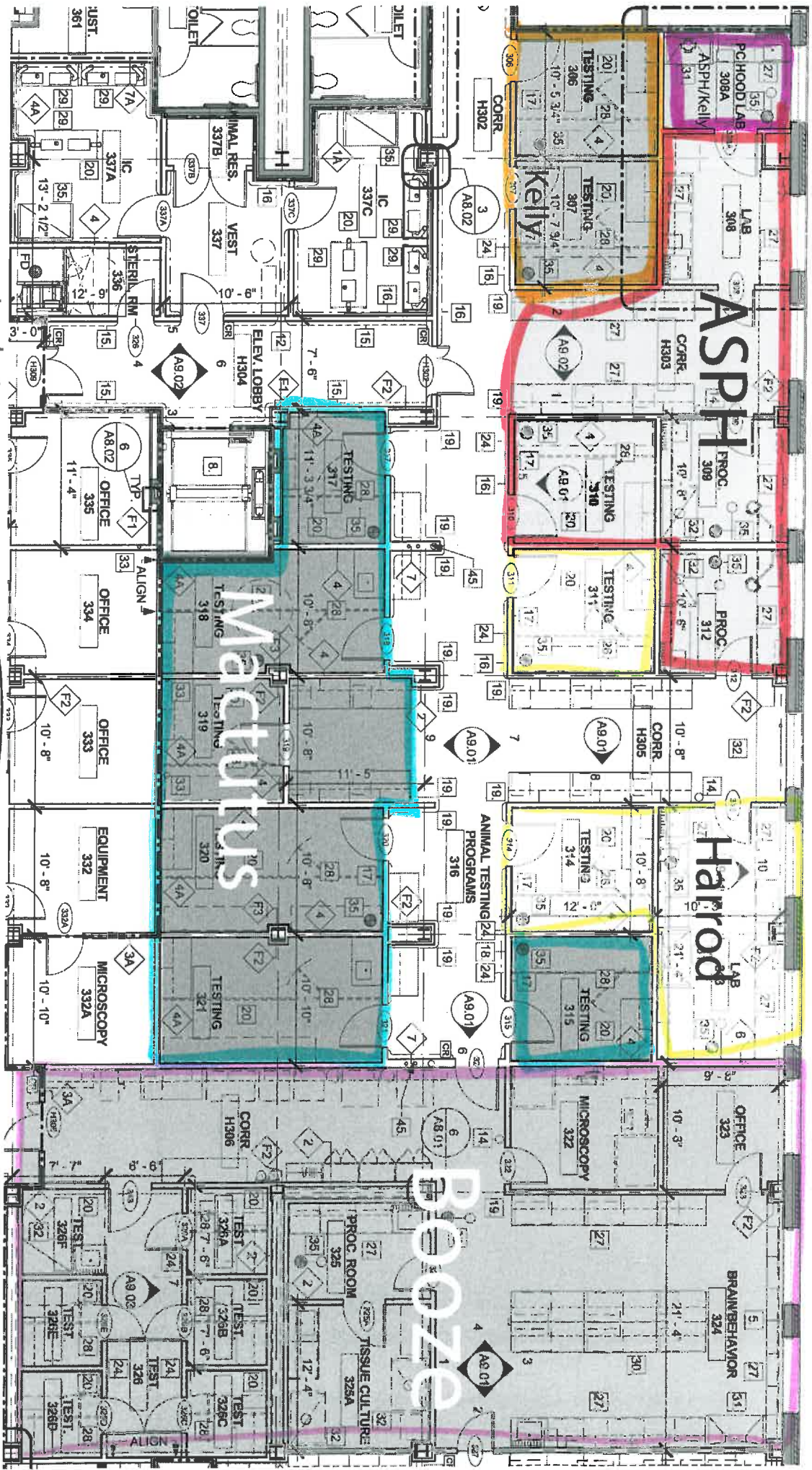

AS of 2/7/14

3rd floor

ASPHEL

ASPH Kelly

ASPH Proc

ASPH Harrod

ASPH Boozze

PC HOOD LAB 308A

LAB 308

CORR H303

PROC 309

PROC 312

CORR H305

LAB 313

OFFICE 323

BRAIN BEHAVIOR 324

PROC ROOM 325

TISSUE CULTURE 325A

JUST 361

291 29

7A

337A

20

13-2 1/2

FD

STERIL RM 336

15

15

6

AB 02

11'-4"

OFFICE 335

OFFICE 334

OFFICE 333

10'-8"

OFFICE 332

10'-8"

EQUIPMENT 332

332A

3A

10'-10"

MICROSCOPY 332A

3A

7-7

CORR H306

TEST 326A

TEST 326B

TEST 326C

TEST 326D

TEST 326E

TEST 326F

AB 01

AB 02

AB 03

AB 04

AB 05

AB 06

AB 07

AB 08

AB 09

AB 10

AB 11

AB 12

AB 13

AB 14

AB 15

AB 16

AB 17

AB 18

AB 19

AB 20

AB 21

AB 22

AB 23

AB 24

AB 25

AB 26

AB 27

AB 28

AB 29

AB 30

AB 31

AB 32

AB 33

AB 34

AB 35

AB 36

AB 37

AB 38

AB 39

AB 40

AB 41

AB 42

AB 43

AB 44

AB 45

AB 46

AB 47

AB 48

AB 49

AB 50

AB 51

AB 52

AB 53

AB 54

AB 55

AB 56

AB 57

AB 58

AB 59

AB 60

AB 61

AB 62

AB 63

AB 64

AB 65

AB 66

AB 67

AB 68

AB 69

AB 70

AB 71

AB 72

AB 73

AB 74

AB 75

AB 76

AB 77

AB 78

AB 79

AB 80

AB 81

AB 82

AB 83

AB 84

AB 85

AB 86

AB 87

AB 88

AB 89

AB 90

AB 91

AB 92

AB 93

AB 94

AB 95

AB 96

AB 97

AB 98

AB 99

AB 100

Booze

EQUIPMENT LIST

Booze

\$190,000

Moved
by
Nikon

Nikon TE2000 microscope	75,000.00	
- Nikon Eclipse microscope	65,000.00	
- Nikon Eclipse SM 1500 microscope	7,000	
- Nikon Stereomaster dissection microscope	5,000	
- Nikon TS 100 microscope	3,000	
- Leica Stereo Lax microscope	1,000	
- Leitz dissection microscope	1,000	
- C1 Confocal imaging system (Nikon)	150,000.00	
- MBF imaging system (Stereo Investigator and NeuroLucida)	100,000.00	102,000
- Cell culture incubators (two) 2x	8,000.00	
- Sanyo Biomed freezers (two) 2x	12,000.00	
- Bio Tek plate reader	28,000.00	170
- Tables anti-vibration (two) 2x	14,000.00	
- Avanti Sartorius centrifuge	42,000.00	240
- Counter isotope	12,000.00	
- Pixera imaging camera	7,000.00	259
- Thermocycler PCR	42,000.00	301
- Bio Rad Protean	8,000.00	
- Bio Rad Chemidoc system	25,000.00	334
- MicroM microtime slicer	18,000.00	
- Biosafety cabinets (two) 2x	3,000.00	368
- Eppendorf table centrifuge small	6,500.00	
- Eppendorf table centrifuge refrig	10,000.00	374
- Vibratome slicer	14,000.00	388
- Thermo Sci Lab refrigerator	6,000.00	394
- Brinkmann oven autoclave	8,000.00	402
- Sanyo BioMed freezer	7,500.00	
- Thermo Sci Liquid nitrogen	1,500.00	411

- Samsung Refrigerator Lab 1,500.00
- Small refrigerators (four) 500.00 4 x 3
- pH Meter Orion 1,000.00
- Mettler balances (two) 5,000.00 4 x 9
- Hybridizer oven 800.00
- Rocking platforms (two) 1,000.00
- Computers (twelve) 20,000.00 4 x 50

Picospritzer about 3,000.00

Voltammetry system about (20,000.00)

Micro Injection chambers - ?? 490,000

(Also office stuff such as metal file cabinets and boxes with office documents)
 (\$1000)

Manufacturers

\$718,000

Equipment/Item	Replacement Cost
Mettler AT 250 Balance	\$5,000
Intralux 5000	\$500
Germinator 500	\$250
Benchmark Digital Stereotaxic Control Panel	\$2,000
SurgiVet Anesthesia Machine	\$10,000
Vibration free table	\$3,000
MiniMitter Running Wheel system	\$80,000
Power Stat Variable AutoTransformer	\$200
Dell Computer	\$1,000
Stainless steel shelving	\$500
HamiltonKinder Locomotor Activity System	\$60,000
Dell Computer	\$1,000
Stainless steel shelving	\$1,000
SDI activity system	\$10,000
SPSG activity system	\$60,000
Infrared activity system	\$10,000
SDI Startle Response system (2)	\$20,000
Maternal/pup activity system	\$2,000
Med Associates Operant systems	\$120,000
APC-Smart-UPS Battery Back-Up Systems(8)	\$4,000
Dell Computers (7)	\$7,000
Coulbourn Instruments modules	\$80,000
Med Associates Interface panels and compoments	\$40,000
Stainless steel shelving	\$1,000
Startle Tremor Response System	\$5,000
Sinus Rhythm Analyzer	\$10,000
Dell Computer	\$1,000
SurgiVet Anesthesia Machine	\$10,000
Vibration free table	\$3,000
Microdialysis system	\$50,000
Dell Workstations (2)	\$4,000
Water Maze Spatial Cognition system	\$12,000
Dell Computer	\$1,000

zhu \$15,000

Room A - Surgery Room

Associated peripherals	\$2,000
Inhalation Chambers	\$60,000
Nose-only inhalation systems (2)	\$20,000
Vacuum pumps (2)	\$2,000
Classical conditioning	\$2,000
Y-mazes (2)	\$2,000
Avoidance conditioning (2)	\$2,000
Radial arm maze	\$2,000
Video cameras/peripherals	\$10,000
Stainless steel shelving	\$1,000

Hi Walker,

Here is the list:

1) *A list of equipment to be moved, with monetary values of each piece of equipment (for insurance purposes).*

- 18 Med Associates Operant Chambers (6 chambers = \$40,000; 18 = **\$120,000**)
- Tuttnauer/Brinkmann Autoclave: Model 2540E **(\$8,004.25)**
- Four Nexel Racks to house the Operant Chambers (each \$380; **\$1520**)
- Standard Refrigerator: Sears, Roebuck and Co. **(\$774.49)**
- Mosler Safe (264 pounds; **\$800**)
- 5 boxes of glassware (**~\$500**)
- "Flammable" Storage Cabinet **(\$800)**
- 4 computers **(\$2000)**
- Misc small instruments **(\$1000)**

Harrod
\$136,000

2) *What is your desired date to have the equipment moved?*

- We still do not know where we are moving to. Space is still being discussed.

3) *Do you or your researchers have a company that you would prefer to handle the moving tasks of relocating the equipment? USC uses various contractors to handle moves like this, so it is OK if you do not have a specific company in mind.*

- No specific company in mind.

Best,
Steven Harrod, PhD

WALKER, MARSHALL

From: AKERMAN II, DAVID
Sent: Thursday, December 05, 2013 11:17 AM
To: WALKER, MARSHALL
Subject: RE: Equipment to be Moved to Discovery: Information Needed

Marshall,

Looking forward to the discovery move, animal resources does have some equipment that will need movers to get it from the GSRC to Discovery. This includes A large triple-wide refrigerator(still on skids and packaged for deliver(Approx \$12,500)), 8 Biosafety cabinets (Approx \$15,000 ea(some of these are going to require disassembly to get the m into the building and all will need to be put together once in their proper location. They will not fit through the doors otherwise).

At this point this should be everything that we will need movers for, but I will let you know if that changes.

Thank you,

Akerman

15000
8

120,000

\$132,500

David A. Akerman II, MM, CMAR, RLATG
Facility Manager, Animal Resources Facilities
University of South Carolina
Suite 102, Graduate Science Research Center
631 Sumter Street
Columbia, SC 29208
Office: (803)777-6704

From: ABRAMS, JEFF
Sent: Thursday, December 05, 2013 10:59 AM
To: WALKER, MARSHALL; BOOZE, ROSEMARIE; CARSON, JAMES; MURPHY, ANGELA; MACTUTUS, CHARLIE; HARROD, STEVEN; KELLY, SANDRA; ZHU, JUN; ZHU, JUN
Cc: OPAL, TOM; BARLOW, SHAYNE; AKERMAN II, DAVID
Subject: RE: Equipment to be Moved to Discovery: Information Needed

Copying David Akerman.

Jeff Abrams, Architect
Project Manager
Facilities Design and Construction
University of South Carolina
803-239-8074
JAbrams@fmc.sc.edu

From: WALKER, MARSHALL
Sent: Thursday, December 05, 2013 9:39 AM
To: BOOZE, ROSEMARIE; CARSON, JAMES; MURPHY, ANGELA; MACTUTUS, CHARLIE; HARROD, STEVEN; KELLY, SANDRA; ZHU, JUN; ZHU, JUN
Cc: OPAL, TOM; BARLOW, SHAYNE; ABRAMS, JEFF
Subject: Equipment to be Moved to Discovery: Information Needed

WALKER, MARSHALL

From: KELLY, SANDRA
Sent: Friday, December 06, 2013 2:36 PM
To: WALKER, MARSHALL
Subject: RE: Equipment to be Moved to Discovery: Information Needed

Hi Marshall,

My information is below. My understanding is that space is still in flux but I am happy to move. Thanks, Sandra

1) A list of equipment to be moved, with monetary values of each piece of equipment (for insurance purposes).

Radial arm maze = \$300

Morris water maze: \$400

Three testing apparati: 3 X \$200 = \$600

One glass fish tank = \$600

2 Computer set-ups = 2 X \$1500 = \$3000

Two computer desks = 2 X \$300

One table 4' long = \$250

3 boxes of glassware = 3 X \$200 = \$600

Kelly
\$6000

2) What is your desired date to have the equipment moved?

January 14th, 2013

3) Do you or your researchers have a company that you would prefer to handle the moving tasks of relocating the equipment? USC uses various contractors to handle moves like this, so it is OK if you do not have a specific company in mind.

No - - this is not specialized or particularly delicate scientific equipment. Some of it is glass or computer-ware which has to be handled accordingly.

I will handle arranging site visits for potential moving contractors, so that they can understand the scope of each move. Feel free to contact me with any questions.

Thank you all.

Marshall Walker

Assistant Project Manager

Facilities Design & Construction

University of South Carolina

C: 803-413-1990

O: 803-576-5840

Walker39@fmc.sc.edu

From: BARLOW, SHAYNE

Sent: Monday, November 11, 2013 2:41 PM

To: CARSON, JAMES; BOOZE, ROSEMARIE; MACTUTUS, CHARLIE; HARROD, STEVEN; KELLY, SANDRA; ZHU, JUN;
angela.murphy@uscmed.sc.edu; FAYAD, RAJA; YOUNGSTEDT, SHAWN

Cc: WEDELL, DOUG; CURTIS, CHRISTINE; SAWYER, ROGER; ROWEN, RANDALL; HAND, GREG; NAGARKATTI, PRAKASH;
GOLDSMITH, EDIE; ABRAMS, JEFF

Subject: Discovery Procedure Space Assignments