

2
3.0
FIRE ALARM SYSTEM
SINGLE-LINE DIAGRAM
NOT TO SCALE

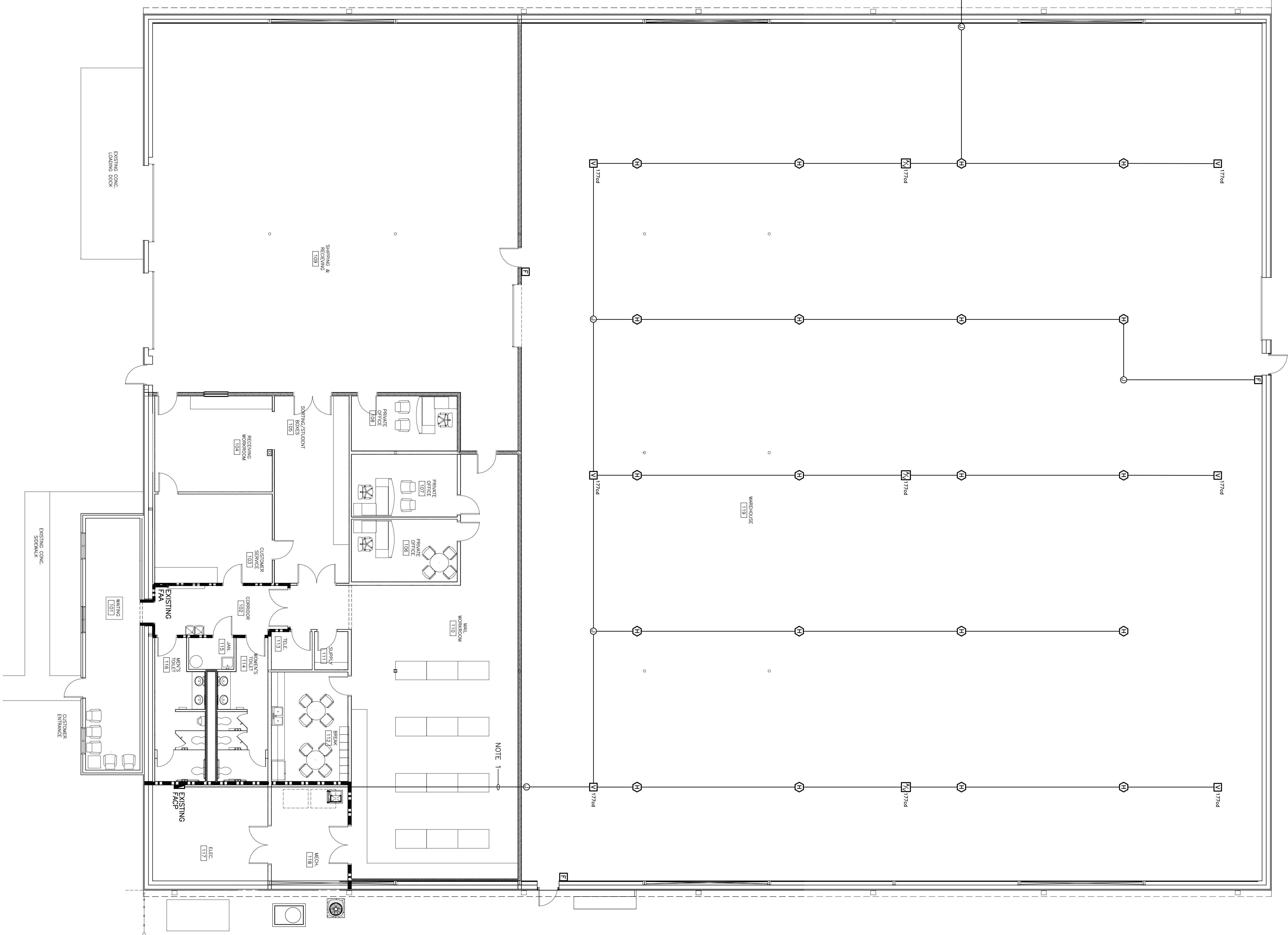

1
3.0
FIRE ALARM PLAN
SCALE: 1/8" = 1'-0"

- FIRE ALARM SYSTEM NOTES
1. PROVIDE 3/4" CONDUIT ROUTED OVERHEAD WITH CONDUCTORS AS NECESSARY FROM EXISTING RACEWAY IN ELECTRICAL ROOM 117 TO NEW FIRE ALARM NOTIFICATION APPLIANCES AND ADDRESSABLE DETECTION DEVICES.
 2. TEST FIRE ALARM SYSTEM IN ACCORDANCE WITH NFPA 72.
 3. PROVIDE ALL WORK IN ACCORDANCE WITH THE NATIONAL ELECTRICAL CODE, 2008 EDITION.

ELECTRICAL SYMBOL LEGEND

	CONTROL PANEL SURFACE MOUNTED IN WALL, TYPE AS NOTED ON PLAN.
	FIRE ALARM COMBINATION ALARM/AMBIG/AMBIG/STRIGGER TYPE NOTIFICATION APPLIANCE MOUNT UNIT TO LOWEST STRUCTURAL MEMBER OF ROOF SUPPORT SYSTEM/STRUCTURE. NUMBER INDICATES MINIMUM CANDELA RATING.
	VISUAL-ONLY (STRIGGER) ALARM UNIT MOUNT UNIT TO CEILING STRUCTURE. "CO" RATING INDICATES MINIMUM REQUIRED CANDELA OUTPUT.
	FIRE ALARM PULL STATION, SEMI-FLUSH MOUNT UNIT ON WALL AT 48" AFF
	FIRE ALARM SYSTEM ADDRESSABLE PHOTOELECTRIC SMOKE DETECTOR, MOUNT UNIT TO HIGHEST POINT OF ROOF STRUCTURE.
	FIRE ALARM SYSTEM ADDRESSABLE COMBINATION FIXED TEMPERATURE/RATE-OF-RISE HEAT DETECTOR, MOUNT UNIT TO CEILING STRUCTURE.
	JUNCTION BOX

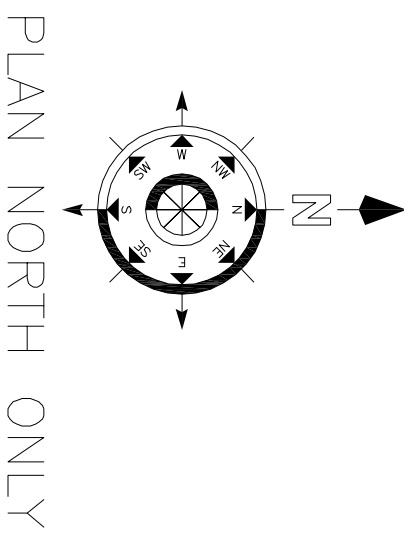

BEA
BRINK
ENGINEERING

7 QUIGGERS COURT, SUITE 201
COLUMBIA, SOUTH CAROLINA 29210
(803) 732-3300
FAX: (803) 732-2880
Email: j.parker@brinkeng.com

BUILDING:	STATE PROJECT NO. H34-1338	DATE: 19SEPT11	DRAWN BY: TSR	CHECKED BY: JWJ
REV.	DESCRIPTION			

SEAL:

SEAL:

