

**LEAD-BASED PAINT ABATEMENT GENERAL NOTES**

- Contractor shall thoroughly read all specifications and thoroughly review all construction documents prior to commencement of abatement activities.
- Contractor is responsible for actual quantities associated with the abatement.

- Structural I Beam 6.5" x 12" x 22'
- Structural I Beam 7.5" x 18" (Varying Lengths)
- Structural I Beam 8" x 13.75" (Varying Lengths)
- +++++ Parapet Wall Structural I Beams 5.25" x 8" (Varying Lengths)
- ..... Structural I Beam 4" x 8" (Varying Lengths)
- Parapet Wall Structural Column 10" x 12" x 16.5'

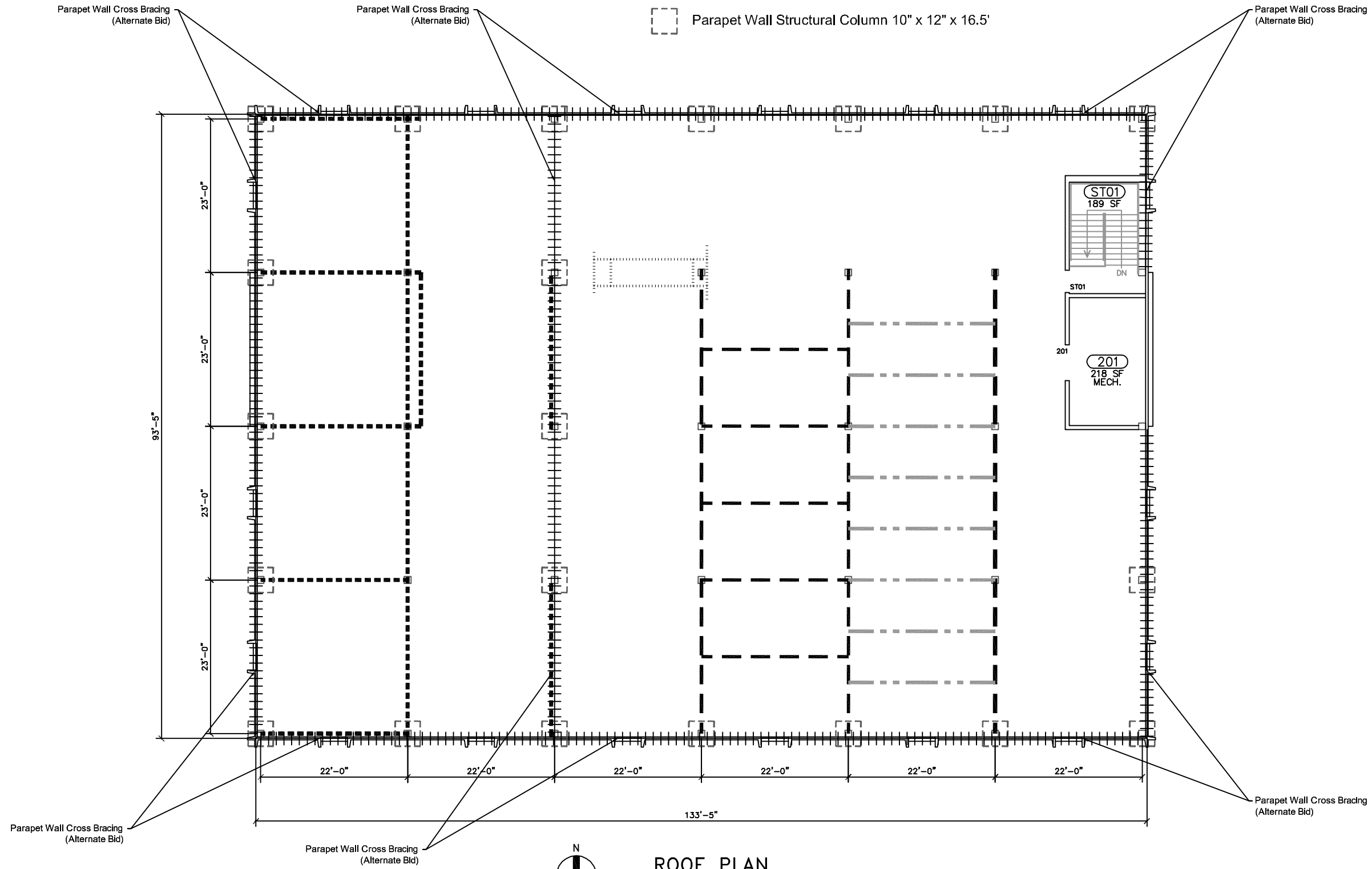

**ROOF PLAN**  
SCALE: 1/8" = 1'-0"

DRWN BY: GME	CHKD BY: JLS
APPR BY: GME	NOTES:
1	2
3	SCALE
	1/8" = 1'-0"

ORIGINAL:	4/25/2013
REVISIONS:	
1	
2	
3	

**F&ME**  
CONSULTANTS  
GEOTECHNICAL - ENVIRONMENTAL - MATERIALS  
COLUMBIA, SOUTH CAROLINA

**LEAD-BASED PAINT ABATEMENT PLAN**  
**ROOF LEVEL**  
University of South Carolina  
Lead-Based Paint Abatement  
East Energy Facility Roof Structural Steel  
Prepared for: USC  
Columbia, South Carolina

F&ME CONSULTANTS  
PROJECT NUMBER:  
**E5300.02**

DRAWING NUMBER:  
**LBP1**