

THESE PROJECT DRAWINGS ARE THE PROPERTY OF ADC ENGINEERING, INC. DRAWINGS ARE PROVIDED FOR PROJECT RECORD FILING ONLY. ANY OTHER USE, REPRODUCTION OR COPYING IN WHOLE OR IN PART IS NOT AUTHORIZED. ALL RIGHTS RESERVED.



USC SUMTER - ADMINISTRATION BUILDING ROOF REPAIRS

UNIVERSITY OF SOUTH CAROLINA, SUMTER

200 MILLER RD.
SUMTER, SOUTH CAROLINA

OWNER PROJECT NUMBER: H39 - 9519

ADC PROJECT NUMBER: 14338

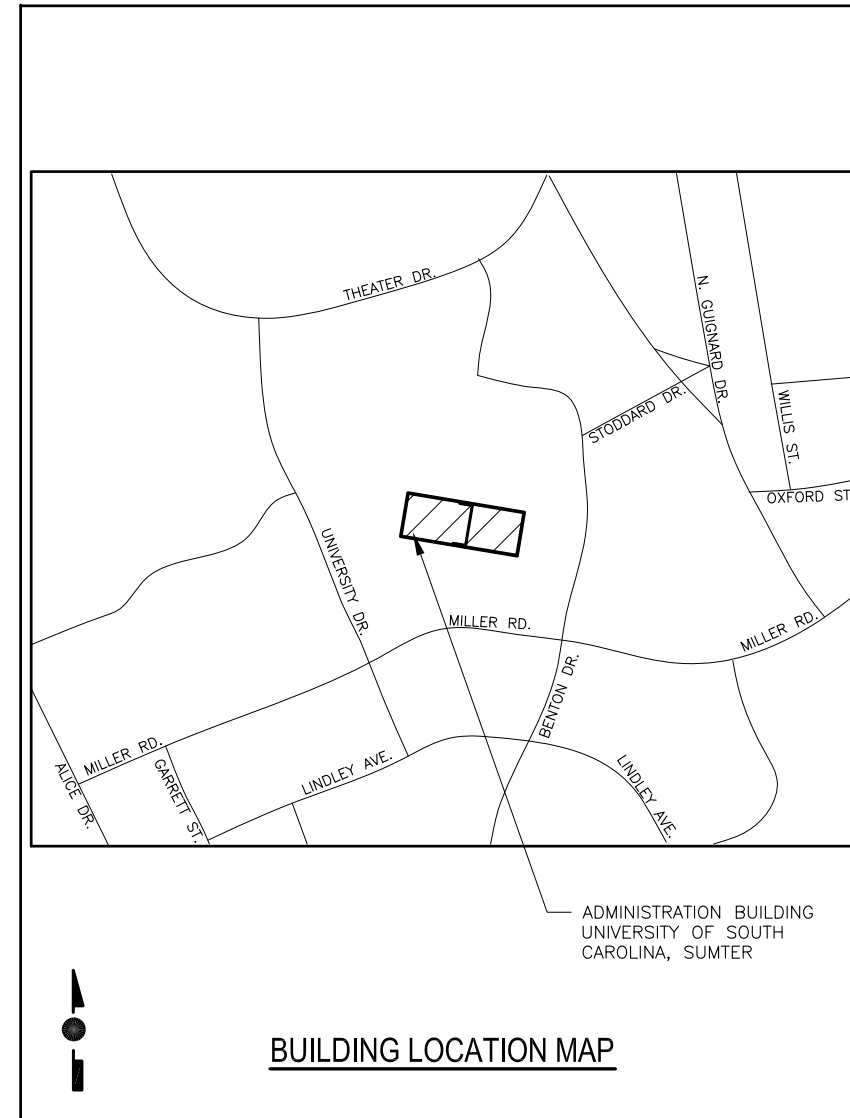
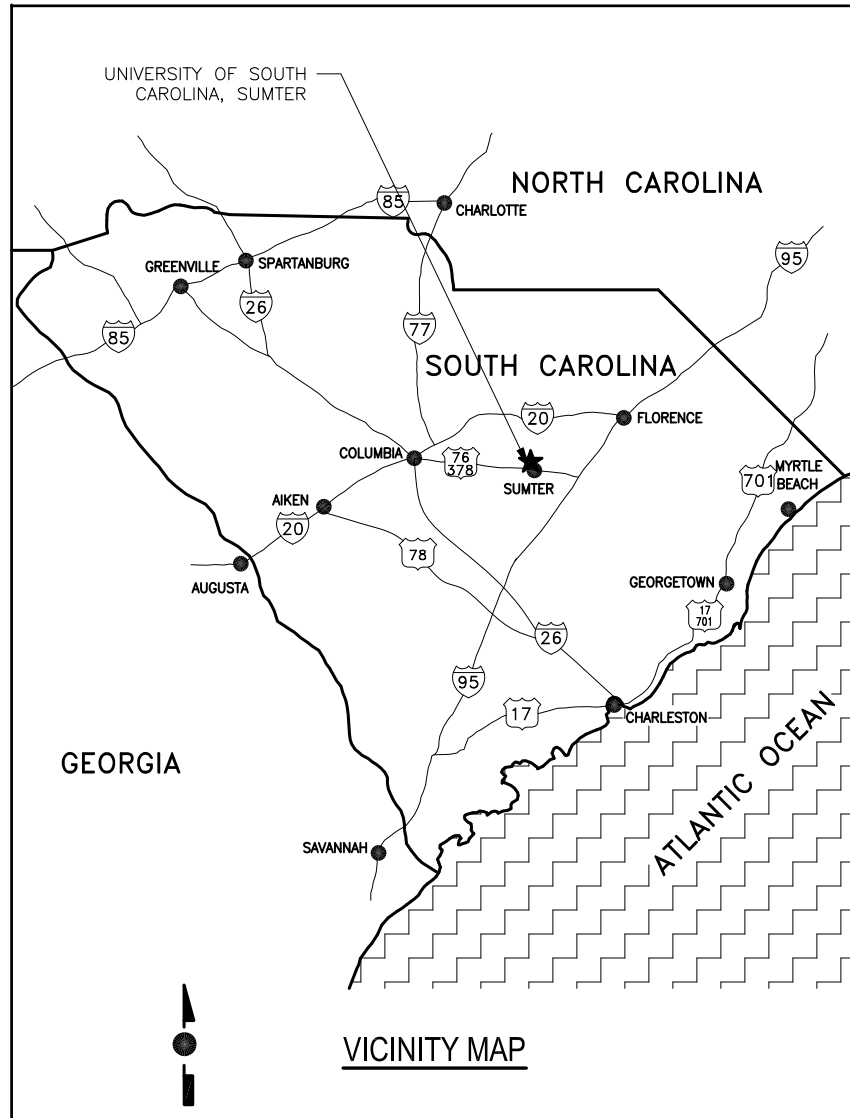

| LEGEND | | ABBREVIATIONS | |
|--------|--|---------------|--|
| ▲XR-1 | SAMPLE TAKEN, R=ROOF F=FLASHING S=STICK | A | ABANDONED |
| → | ROOF AREA / LEVEL | ANSI | AMERICAN NATIONAL STANDARDS INSTITUTE |
| ○ | LOCATION OF SAMPLE CORE | BIA | BRICK INDUSTRY ASSOCIATION |
| ⊗ | ROOF AREA SYMBOL | DS | DOWNSPOUT |
| RD | ROOF DRAIN | EPDM | SINGLE PLY |
| OF | OVERFLOW SCUPPER | ETC | ET CETERA |
| □ | ROOF HATCH / SCUTTLE | HVAC | HEAT/VENTILATION/AIR CONDITION |
| VTR | VENT THRU ROOF | LB | POUND |
| EJ | EXPANSION JOINT | MAX | MAXIMUM |
| EJ | EXPANSION JOINT BY WALL | MIN | MINIMUM |
| □ | VENTILATOR | N.I.C. | NOT IN CONTRACT |
| ┌ | PARAPET WALL | NRCA | NATIONAL ROOFING CONTRACTORS ASSOCIATION |
| ← | SLOPE DIRECTION | O.C. | ON CENTER |
| | | OSHA | OCCUPATIONAL SAFETY AND HEALTH ASSOCIATION |
| | | PVC | POLYVINYLCHLORIDE |
| | | RD | ROOF DRAIN |
| | | SMACNA | SHEET METAL AND AIR CONDITIONING CONTRACTORS ASSOCIATION, INC. |
| | | SWRI | SEALANT WATERPROOFING RESTORATION INSTITUTE |
| | | TYP | TYPICAL |
| | | VTR | VENT THRU ROOF |
| | | W/ | WITH |

| DETAILS/SECTION IDENTIFIER | |
|----------------------------|----------------------|
| 1 | DETAIL/SECTION LABEL |
| R201 | SHEET SHOWN ON |

| DRAWING INDEX | |
|---------------|--------------------|
| R101 | COVER SHEET |
| R102 | GENERAL NOTES |
| R103 | EXISTING ROOF PLAN |
| R104 | NEW ROOF PLAN |
| R201 | DETAILS / SECTIONS |
| R202 | DETAILS / SECTIONS |

USC SUMTER - ADMINISTRATION BUILDING ROOF REPAIRS
 UNIVERSITY OF SOUTH CAROLINA, SUMTER
 OWNER PROJECT NO. H39-9519
 200 MILLER RD.
 SUMTER, SOUTH CAROLINA

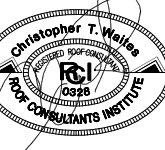
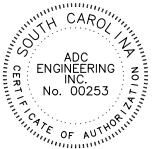

ADC
ENGINEERING SPECIALISTS

SITE SERVICES \ BUILDING ENVELOPE \ STRUCTURAL
 1226 YEAMANS HALL ROAD
 HANAHAN, SC 29410
 843-566-0161
 Fax: 843-566-0162
 ADCENGINEERING.COM

| | |
|----------------|---------|
| DATE: | 3-11-15 |
| ADC PROJECT #: | 14338 |
| DESIGNED: | CTW |
| CHECKED: | CTW |
| DRAWN: | DAA |
| REVISION: | |

COVER SHEET

R101
SHEET 1 OF 6

SUMMARY OF WORK

- A. THE BUILDINGS WILL REMAIN COMPLETELY FUNCTIONAL AND FULLY PROTECTED AT ALL TIMES DURING THE CONSTRUCTION WORK.
- B. BASE BID WORK INCLUDES SELECTIVE REPAIRS OF THE ROOF SYSTEM OF THE ADMINISTRATION BUILDING AT THE USC SUMTER CAMPUS. ALL ASSOCIATED SHEET METAL COMPONENTS AND ACCESSORIES ARE INCLUDED.
1. SELECTIVE DEMOLITION OF THE EXISTING ROOF SYSTEM IN ACCORDANCE WITH SECTION 02 04 00, CUTTING AND PATCHING AND SECTION 02 05 00, DEMOLITION AND REMOVAL.
 2. SELECTIVE LOW SLOPED ROOF SYSTEM REPAIRS IN ACCORDANCE WITH SECTION 07 50 01; GRAVEL SURFACED BUILT-UP ROOF REPAIRS.
 3. 07 50 01, GENERAL ROOF REPAIRS AND MAINTENANCE.
 4. SHEET METAL, COMPONENTS AND ACCESSORIES PER SECTION 07 60 00, SHEET METAL.
 5. SELECTIVE REPLACEMENT OF SEALANT SYSTEMS IN ACCORDANCE WITH SECTION 07 92 00, SEALANTS FOR ROOFING AND SHEET METAL.
- C. ALTERNATE NUMBER 1 WORK INCLUDES REPAIRING THE REMAINING SIX (6) ROOF DRAINS AND INSTALLATION OF NEW OVERFLOW SCUPPER LINERS WITH FACE PLATES AT THE REMAINING SIX (6) OVERFLOW SCUPPERS. ALL SPECIFICATION SECTIONS AND DRAWINGS APPLY TO ALTERNATE WORK.
- D. UNIT PRICES AND ALLOWANCES ARE INCLUDED IN ACCORDANCE WITH SECTION 01 21 10, UNIT PRICES AND ALLOWANCES AND ARE TO BE INCLUDED IN THE BASE BID.

UNIT PRICE QUANTITIES

1. IN ACCORDANCE WITH SECTION 01 11 00, SUMMARY OF WORK, THE CONTRACT DOCUMENTS INCLUDE WITHIN THE BASE BID SPECIFIC QUANTITIES.
2. THE SPECIFIC QUANTITIES ARE LISTED WITHIN THE INDIVIDUAL SPECIFICATION SECTIONS OF THIS PROJECT AND ARE INCLUDED ON THE BID FORM AS NOTED.

A SINGLE UNIT PRICE WILL BE PROVIDED FOR EACH ITEM, TO BE USED AS AN 'ADD' OR 'DEDUCT', BASED ON ACTUAL FIELD CONDITIONS. ANY QUANTITY ABOVE OR BELOW THESE SPECIFIED AMOUNTS WILL RESULT IN AN 'ADD' OR 'DEDUCT' TO THE CONTRACT SUM BASED ON THE REQUIRED UNIT PRICES.
3. IN ACCORDANCE WITH SECTION 01 21 10, UNIT PRICES AND ALLOWANCES, THE FOLLOWING DOCUMENTATION IS REQUIRED.
 - A. THE CONTRACTOR SHALL MAINTAIN A LOG OF ALL REPAIR UNIT PRICED QUANTITIES USED BASED ON CONTRACT REQUIREMENTS.
 - B. CONTRACTOR SHALL NOTIFY OWNER IN WRITING WHEN 80% OF QUANTITY IS USED FOR EACH UNIT PRICE ITEM.
 - C. OWNER IS NOT RESPONSIBLE FOR QUANTITIES WHICH EXCEED 80% UNLESS OWNER IS NOTIFIED IN WRITING PRIOR TO EXCEEDING THESE QUANTITIES, AND CONTRACTOR RECEIVES APPROVAL TO PROCEED.
 - D. PROVIDE PHOTOGRAPH OR VIDEOTAPE DOCUMENTATION OF REPAIRS AND ACTUAL QUANTITIES USED.
 - E. LOCATE QUANTITIES AND SHOW THEIR LOCATIONS ON DRAWINGS.
 - F. PROVIDE ACTUAL USED QUANTITIES ON EACH APPLICATION FOR PAYMENT REQUEST.
4. PROVIDE SUMMARY OF UNIT QUANTITIES 'REQUIRED' VERSE 'USED' AND ABOVE DOCUMENTATION WHEN REQUESTED, AND AS PART OF PROJECT CLOSE-OUT REQUIREMENTS OF SECTION 01 77 00, CONTRACT CLOSE-OUT.

GENERAL M/E/P AND COORDINATION NOTES

1. DISCONNECT AND REMOVE ALL ROOFTOP MECHANICAL AND ELECTRICAL EQUIPMENT AS NECESSARY TO COMPLETE THE WORK AND REINSTALL UPON COMPLETION OF WORK.
2. ANY CABLES, WIRES, SATELLITE OR MICROWAVE DISHES, ANTENNAS AND ROOFTOP MECHANICAL, ELECTRICAL OR ELECTRONIC COMPONENTS SHALL BE TEMPORARILY DISCONNECTED AND RECONNECTED BY QUALIFIED CRAFTSMEN. THIS INCLUDES ROOF AREAS, FLASHINGS AND ADJACENT WALL AREAS.
3. ANY LOCATIONS/CONDITIONS WHERE THE ABOVE REQUIREMENTS CANNOT BE MET, SHALL BE BROUGHT TO THE ATTENTION OF THE ROOF CONSULTANT/ENGINEER OR OWNER IMMEDIATELY.

CONSTRUCTION NOTES

1. SUBSTRATE SHALL BE INSPECTED AND REPAIRED AS SPECIFIED.
2. PROVIDE ALL NEW PRODUCTS AS REQUIRED TO PROVIDE FOR INDICATED REPAIRS AND TO MEET SPECIFIED REQUIREMENTS.
3. ROOFING AND SHEET METAL WORK SHALL BE IN STRICT ACCORDANCE WITH THE CONTRACT REQUIREMENTS. ANY CLARIFICATIONS OR ADDITIONAL INFORMATION SHALL BE IN ACCORDANCE WITH PUBLISHED GUIDELINES OF NRCA ROOFING AND WATERPROOFING MANUAL (5th EDITION) AND SMACNA ARCHITECTURAL SHEET METAL MANUAL (7th EDITION).
4. ALL FLASHING TERMINATIONS SHALL HAVE CONFORMING WATERTIGHT SHEET METAL CLOSURES, AND WATERPROOF UNDERLAYMENT ALL SHEETMETAL BELOW W/ SEALED LAPS.
5. SPECIFIC AND TYPICAL DETAILS ARE PROVIDED. TYPICAL DETAILS APPLY TO ALL INSTANCES WHERE SIMILAR CONDITION OCCURS.
6. ALL WORK SHALL BE CONDUCTED IN A SUBSTANTIAL WORKMANLIKE MANNER IN ACCORDANCE WITH SPECIFIED REQUIREMENTS.

PROTECTION NOTES

1. FACILITIES MAY BE OCCUPIED DURING CONSTRUCTION. CONTRACTOR SHALL TAKE ALL NECESSARY PRECAUTIONS TO PROTECT THE FACILITY, CONTENTS, AND OCCUPANTS.
2. THE BUILDING SHALL BE WATERTIGHT AT THE END OF EACH DAY'S WORK AND WHEN INCLEMENT WEATHER THREATENS.
3. CONTRACTOR SHALL PROTECT THE BUILDING EXTERIOR AND GROUNDS INCLUDING SURFACES, GRASS, PLANTS, TREES, SHRUBS, AND OTHER LANDSCAPING. THE CONTRACTOR SHALL RETURN THE SITE AND ANY DAMAGED ITEMS TO ORIGINAL OR BETTER CONDITION.
4. ANY SURFACES STAINED, MARRED, OR DAMAGED BY THE WORK OR THE CONTRACTOR, THE CONTRACTOR SHALL RETURN THE SITE AND ANY DAMAGED ITEMS OF THE SITE OR FACILITY TO ORIGINAL OR BETTER CONDITION AND MATCH ADJACENT SURFACES.
5. WORK SHALL BE SEQUENCED TO MINIMIZE TRAFFIC ON THE NEW WORK.

GENERAL NOTES

1. PRIOR TO PERFORMING WORK, CONTRACTOR SHALL INSPECT DECK SURFACES AND SUBSTRATE CONDITIONS. PROVIDE FOR THE SAFETY AND PROTECTION OF WORKERS AND OCCUPANTS THROUGHOUT THE COURSE OF WORK.
2. ALL BUILDING DIMENSIONS, EXISTING CONDITIONS, ITEM LOCATIONS, AND SIZE AND QUANTITY OF PENETRATIONS SHALL BE FIELD VERIFIED BY THE CONTRACTOR PRIOR TO BID.
3. LAYDOWN / STORAGE AREA IS LIMITED AND SHALL BE AS APPROVED BY THE OWNER.
4. SITE SHALL BE CLEANED ON A DAILY BASIS AND SECURED AT THE END OF EACH WORK DAY.
5. BUILDING ACCESS SHALL BE COORDINATED WITH THE OWNER AND SHALL BE ONLY AS REQUIRED TO ACCOMPLISH CONTRACT WORK.

DEMOLITION NOTES

1. SEE SECTION 01 50 00, CONSTRUCTION FACILITIES AND TEMPORARY CONTROLS, SECTION 02 04 00, CUTTING AND PATCHING, AND SECTION 02 05 00, DEMOLITION AND REMOVAL.
2. REMOVE ALL FLASHINGS AND ACCESSORIES AS NOTED, SPECIFIED OR REQUIRED TO COMPLETE THE WORK, ALL NEW SHEET METAL REQUIRED UNLESS OTHERWISE INDICATED.
3. THE UNDERSIDE (INTERIOR SIDE) OF THE DECK MAY HAVE HVAC, ELECTRICAL FIXTURES, ETC. ATTACHED. THE CONTRACTOR SHALL HAVE QUALIFIED CRAFTSMEN REMOVE AND REINSTALL ALL AFFECTED ITEMS OF THE DEMOLITION OF ROOFING TO COMPLETE THE WORK AND TO REPAIR/REPLACE DECKING. THE LOCATION AND METHOD OF ATTACHMENT SHALL BE THE SAME AS THE ORIGINAL, UNLESS DIRECTED OR APPROVED OTHERWISE BY THE ROOF CONSULTANT AND/OR THE OWNER.
4. ALL DEMOLITION SHALL ADHERE TO ANSI AND OSHA GUIDELINES, AND SECTION 01 52 05.

USC SUMTER - ADMINISTRATION BUILDING ROOF REPAIRS

UNIVERSITY OF SOUTH CAROLINA, SUMTER

OWNER PROJECT NO. H39-9519

200 MILLER RD.

SUMTER, SOUTH CAROLINA

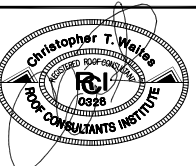
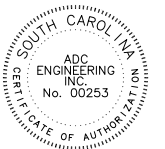

ENGINEERING SPECIALISTS

SITE SERVICES \ BUILDING ENVELOPE \ STRUCTURAL
1226 YEAMANS HALL ROAD
HANAHAN, SC 29410
843-566-0161
Fax: 843-566-0162
ADCENGINEERING.COM

DATE: 3-11-15

ADC PROJECT #: 14338

DESIGNED: CTW

CHECKED: CTW

DRAWN: DAA

REVISION:

GENERAL NOTES

R102

THESE PROJECT DRAWINGS ARE THE PROPERTY OF ADC ENGINEERING, INC. DRAWINGS ARE PROVIDED FOR PROJECT RECORD FILING ONLY. ANY OTHER USE, REPRODUCTION OR COPYING IN WHOLE OR IN PART IS NOT AUTHORIZED. ALL RIGHTS RESERVED.

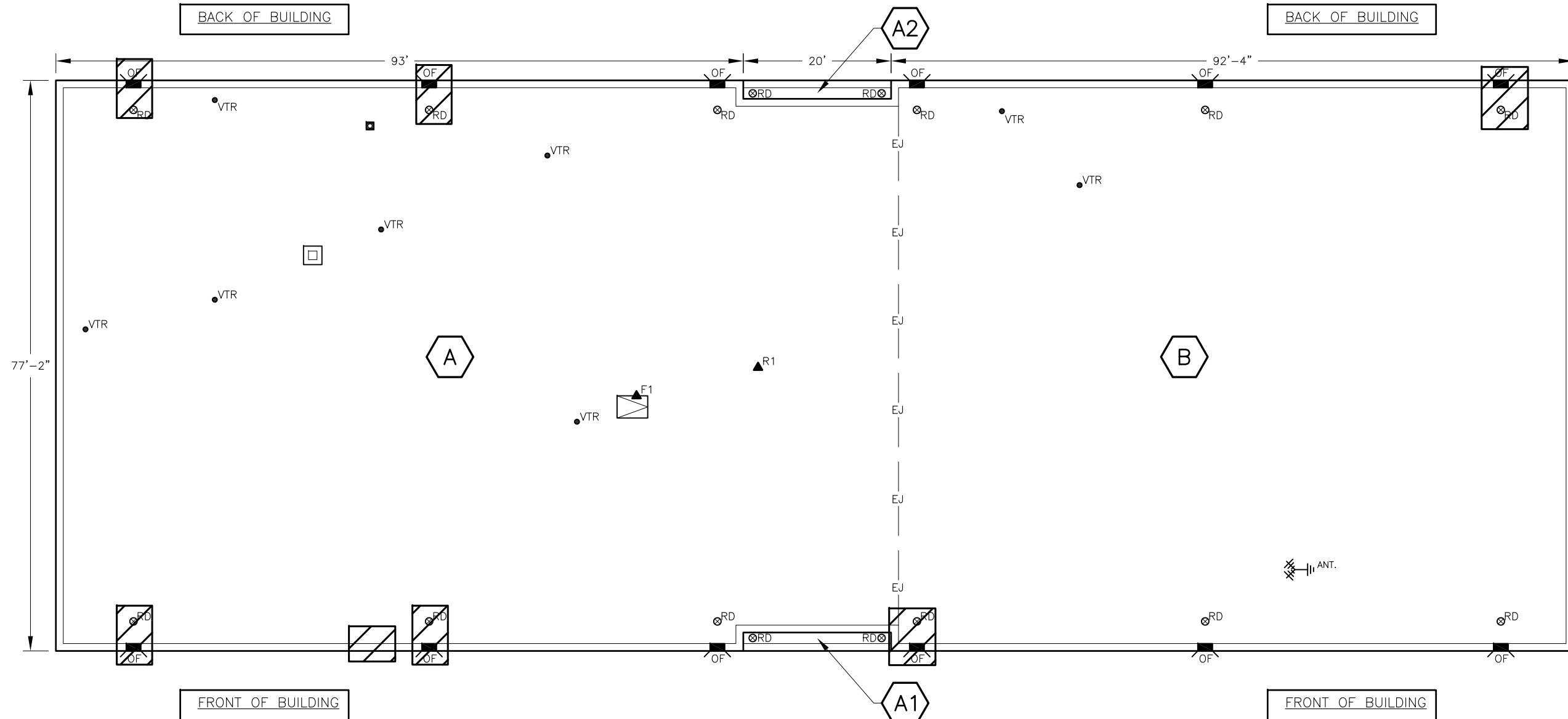

EXISTING ROOF PLAN

NOTE:
 = APPROXIMATE LOCATIONS OF KNOWN LEAKS

PLAN NORTH

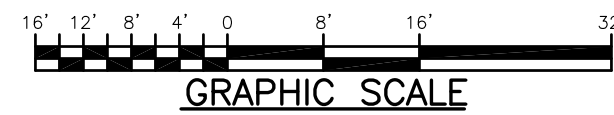

CONSTRUCTION DOCUMENTS

USC SUMTER - ADMINISTRATION BUILDING ROOF REPAIRS
 UNIVERSITY OF SOUTH CAROLINA, SUMTER
 OWNER PROJECT NO. H39-9519
 200 MILLER RD.
 SUMTER, SOUTH CAROLINA

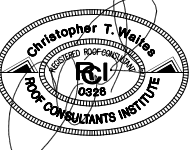
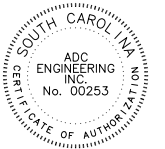

ADC
ENGINEERING SPECIALISTS
 SITE SERVICES \ BUILDING ENVELOPE \ STRUCTURAL
 1226 YEAMANS HALL ROAD
 HANAHAN, SC 29410
 843-566-0161
 Fax: 843-566-0162
 ADCENGINEERING.COM

DATE: 3-11-15
 ADC PROJECT #: 14338
 DESIGNED: CTW
 CHECKED: CTW
 DRAWN: DAA
 REVISION:

EXISTING ROOF PLAN

R103

SHEET 3 OF 6

THESE PROJECT DRAWINGS ARE THE PROPERTY OF ADC ENGINEERING, INC. DRAWINGS ARE PROVIDED FOR PROJECT RECORD FILING ONLY. ANY OTHER USE, REPRODUCTION OR COPYING IN WHOLE OR IN PART IS NOT AUTHORIZED. ALL RIGHTS RESERVED.

REPAIR NOTES:

1. ALL COPING COVER PLATES ARE TO BE REPLACED PER DETAIL 4/R201 AND DETAIL 8/R202.
2. EXISTING ROOF MEMBRANE AND EXISTING BASE FLASHING TO BE INSPECTED AND REPAIRED AS REQUIRED PER THE CONSTRUCTION DOCUMENTS..
3. ALL ROOF DRAINS TO BE FLOOD TESTED. REPAIRS TO BE MADE AS REQUIRED PER THE CONSTRUCTION DOCUMENTS.
4. ALL PIPE / VTR PENETRATIONS TO BE RE-WORKED IN ACCORDANCE WITH DETAIL 6/R201.

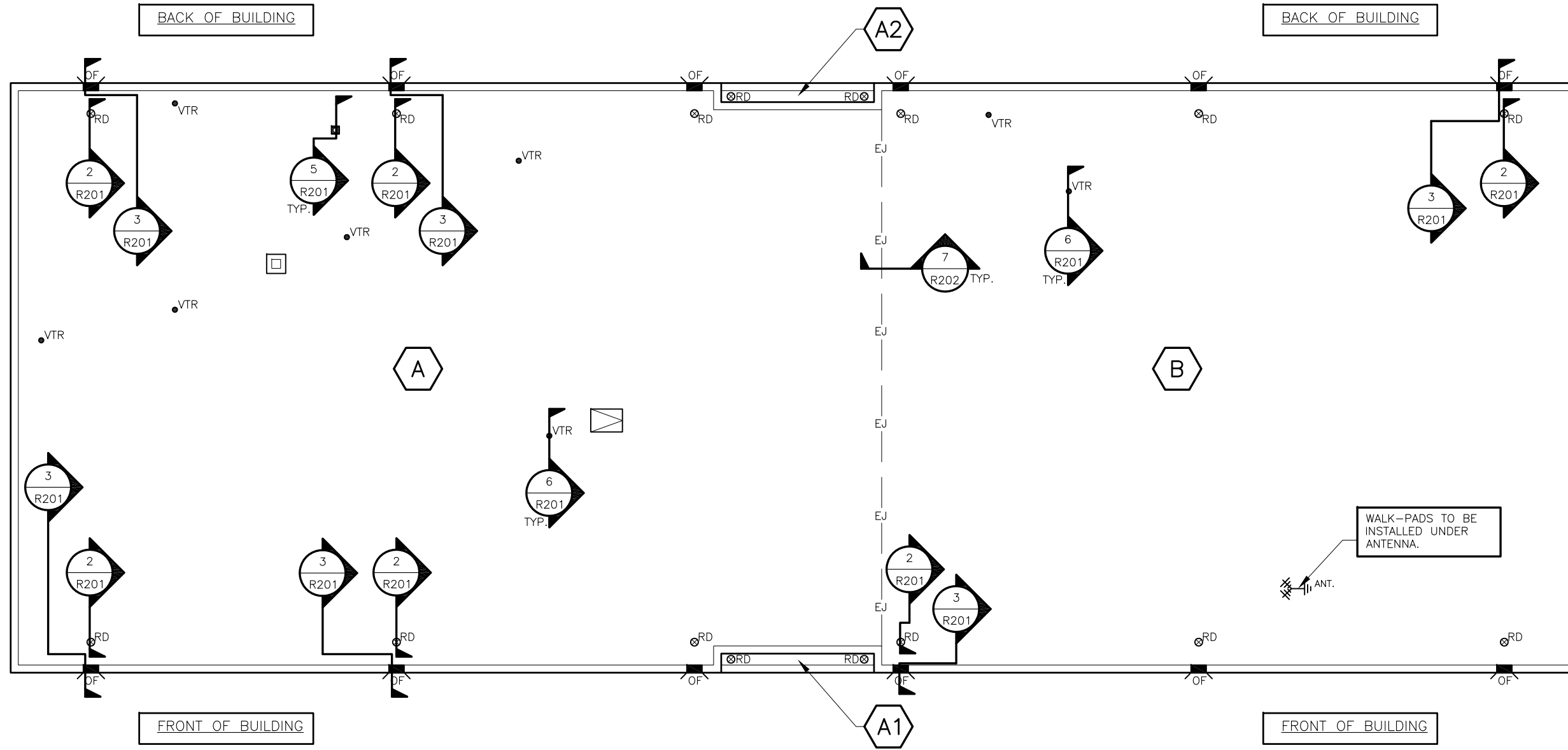

NEW ROOF PLAN

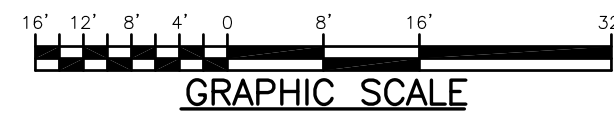

USC SUMTER - ADMINISTRATION BUILDING ROOF REPAIRS
 UNIVERSITY OF SOUTH CAROLINA, SUMTER
 OWNER PROJECT NO. H39-9519
 200 MILLER RD.
 SUMTER, SOUTH CAROLINA

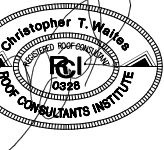
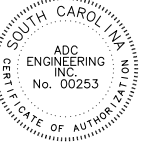

ADC
 ENGINEERING SPECIALISTS
 SITE SERVICES \ BUILDING ENVELOPE \ STRUCTURAL
 1226 YEAMANS HALL ROAD
 HANAHAN, SC 29410
 843-566-0161
 Fax: 843-566-0162
 ADCENGINEERING.COM

DATE: 3-11-15
 ADC PROJECT #: 14338
 DESIGNED: CTW
 CHECKED: CTW
 DRAWN: DAA
 REVISION:

NEW ROOF PLAN

R104

THESE PROJECT DRAWINGS ARE THE PROPERTY OF ADC ENGINEERING, INC. DRAWINGS ARE PROVIDED FOR PROJECT RECORD FILING ONLY. ANY OTHER USE, REPRODUCTION OR COPYING IN WHOLE OR IN PART IS NOT AUTHORIZED. ALL RIGHTS RESERVED.

NOTES:

1. REMOVE ALL EXISTING AGGREGATE SURFACING DOWN TO THE EXISTING ROOF MEMBRANE AND PRIME PER MANUFACTURERS INSTRUCTIONS.
2. GRANULAR SURFACED MODIFIED CAP SHEET TO BE FULLY ADHERED IN COLD ADHESIVE OR TORCH APPLIED.

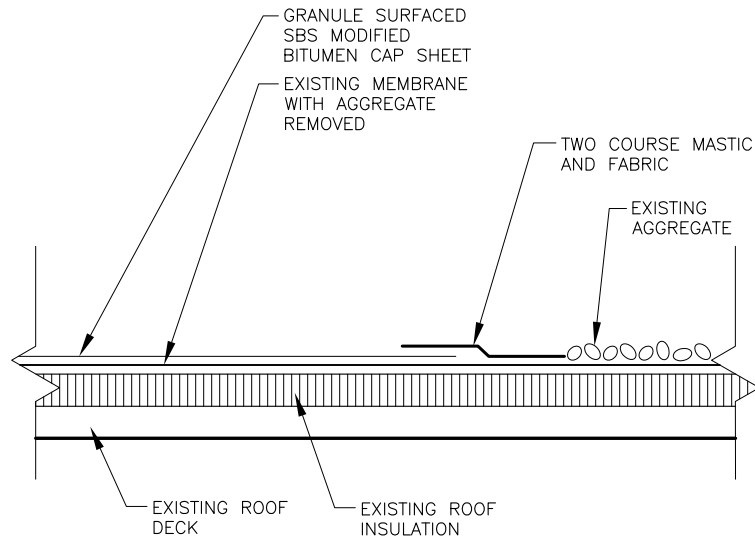

1 TIE-IN DETAIL
R201 NOT TO SCALE (TYPICAL)

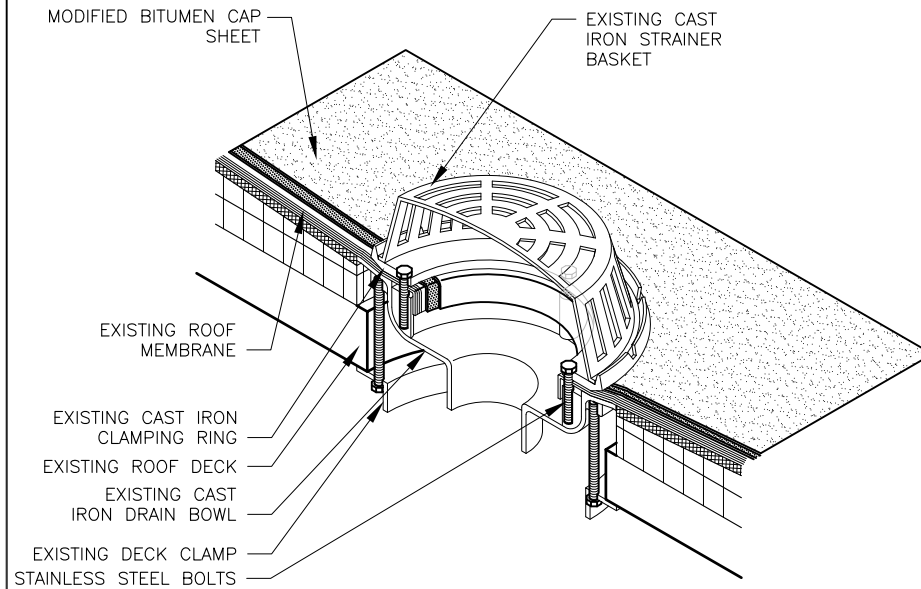

NOTE:

1. REMOVE ALL EXISTING AGGREGATE SURFACING DOWN TO THE EXISTING ROOF MEMBRANE AND PRIME PER MANUFACTURERS INSTRUCTIONS.
2. GRANULAR SURFACED MODIFIED CAP SHEET TO BE FULLY ADHERED IN COLD ADHESIVE AND TO EXTEND UNDER ROOF DRAIN CLAMPING RING.

2 ROOF DRAIN
R201 NOT TO SCALE (TYPICAL)

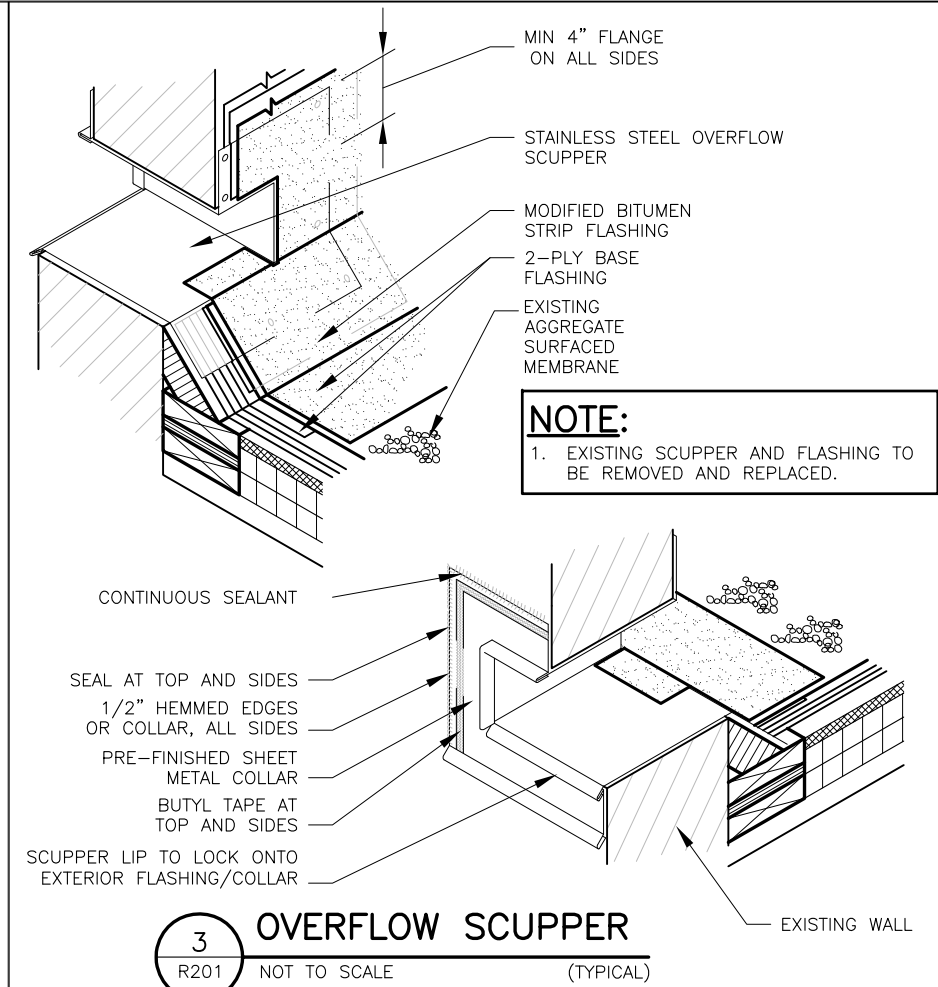

NOTE:

1. EXISTING SCUPPER AND FLASHING TO BE REMOVED AND REPLACED.

3 OVERFLOW SCUPPER
R201 NOT TO SCALE (TYPICAL)

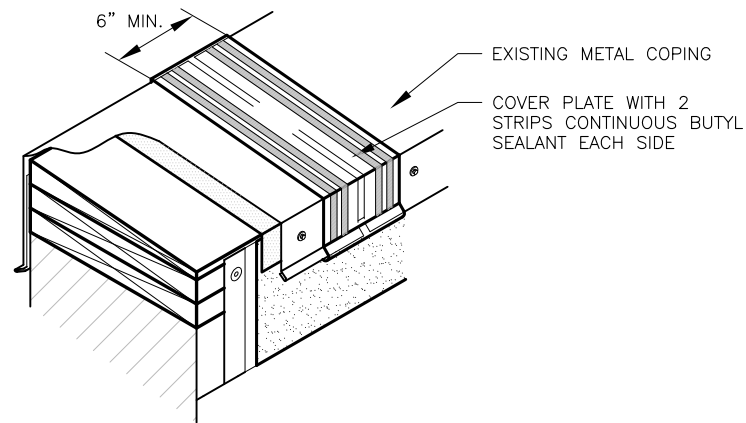

4 BASE FLASHING AT PARAPET
R201 NOT TO SCALE (TYPICAL)

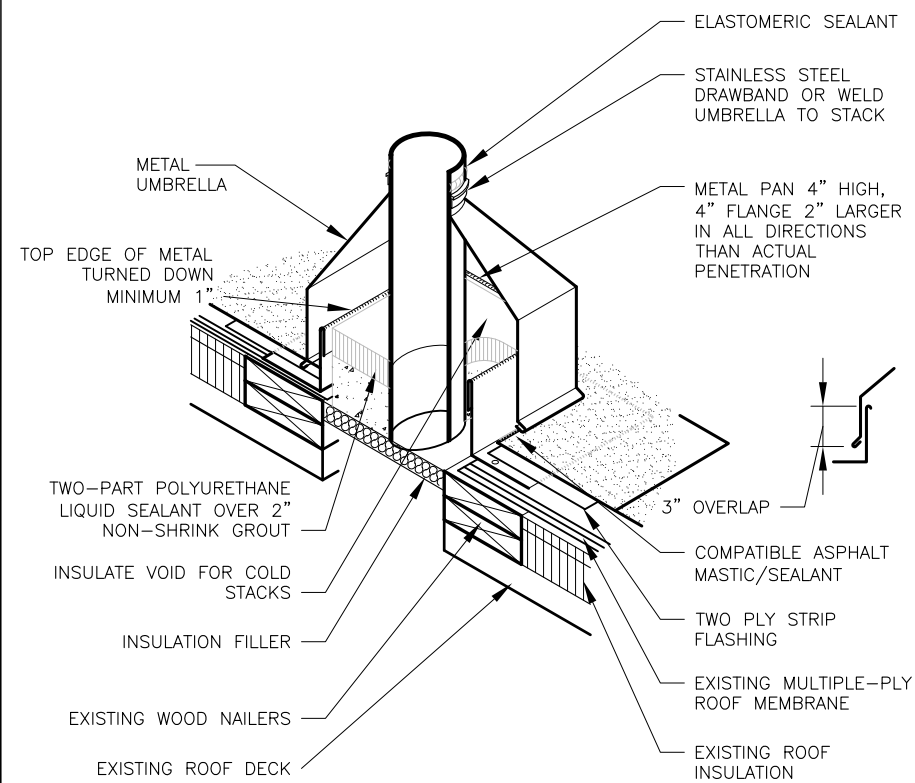

5 PITCH PAN WITH UMBRELLA
R201 NOT TO SCALE (TYPICAL)

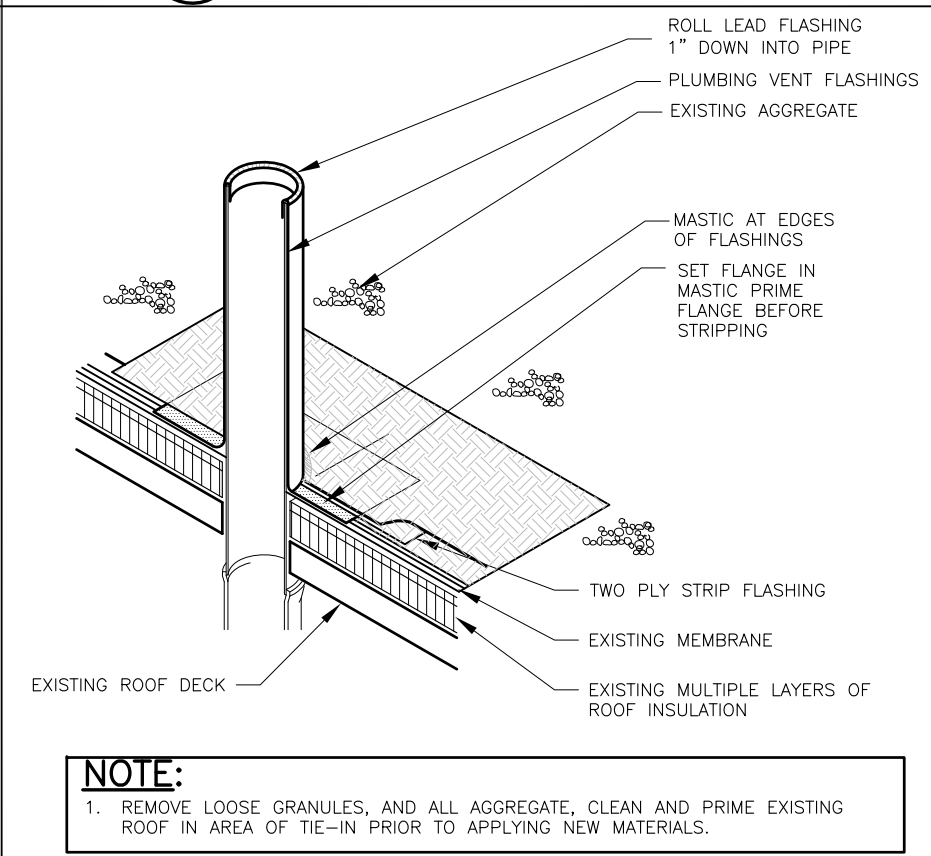

NOTE:

1. REMOVE LOOSE GRANULES, AND ALL AGGREGATE, CLEAN AND PRIME EXISTING ROOF IN AREA OF TIE-IN PRIOR TO APPLYING NEW MATERIALS.

6 PLUMBING VENT FLASHING
R201 NOT TO SCALE

USC SUMTER - ADMINISTRATION BUILDING ROOF REPAIRS
UNIVERSITY OF SOUTH CAROLINA, SUMTER
OWNER PROJECT NO. H39-9519
200 MILLER RD.
SUMTER, SOUTH CAROLINA

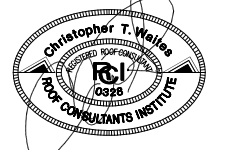
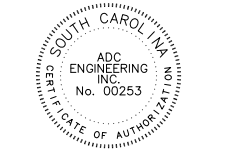

ADC ENGINEERING SPECIALISTS
SITE SERVICES \ BUILDING ENVELOPE \ STRUCTURAL
1226 YEAMANS HALL ROAD
HANAHAN, SC 29410
843-566-0161
Fax: 843-566-0162
ADCENGINEERING.COM

DATE: 3-11-15
ADC PROJECT #: 14338
DESIGNED: CTW
CHECKED: CTW
DRAWN: DAA
REVISION:

DETAILS/ SECTIONS

THESE PROJECT DRAWINGS ARE THE PROPERTY OF ADC ENGINEERING, INC. DRAWINGS ARE PROVIDED FOR PROJECT RECORD FILING ONLY. ANY OTHER USE, REPRODUCTION OR COPYING IN WHOLE OR IN PART IS NOT AUTHORIZED. ALL RIGHTS RESERVED.

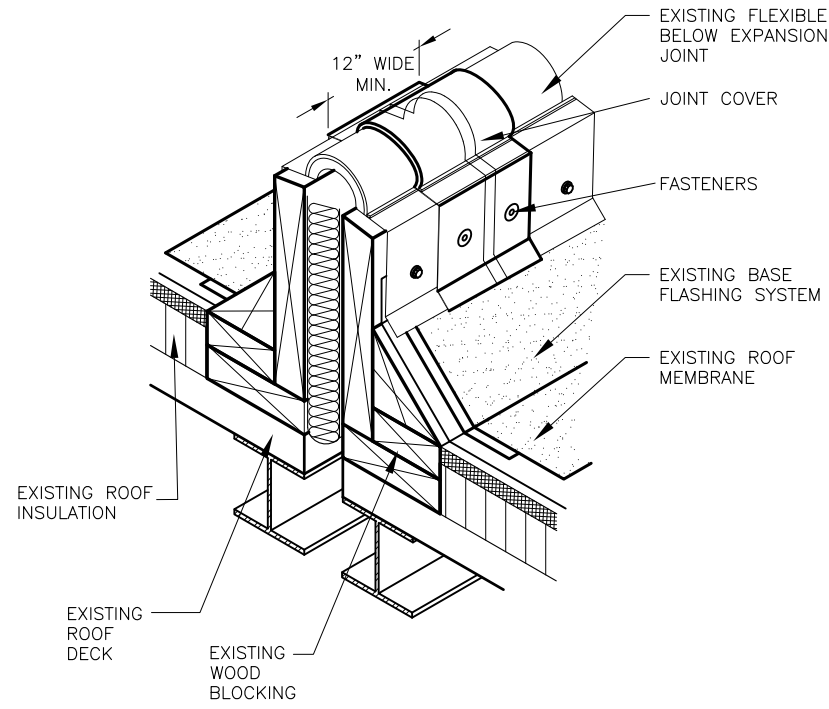

7 EXPANSION JOINT COVER REPAIR
R202 NOT TO SCALE (TYPICAL)

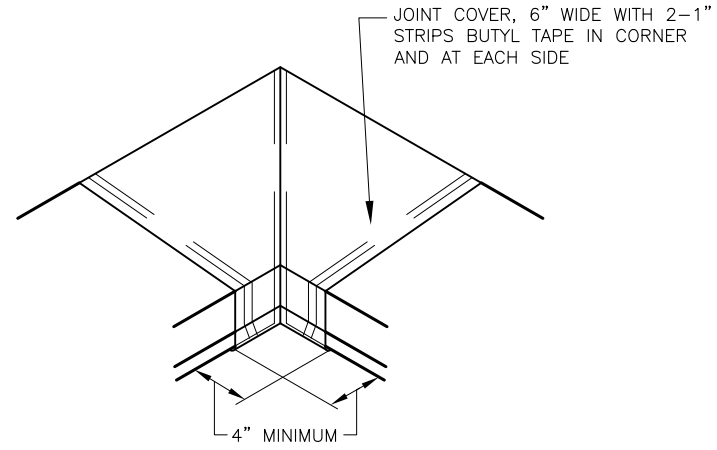

NOTE:
1. ALL COPING COVER PLATES TO BE REPLACED AS REQUIRED PER THE CONSTRUCTION DOCUMENTS.

8 COPING COVER PLATES @ CORNERS
R202 NOT TO SCALE (TYPICAL)

INTENTIONALLY LEFT BLANK

INTENTIONALLY LEFT BLANK

INTENTIONALLY LEFT BLANK

INTENTIONALLY LEFT BLANK

USC SUMTER - ADMINISTRATION BUILDING ROOF REPAIRS
UNIVERSITY OF SOUTH CAROLINA, SUMTER
OWNER PROJECT NO. H39-9519
200 MILLER RD.
SUMTER, SOUTH CAROLINA

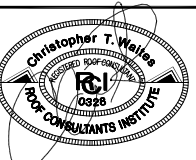
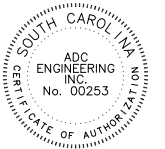

ADC
ENGINEERING SPECIALISTS
SITE SERVICES \ BUILDING ENVELOPE \ STRUCTURAL
1226 YEAMANS HALL ROAD
HANAHAN, SC 29410
843-566-0161
Fax: 843-566-0162
ADCENGINEERING.COM

DATE: 3-11-15
ADC PROJECT #: 14338
DESIGNED: CTW
CHECKED: CTW
DRAWN: DAA
REVISION:

DETAILS/
SECTIONS

R202