



ENGINEERS - SURVEYORS  
 COX AND DINKINS, INC.  
 724 BELTLINE BLVD.  
 COLUMBIA, SC 29205  
 803-254-0518  
 Fax: 803-765-0993  
 Email: cdinc@coxanddinkins.com

REGISTERED PROFESSIONAL ENGINEER  
 No. 14890



CERTIFICATE OF AUTHORIZATION SEAL

NO.	DATE	REVISIONS	DESCRIPTION

DEVELOPER:  
 UNIVERSITY OF SOUTH CAROLINA  
 Facilities Design and Construction  
 743 Green Street  
 Columbia, SC 29208  
 803.777.5811  
 PROJECT CONTACT:  
 Fred Scott  
 864.503.5538

**BID SET**  
**UNIVERSITY OF SOUTH CAROLINA UPSTATE**  
**NORTH CAMPUS BOULEVARD REPAIR / IMPROVEMENTS**  
**STATE PROJECT H34-1360**  
 LOCATED IN SPARTANBURG  
 SPARTANBURG COUNTY, SOUTH CAROLINA  
**REPAVING/REHABILITATION PLAN**

TMS 6-08-00-010.01	SF NO. N/A
PROJECT NO. 1703	SHEET NO. <b>C4 of 6</b>
DATE 5/10/2013	

**NOTES TO CONTRACTOR:**

- 1) THE CONTRACTOR SHALL NOTIFY FRED SCOTT OF UNIVERSITY OF SOUTH CAROLINA UPSTATE (864-503-5538) 48 HOURS PRIOR TO STARTING WORK.
- 2) CONTRACTOR SHALL PROVIDE TRAFFIC CONTROL PER MUTCD AND SOUTH CAROLINA SUPPLEMENT TO MUTCD. CONTRACTOR SHALL BE RESPONSIBLE FOR PROVIDING TRAFFIC CONTROL AND BARRIERS IN THE PAVEMENT, DRIVE AREAS, AND SIDEWALKS TO ENSURE TRAFFIC DOES NOT DISRUPT THE WORK IN PROGRESS. CONTRACTOR SHALL COORDINATE WITH FRED SCOTT OF UNIVERSITY OF SOUTH CAROLINA UPSTATE (864-503-5538).
- 3) CONTRACTOR SHALL CONSULT WITH PAVEMENT MARKING MANUFACTURER AND SUBCONTRACTOR TO DETERMINE ACCEPTABLE PROCEDURE FOR APPLYING PAVEMENT MARKINGS PRIOR TO THE RECOMMENDED ASPHALT CURING PERIOD. CONTRACTOR SHALL BE RESPONSIBLE FOR REPAIRING DAMAGE TO THE NEW ASPHALT THAT MAY BE CAUSED BY IMPROPER APPLICATION OF PAVEMENT MARKINGS.
- 4) CONTRACTOR SHALL NOTIFY PUPS, METROPOLITAN WATER DISTRICT (864-503-0822) AND USC UPSTATE FACILITIES MANAGEMENT (864-503-5500) A MINIMUM THREE(3) DAYS PRIOR TO DIGGING.
- 5) TWO LANES OF VEHICULAR TRAFFIC SHALL BE MAINTAINED AT ALL TIMES, EXCEPT FOR SHORT TIME PERIODS AND ONLY AFTER COORDINATION WITH USCU.

**GENERAL NOTES:**

- 1) THE LOCATION OF OTHER UNDERGROUND UTILITIES AND THEIR SERVICES ARE UNKNOWN.
- 2) IT IS THE CONTRACTOR'S RESPONSIBILITY TO VERIFY THAT THEY AND THEIR SUBCONTRACTORS HAVE THE CORRECT/LAST REVISED PLANS AVAILABLE.
- 3) IT IS THE CONTRACTOR'S RESPONSIBILITY TO COORDINATE WITH THE OWNER/OPERATOR FOR UTILITY LOCATIONS PRIOR TO START OF CONSTRUCTION.
- 4) ALL UTILITY LIDS, VALVES, MANHOLES, ETC. ENCOUNTERED DURING THIS MILLING AND REPAVING PROJECT SHALL BE PROTECTED AND RAISED TO FINAL GRADE AS NECESSARY.
- 5) SEED AND STRAW DISTURBED AREA OF NEW WORK IMMEDIATELY AFTER WORK HAS BEEN COMPLETED.
- 6) ALL DISTURBED AREAS SHALL BE GRASSED TO CAMPUS STANDARD.
- 7) 4" OF TOP SOIL SHALL BE PLACED OVER ALL GRADED AREAS PRIOR TO GRASSING.
- 8) INSTALL TREE PROTECTION AS NECESSARY AND/OR AS DIRECTED BY THE OWNER.
- 9) ALL AREAS SHALL BE SWEEP CLEAN PRIOR TO RESURFACING.

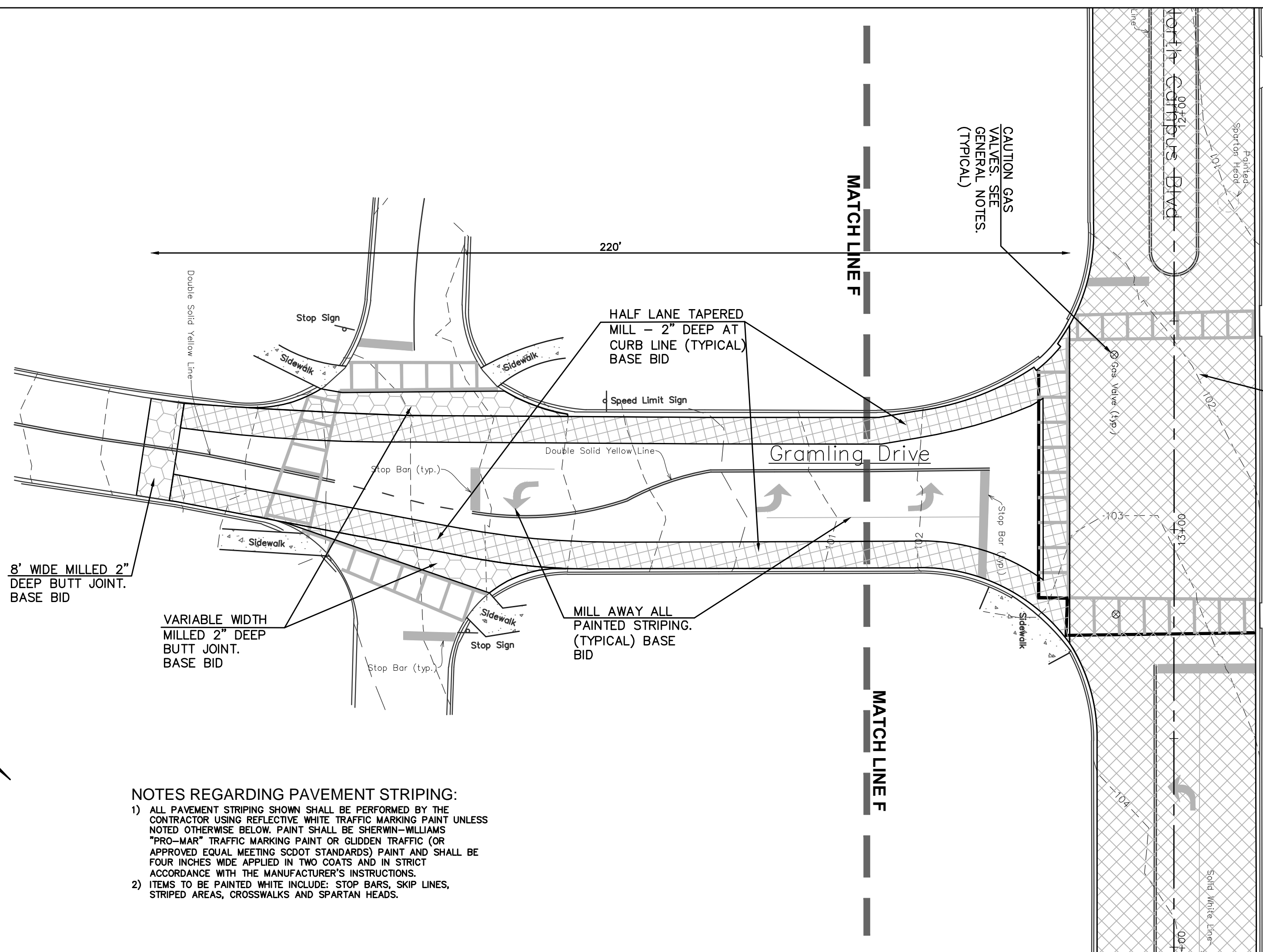

**NOTES REGARDING PAVEMENT STRIPING:**

- 1) ALL PAVEMENT STRIPING SHOWN SHALL BE PERFORMED BY THE CONTRACTOR USING REFLECTIVE WHITE TRAFFIC MARKING PAINT UNLESS NOTED OTHERWISE BELOW. PAINT SHALL BE SHERWIN-WILLIAMS "PRO-MARK" TRAFFIC MARKING PAINT OR GLOIDEN TRAFFIC OR APPROVED EQUAL MEETING SCODT STANDARDS) PAINT AND SHALL BE FOUR INCHES WIDE APPLIED IN TWO COATS AND IN STRICT ACCORDANCE WITH THE MANUFACTURER'S INSTRUCTIONS.
- 2) ITEMS TO BE PAINTED WHITE INCLUDE: STOP BARS, SKIP LINES, STRIPED AREAS, CROSSWALKS AND SPARTAN HEADS.

GENERAL NOTE: REGARDLESS OF BASE BID OR ALTERNATES THE ENTIRE PROJECT AREA BEGINNING AT STATION 1+69 SHALL BE OVERLAID WITH A SCODT STANDARD 2" SURFACE COURSE (TYPE 3 AND 4) AND A SCODT STANDARD 1" PRIME COAT (MEETING SCODT STANDARDS) BASE BID SHALL INCLUDE HAULING AND DUMPING ALL MILLINGS TO A LOCATION ON CAMPUS.

- NOTES:**
1. ALL ASPHALT THICKNESSES ARE COMPACTED THICKNESS.
  2. FOR BASE BID ALL MILLINGS SHALL BE HAULED AND DUMPED AT A LOCATION ON CAMPUS.
  3. ALL STRIPING SHALL BE REINSTALLED AS IT EXISTS PRIOR TO CONSTRUCTION. CONTRACTOR SHALL PAINT LINES SMOOTHLY USING MINIMUM 30' RADII WHERE APPLICABLE.
  5. SEE NOTES ON PLAN CONCERNING BASE BID AND ALTERNATE NUMBERS 1, 2 AND 3.

