

# UNIVERSITY of SOUTH CAROLINA



UNIVERSITY OF  
**SOUTH CAROLINA**

## WARDLAW COLLEGE AND DRAYTON HALL HVAC EQUIPMENT AND ROOF REPLACEMENT STATE PROJECT No.: H27-6100

820 SUMTER STREET  
COLUMBIA, SC 29208

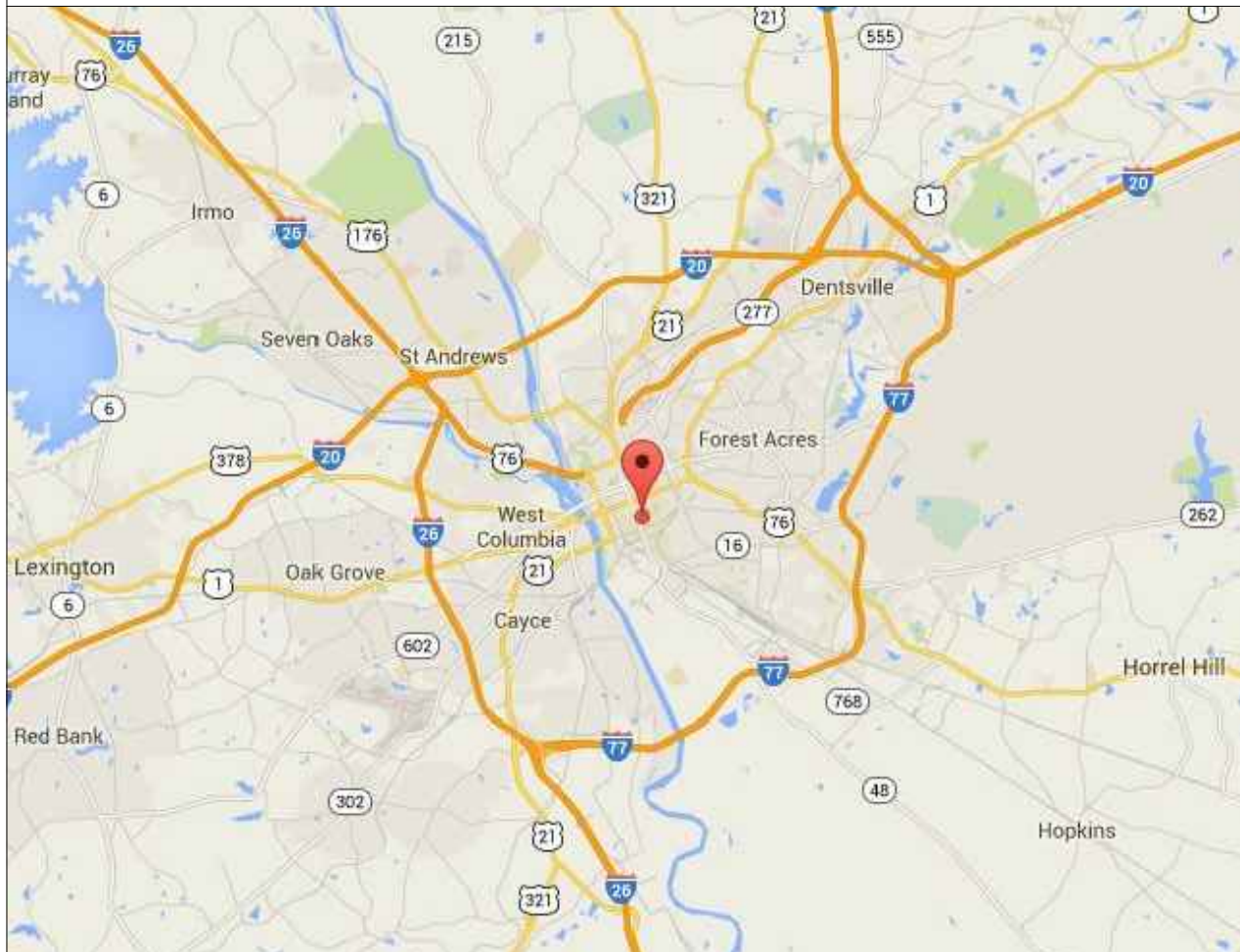
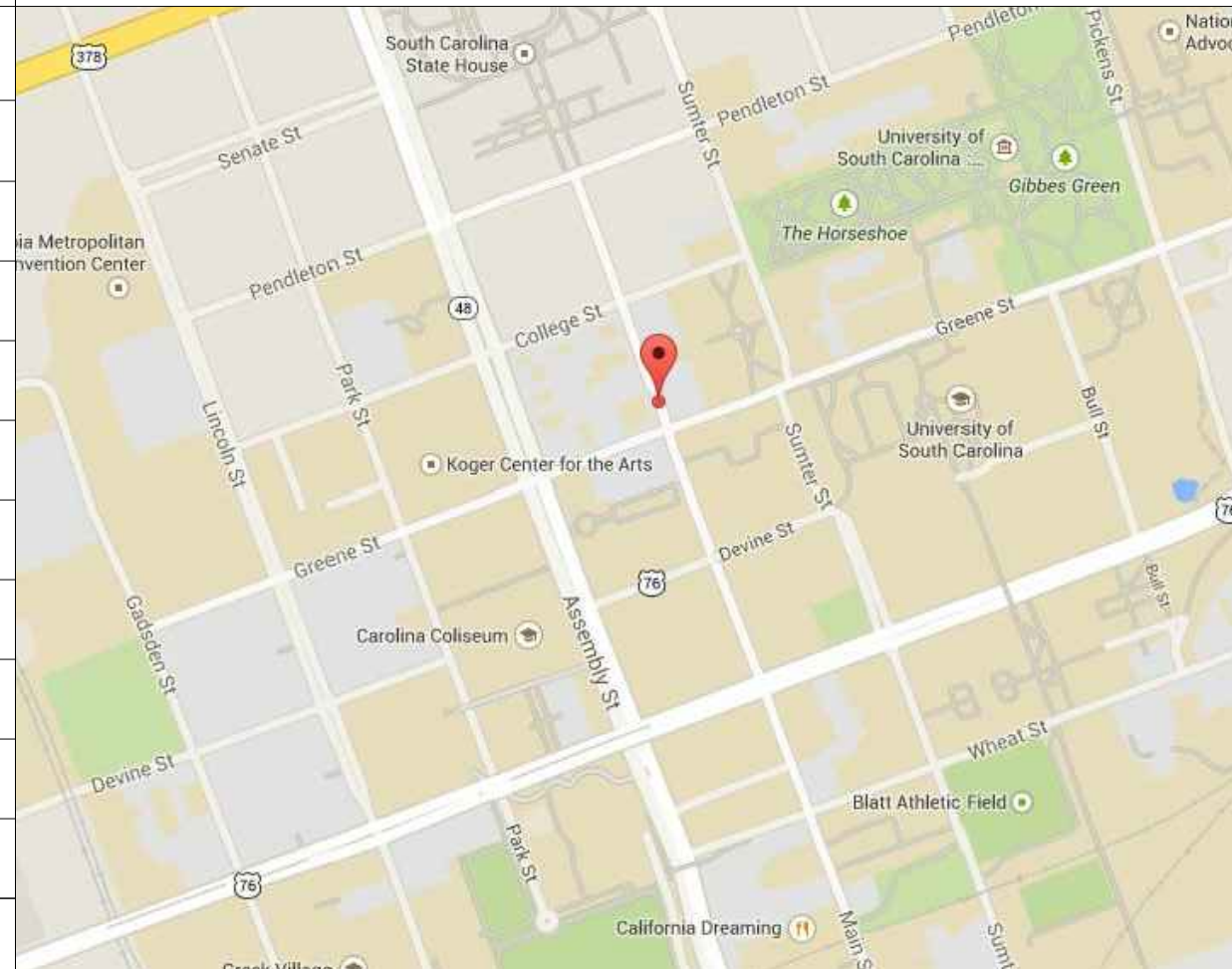
VICINITY MAP	INDEX OF DRAWINGS		LOCATION MAP
	SHEET NO:	SHEET NAME:	
	T-100	COVER SHEET	
	R-100	ROOF PLAN	
	R-200	ROOF DETAILS	
	R-201	ROOF DETAILS	

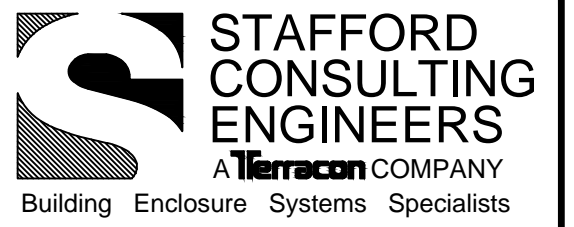

STAFFORD  
CONSULTING  
ENGINEERS  
A Terracon COMPANY  
Building Enclosure Systems Specialists  
2020 STARITA ROAD SUITE-E  
CHARLOTTE, NORTH CAROLINA  
P. 704.594.8940 F. 704.509.1888  
RALEIGH . CHARLOTTE . JACKSONVILLE

PROJECT NAME AND ADDRESS:

UNIVERSITY OF SOUTH CAROLINA  
**WARDLAW COLLEGE AND  
DRAYTON HALL HVAC EQUIPMENT  
AND ROOF REPLACEMENT**  
820 Sumter Street  
Columbia, SC 29208

ISSUE DATE:

MARCH 24, 2015

ISSUE FOR:

- DESIGN DEVELOPMENT SUBMITTAL:  
NOT FOR CONSTRUCTION
- SURVEY REPORT SUBMITTAL:  
NOT FOR CONSTRUCTION
- CONSTRUCTION DOCUMENT SUBMITTAL:  
NOT FOR CONSTRUCTION
- BID DOCUMENT SUBMITTAL:  
NOT FOR CONSTRUCTION
- CONSTRUCTION DOCUMENT SUBMITTAL
- ADDENDUM SUBMITTAL
- RECORD DRAWINGS

PROJECT TEAM:

DESIGNED BY: AWM  
DRAWN BY: EGM II  
APPROVED BY: VTN

PROJECT NUMBER:

FH146901

ADDENDUM:

NO 1:	DATE:	DESCRIPTION:

ENGINEER STATE LICENSE SEAL

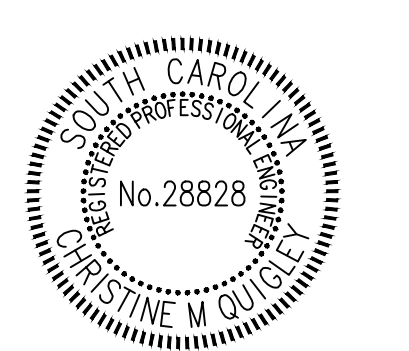

TITLE SHEET:

COVER SHEET

SHEET NUMBER:

**T-100**

PROJECT NAME AND ADDRESS:

UNIVERSITY of SOUTH CAROLINA  
**WARDLAW COLLEGE AND  
 DRAYTON HALL HVAC EQUIPMENT  
 AND ROOF REPLACEMENT**  
 820 Sumter Street  
 Columbia, SC 29208

ISSUE DATE:  
**MARCH 24, 2015**

ISSUE FOR:

- DESIGN DEVELOPMENT SUBMITTAL: NOT FOR CONSTRUCTION
- SURVEY REPORT SUBMITTAL: NOT FOR CONSTRUCTION
- CONSTRUCTION DOCUMENT SUBMITTAL: NOT FOR CONSTRUCTION
- BID DOCUMENT SUBMITTAL: NOT FOR CONSTRUCTION
- CONSTRUCTION DOCUMENT SUBMITTAL
- ADDENDUM SUBMITTAL
- RECORD DRAWINGS

PROJECT TEAM:

DESIGNED BY: **AWM**

DRAWN BY: **EGM II**

APPROVED BY: **VTN**

PROJECT NUMBER: **FH146901**

ADDENDUM:

NO 1:	DATE:	DESCRIPTION:

ENGINEER STATE LICENSE SEAL



TITLE SHEET:  
**ROOF PLAN**

SHEET NUMBER:

**R-100**

**LEGEND**

- RD ⊙ ROOF DRAIN
- OS = OVERFLOW SCUPPER
- ▬▬▬▬▬▬ PARAPET
- RD ⊙ ROOF DRAIN
- ⊗ MECHANICAL UNIT
- - - TAPERED INSULATION
- TAPERED INSULATION SLOPE
- STRUCTURAL DECK SLOPE
- ⊠ ROOF HATCH
- VENT PIPE/PENETRATION
- ⊗ ROOF DETAIL FLAGS
- ⊗ CONSTRUCTION NOTES FLAG
- ▨ NOT IN CONTRACT

**CODE SUMMARY**

INTERNATIONAL BUILDING CODE (2012 EDITION) AND ASCE 7-10

BASIC WIND SPEED = 130 MPH  
 CATEGORY = III  
 EXPOSURE CATEGORY = B  
 INTERNAL PRESSURE COEF. = +/- 0.18

THE NEW ROOF SYSTEM SHALL BE DESIGNED AND CONSTRUCTED TO MEET THE FOLLOWING WIND UPLIFT PRESSURES:

AREA A

- FIELD ZONE = -51.71 PSF
- PERIMETER ZONE = -81.17 PSF
- CORNER ZONE = -110.63 PSF

AREAS B, C

- FIELD ZONE = -32.98 PSF
- PERIMETER ZONE = -55.34 PSF
- CORNER ZONE = -83.29 PSF

**CONSTRUCTION NOTES**

- LEDGE BELOW PARAPET WALL AT EXTERIOR NOT SHOWN FOR CLARITY.
- FIELD TAPER TO PROVIDE DRAINAGE TO ROOF DRAINS.
- ALL ROOF DRAINS ARE TO BE REPLACED AS PART OF THE BASE SCOPE OF WORK.

**KEY PLAN**

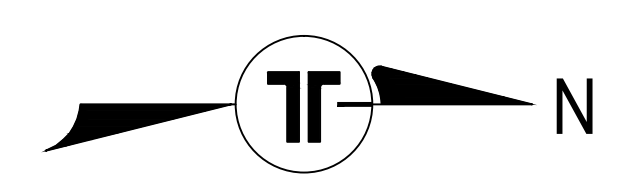
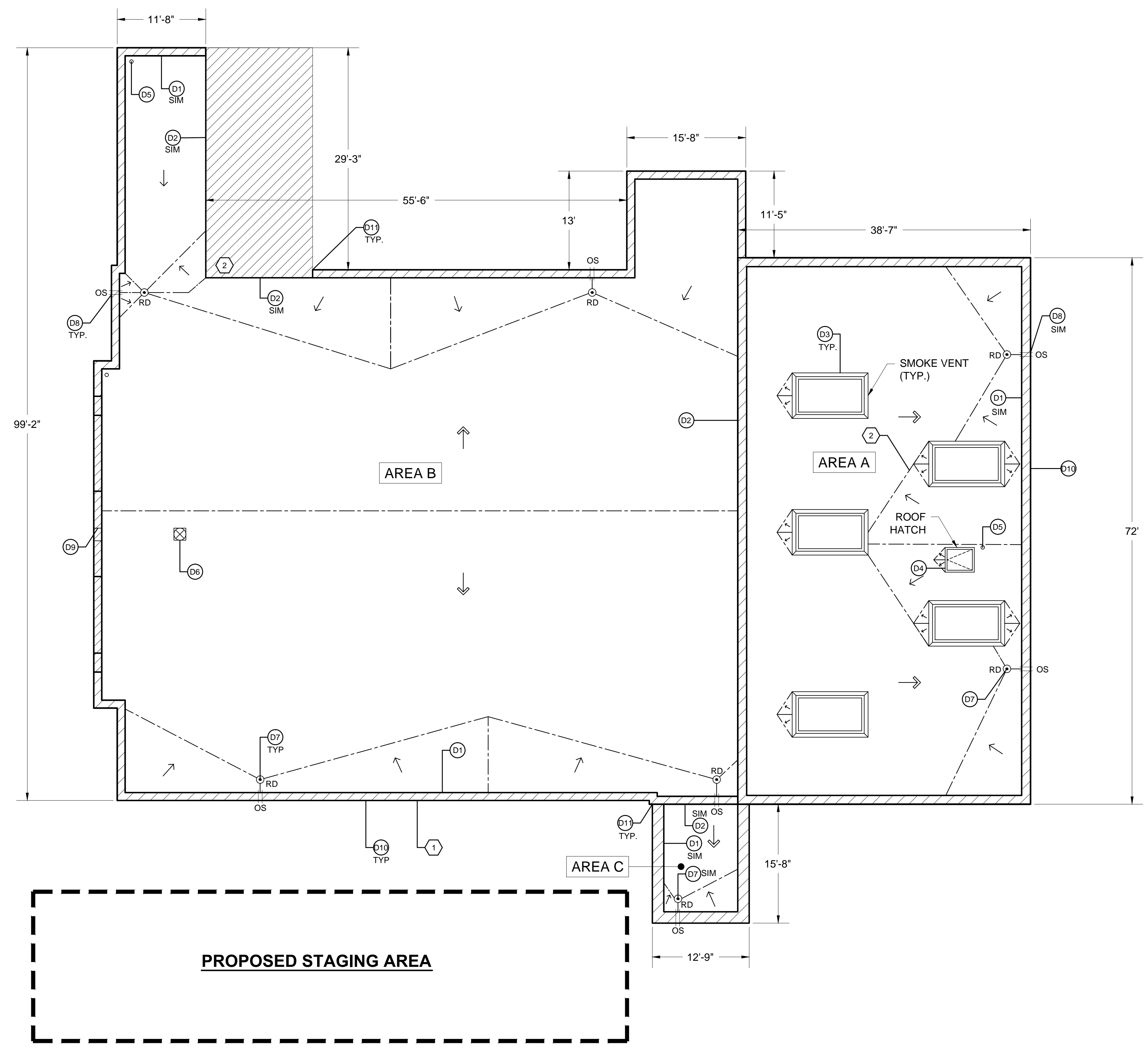
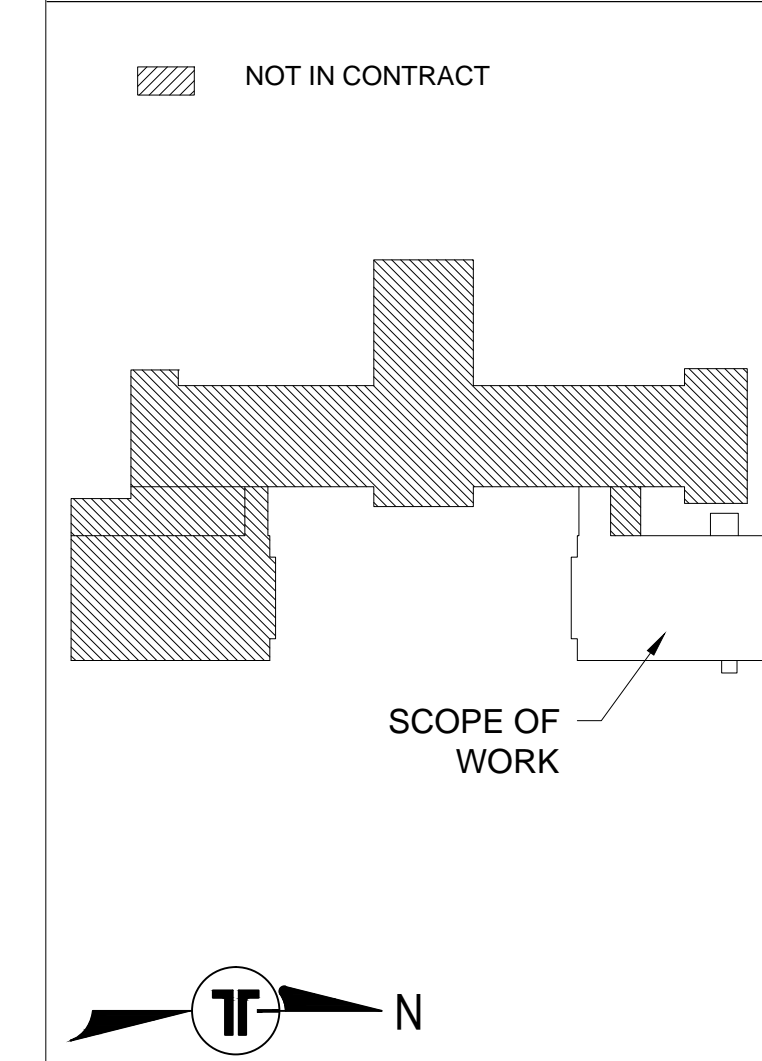

**RP** ROOF PLAN: DRAYTON HALL  
 SCALE: 1/8"=1'-0"  
 0 1 2 3 4 6 8 12



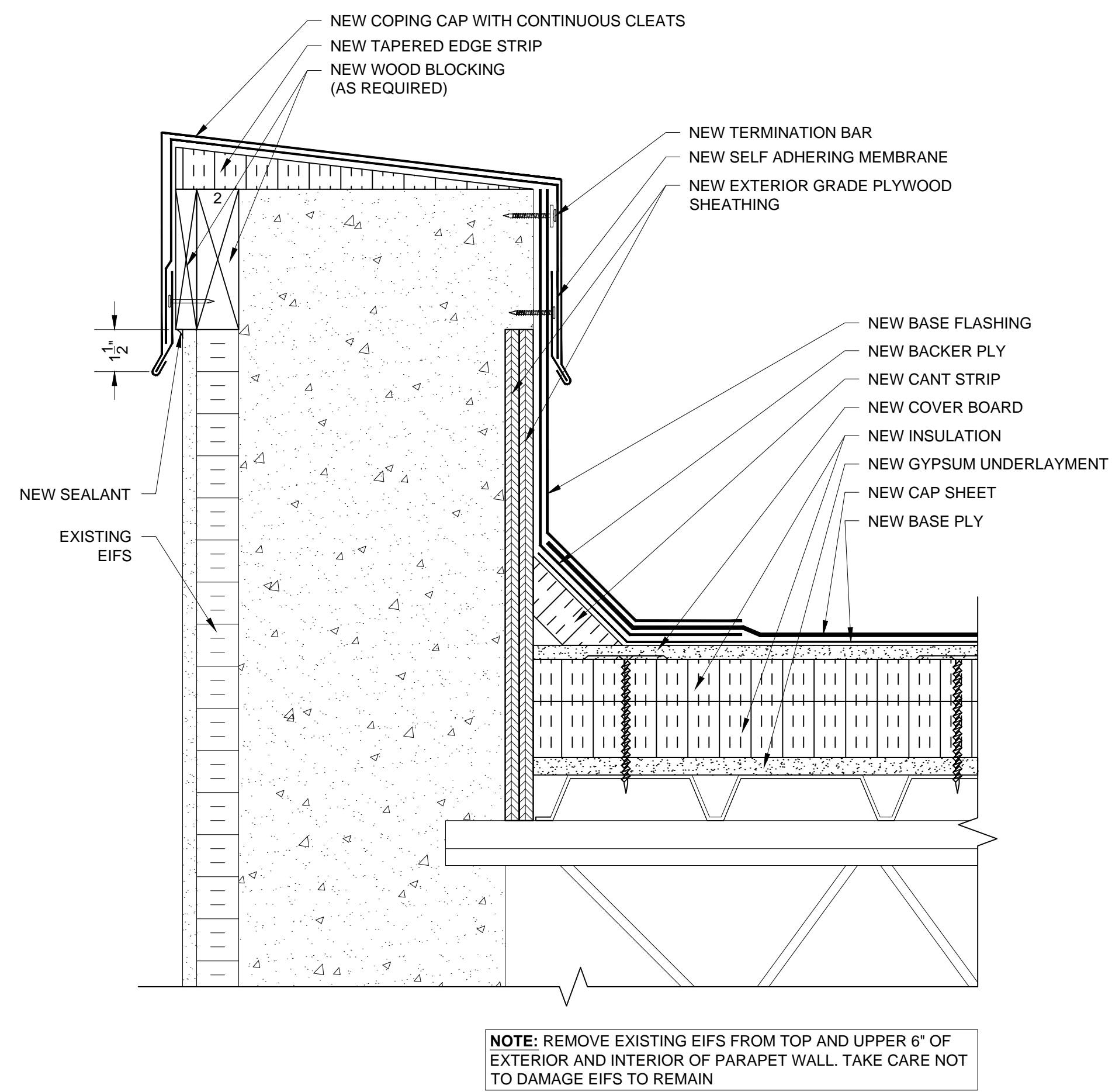

NOTE: REMOVE EXISTING EIFS FROM TOP AND UPPER 6" OF EXTERIOR AND INTERIOR OF PARAPET WALL. TAKE CARE NOT TO DAMAGE EIFS TO REMAIN

**D1** PARAPET WALL DETAIL  
SCALE: 3" = 1"  
0 1' 2' 3' 4' 6'

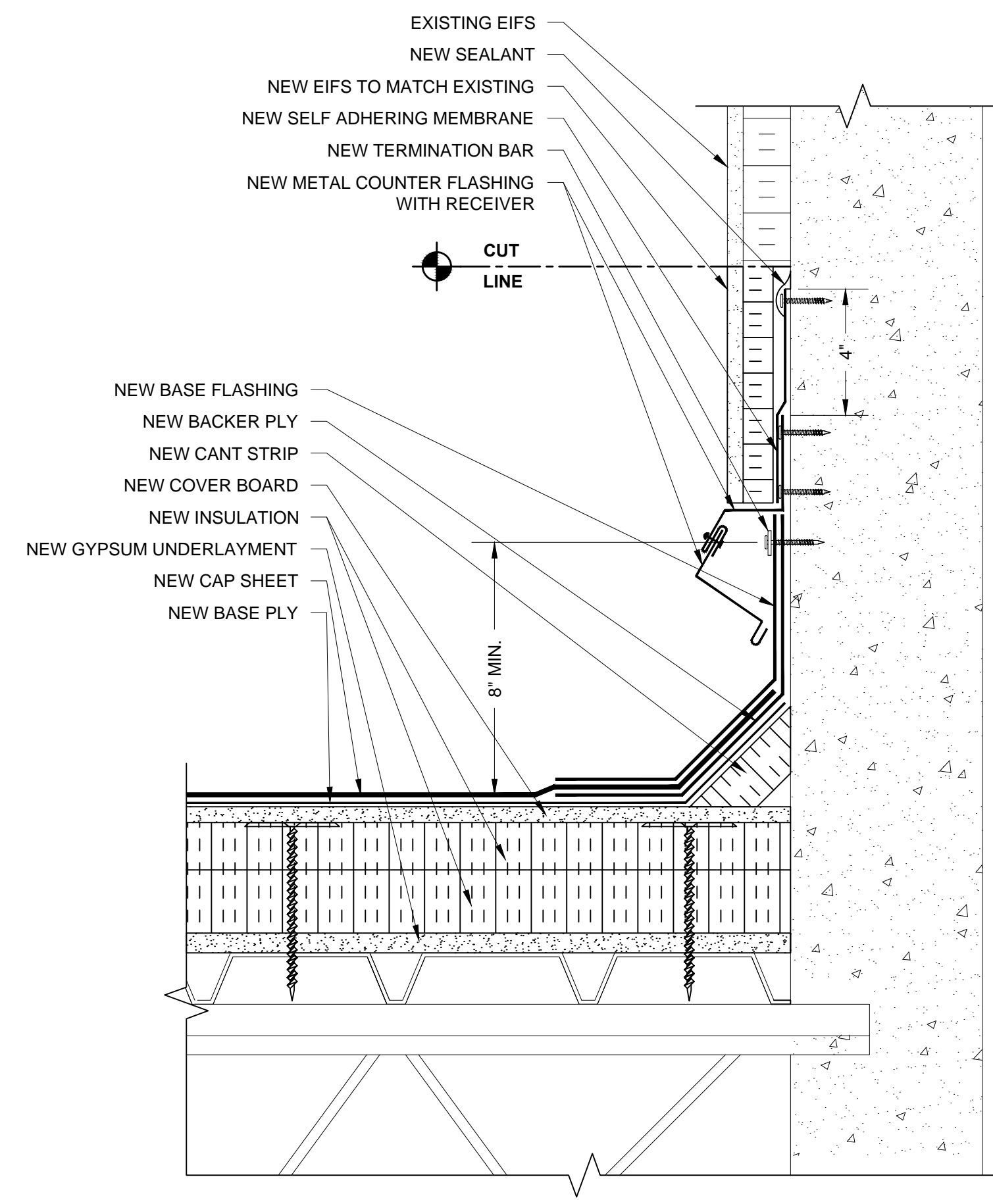

**D2** BASE FLASHING AT WALL DETAIL  
SCALE: 3" = 1"  
0 1' 2' 3' 4' 6'

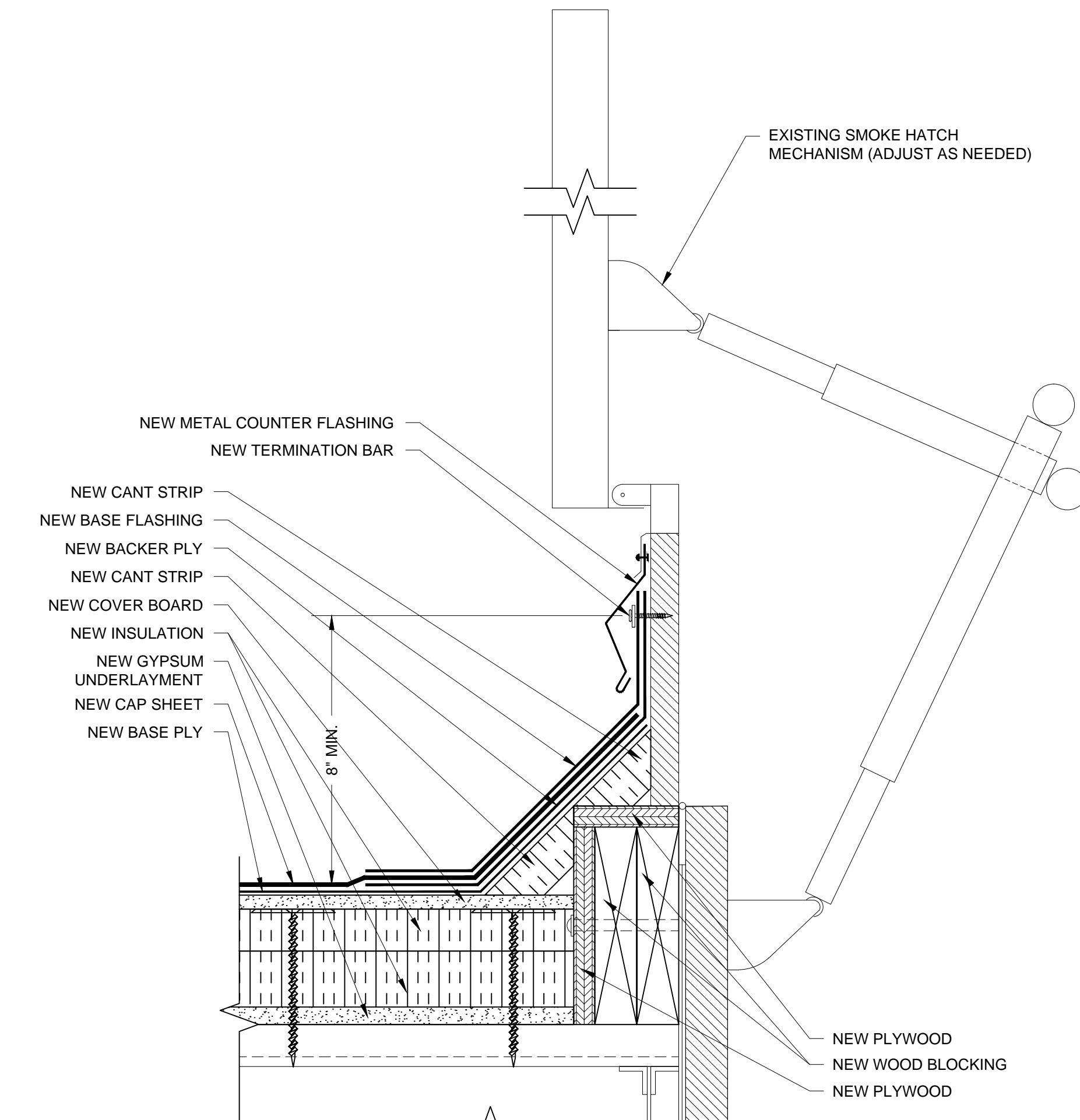

NOTE: COORDINATE LIFTING OF SMOKE VENT TO PLACE NEW WOOD BLOCKING WITH THE UNIVERSITY.

**D3** SMOKE VENT CURB DETAIL  
SCALE: 3" = 1"  
0 1' 2' 3' 4' 6'

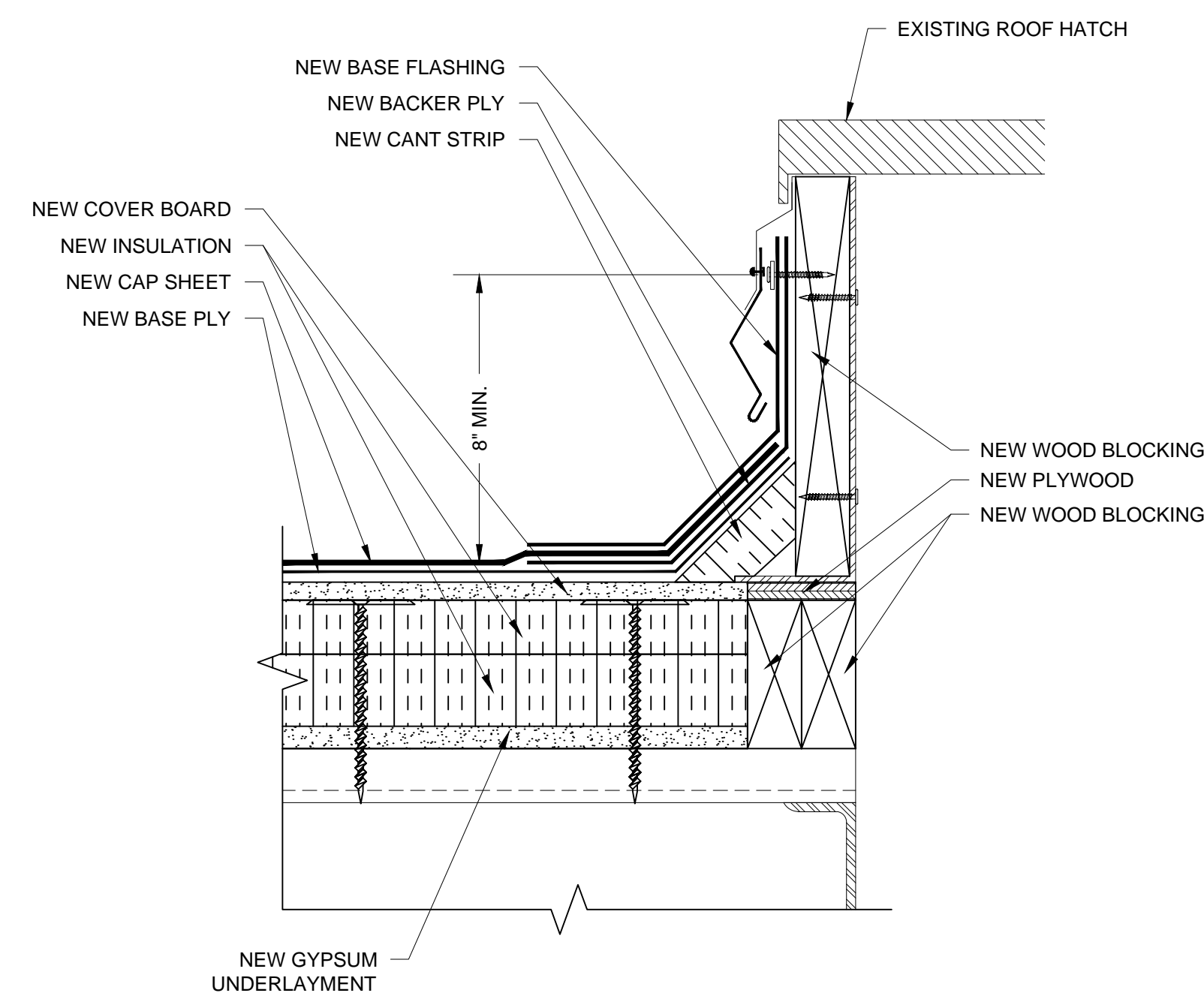

**D4** ROOF HATCH DETAIL  
SCALE: 3" = 1"  
0 1' 2' 3' 4' 6'

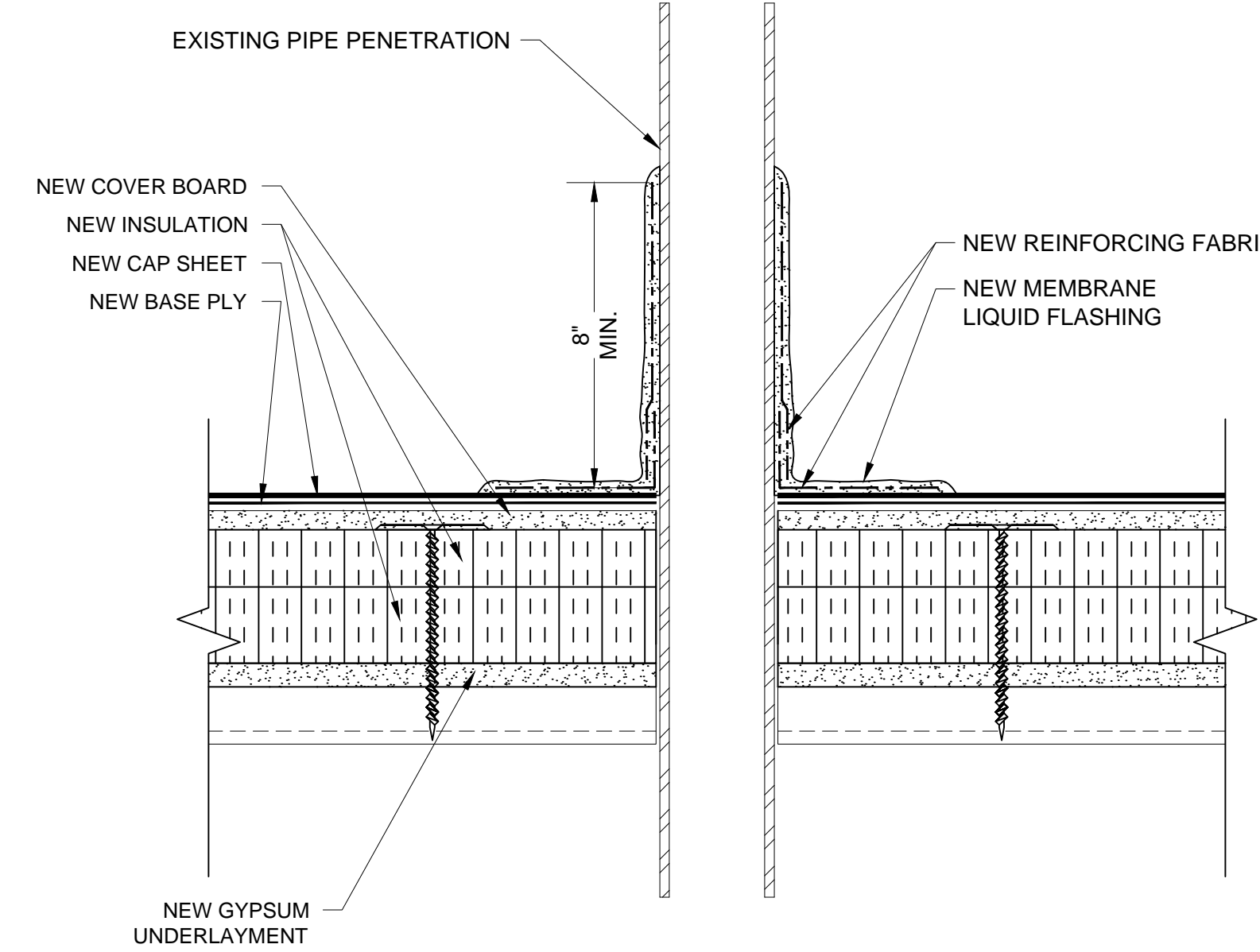

**D5** SOIL VENT ROOF PENETRATION DETAIL  
SCALE: 3" = 1"  
0 1' 2' 3' 4' 6'

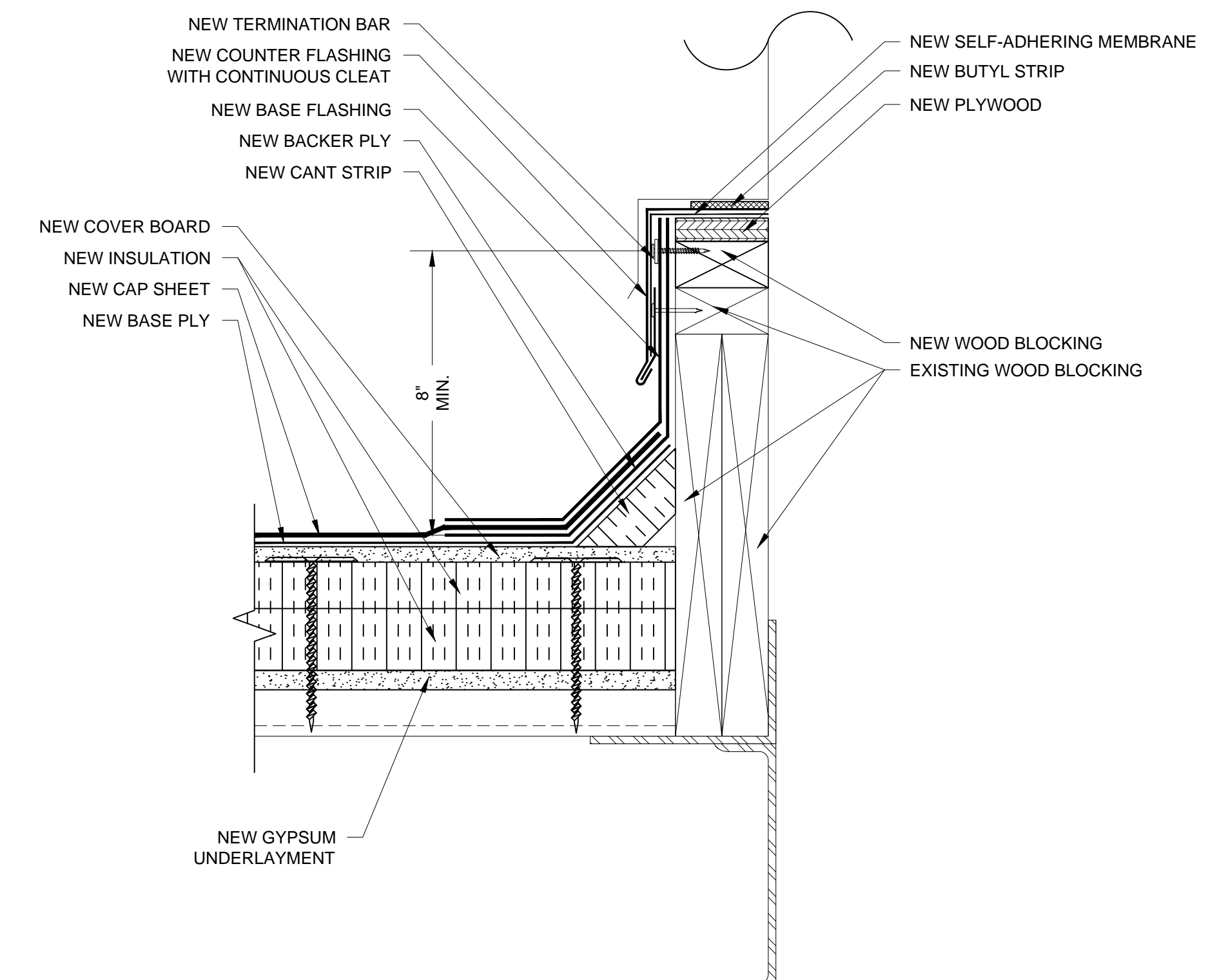

**D6** EQUIPMENT CURB DETAIL  
SCALE: 3" = 1"  
0 1' 2' 3' 4' 6'

PROJECT NAME AND ADDRESS:

UNIVERSITY OF SOUTH CAROLINA  
**WARDLAW COLLEGE AND DRAYTON HALL HVAC EQUIPMENT AND ROOF REPLACEMENT**  
820 Sumter Street  
Columbia, SC 29208

ISSUE DATE:  
**MARCH 24, 2015**

- ISSUE FOR:
- DESIGN DEVELOPMENT SUBMITTAL: NOT FOR CONSTRUCTION
  - SURVEY REPORT SUBMITTAL: NOT FOR CONSTRUCTION
  - CONSTRUCTION DOCUMENT SUBMITTAL: NOT FOR CONSTRUCTION
  - BID DOCUMENT SUBMITTAL: NOT FOR CONSTRUCTION
  - CONSTRUCTION DOCUMENT SUBMITTAL
  - ADDENDUM SUBMITTAL
  - RECORD DRAWINGS

PROJECT TEAM:  
DESIGNED BY: **AWM**  
DRAWN BY: **EGM II**  
APPROVED BY: **VTN**

PROJECT NUMBER:  
**FH146901**

ADDENDUM:  
NO 1: DATE: DESCRIPTION:

NO 1:	DATE:	DESCRIPTION:

ENGINEER STATE LICENSE SEAL



TITLE SHEET:  
**ROOF DETAILS**

SHEET NUMBER:

**R-200**

PROJECT NAME AND ADDRESS:

UNIVERSITY of SOUTH CAROLINA  
**WARDLAW COLLEGE AND  
 DRAYTON HALL HVAC EQUIPMENT  
 AND ROOF REPLACEMENT**  
 820 Sumter Street  
 Columbia, SC 29208

ISSUE DATE:

**MARCH 24, 2015**

ISSUE FOR:

- DESIGN DEVELOPMENT SUBMITTAL: NOT FOR CONSTRUCTION
- SURVEY REPORT SUBMITTAL: NOT FOR CONSTRUCTION
- CONSTRUCTION DOCUMENT SUBMITTAL: NOT FOR CONSTRUCTION
- BID DOCUMENT SUBMITTAL: NOT FOR CONSTRUCTION
- CONSTRUCTION DOCUMENT SUBMITTAL
- ADDENDUM SUBMITTAL
- RECORD DRAWINGS

PROJECT TEAM:

DESIGNED BY: **AWM**  
 DRAWN BY: **EGM II**  
 APPROVED BY: **VTN**

PROJECT NUMBER:

**FH146901**

ADDENDUM:

NO. 1: DATE: DESCRIPTION:

NO.	DATE	DESCRIPTION

ENGINEER STATE LICENSE SEAL

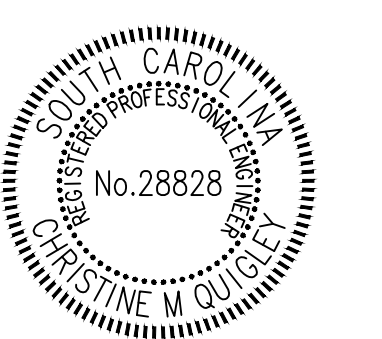

TITLE SHEET:

**ROOF DETAILS**

SHEET NUMBER:

**R-201**

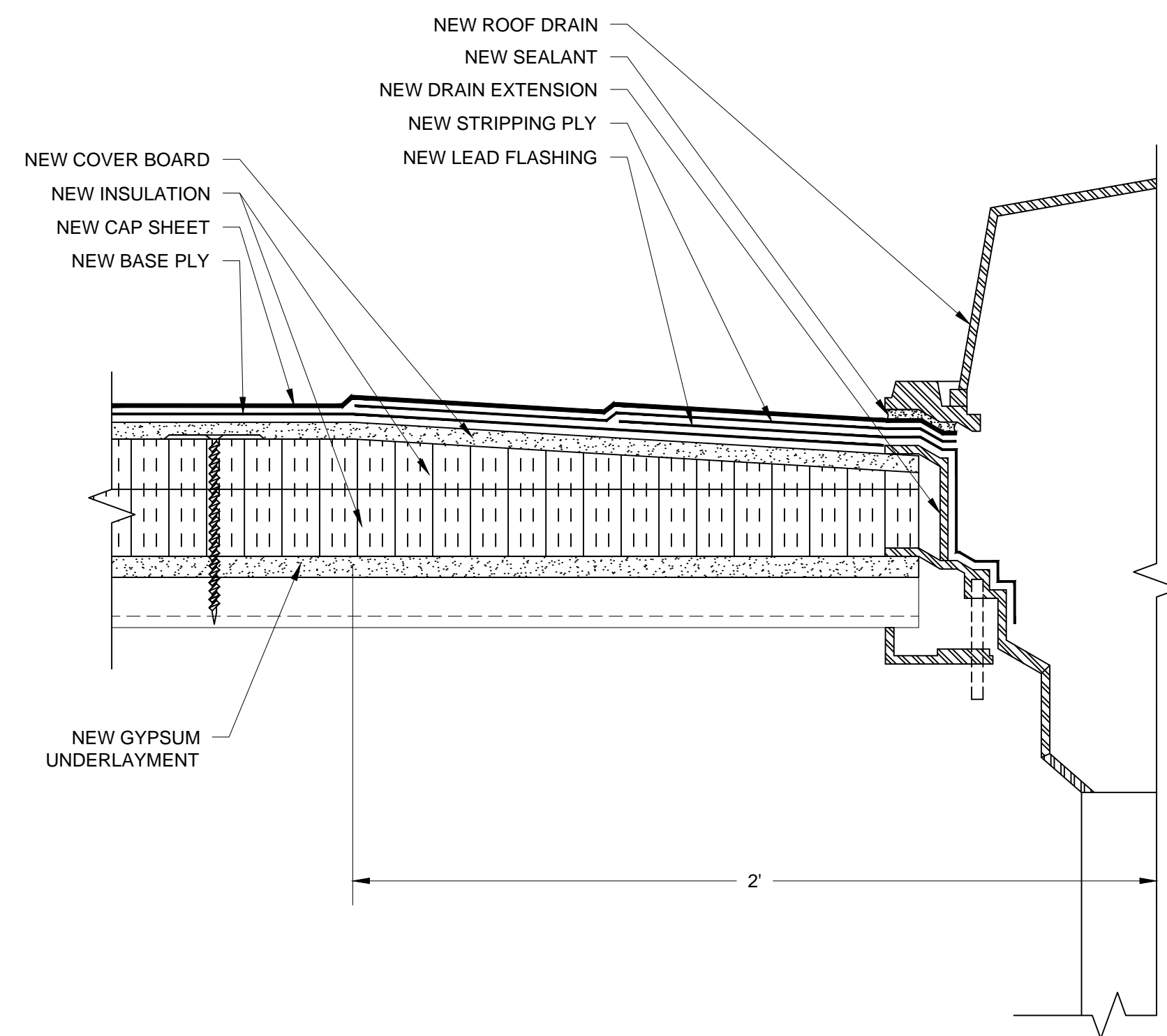

**D7** ROOF DRAIN DETAIL  
 SCALE: 3" = 1"  
 0 1' 2' 3' 4' 6"

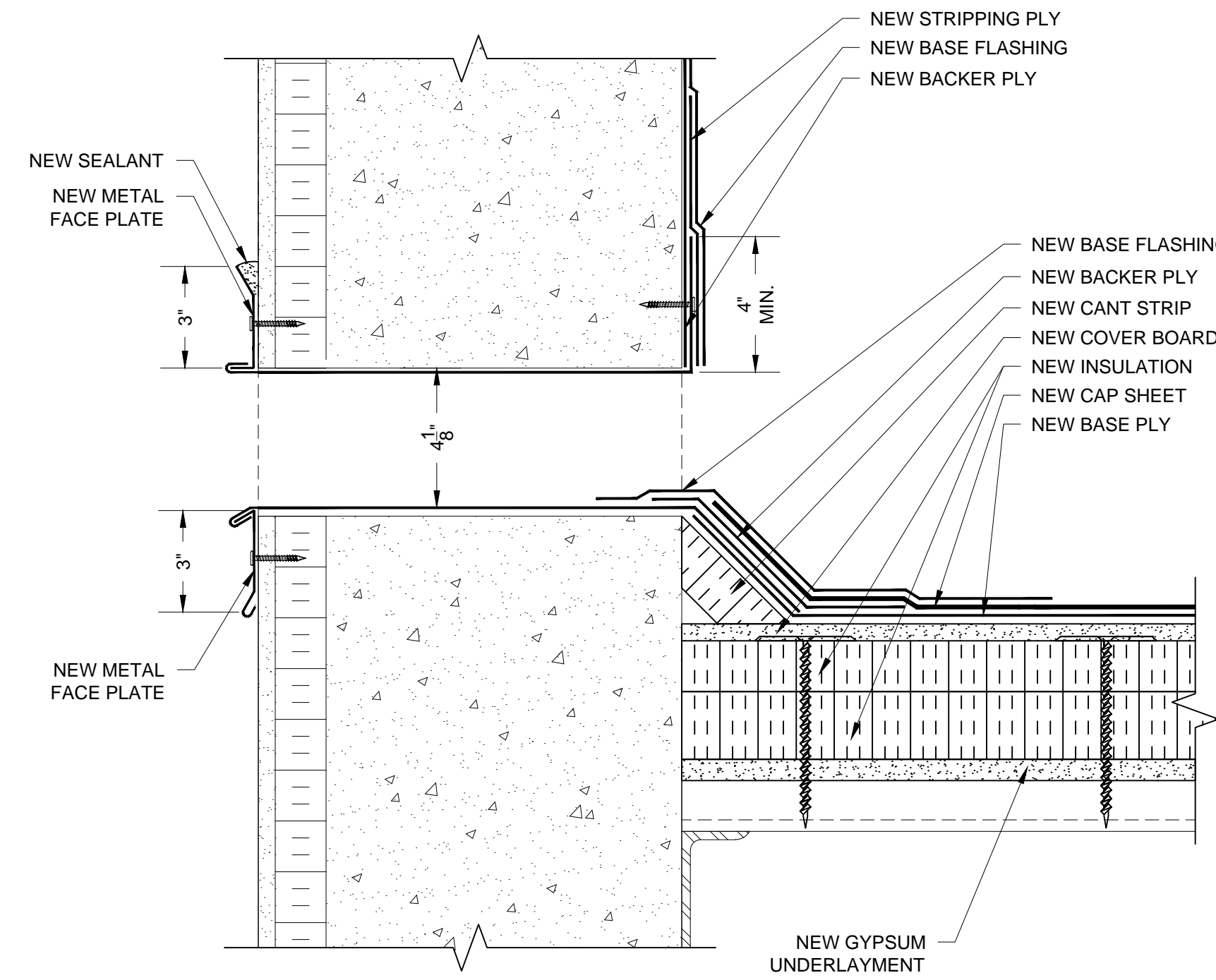

**D8** OVERFLOW DRAIN SCUPPER DETAIL  
 SCALE: 3" = 1"  
 0 1' 2' 3' 4' 6"

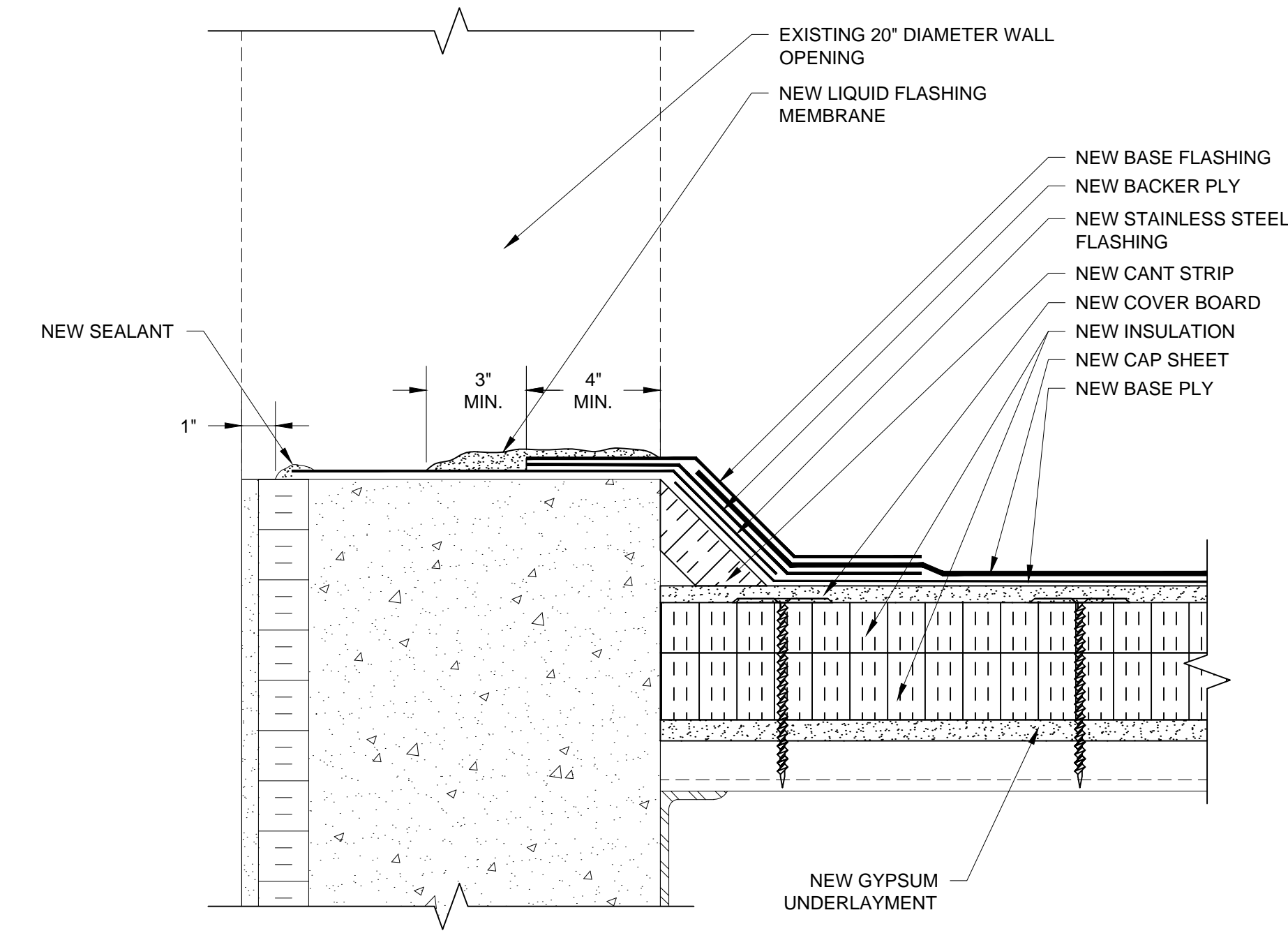

**NOTE:** APPLY LIQUID FLASHING MEMBRANE AT INTERIOR OF OPENING THE ENTIRE PERIMETER OF THE OPENING.

**D9** WALL OPENING FLASHING DETAIL  
 SCALE: 3" = 1"  
 0 1' 2' 3' 4' 6"

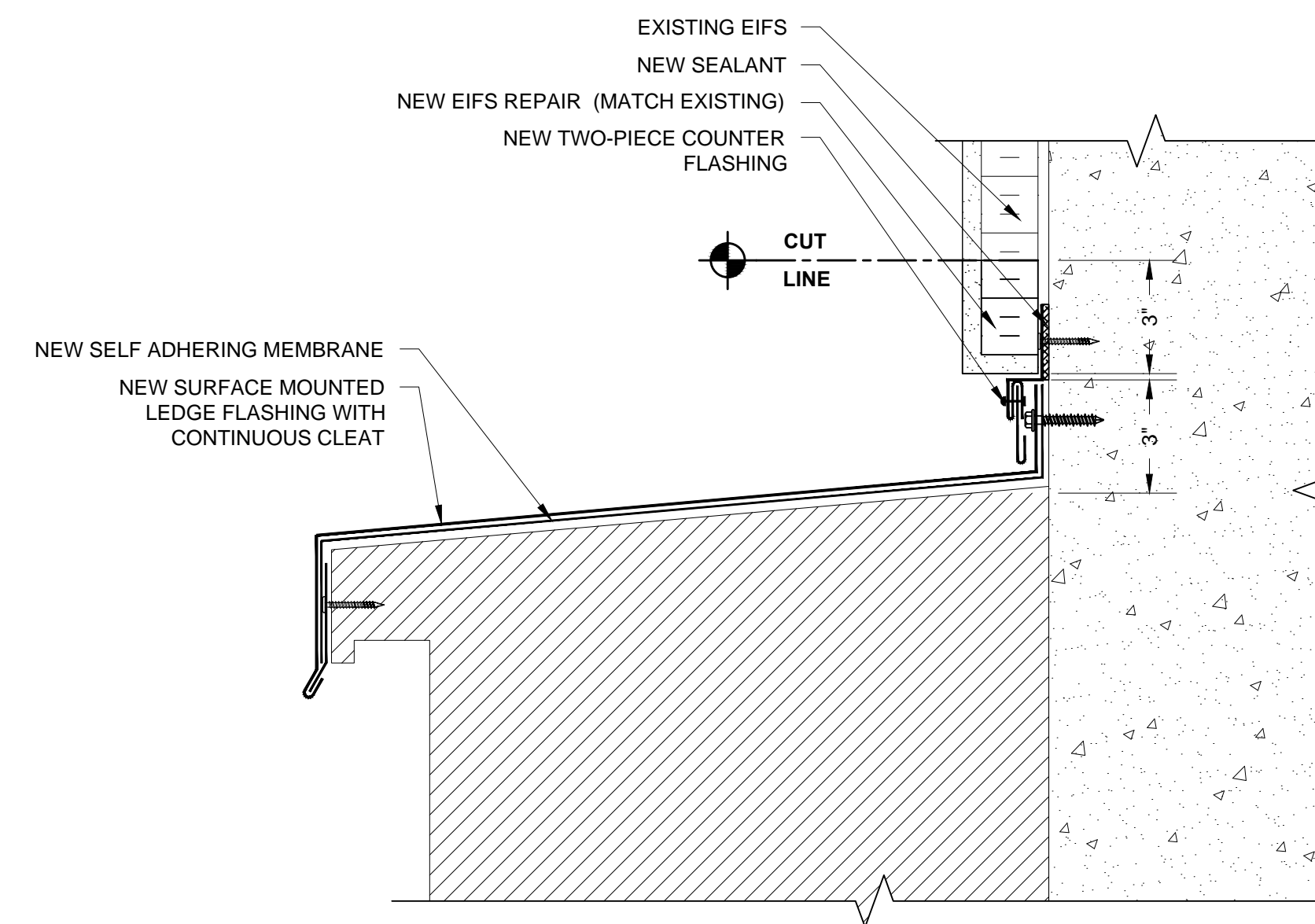

**D10** LEDGE FLASHING DETAIL  
 SCALE: 3" = 1"  
 0 1' 2' 3' 4' 6"

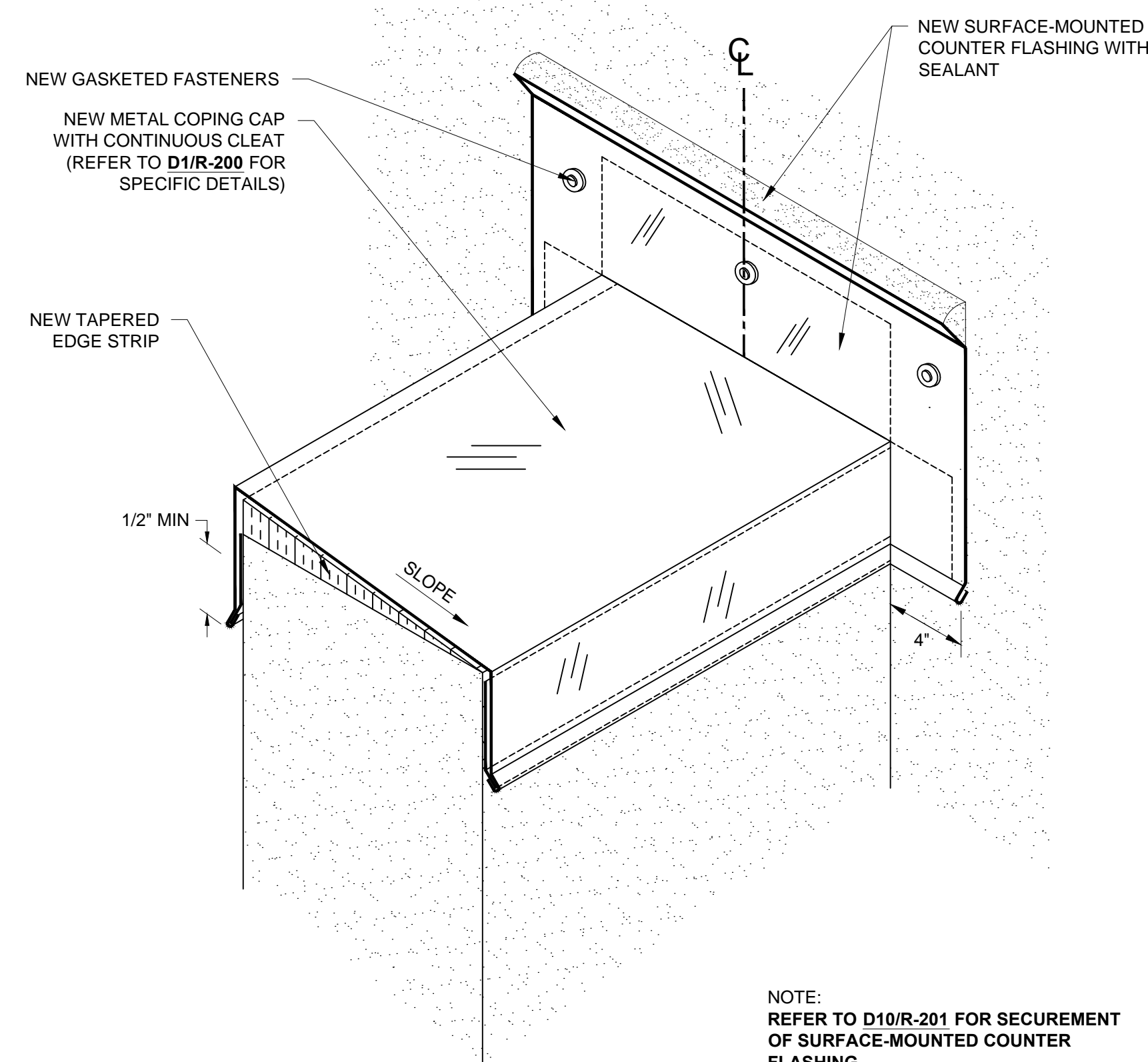

**NOTE:** REFER TO D10/R-201 FOR SECUREMENT OF SURFACE-MOUNTED COUNTER FLASHING

**D11** COPING TERMINATION AT WALL DETAIL  
 SCALE: NTS