



INDEX OF DRAWINGS

CIVIL
C1.1 EXISTING CONDITIONS AND DEMOLITION PLAN
C2.1 STAKING PLAN
C3.1 GRADING AND DRAINAGE PLAN
CA.1 SEDIMENT AND EROSION CONTROL PLAN
CS.1 DETAILS
ELECTRICAL
E0.1 ELECTRICAL DETAILS & SCHEDULES
E0.2 ELECTRICAL SITE PLAN
LANDSCAPE
L1.0 LANDSCAPE PLAN

GREEK VILLAGE STUDENT PARKING DEVELOPMENT

CITY OF COLUMBIA, SC

March, 2020
Project Number: H27-Z414

University of South Carolina
Columbia, South Carolina

GREEK VILLAGE STUDENT
PARKING DEVELOPMENT
PROJECT #: H27-Z414

COLUMBIA
SOUTH CAROLINA

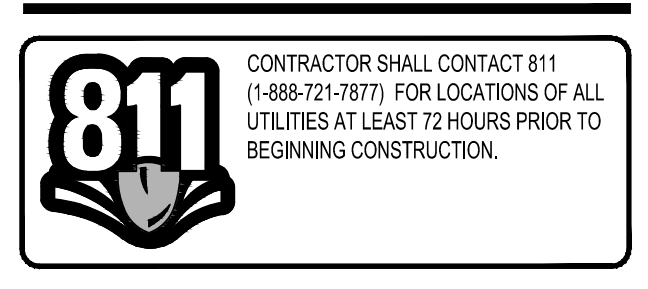
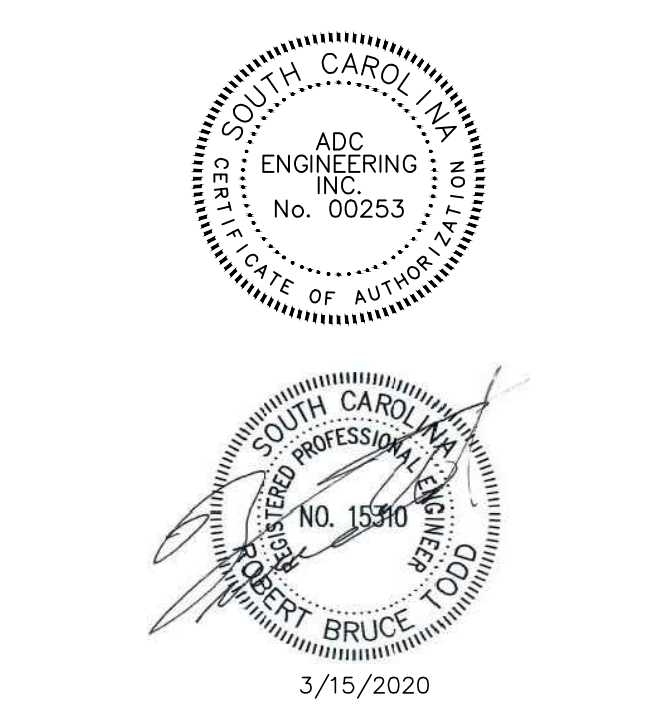

DATE:	03/13/2020
ADC PROJECT #:	20002.00
DESIGNED:	RBT
CHECKED:	RBT
DRAWN:	RPL
REVISION:	100% CD Review

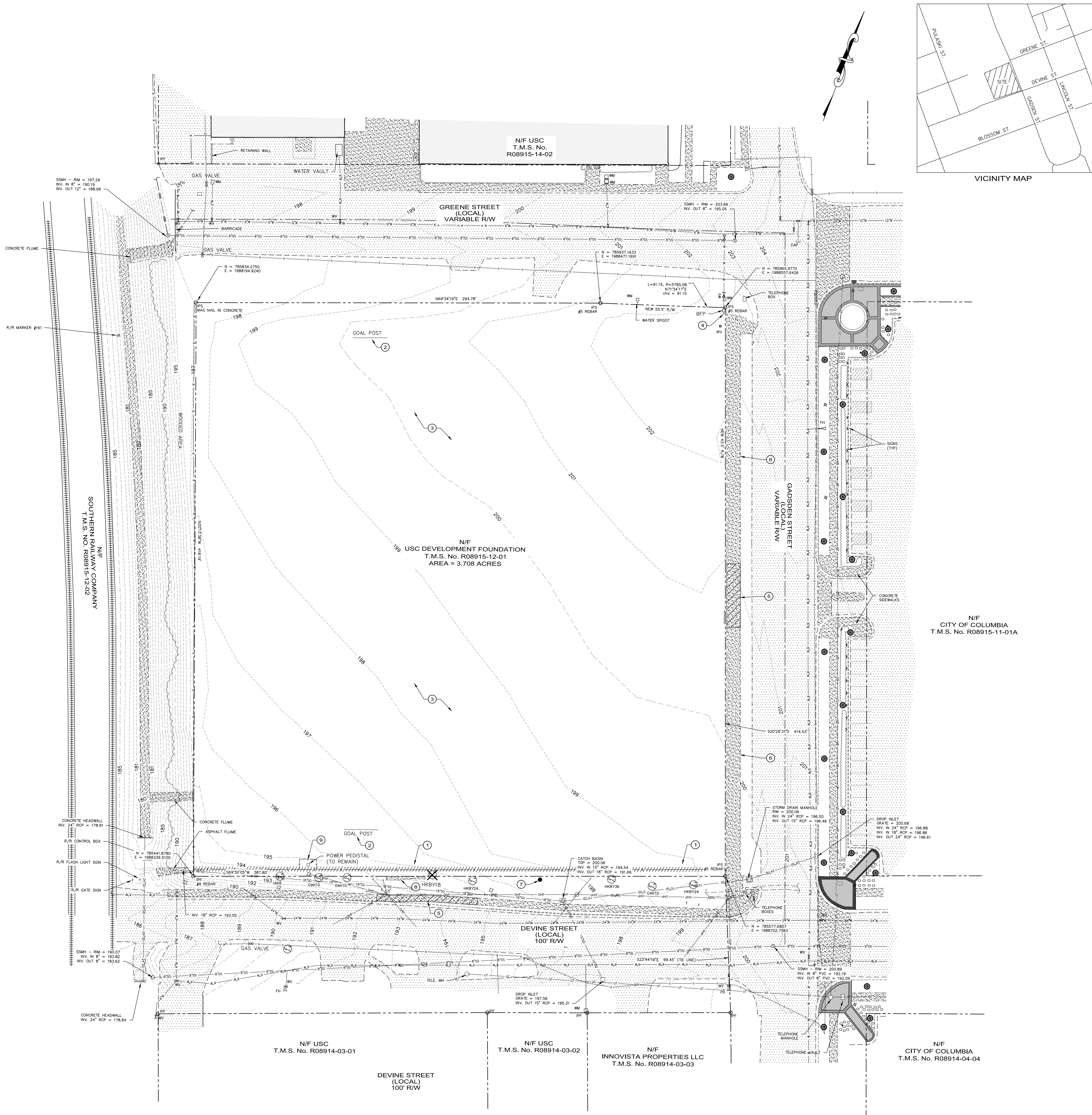

LEGEND		
DEMOLITION	EXISTING	DESCRIPTION
N/A		BENCHMARK/CONTROL POINT
N/A		PROPERTY LINE
N/A		BUILDING
N/A		LIGHT POLE
N/A		TREE
N/A		BITUMINOUS SURFACE
N/A		CONCRETE SURFACE
N/A		CONTOUR
N/A		SPOT ELEVATION
N/A		CHAIN LINK FENCE
N/A		WATER VALVE
N/A		WATER METER
N/A		UNDERGROUND ELECTRIC LINE
N/A		SANITARY SEWER LINE w/MANHOLE
N/A		SANITARY SEWER CLEANOUT
N/A		STORM DRAIN LINE w/STRUCTURE
N/A		KEY NOTE REFERENCE

OWNER/ZONING/SITE INFORMATION	
ITEM	DESCRIPTION
TMS #	R08915-12-01
OWNER	UNIVERSITY OF SOUTH CAROLINA
OWNER ADDRESS	743 GREENE STREET
OWNER PHONE	803-777-7592
OWNER EMAIL	efjones@mc.sc.edu
ZONING	M-2
SITE ADDRESS	737 GADSDEN STREET
TOTAL ACREAGE	3.71
DISTURBED ACREAGE	3.18

- GENERAL NOTES**
- TOPOGRAPHIC SURVEY WAS COMPLETED BY AMERICAN ENGINEERING CONSULTANTS INC. ON 1/14/2020. NO BOUNDARY OR TOPOGRAPHIC SURVEY WAS PERFORMED BY ADC ENGINEERING. THIS SURVEY IS A COMBINATION OF THE SURVEY COMPLETED BY AMERICAN ENGINEERING ON 1/14/20, THE SURVEY COMPLETED BY B.F. BARBER DATED 4/21/09, AND DESIGN PLANS PREPARED BY R.B. TODD CONSULTING ENGINEERS TITLED "GREENE STREET INTRAMURAL FIELDS" DATED MAY 11, 2009.
 - ACCORDING TO FEMA FLOOD INSURANCE RATE MAP 450790036L, DATED 12/23/2017, THIS PROPERTY IS LOCATED IN FLOOD ZONE "X".
 - THE CONTRACTOR SHALL NOTIFY THE ENGINEER PRIOR TO CONSTRUCTION OF ANY DISCREPANCIES BETWEEN THESE PLANS AND ACTUAL FIELD CONDITIONS.
 - THE CONTRACTOR SHALL NOTIFY PUPS AT 1-888-721-7877 AT LEAST 72 HOURS PRIOR TO CONSTRUCTION TO HAVE ALL UNDERGROUND UTILITIES LOCATED.
 - THE CONTRACTOR SHALL NOTE THAT THE AREA OF IMPROVEMENT CONTAINS BURIED CONSTRUCTION DEBRIS (BRICKS, CONCRETE, ASPHALT, METAL, ETC.), FROM PREVIOUS DEMOLISHED IMPROVEMENTS ON THE SITE.
 - ALL WORK BY PRIME CONTRACTOR AND SUB CONTRACTORS SHALL BE PERFORMED IN ACCORDANCE WITH OSHA GUIDELINES. THE PRIME CONTRACTOR SHALL BE RESPONSIBLE FOR MONITORING AND ENFORCING ALL OSHA SAFETY REGULATIONS.

- KEY NOTES**
- REMOVE EXISTING FENCE PARALLEL WITH DEVINE STREET.
 - REMOVE GOAL POSTS AND DELIVER TO OWNER.
 - THE EXISTING SITE WITHIN THE PROPERTY BOUNDARY IS TO BE IMPROVED TO PROVIDE TEMPORARY PARKING. SEE SHEET C2.1. THE CONTRACTOR SHALL REMOVE THE EXISTING VEGETATION AND TOPSOIL TO A MINIMUM DEPTH OF 4". THE CONTRACTOR SHALL ALSO REMOVE EXISTING IRRIGATION SPRAY HEADS AND PIPING THAT INTERFERES WITH GRADING AND PROPOSED IMPROVEMENTS.
 - CONTRACTOR TO LOCATE EXISTING IRRIGATION LINE JUST PAST BACKFLOW PREVENTOR AND CUT LINE. CONNECT NEW IRRIGATION LINE TO EXISTING LINE PAST BACKFLOW PREVENTOR AND EXTEND IRRIGATION SYSTEM TO NEW PLANTINGS. COORDINATE WITH LANDSCAPE PLAN.
 - REMOVE EXISTING SIDEWALK TO PROMOTE CONSTRUCTION OF NEW DRIVEWAY. CUT AT NEAREST SCORE JOINT PAST DRIVEWAY IMPROVEMENT. SEE SHEET C2.1.
 - EXISTING SIDEWALK AND OTHER IMPROVEMENTS INDICATED BETWEEN GADSDEN STREET AND THE PROPERTY LINE ARE PROPOSED AND ARE ANTICIPATED TO BE COMPLETED ONCE CONSTRUCTION STARTS ON THE PARKING LOT PROJECT. CONTRACTOR FOR PARKING LOT TO COORDINATE WITH CONTRACTOR FOR GADSDEN STREET IMPROVEMENTS IF CONSTRUCTION IS CONCURRENT.
 - REMOVE EXISTING METAL POLE.
 - REMOVE EXISTING CONCRETE.
 - REMOVE FENCE ENCLOSURE AROUND POWER PEDESTAL.

- DEMOLITION NOTES**
- THE CONTRACTOR SHALL FIELD VERIFY ALL ITEMS TO BE DEMOLISHED AND REMOVED FROM THE SITE. THE VERIFICATION PROCESS SHALL INCLUDE VISITING AND WALKING THE SITE. ALL ITEMS REQUIRING DEMOLITION/REMOVAL, WHETHER SHOWN ON THIS PLAN OR NOT, SHALL BE THE RESPONSIBILITY OF THE CONTRACTOR.
 - PRIOR TO COMMENCEMENT OF TREE REMOVAL THE CONTRACTOR SHALL WALK THE SITE WITH THE OWNER AND/OR OWNER'S REPRESENTATIVE TO IDENTIFY TREES AND/OR VEGETATION TO REMAIN. PROTECTION OF IDENTIFIED TREES AND/OR VEGETATION SHALL BE THE RESPONSIBILITY OF THE CONTRACTOR.
 - THERE SHALL BE NO BURNING ON SITE.
 - EXISTING IMPROVEMENTS SO NOTED, ARE TO BE REMOVED FROM THE SITE BY THE CONTRACTOR AND DISPOSED OF ACCORDING TO APPLICABLE REGULATIONS.
 - THE CONTRACTOR IS RESPONSIBLE FOR COORDINATING THE REMOVAL AND/OR RELOCATION OF ALL UTILITIES (ABOVE AND BELOW GROUND LEVEL) AS NECESSARY TO ACCOMMODATE THE IMPROVEMENTS SHOWN ON THESE PLANS AND AS REQUIRED TO FACILITATE CONSTRUCTION.
 - ALL EXISTING CONCRETE AND/OR ASPHALT PAVEMENT THAT IS INDICATED ON THESE PLANS TO BE REMOVED FROM THE PROJECT SITE SHALL BE DISPOSED OF OFF SITE BY THE CONTRACTOR ACCORDING TO APPLICABLE CODES.
 - THE CONTRACTOR SHALL CONSULT THE OWNER REGARDING SALVAGE. ANY ITEMS NOT RETAINED BY THE OWNER SHALL BE THE CONTRACTOR'S RESPONSIBILITY TO DEMOLISH AND/OR LEGALLY DISPOSE OF.
 - EROSION AND SEDIMENT CONTROL DEVICES MUST BE IN PLACE PRIOR TO DEMOLITION.
 - IF ANY HAZARDOUS MATERIAL IS ENCOUNTERED DURING DEMOLITION, THE CONTRACTOR SHALL COORDINATE WITH THE OWNER AND APPROPRIATE AGENCIES FOR PROPER REMOVAL AND DISPOSAL.
 - DEMOLITION SHALL MEET ALL APPLICABLE STATE, LOCAL, AND FEDERAL REGULATIONS. THE CONTRACTOR IS RESPONSIBLE FOR OBTAINING APPLICABLE DEMO AND DISPOSAL PERMITS.

- LAND DISTURBANCE NOTES**
- THE CONTRACTOR SHALL NOT COMMENCE CONSTRUCTION UNTIL THE PRE-CONSTRUCTION MEETING IS HELD WITH THE LOCAL INSPECTOR, ENGINEER, AND SUB-CONTRACTORS WHO WILL BE ASSOCIATED WITH LAND-DISTURBING ACTIVITIES.
 - THE CONTRACTOR SHALL NOT COMMENCE CONSTRUCTION UNTIL ALL APPLICABLE CO-PERMITTEE AND NON-CO-PERMITTEE CERTIFICATIONS HAVE BEEN SIGNED IN THE SWPPP MANUAL TO BE PROVIDED BY THE ENGINEER.
 - THE CONTRACTOR SHALL NOTIFY THE DHEC INSPECTOR AT LEAST TEN (10) DAYS PRIOR TO COMMENCING LAND-DISTURBING ACTIVITIES. REFER TO THE APPROVED NOI PERMIT.

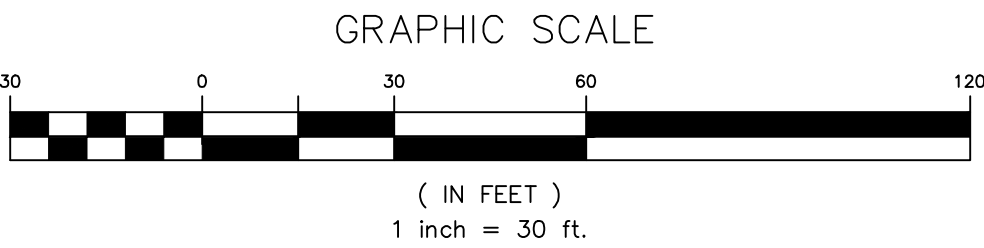

CONSTRUCTION DOCUMENTS

University of South Carolina
Columbia, South Carolina

GREEK VILLAGE STUDENT
PARKING DEVELOPMENT
PROJECT # H27-2414

COLUMBIA
SOUTH CAROLINA

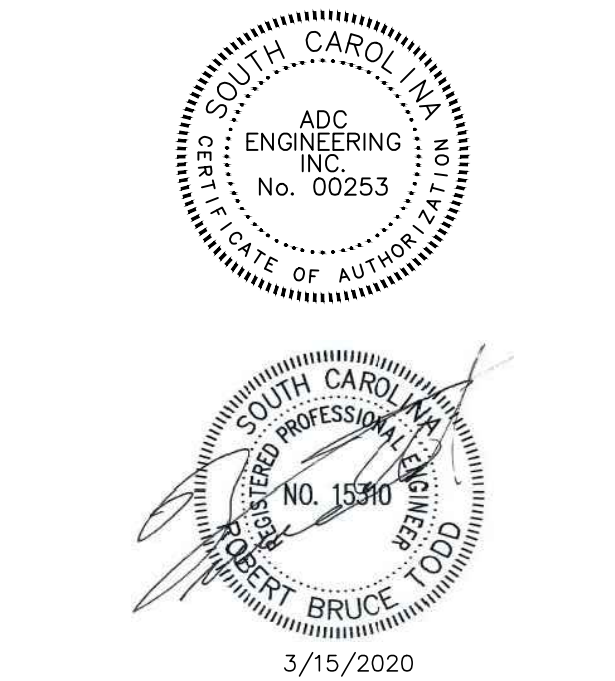

ADC ENGINEERING

7436 BROAD RIVER ROAD, SUITE 212
IRMO, SC 29063
803-781-3141
ADCENGINEERING.COM

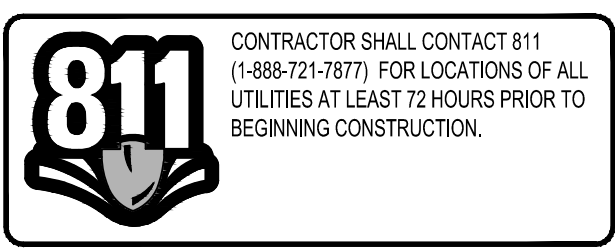

DATE:	03/13/2020
ADC PROJECT #:	20002.00
DESIGNED:	RBT
CHECKED:	RBT
DRAWN:	RPL
REVISION:	100% CD Review

EXISTING
CONDITIONS PLAN

C1.1

N/F
SOUTHERN RAILWAY COMPANY
T.M.S. NO. R08915-12-02

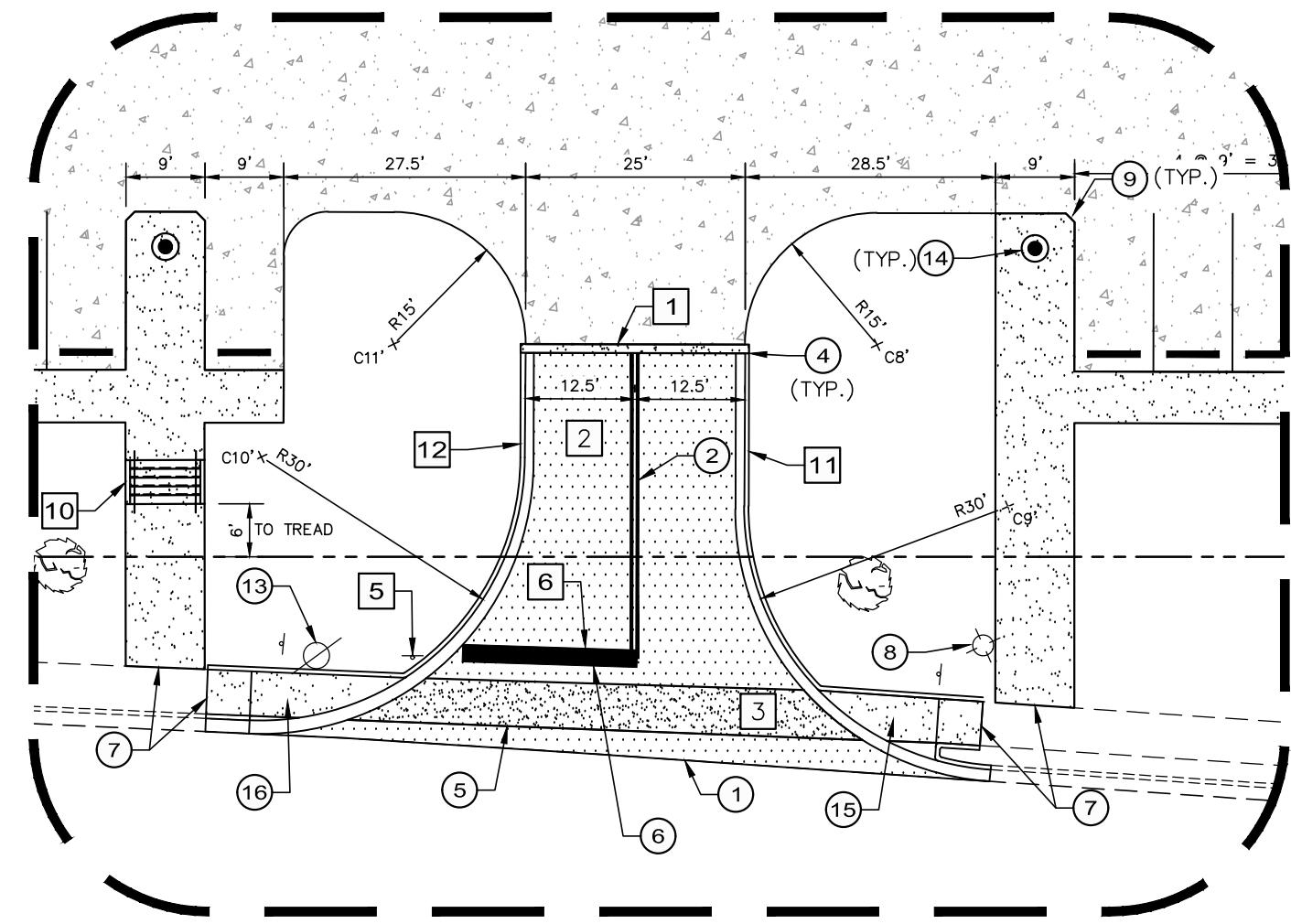
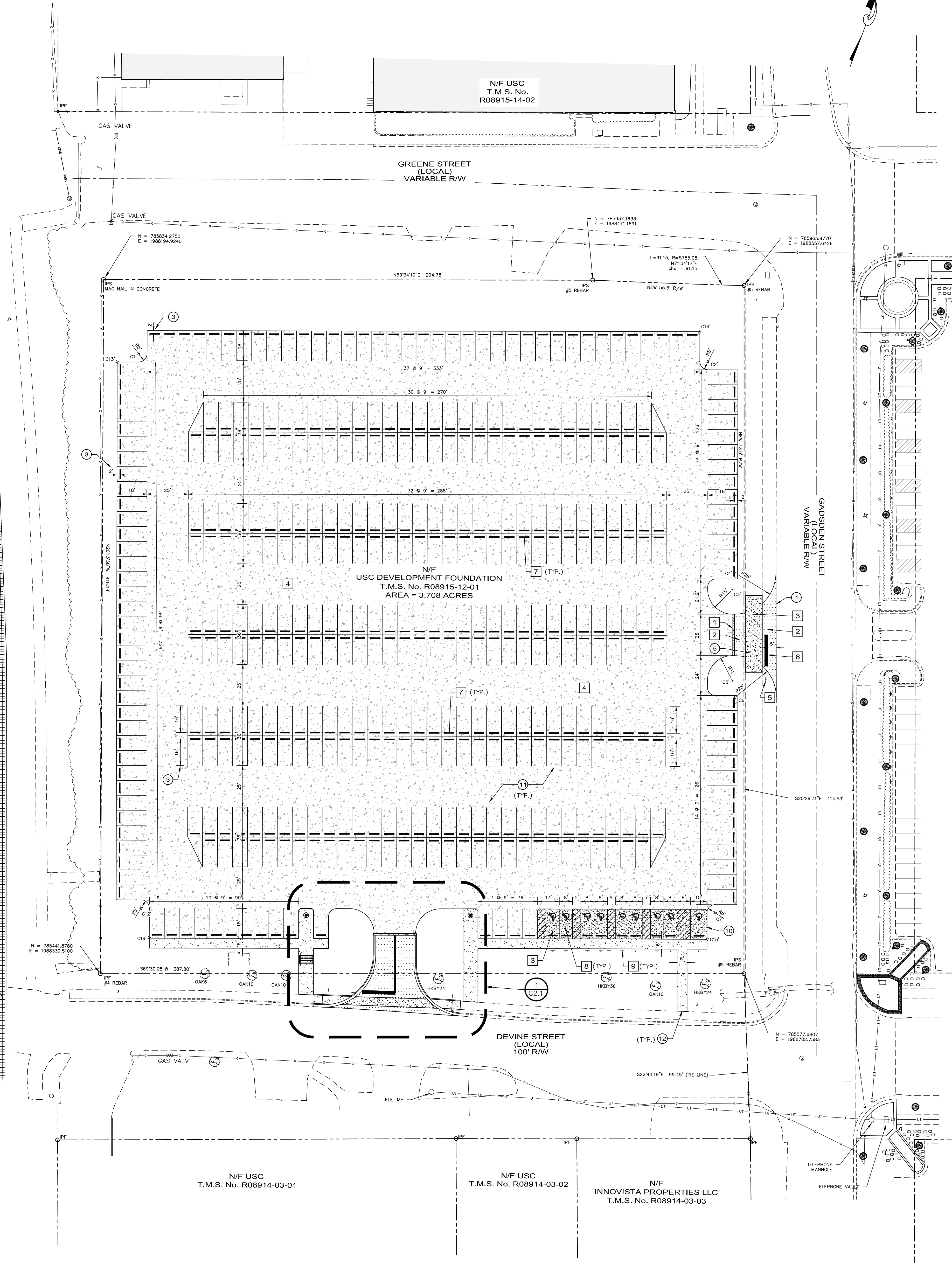

1
C2.1
ENLARGEMENT
1"=20'

LEGEND		
NEW	EXISTING	DESCRIPTION
N/A		BENCHMARK/CONTROL POINT
N/A		BUILDING
N/A		LIGHT POLE
N/A		CURB AND GUTTER
		HEAVY DUTY ASPHALT PAVEMENT
		RECYCLED ASPHALT
		LIGHT DUTY CONCRETE PAVEMENT
		HEAVY DUTY CONCRETE PAVEMENT
		BOLLARD
		KEY NOTE REFERENCE

- GENERAL NOTES**
- SEE SHEET C1.1 FOR ADDITIONAL GENERAL NOTES.
 - ALL ROADWAY STRIPING SHOWN SHALL BE PERFORMED BY THE CONTRACTOR USING TRAFFIC MARKING PAINT. PAINT SHALL BE SHERWIN-WILLIAMS "PRO-MAR" TRAFFIC MARKING PAINT OR EQUIVALENT. TRAFFIC PAINT AND SHALL BE APPLIED IN TWO COATS AND IN STRICT ACCORDANCE WITH MANUFACTURER'S INSTRUCTIONS. ALL PARKING LOT STRIPES TO BE 4" WIDE (WHITE).
 - ALL DIMENSIONS ARE MEASURED FROM FACE OF PARKING SPACE, CURB, CURB CORNER, OR EDGE OF PAVEMENT UNLESS OTHERWISE INDICATED.
 - ALL RADII ARE 5' UNLESS OTHERWISE NOTED.
 - COORDINATES ARE STATE PLANE.

- KEY NOTES**
- PLACE NEW ASPHALT FLUSH WITH EXISTING.
 - INSTALL 4" WIDE DOUBLE YELLOW PAINT STRIPE AS INDICATED FROM STOP BAR TO CONCRETE KEY.
 - MEASUREMENTS ARE FROM END OF PARKING SPACE TO FACE OF WHEEL STOP. (TYP.)
 - TAPER CURB AND GUTTER AT CONCRETE KEY (TYP.).
 - POUR NEW SIDEWALK SECTION ACROSS DRIVEWAY AS INDICATED (6"-4000 PSI). MATCH WIDTH OF EXISTING SIDEWALK. SCORE 5" ON CENTER.
 - INSTALL STOP BAR 2' FROM EDGE OF SIDEWALK.
 - CONNECT NEW CONCRETE SIDEWALK TO EDGE OF EXISTING SIDEWALK.
 - JOG SIDEWALK AROUND EXISTING LIGHT POLE.
 - MITRE CORNERS OF CONCRETE SIDEWALK ALONG DRIVE AISLE 12".
 - INSTALL HEAVY DUTY CONCRETE PAVEMENT AT HANDICAP SPACES AS INDICATED. MITRE CORNERS ALONG DRIVE AISLE 12".
 - PARKING STRIPES SHOWN ARE FOR GENERAL INFORMATION AND FOR ALIGNMENT OF WHEEL STOPS. NO PARKING SPACE STRIPING REQUIRED.
 - CONNECT NEW SIDEWALK FLUSH WITH EXISTING (TYP.).
 - JOG NEW SIDEWALK AROUND EXISTING POWER POLE.
 - INSTALL BOLLARD 12" FROM END OF CONCRETE.
 - INSTALL HANDICAP RAMP AS PER SCDOT DETAIL 720-952-11 (DETAIL #2).
 - INSTALL HANDICAP RAMP AS PER SCDOT DETAIL 720-952-11 (DETAIL #1).

DETAIL REFERENCES		
I.D.	DETAIL NO.	DESCRIPTION
1	10/C5.1	CONCRETE KEY
2	1/C5.1	HEAVY DUTY ASPHALT PAVEMENT
3	4/C5.1	HEAVY DUTY CONCRETE PAVEMENT
4	2/C5.1	RECYCLED ASPHALT
5	16/C5.1	STOP SIGN
6	12/C5.1	STOPBAR
7	6/C5.1	WHEEL STOP
8	14/C5.1	HC SPACE
9	15/C5.1	HC SIGN
10	17/C5.1	STEPS
11	7/C5.1	PITCHED CURB AND GUTTER
12	7/C5.1	NORMAL CURB AND GUTTER

PARKING SUMMARY
CITY COLUMBIA ZONING ORDINANCE
TOTAL PROPOSED PARKING SPACES = 440
TOTAL REGULAR SPACES = 431
TOTAL HANDICAP SPACES = 9

COORDINATE SCHEDULE			
COORDINATE	DESCRIPTION	NORTHING	EASTING
C1	RADIUS	785799.79	1988230.41
C2	RADIUS	785915.57	1988553.36
C3	RADIUS	785792.15	1988615.15
C4	RADIUS	785801.95	1988612.82
C5	RADIUS	785740.59	1988634.34
C6	RADIUS	785731.78	1988639.30
C7	RADIUS	785605.92	1988673.76
C8	RADIUS	785536.26	1988523.11
C9	RADIUS	785524.23	1988543.52
C10	RADIUS	785499.76	1988461.93
C11	RADIUS	785517.10	1988471.55
C12	RADIUS	785487.40	1988348.62
C13	CORNER	785790.58	1988219.96
C14	CORNER	785930.69	1988542.37
C15	CORNER	785589.36	1988674.57
C16	CORNER	785472.27	1988359.57

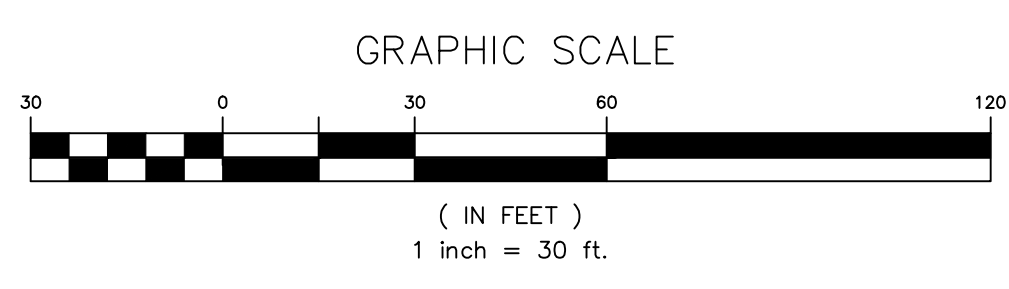

University of South Carolina
Columbia, South Carolina

GREEK VILLAGE STUDENT
PARKING DEVELOPMENT
PROJECT # H27-Z414
COLUMBIA
SOUTH CAROLINA

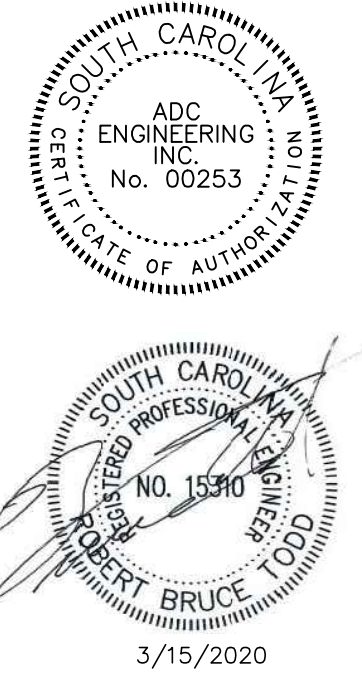

ADC ENGINEERING
7436 BROAD RIVER ROAD, SUITE 212
IRMO, SC 29063
803-781-3141
ADCENGINEERING.COM

811
CONTRACTOR SHALL CONTACT 811 (1-888-721-7877) FOR LOCATIONS OF ALL UTILITIES AT LEAST 72 HOURS PRIOR TO BEGINNING CONSTRUCTION.

DATE:	03/13/2020
ADC PROJECT #:	20002.00
DESIGNED:	RBT
CHECKED:	RBT
DRAWN:	RPL
REVISION:	100% CD Review

STAKING PLAN

C2.1

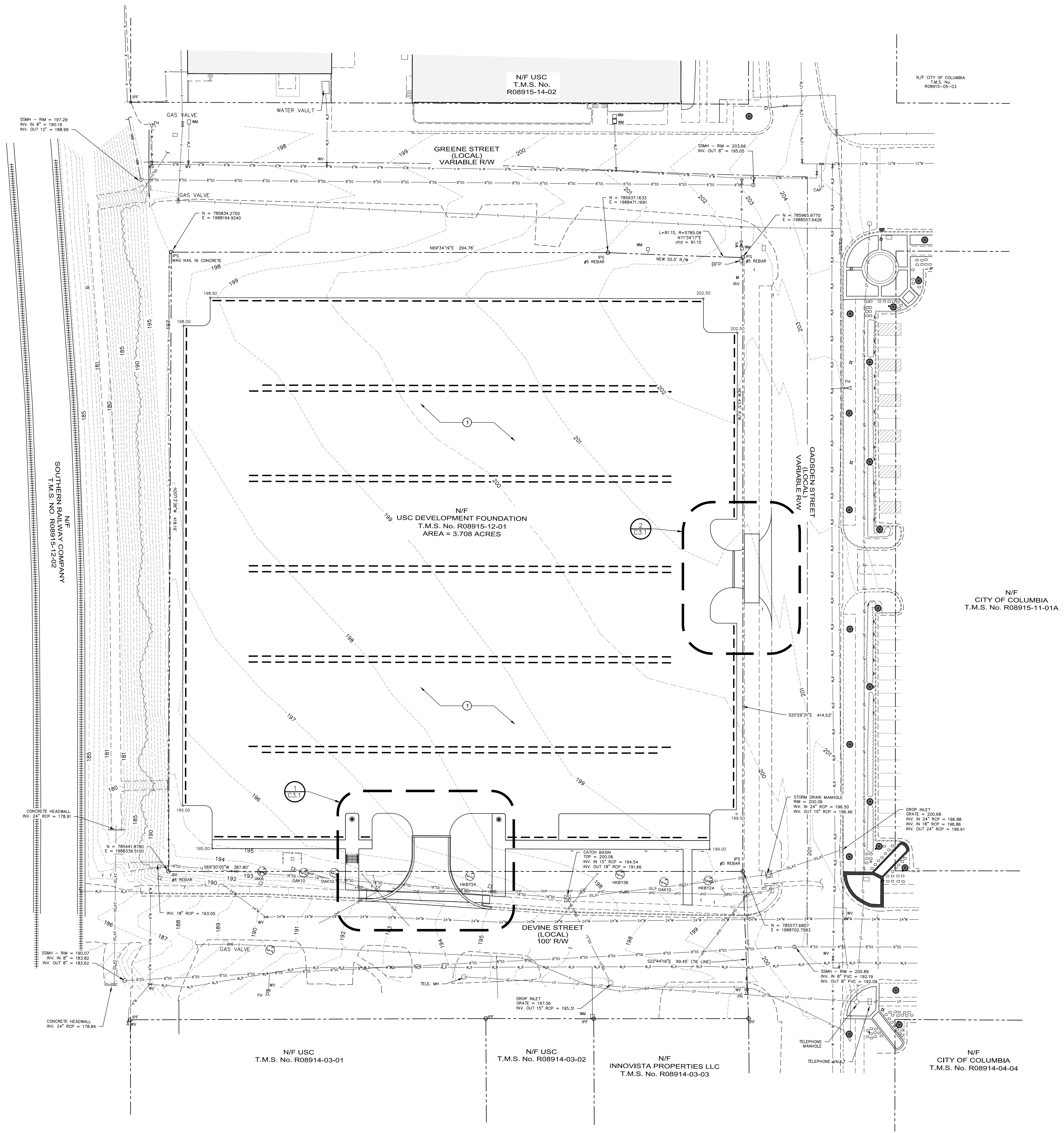

LEGEND		
NEW	EXISTING	DESCRIPTION
N/A		BENCHMARK/CONTROL POINT
N/A		PROPERTY LINE BUILDING
N/A		TREE
		CONTOUR
		SPOT ELEVATION
		FIRE HYDRANT
		LIGHT POLE
		WATER VALVE
		WATER METER
		WATER MAIN/SERVICE
		STORM DRAIN LINE w/STRUCTURE
		SANITARY SEWER LINE w/MANHOLE
		SANITARY SEWER CLEANOUT
		CHAIN LINK FENCE
		KEY NOTE REFERENCE

GENERAL NOTES

1. SEE SHEET C1.1 FOR ADDITIONAL GENERAL NOTES.

KEY NOTES

① IT IS THE GENERAL INTENT OF GRADING THAT THE FINISHED SURFACE GRADES IN THE PARKING LOT SHALL MATCH EXISTING GRADES PRIOR TO CONSTRUCTION. SPOT GRADES AT PARKING LOT CORNERS CAN BE ADJUSTED TO ACCOMMODATE EXISTING GRADES. COORDINATE WITH ENGINEER PRIOR TO ADJUSTING GRADES MORE THAN FOUR INCHES.

② MATCH EXISTING GRADES AT EDGE OF PAVEMENT.

③ COORDINATE WITH POWER COMPANY TO RELOCATE GUY WIRE OUT OF SIDEWALK.

④ SLOPE FROM EDGE OF EXISTING PAVEMENT UP TO EDGE OF SIDEWALK ON 2.0% CARRY 2.0% SLOPE ACROSS SIDEWALK.

GRADING NOTES

1. DURING CONSTRUCTION AND UNTIL SITE IS STABILIZED, USE THE SILT FENCE STORM INLET SEDIMENT TRAP SHOWN ON DETAIL SHEET AROUND ALL INLETS AND PLACE AND MAINTAIN SILT FENCES AS REQUIRED TO PREVENT EROSION AND SEDIMENTATION RUNOFF.

2. CONTRACTOR SHALL VERIFY ALL FIELD CONDITIONS PRIOR TO BEGINNING WORK. CONTRACTOR SHALL VERIFY LOCATION AND AVAILABILITY OF ALL UTILITIES AFFECTING THE PROJECT ON AND OFF THE SITE.

3. THE CONSTRUCTION OF ALL STREETS & DRAINAGE FACILITIES SHALL BE GOVERNED BY CITY OF COLUMBIA STANDARD SPECIFICATIONS & SCDOT STANDARD SPECIFICATIONS LATEST EDITION.

4. CONTRACTOR SHALL USE THE INLET SEDIMENT PROTECTION ON ALL INLETS UNTIL THE AREA DRAINING TO THE INLET HAS BEEN STABILIZED.

5. CONTRACTOR TO INSTALL ADDITIONAL EROSION CONTROL MEASURES AS REQUIRED BY CITY OF COLUMBIA OR SCDOT.

6. PROVIDE SILT FENCE AND/OR OTHER CONTROL DEVICES, AS MAY BE REQUIRED, TO CONTROL SOIL EROSION DURING ALL UTILITY CONSTRUCTION. ALL DISTURBED AREAS SHALL BE CLEANED, GRADED AND STABILIZED WITH GRASSING IMMEDIATELY AFTER THE UTILITY CONSTRUCTION.

7. CONTRACTOR TO REPAIR ANY DAMAGE DONE TO EXISTING PAVEMENT, FENCING, ETC. DUE TO CONSTRUCTION ENTIRELY AT HIS EXPENSE.

8. CONTRACTOR MUST TAKE NECESSARY ACTION TO MINIMIZE THE TRACKING OF MUD ONTO THE PAVED ROADWAY FROM CONSTRUCTION AREAS. CONTRACTOR TO DAILY REMOVE MUD/SOIL FROM PAVEMENT AS REQUIRED.

9. ALL EROSION CONTROL DEVICES SHALL BE PROPERLY MAINTAINED DURING ALL PHASES OF CONSTRUCTION UNTIL THE COMPLETION OF ALL CONSTRUCTION ACTIVITIES AND ALL DISTURBED AREAS HAVE BEEN STABILIZED. ADDITIONAL CONTROL DEVICES MAY BE REQUIRED DURING CONSTRUCTION IN ORDER TO CONTROL EROSION AND/OR OFFSITE SEDIMENTATION. ALL TEMPORARY CONTROL DEVICES SHALL BE REMOVED ONCE CONSTRUCTION IS COMPLETE AND THE SITE IS STABILIZED.

10. ALL UNDERGROUND LOCATIONS ARE APPROXIMATE PER DRAWINGS AND LOCATIONS SUPPLIED BY VARIOUS UTILITY COMPANIES.

11. ALL DEMOLISHED ITEMS TO BE REMOVED FROM SITE AND DISPOSED OF IN LEGAL MANNER.

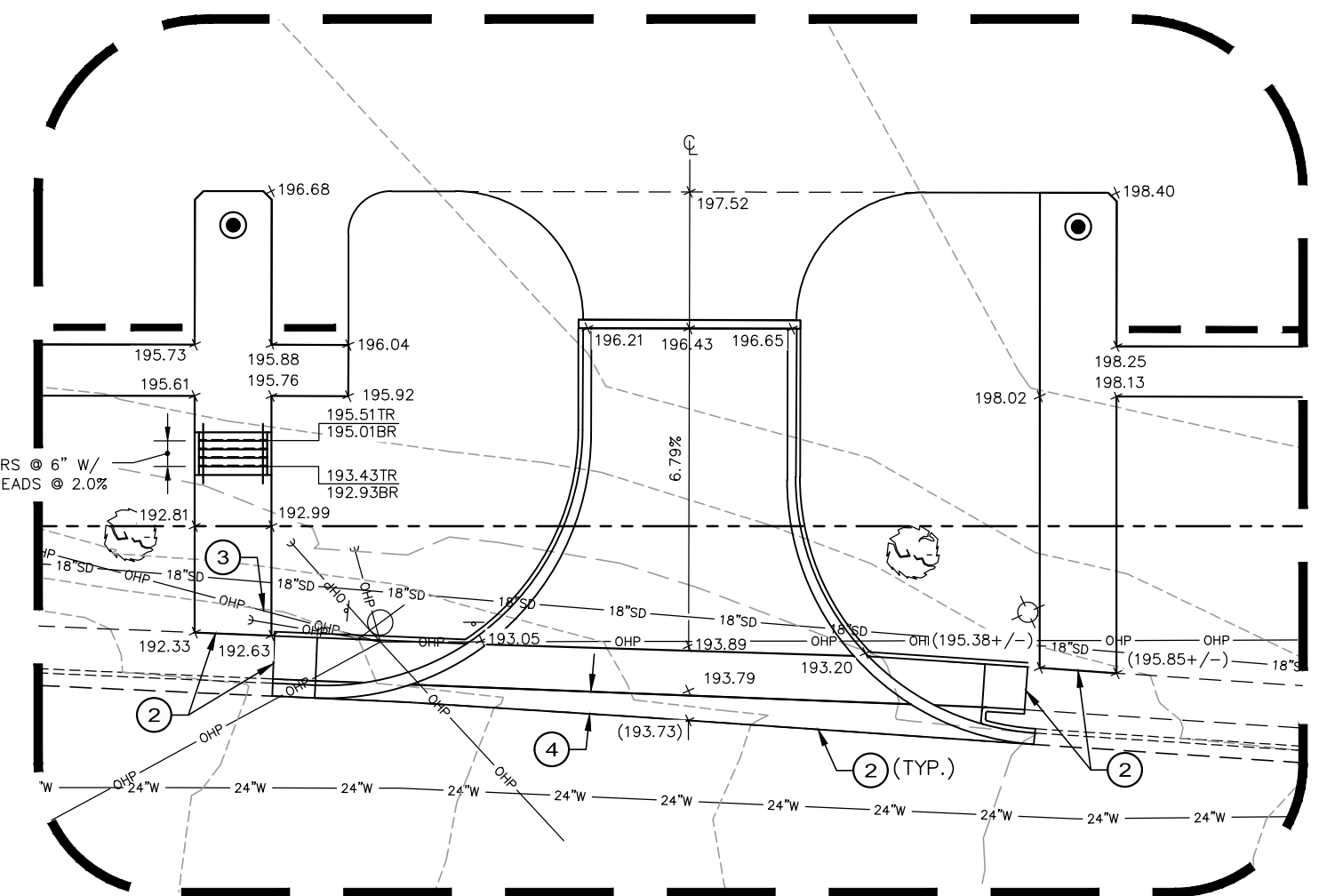

1 C3.1 ENLARGEMENT

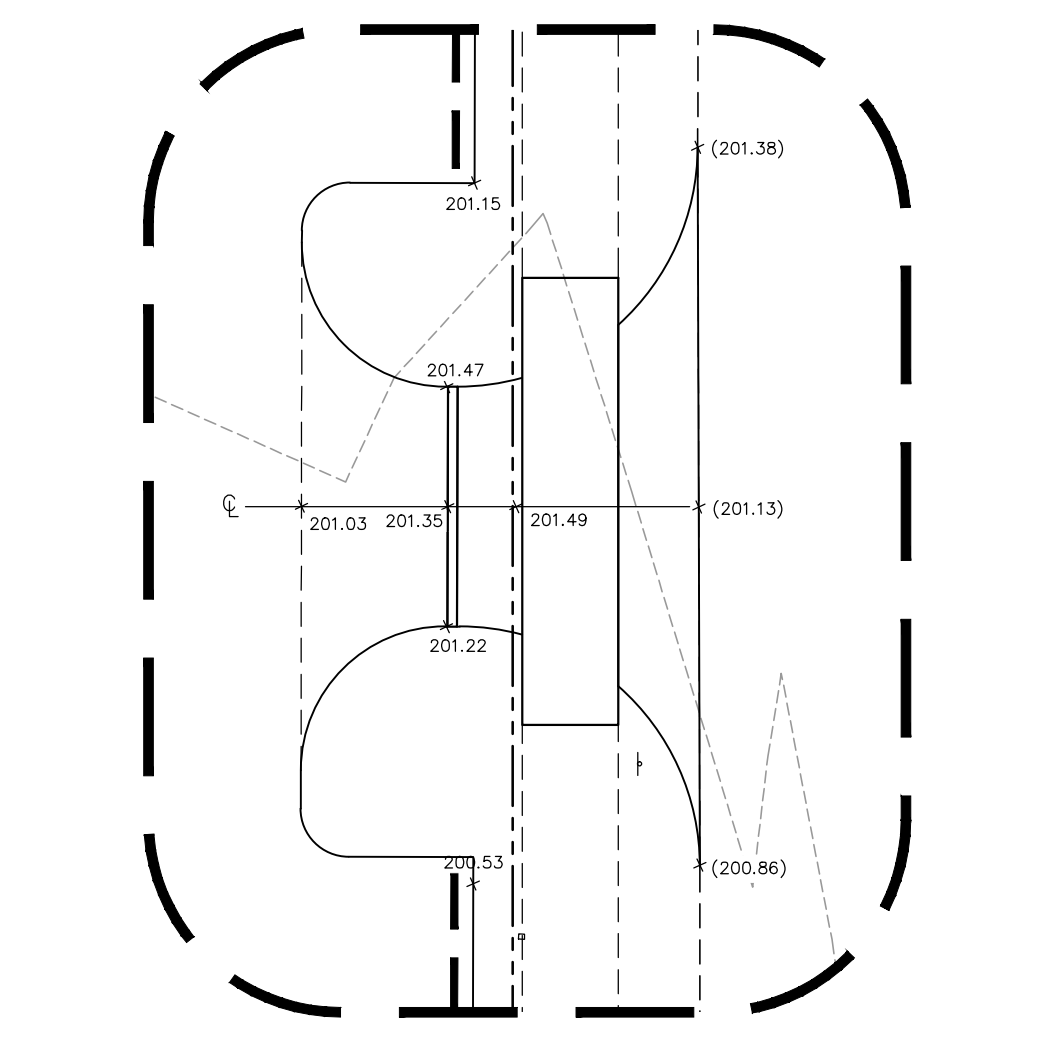

2 C3.1 ENLARGEMENT

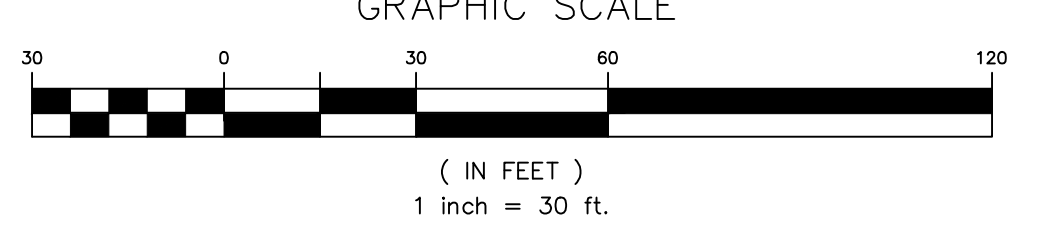

University of South Carolina
Columbia, South Carolina

GREEK VILLAGE STUDENT
PARKING DEVELOPMENT
PROJECT # H27-Z414
COLUMBIA
SOUTH CAROLINA

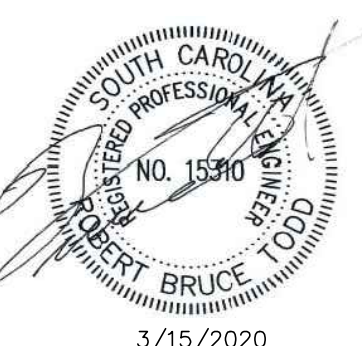
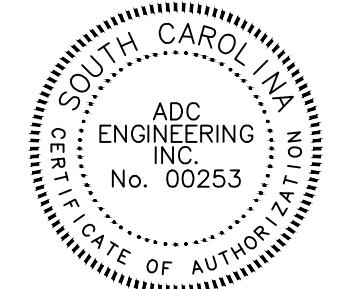

ADC ENGINEERING

7436 BROAD RIVER ROAD, SUITE 212
IRMO, SC 29063
803-781-3141
ADCENGINEERING.COM

811

CONTRACTOR SHALL CONTACT 811 (1-888-721-7871) FOR LOCATIONS OF ALL UTILITIES AT LEAST 72 HOURS PRIOR TO BEGINNING CONSTRUCTION.

DATE:	03/13/2020
ADC PROJECT #:	20002.00
DESIGNED:	RBT
CHECKED:	RBT
DRAWN:	RPL
REVISION:	100% CD Review

GRADING AND DRAINAGE PLAN

C3.1

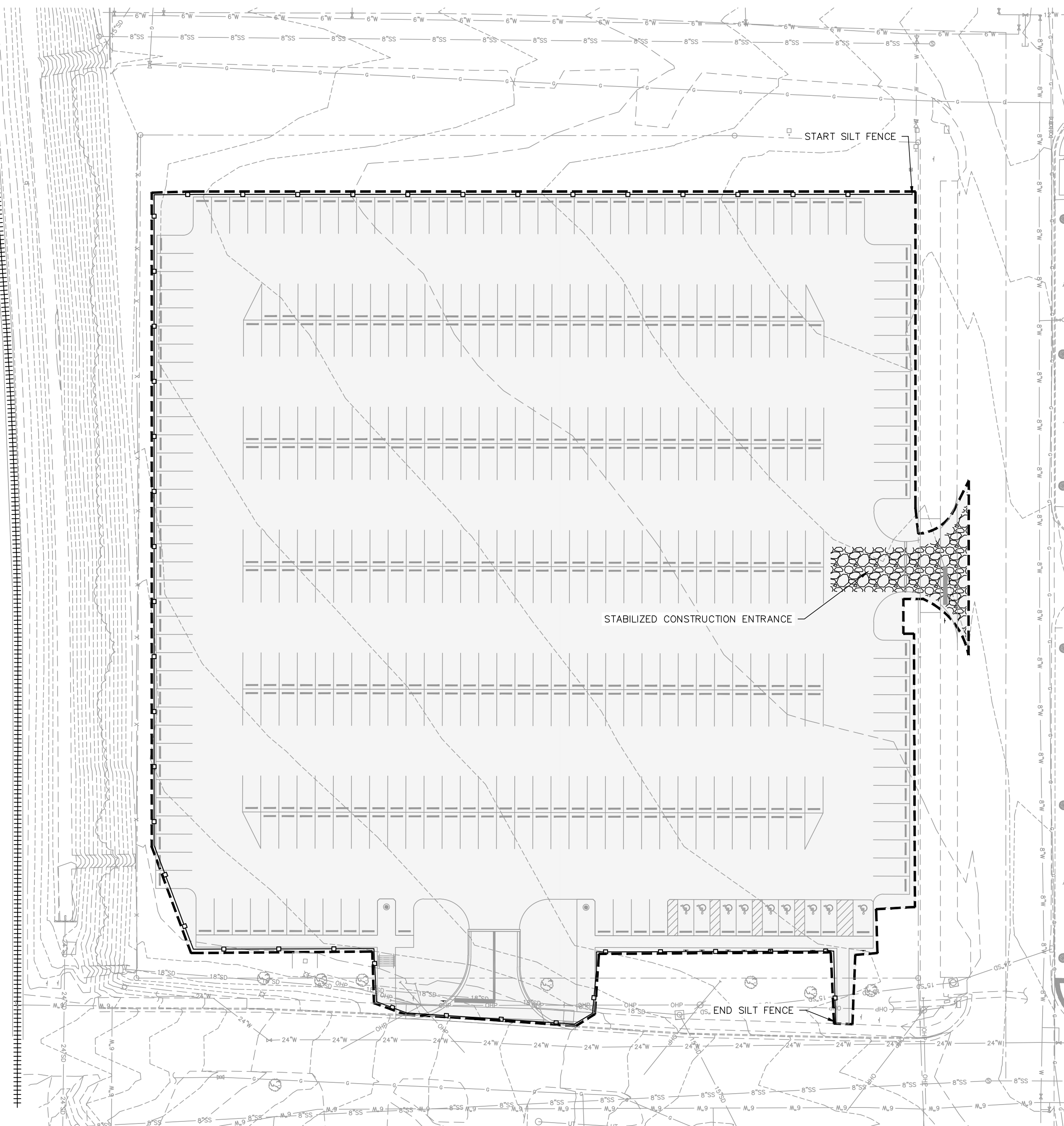

AIRBORNE DUST CONTROL

THE CONTRACTOR SHALL IMPLEMENT DUST CONTROL MEASURES AS OUTLINED IN THE SOUTH CAROLINA DHEC STORMWATER MANAGEMENT BMP HANDBOOK AS NEEDED TO CONTROL AIRBORNE DUST DURING CONSTRUCTION. COORDINATE WITH ENGINEER PRIOR TO IMPLEMENTATION OF VARIOUS MEASURES.

SLOPE STABILIZATION

THE CONTRACTOR IS RESPONSIBLE FOR SLOPE STABILIZATION AND IS RESPONSIBLE FOR INSTALLING THE NECESSARY STABILIZATION DEVICES TO ACCOMPLISH 100% STABILIZATION. THE CONTRACTOR SHALL INSTALL THE EROSION CONTROL MAT WHERE INDICATED AT MINIMUM AND MAY NEED TO INSTALL TEMPORARY SLOPE DRAIN (CONTRACTOR OPTION)

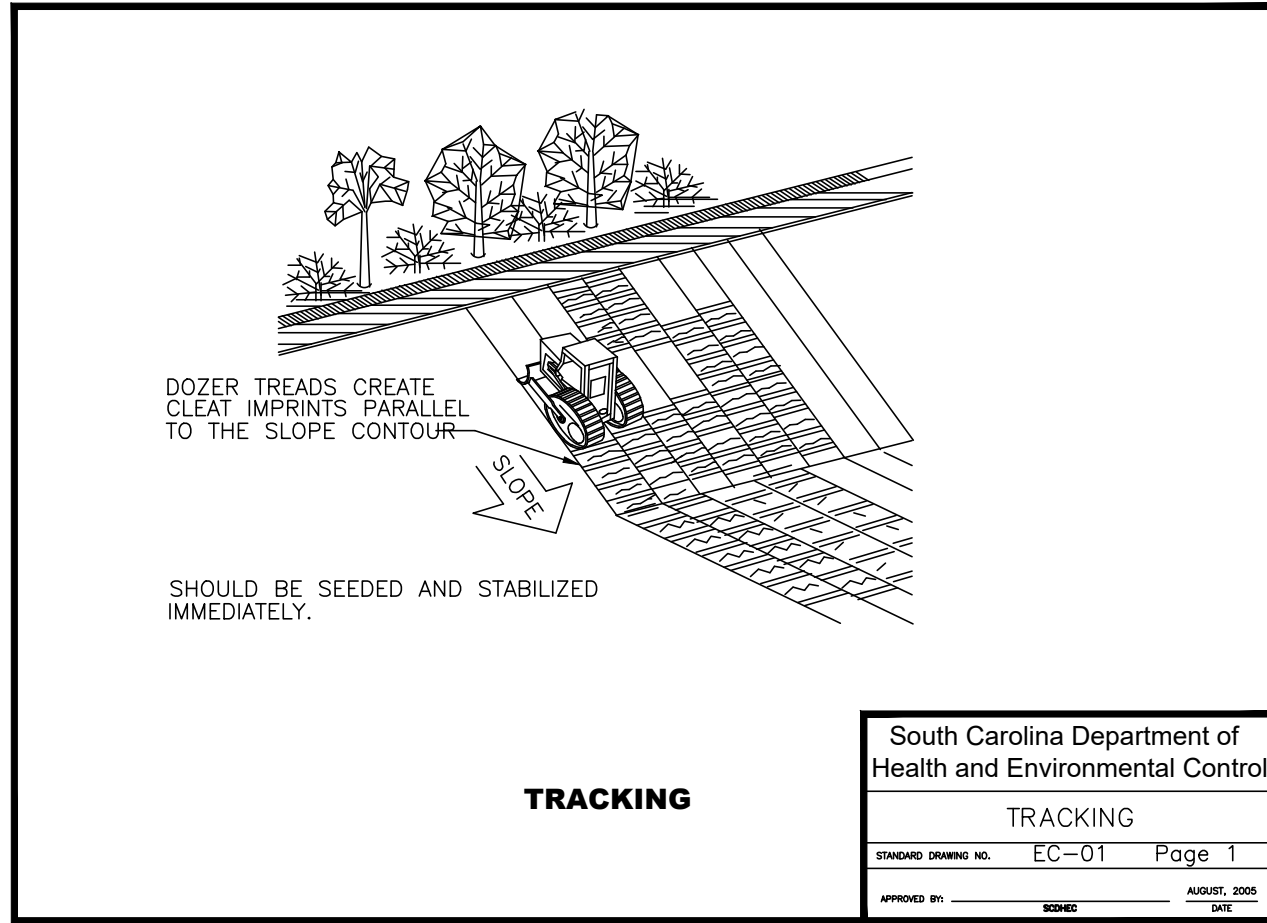

CONSTRUCTION SEQUENCE OF ENTIRE CONSTRUCTION AREA FOR EROSION AND SEDIMENT CONTROL

1. RECEIVE NPDES COVERAGE FROM DHEC.
2. PRE-CONSTRUCTION MEETING WITH THE CITY OF COLUMBIA
3. INSTALLATION OF CONSTRUCTION ENTRANCE(S).
4. CLEARING & GRUBBING ONLY AS NECESSARY FOR INSTALLATION OF PERIMETER CONTROLS.
5. INSTALLATION OF PERIMETER CONTROLS (E.G., SILT FENCE).
6. SITE DEMO BEGINS.
7. CLEARING & GRUBBING OF SITE.
8. FINE GRADING, SIDEWALK CONSTRUCTION ETC.
9. PERMANENT/FINAL PARKING LOT STABILIZATION.
10. SEDIMENT ACCUMULATIONS SHALL BE REMOVED FROM IMPOUNDED AREAS ONCE THE SITE IS STABILIZED.
11. REMOVAL OF TEMPORARY SEDIMENT & EROSION CONTROL MEASURES AFTER ENTIRE AREA DRAINING TO THE STRUCTURE IS FINALLY STABILIZED (THE DEPARTMENT RECOMMENDS THAT THE PROJECT OWNER/OPERATOR HAVE THE SWPPP PREPARER OR REGISTRATION EQUIVALENT APPROVE THE REMOVAL OF TEMPORARY STRUCTURES).
12. SUBMIT NOTICE OF TERMINATION (NOT) TO CITY WITH CLOSEOUT PACKAGE AS APPROPRIATE.

STANDARD NOTES FROM SWPPP

SWPPP, INSPECTION RECORDS, AND RAINFALL DATA MUST BE KEPT ONSITE OR WITHIN THIRTY (30) MINUTES OF THE SITE AT ALL TIMES FROM THE COMMENCEMENT OF CONSTRUCTION ACTIVITIES TO THE DATE THAT FINAL STABILIZATION IS ACHIEVED. THESE ITEMS ARE TO BE IN A DESIGNATED AREA THAT IS ACCESSIBLE TO THE INSPECTORS.

SEDIMENT AND EROSION CONTROL NOTES

1. THE CONTRACTOR SHALL PROVIDE AND MAINTAIN THROUGHOUT THE LENGTH OF CONSTRUCTION SILT FENCES AT ALL STORM DRAINAGE STRUCTURES AND ALONG THE PERIMETER OF CONSTRUCTION AS NECESSARY TO CONTAIN ALL SEDIMENT RUNOFF WITHIN THE AREAS DISTURBED BY CONSTRUCTION.
2. STABILIZATION MEASURES SHALL BE INITIATED AS SOON AS PRACTICABLE IN PORTIONS OF THE SITE WHERE CONSTRUCTION ACTIVITIES HAVE TEMPORARILY OR PERMANENTLY CEASED, BUT IN NO CASE MORE THAN FOURTEEN (14) DAYS AFTER WORK HAS CEASED EXCEPT AS STATED BELOW.
 - > WHERE STABILIZATION BY THE 14th DAY IS PRECLUDED BY SNOW COVER OR FROZEN GROUND CONDITIONS, STABILIZATION MEASURES MUST BE INITIATED AS SOON AS PRACTICABLE.
 - > WHERE CONSTRUCTION ACTIVITY ON A PORTION OF THE SITE IS TEMPORARILY CEASED, AND EARTH-DISTURBING ACTIVITIES WILL BE RESUMED WITHIN 21 DAYS, TEMPORARY STABILIZATION MEASURES DO NOT HAVE TO BE INITIATED ON THAT PORTION OF THE SITE.
3. ALL SEDIMENT AND EROSION CONTROL DEVICES SHALL BE INSPECTED AT LEAST ONCE EVERY CALENDAR WEEK. IF PERIODIC INSPECTION OR OTHER INFORMATION INDICATES THAT A BMP HAS BEEN INAPPROPRIATELY OR INCORRECTLY INSTALLED, THE PERMITTEE MUST ADDRESS THE NECESSARY REPLACEMENT OR MODIFICATION REQUIRED TO CORRECT THE BMP WITHIN 48 HOURS OR IDENTIFICATION.
4. SEDIMENT DEPOSITS SHOULD BE REMOVED WHEN THEY REACH ONE-THIRD THE HEIGHT OF THE SEDIMENT FENCE.
5. THE CONTRACTOR SHALL BE RESPONSIBLE FOR STABILIZING ALL SLOPES FROM FINISH GRADE TO NATURAL GROUND AND FOR PREVENTING EXCESSIVE EROSION FROM OCCURRING. IMMEDIATELY AFTER ESTABLISHING THE INTERMEDIATE ROUGH GRADE SLOPES AND AFTER REACHING THE FINAL GRADE SLOPES, THE CONTRACTOR SHALL PROVIDE GRASSING OF THESE SLOPES. WHEN SLOPES ARE DISTURBED BY THE SUBSEQUENT EXCAVATIONS FOR OTHER ITEMS, THE CONTRACTOR SHALL INSPECT THE REPAIRS AND CORRECT ANY DEFICIENCIES IN THE REPAIRS.
6. ALL GRADING WORK SHALL CONFORM SUBSTANTIALLY WITH THE GRADING PLANS. WHERE SPOT GRADES ARE INDICATED ON THE PLANS, THEY SHALL BE ESTABLISHED BY SCALING AND SHALL TAKE PRECEDENCE OVER CONTOURS. ALL GRADING BETWEEN SPOT GRADES SHALL BE SMOOTH AND UNIFORM.
7. THE CONTRACTOR SHALL ADEQUATELY COORDINATE THE INSTALLATION OF THE STORM DRAINAGE SYSTEM TO ENSURE THAT POSITIVE RUNOFF OF STORMWATER IS EFFECTED BOTH DURING CONSTRUCTION AND AFTER COMPLETION OF THE WORK.
8. IF NECESSARY, SLOPES WHICH EXCEED 8 VERTICAL FEET SHOULD BE STABILIZED WITH SYNTHETIC OR VEGETATIVE MATS, IN ADDITION TO HYDROSEEDING. IT MAY BE NECESSARY TO INSTALL TEMPORARY SLOPE DRAINS DURING CONSTRUCTION. TEMPORARY BERMS MAY BE NEEDED UNTIL THE SLOPE IS BROUGHT TO GRADE.
9. PROVIDE SILT FENCE AND/OR OTHER CONTROL DEVICES, AS MAY BE REQUIRED, TO CONTROL SOIL EROSION DURING UTILITY CONSTRUCTION. ALL DISTURBED AREAS SHALL BE CLEARED, GRADED, AND STABILIZED WITH GRASSING IMMEDIATELY AFTER THE UTILITY INSTALLATION. COVER, AND TEMPORARY SEEDING AT THE END OF EACH DAY ARE RECOMMENDED. IF WATER IS ENCOUNTERED WHILE TRENCHING, THE WATER SHOULD BE FILTERED TO REMOVE ANY SEDIMENTS BEFORE BEING PUMPED BACK INTO ANY WATERS OF THE STATE.
10. THE CONTRACTOR MUST TAKE NECESSARY ACTION TO MINIMIZE TRACKING OF MUD ONTO PAVED ROADWAY FROM CONSTRUCTION AREAS AND GENERATION OF DUST.
11. ALL EROSION CONTROL DEVICES SHALL BE PROPERLY MAINTAINED DURING ALL PHASES OF CONSTRUCTION UNTIL THE COMPLETION OF ALL CONSTRUCTION ACTIVITIES AND ALL DISTURBED AREAS HAVE BEEN STABILIZED. ADDITIONAL CONTROL DEVICES MAY BE REQUIRED DURING CONSTRUCTION IN ORDER TO CONTROL EROSION AND/OR OFFSITE SEDIMENTATION. ALL TEMPORARY CONTROL DEVICES SHALL BE REMOVED ONCE CONSTRUCTION IS COMPLETE AND THE SITE IS STABILIZED.
12. TEMPORARY DIVERSION BERMS AND/OR DITCHES SHALL BE PROVIDED AS NEEDED DURING CONSTRUCTION TO PROTECT WORK AREAS FROM UPSLOPE RUNOFF AND/OR DIVERT SEDIMENT-LADEN WATER TO APPROPRIATE TRAPS OR STABLE OUTLETS.
13. ALL WATERS OF THE STATE (WOS), INCLUDING WETLANDS, ARE TO BE FLAGGED OR OTHERWISE CLEARLY MARKED IN THE FIELD. A DOUBLE ROW OF SILT FENCE IS TO BE INSTALLED IN ALL AREAS WHERE A 50-FOOT BUFFER CANNOT BE MAINTAINED BETWEEN THE DISTURBED AREAS AND ALL WOS. A 10-FOOT BUFFER SHOULD BE MAINTAINED BETWEEN THE LAST ROW OF SILT FENCE AND ALL WOS.
14. LITTER, CONSTRUCTION DEBRIS, OILS, FUELS, BUILDING PRODUCTS WITH SIGNIFICANT POTENTIAL FOR IMPACT (SUCH AS STOCKPILES OF FRESHLY TREATED LUMBER), AND CONSTRUCTION CHEMICALS THAT COULD BE EXPOSED TO STORMWATER MUST BE PREVENTED FROM BECOMING A POLLUTANT SOURCE IN STORMWATER DISCHARGES.
15. A COPY OF THE SWPPP, INSPECTIONS RECORDS, AND RAINFALL DATA MUST BE RETAINED AT THE CONSTRUCTION SITE OR A NEARBY LOCATION EASILY ACCESSIBLE DURING NORMAL BUSINESS HOURS, FROM THE DATE OF COMMENCEMENT OF CONSTRUCTION ACTIVITIES TO THE DATE THAT FINAL STABILIZATION IS REACHED.
16. INITIATE STABILIZATION MEASURES ON ANY EXPOSED STEEP SLOPE (3H:1V OR GREATER) WHERE LAND-DISTURBING ACTIVITIES HAVE
17. MINIMIZE SOIL COMPACTION AND, UNLESS INFEASIBLE, PRESERVE TOPSOIL.
18. MINIMIZE DISCHARGE OF POLLUTANTS FROM EQUIPMENT AND VEHICLE WASHING, WHEEL WASH WATER, AND OTHER WASH WATERS. WASH WATERS MUST BE TREATED IN A SEDIMENT BASIN OR ALTERNATIVE CONTROL THAT PROVIDES EQUIVALENT OR BETTER TREATMENT PRIOR TO DISCHARGE.
19. MINIMIZE THE DISCHARGE OF POLLUTANTS FROM DEWATERING OF TRENCHES AND EXCAVATED AREAS. THESE DISCHARGES ARE TO BE ROUTED THROUGH APPROPRIATE BMPs (SEDIMENT BASIN, FILTER BAG, ETC.).
20. THE FOLLOWING DISCHARGES FROM SITES ARE PROHIBITED:
 - WASTEWATER FROM WASHOUT OF CONCRETE, UNLESS MANAGED BY AN APPROPRIATE CONTROL.
 - WASTEWATER FROM WASHOUT AND CLEANOUT OF STUCCO, PAINT, FROM RELEASE OILS, CURING COMPOUNDS AND OTHER CONSTRUCTION MATERIALS.
 - FUELS, OILS, OR OTHER POLLUTANTS USED IN VEHICLE AND EQUIPMENT OPERATION AND MAINTENANCE; AND
 - SOAPS OR SOLVENTS USED IN VEHICLE AND EQUIPMENT WASHING.
21. IF EXISTING BMPs NEED TO BE MODIFIED OR IF ADDITIONAL BMPs ARE NECESSARY TO COMPLY WITH THE REQUIREMENTS OF THIS PERMIT AND/OR SC's WATER QUALITY STANDARDS, IMPLEMENTATION MUST BE COMPLETED BEFORE THE NEXT STORM EVENT WHENEVER PRACTICAL. IF IMPLEMENTATION BEFORE THE NEXT STORM EVENT IS IMPRACTICABLE, THE SITUATION MUST BE DOCUMENTED IN THE SWPPP AND ALTERNATIVE BMPs MUST BE IMPLEMENTED AS SOON AS REASONABLY POSSIBLE.
22. A PRE-CONSTRUCTION CONFERENCE MUST BE HELD FOR EACH CONSTRUCTION SITE WITH AN APPROVED ON-SITE SWPPP PRIOR TO THE IMPLEMENTATION OF CONSTRUCTION ACTIVITIES. FOR NON-LINEAR PROJECTS THAT DISTURB 10 ACRES OR MORE THIS CONFERENCE MUST BE HELD ON-SITE UNLESS THE DEPARTMENT HAS APPROVED OTHERWISE.
23. RESIDENTIAL SUBDIVISIONS REQUIRE EROSION CONTROL FEATURES FOR INFRASTRUCTURE AS WELL AS FOR INDIVIDUAL LOT CONSTRUCTION. INDIVIDUAL PROPERTY OWNERS SHALL FOLLOW THESE PLANS DURING CONSTRUCTION OR OBTAIN APPROVAL OF AN INDIVIDUAL PLAN IN ACCORDANCE WITH S.C. REG. 72-300 ET SEQ AND SC100000.

EROSION AND SEDIMENT CONTROL MEASURES

GENERAL

THE CONTRACTOR IS ADVISED THAT ALL GRADING AND DRAINAGE WORK ON THE PROJECT IS PERMITTED UNDER THE REQUIREMENTS OF THE SOUTH CAROLINA DEPARTMENT OF HEALTH AND ENVIRONMENTAL CONTROL, DIVISION OF STORMWATER MANAGEMENT. COMPLIANCE WITH THE PERMITTED CONDITIONS IS MANDATORY. THE CONTRACTOR SHALL RELY ON EXPERIENCE AND CONTROL OF THE WORK TO PROVIDE ADEQUATE AND ORDERLY CONSTRUCTION METHODS TO CONTROL STORMWATER RUNOFF AND PREVENT THE EXCESSIVE MIGRATION OF SEDIMENTS FROM THE SITE. THE CONTRACTOR ALSO SHALL DIRECT INSTALLATION OF NECESSARY TEMPORARY CONSTRUCTION MEASURES TO CONTROL STORMWATER RUNOFF. ALL STORMWATER MANAGEMENT MEASURES SHALL BE INSPECTED AFTER EACH RAIN EVENT AND ANY REQUIRED MAINTENANCE SHALL BE PERFORMED.

SILT FENCES

SILT FENCES OR EQUIVALENT SEDIMENT CONTROL SHALL BE INSTALLED WHERE INDICATED AND MAINTAINED IN ACCORDANCE WITH THIS PLAN.

STORM DRAINAGE STRUCTURES

TEMPORARY BARRIERS OF EITHER SILT FENCING OR ROCK RIPRAP SHALL BE INSTALLED AND MAINTAINED AROUND STORM DRAINAGE STRUCTURES UNTIL THEIR DRAINAGE AREA IS STABILIZED. STORM DRAINAGE PIPES, INCLUDING OUTLET PROTECTION, SHALL BE INSTALLED AS SOON AS EARTH GRADING IS ADEQUATE TO ACCEPT PIPE INSTALLATION. INLET STRUCTURES SHALL BE CONSTRUCTED AS THE EARTHILL IS PLACED AND CONSTRUCTION SHALL AT ALL TIMES PROVIDE SURFACE DRAINAGE TO THEM. TEMPORARY BARRIERS SHALL BE INSTALLED AND MAINTAINED AT EACH INLET AS THE EARTH FILL RISES.

STABILIZATION OF DISTURBED AREAS

DISTURBED AREAS SHALL RECEIVE STABILIZING MEASURES WITHIN 14 DAYS AFTER DISTURBANCES, UNLESS CONSTRUCTION WILL RESUME IN THAT AREA WITHIN 21 DAYS FROM WHEN ACTIVITIES CEASED.

INSPECTION AND MAINTENANCE

SEDIMENT CONTROL SYSTEMS SHALL BE INSPECTED AT LEAST WEEKLY AND AFTER ANY RAINFALL EVENT EXCEEDING 0.5 INCH. ANY NEEDED CORRECTIONS OR MAINTENANCE SHALL BE ACCOMPLISHED IMMEDIATELY THEREAFTER.

REMOVAL OF SEDIMENT CONTROL SYSTEMS

TEMPORARY EROSION CONTROL MEASURES SHALL BE REMOVED AFTER EACH AFFECTED AREA HAS BEEN "FINALLY STABILIZED".

TEMPORARY DIVERSIONS

TEMPORARY DIVERSION BERMS AND/OR DITCHES WILL BE PROVIDED AS NEEDED DURING CONSTRUCTION TO PROTECT WORK AREAS FROM UPSLOPE RUNOFF AND/OR DIVERT SEDIMENT LADEN WATER TO APPROPRIATE TRAPS OR STABLE OUTLETS.

TEMPORARY DIVERSIONS SHALL BE CONSTRUCTED AS NECESSARY TO PREVENT FLOW OF STORMWATER OVER DISTURBED AREA. TEMPORARY DIVERSION OUTLETS SHALL HAVE ADEQUATE CAPACITY AND TERMINATE INTO DENSE VEGETATION, ROCK RIP RAP, STORM STRUCTURES OR SIMILAR MEASURES TO REDUCE EROSION AT THE OUTLET. TEMPORARY DIVERSION CHANNELS SHALL BE CONSTRUCTED AND MAINTAINED AT A MINIMUM OF 1 PERCENT GRADE AND A MAXIMUM GRADE OF 2 PERCENT. THE CAPACITY OF TEMPORARY DIVERSIONS SHALL BE RESTORED ANYTIME THE EXCAVATED CHANNEL BECOMES FULL OF SEDIMENT AT ANY POINT IN THE LENGTH OF THE DIVERSION. THE RIDGE AND CHANNEL OF THE TEMPORARY DIVERSIONS SHALL BE STABILIZED WITH TEMPORARY VEGETATION IMMEDIATELY AFTER CONSTRUCTION AND RE-STABILIZED AFTER EACH DISTURBANCE.

PREDOMINANT SOIL TYPE

URBAN LAND, (U₂) TYPE C

GRASSING PER 1000 SQUARE FEET (TEMPORARY)

FROM MAY 1 TO AUGUST 30	FROM SEPTEMBER 1 TO APRIL 30
1 LB. BROWNTOP MULLET GRASS	6 LBS. ANNUAL RYEGRASS
15 LBS. 10-10-10 FERTILIZER	15 LBS. 10-10-10 FERTILIZER
5 LBS. MAGNESIUM SULFATE	5 LBS. MAGNESIUM SULFATE
10 LBS. CALCIUM (GYPSUM)	10 LBS. CALCIUM (GYPSUM)

GRASS INFORMATION (PERMANENT)

SEE LANDSCAPE ARCHITECTURE PLANS FOR PERIMETER GRASSING AND LANDSCAPE INFORMATION.

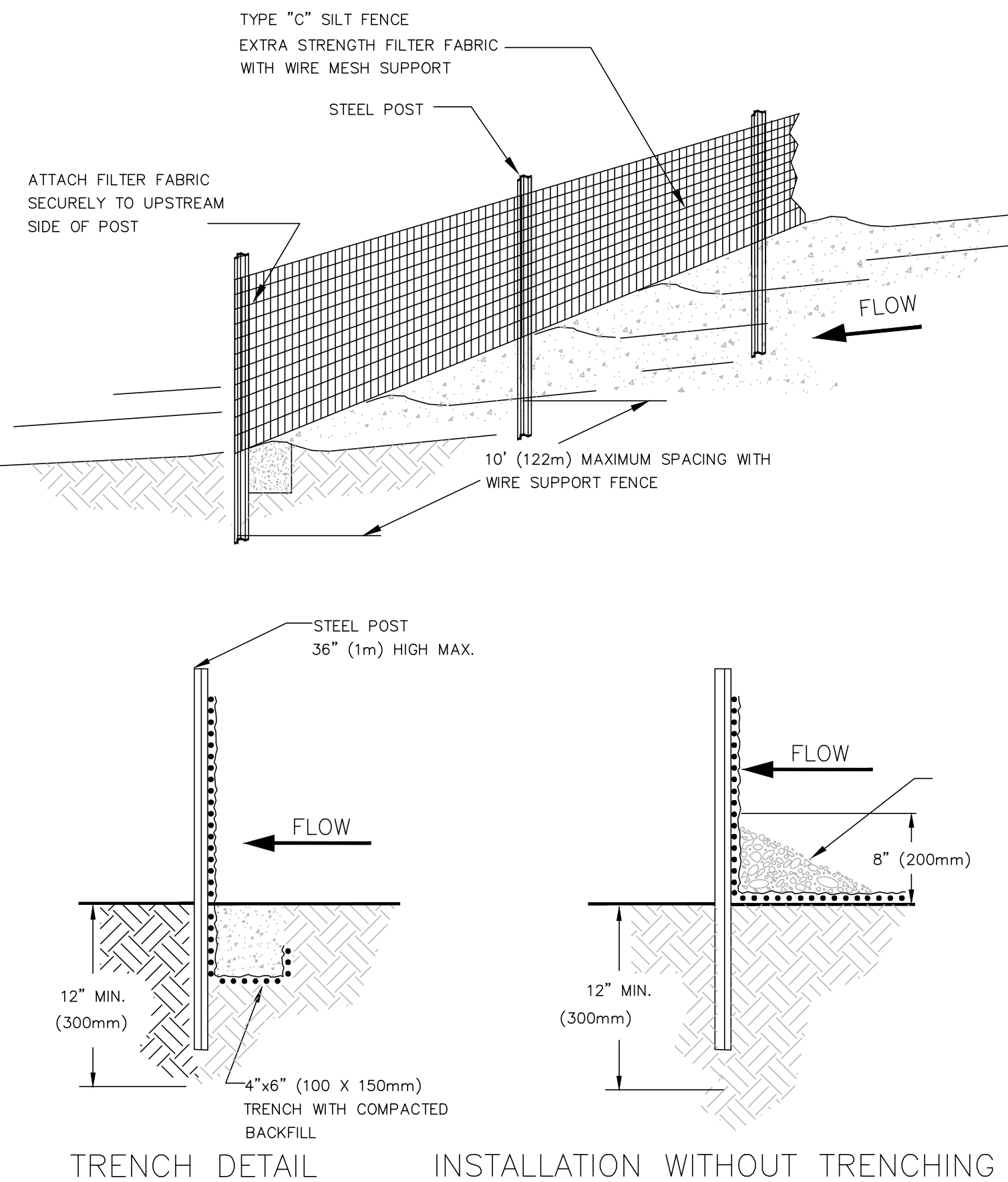

NOTES:

1. SILT FENCE SHALL BE PLACED ON SLOPE CONTOURS TO MAXIMIZE PONDING EFFICIENCY.
2. INSPECT AND REPAIR FENCE AFTER EACH STORM EVENT AND REMOVE SEDIMENT WHEN NECESSARY. 2/3 FULL MAXIMUM RECOMMENDED STORAGE HEIGHT.
3. REMOVED SEDIMENT SHALL BE DEPOSITED TO AN AREA THAT WILL NOT CONTRIBUTE SEDIMENT OFF-SITE AND CAN BE PERMANENTLY STABILIZED.

SILT FENCE DETAIL (TYPE "C")

NO SCALE

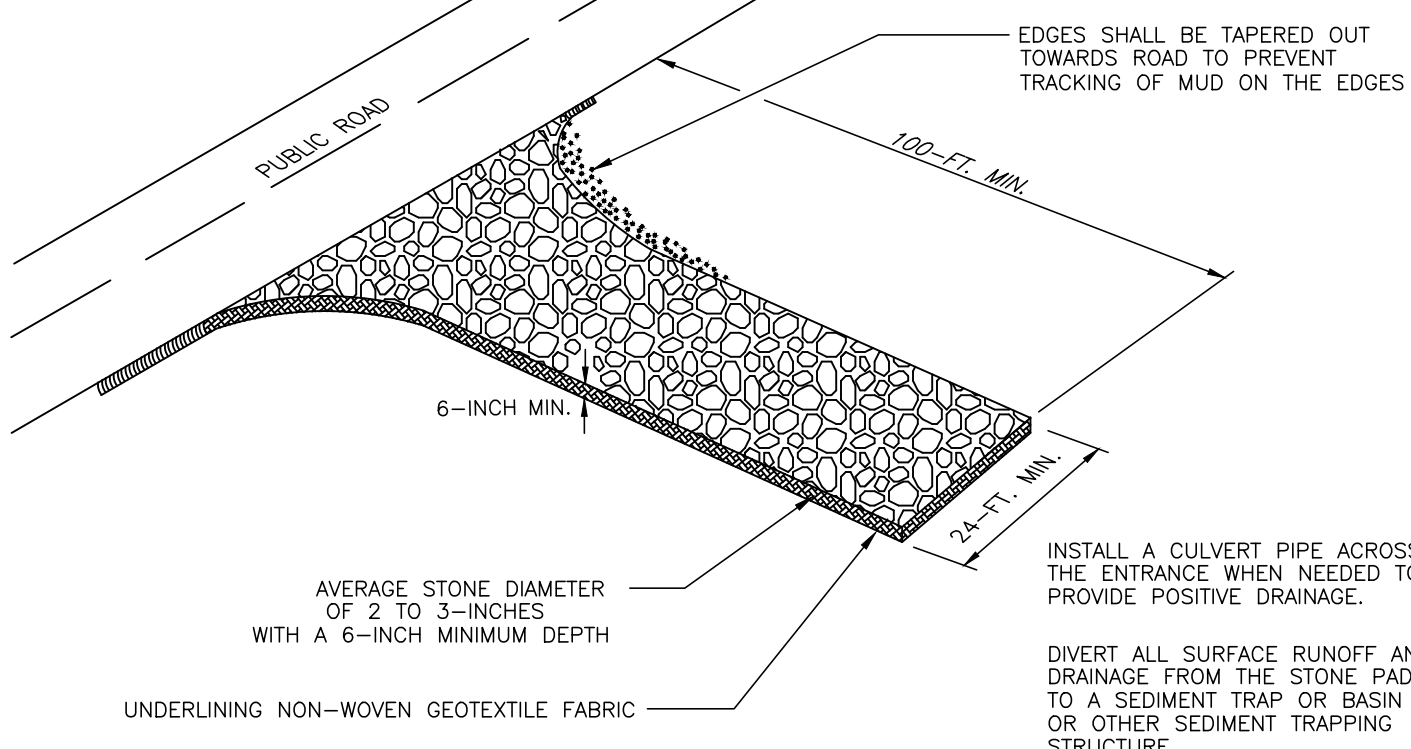

STABILIZED CONSTRUCTION ENTRANCE

NOT TO SCALE

INSPECTION AND MAINTENANCE OF CONSTRUCTION ENTRANCE

ALL SEDIMENT AND EROSION CONTROL DEVICES SHALL BE INSPECTED AT LEAST ONCE EVERY SEVEN (7) CALENDAR DAYS AND WITHIN 24 HOURS OF THE END OF A STORM EVENT OF 0.5 INCHES OR GREATER, OR AFTER HEAVY USE. CHECK FOR MUD AND SEDIMENT BUILDUP AND PAD INTEGRITY. MAKE DAILY INSPECTIONS DURING PERIODS OF WET WEATHER. MAINTENANCE IS REQUIRED MORE FREQUENTLY IN WET WEATHER CONDITIONS. RESHAPE THE STONE PAD AS NEEDED FOR DRAINAGE AND RUNOFF CONTROL.

WASH OR REPLACE STONES AS NEEDED AND AS DIRECTED BY THE INSPECTOR. THE STONE IN THE ENTRANCE SHOULD BE WASHED OR REPLACED WHENEVER THE ENTRANCE FAILS TO REDUCE MUD BEING CARRIED OFF-SITE BY VEHICLES. FREQUENT WASHING WILL EXTEND THE USEFUL LIFE OF STONE.

IMMEDIATELY REMOVE MUD AND SEDIMENT TRACKED OR WASHED ONTO PUBLIC ROADS BY BRUSHING OR SWEEPING. FLUSHING SHOULD ONLY BE USED WHEN THE WATER CAN BE DISCHARGED TO A SEDIMENT TRAP OR BASIN.

REPAIR ANY BROKEN PAVEMENT IMMEDIATELY.

University of South Carolina
Columbia, South Carolina

GREEK VILLAGE STUDENT
PARKING DEVELOPMENT
PROJECT # H27-Z414

COLUMBIA
SOUTH CAROLINA

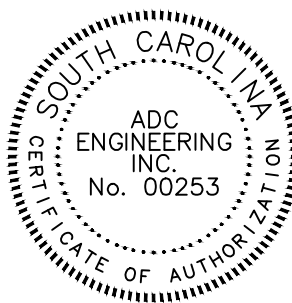

3/15/2020



7436 BROAD RIVER ROAD, SUITE 212
IRMO, SC 29063
803-781-3141
ADCENGINEERING.COM



CONTRACTOR SHALL CONTACT 811
(1-888-721-7877) FOR LOCATIONS OF ALL
UTILITIES AT LEAST 72 HOURS PRIOR TO
BEGINNING CONSTRUCTION.

DATE: 03/13/2020

ADC PROJECT #: 20002-00

DESIGNED: RBT

CHECKED: RBT

DRAWN: RPL

REVISION: 100% CD Review

SEDIMENT AND EROSION CONTROL PLAN

C4.1

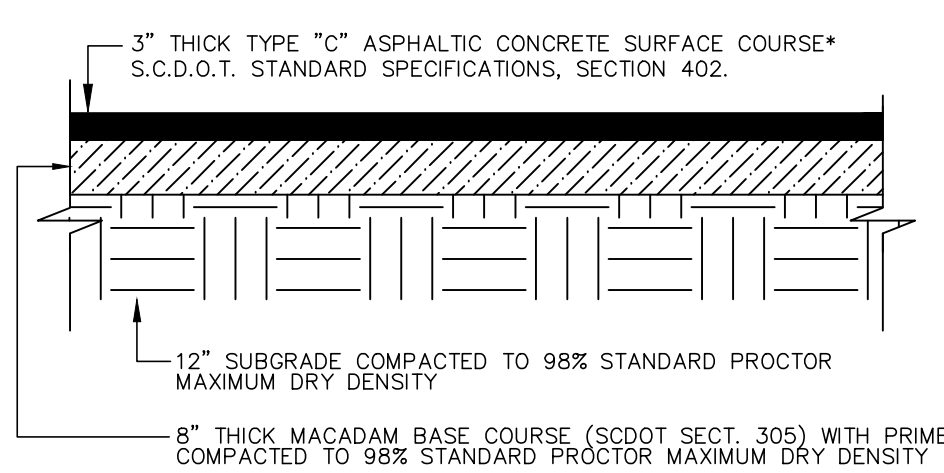

1
C5.1 **HEAVY DUTY ASPHALT PAVEMENT**
NOT TO SCALE

*INSTALL IN TWO 1.5" LIFTS
NOTE: INTENDED FOR USE WITHIN SCDOT R/W

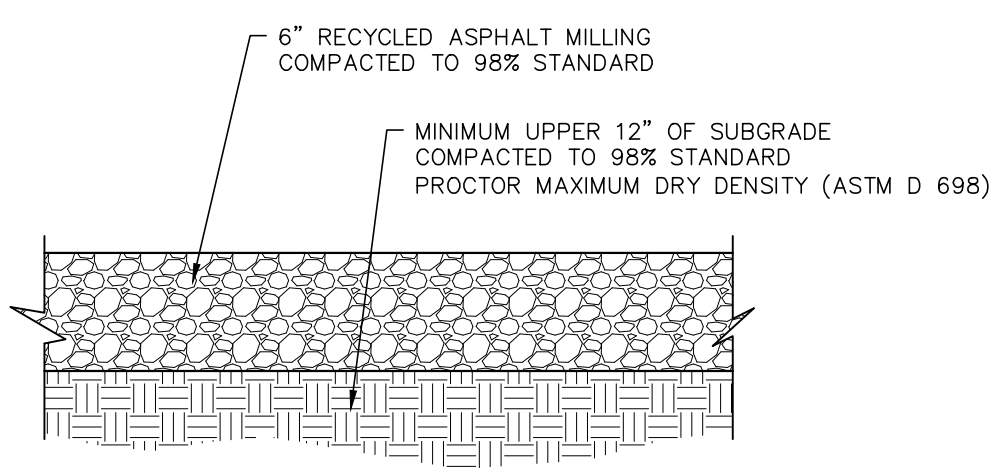

2
C5.1 **RECYCLED ASPHALT**
NOT TO SCALE

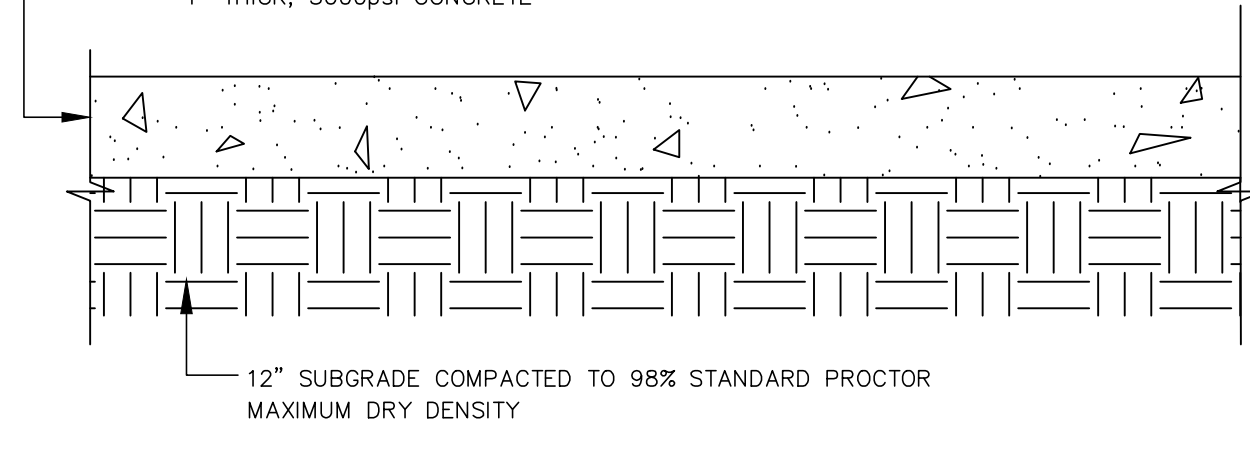

3
C5.1 **LIGHT DUTY CONCRETE**
NOT TO SCALE

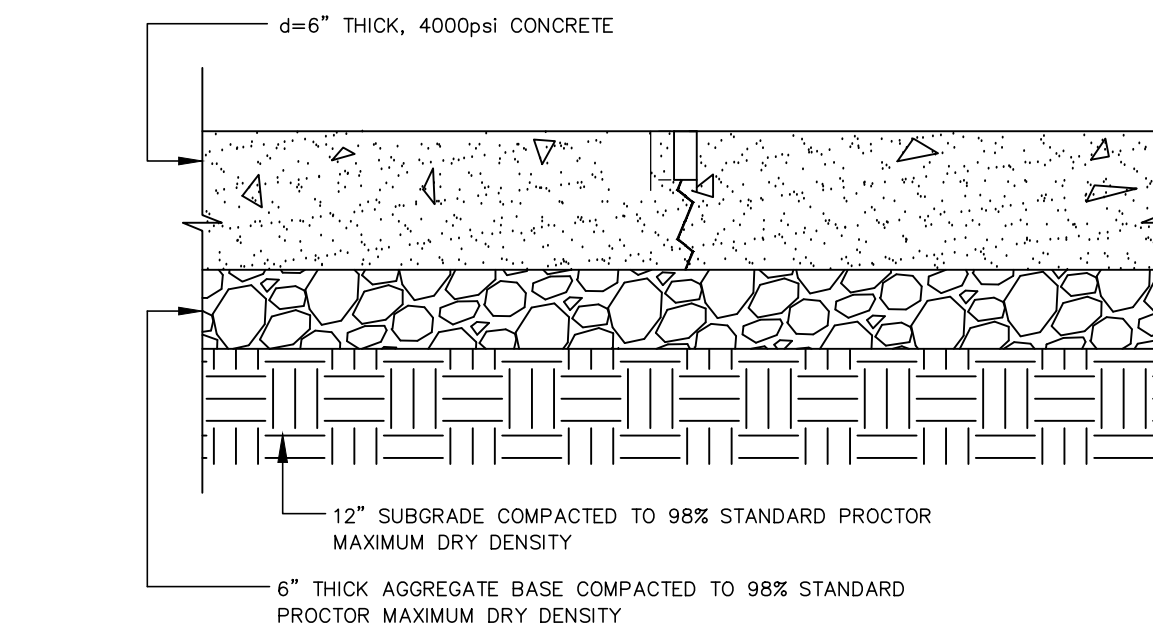

4
C5.1 **HEAVY DUTY CONCRETE PAVEMENT W/ SCORE JOINT**
NOT TO SCALE

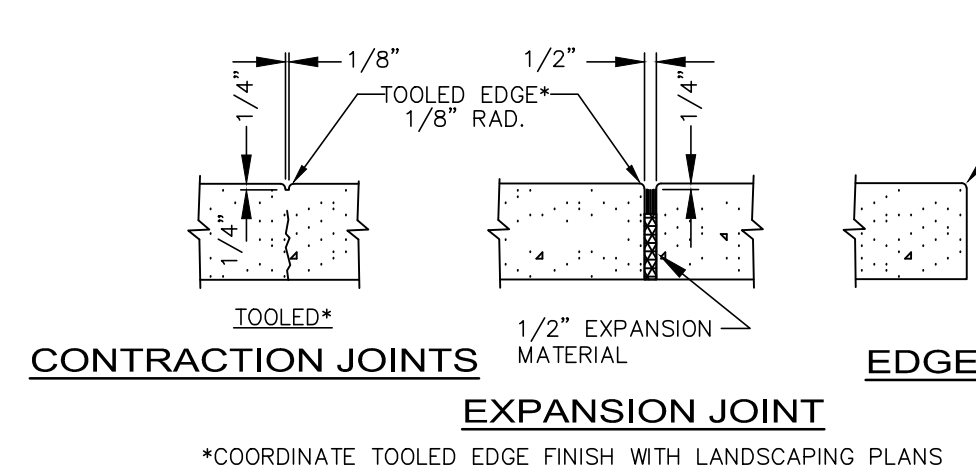

5
C5.1 **CONCRETE SIDEWALK JOINTS**
NOT TO SCALE

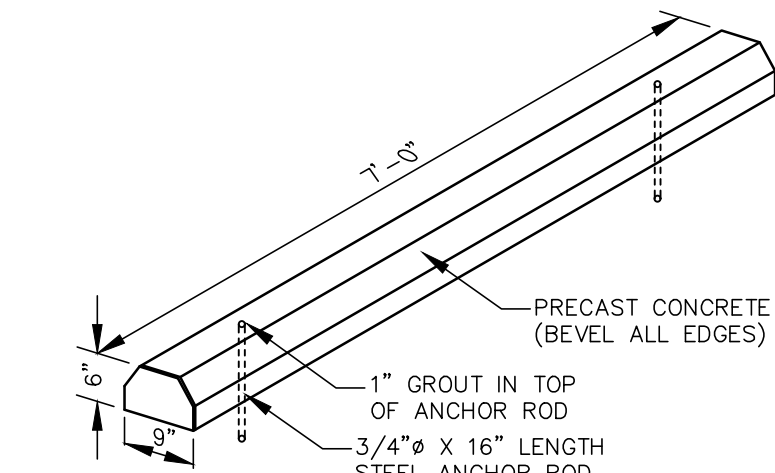

6
C5.1 **PRECAST CONCRETE WHEELSTOP**
NOT TO SCALE

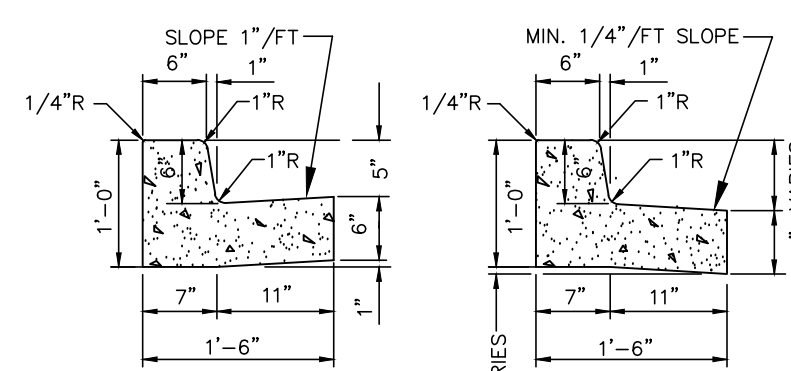

NORMAL GUTTER **PITCHED GUTTER**

- NOTES:**
1. CURB AND GUTTER TO BE CONSTRUCTED IN 10-FOOT LENGTHS.
 2. PROVIDE 1/2 INCH EXPANSION JOINT MATERIAL AT INTERVALS NOT TO EXCEED 100 FEET, AT THE ENDS AND MID-POINT OF RETURNS, AND AT ANY LOCATION WHERE THE NEW CURB AND GUTTER ABUTS OTHER CONCRETE STRUCTURES.
 3. PROVIDE A 5' LONG TRANSITION BETWEEN NORMAL GUTTER AND PITCHED GUTTER UNLESS OTHERWISE INDICATED ON PLANS.

7
C5.1 **CONCRETE CURB & GUTTER**
SCALE: 3/4" = 1'-0"

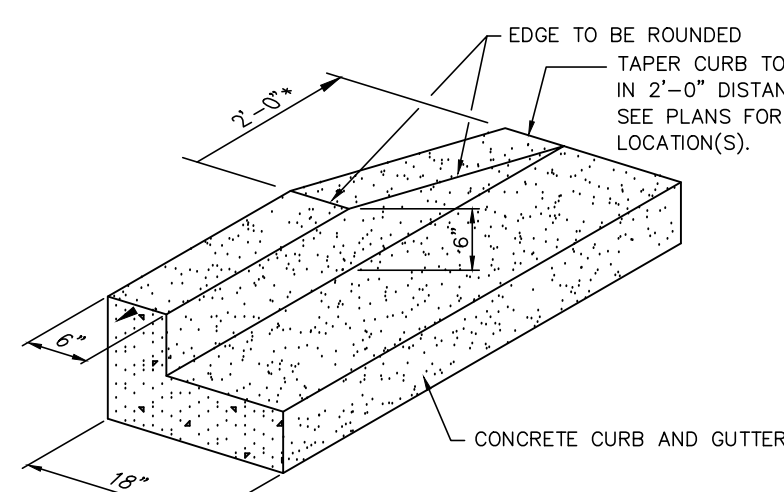

8
C5.1 **TAPERED CURB & GUTTER**
NOT TO SCALE

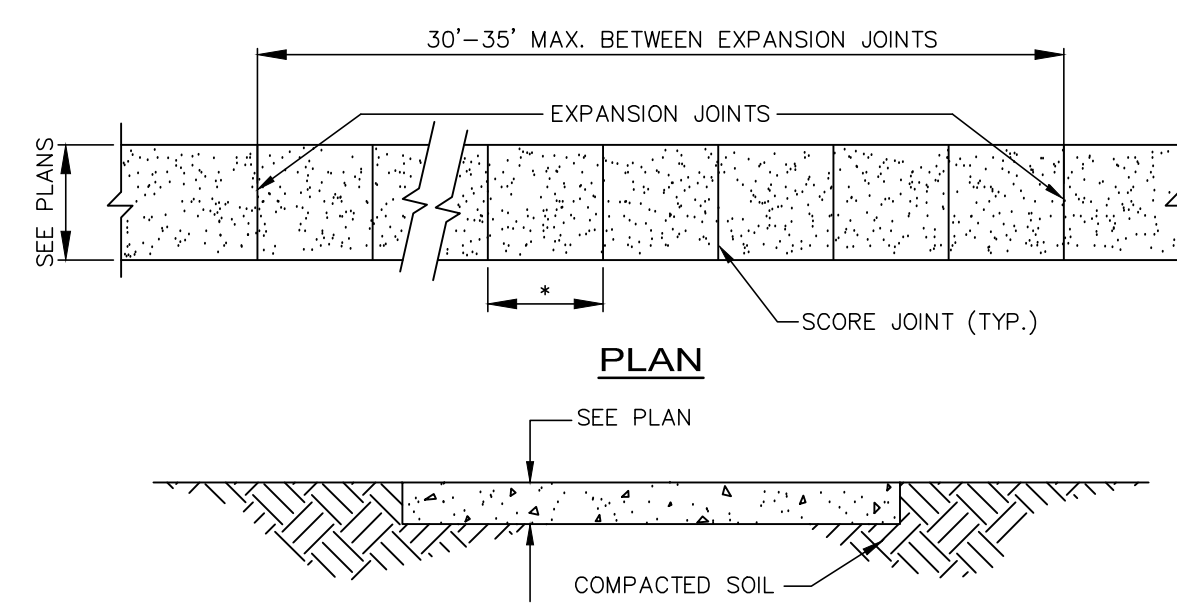

9
C5.1 **CONCRETE SIDEWALK**
SCALE: 1" = 1'-0"

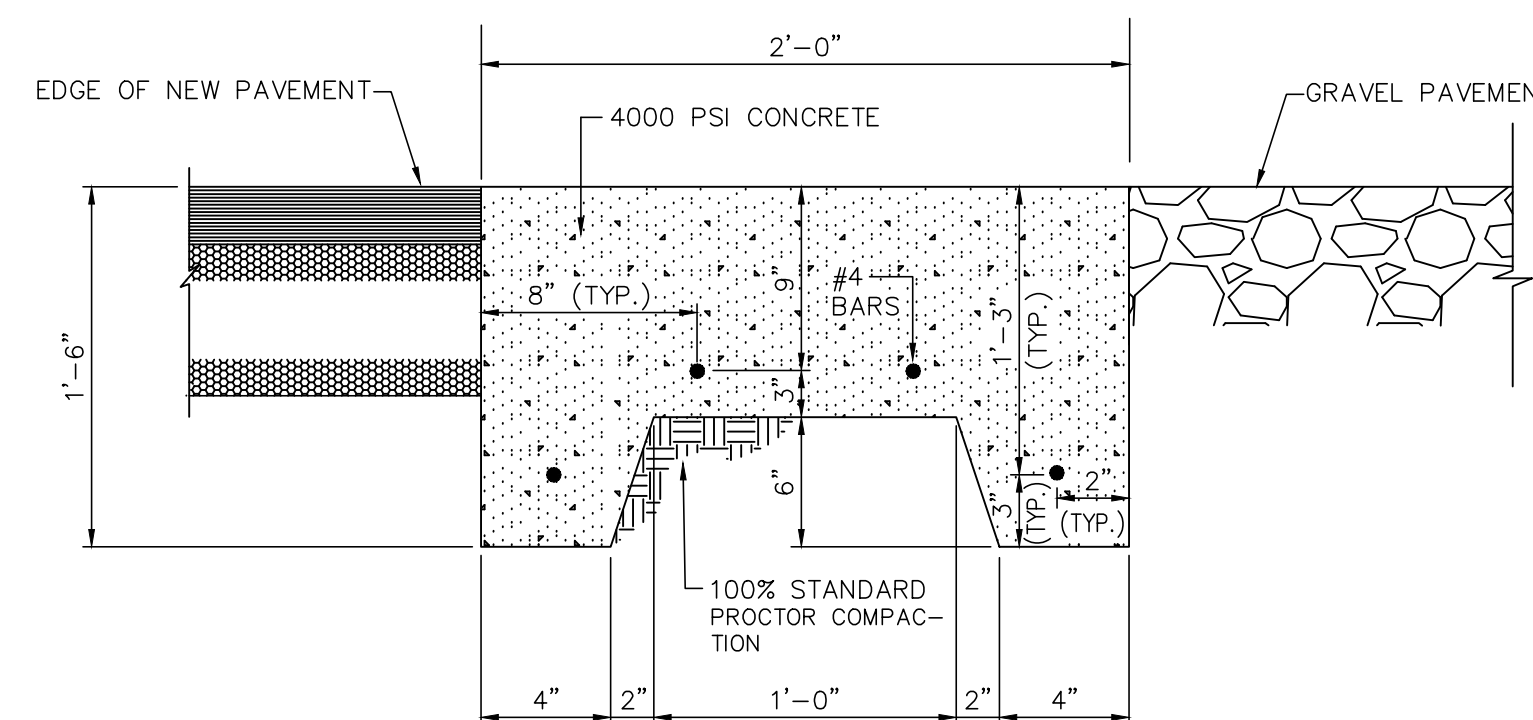

10
C5.1 **CONCRETE KEY**
NOT TO SCALE

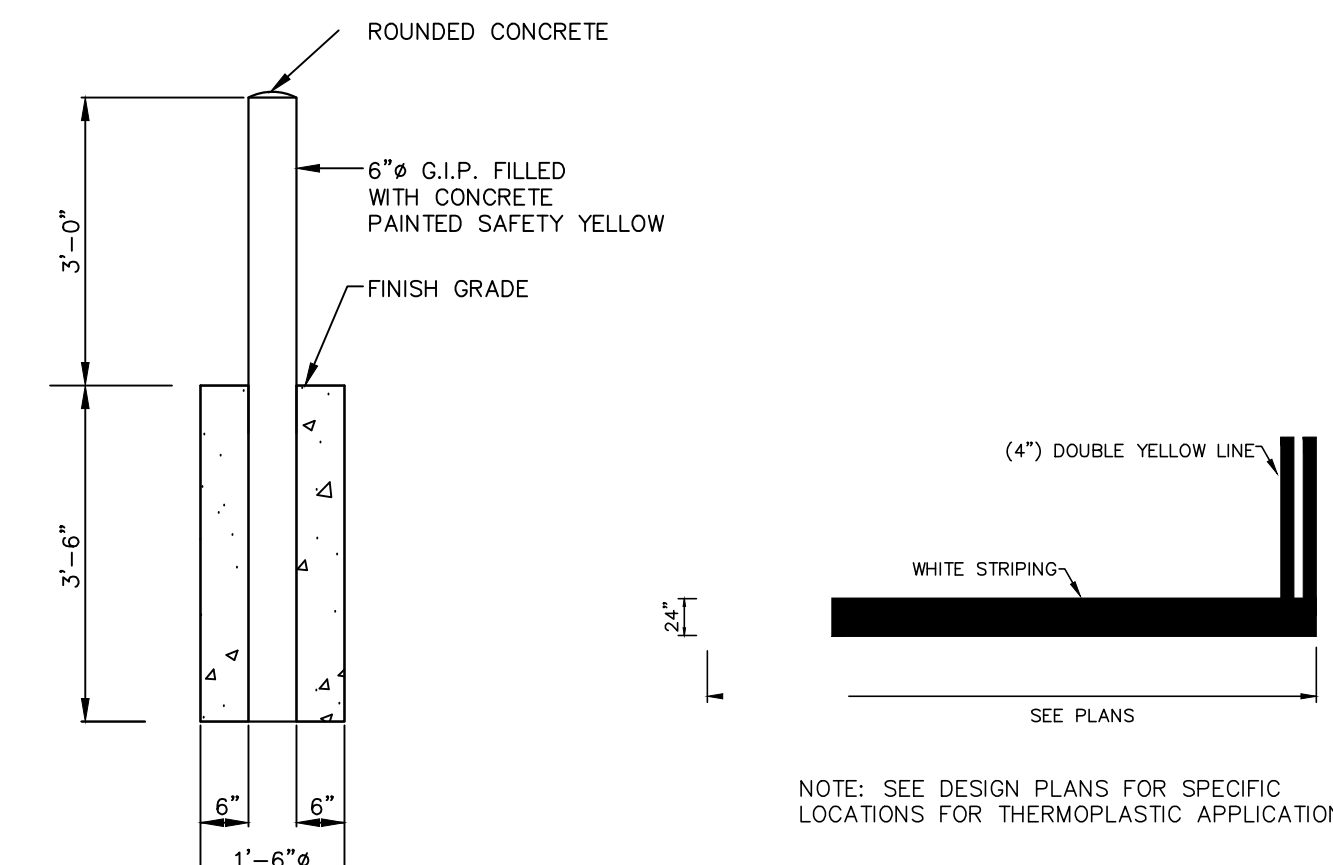

11
C5.1 **BOLLARD**
NO SCALE

12
C5.1 **STOP BAR**
NOT TO SCALE

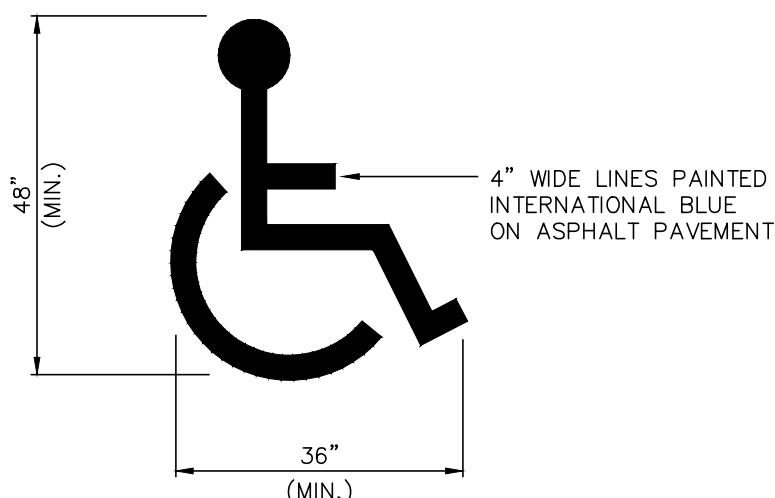

HANDICAP PARKING PAINTED SYMBOL DETAIL

13
C5.1 **HANDICAP ACCESSIBLE PARKING STALLS**
NOT TO SCALE

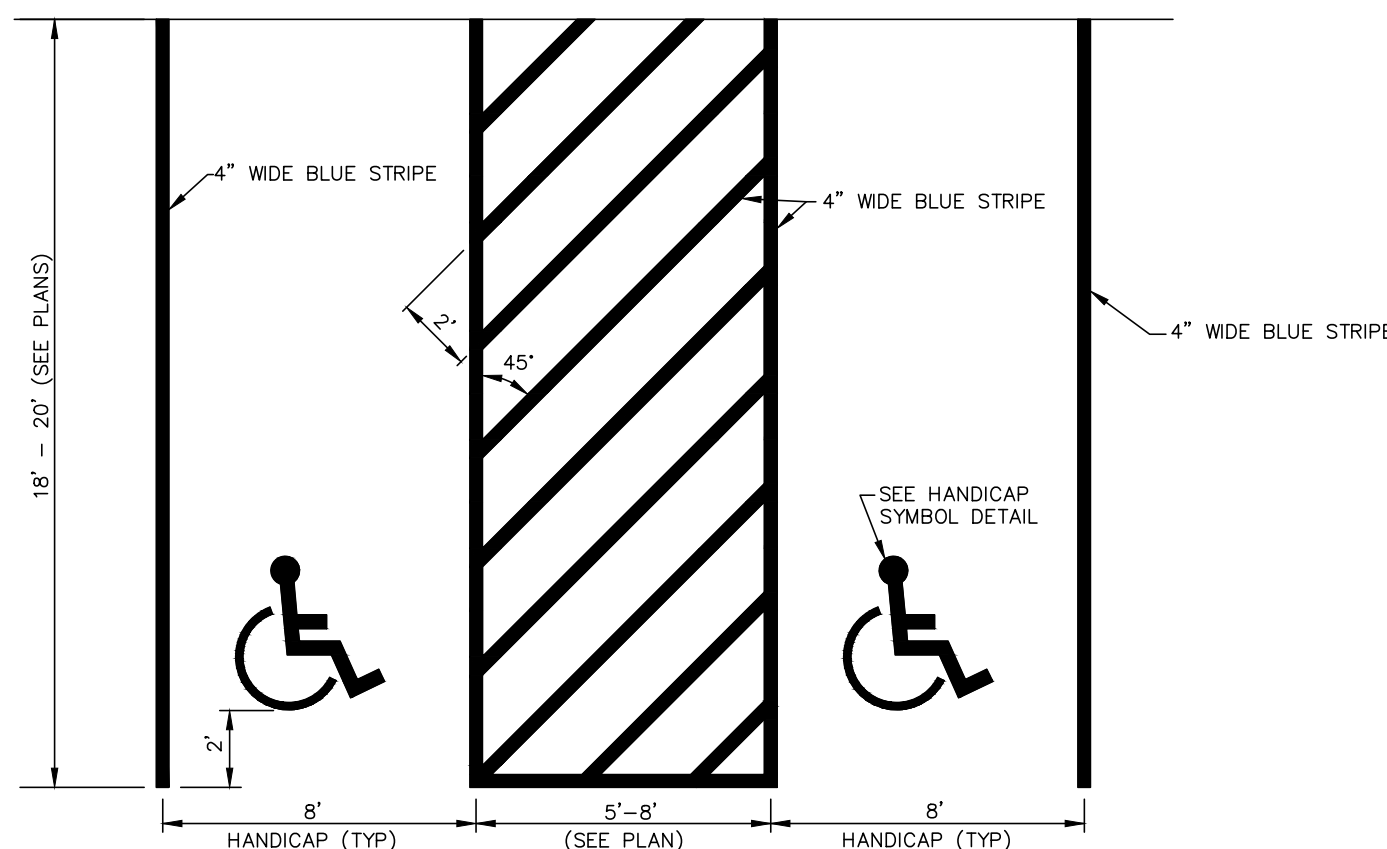

14
C5.1 **HANDICAP ACCESSIBLE PARKING STALLS**
NO SCALE

- NOTES:**
1. ALL STRIPING SHALL BE PERFORMED BY CONTRACTOR USING TRAFFIC MARKING PAINT. PAINT SHALL BE SHERWIN-WILLIAMS "PRO-MAR" TRAFFIC MARKING PAINT OR GLODDEN TRAFFIC MARKING PAINT AND SHALL BE APPLIED IN TWO COATS AND IN STRICT ACCORDANCE WITH THE MANUFACTURER'S INSTRUCTIONS. ALL STRIPING ASSOCIATED WITH HANDICAP PARKING SHALL BE 4" WIDE (BLUE).
 2. SEE PLANS FOR SPECIFIC LOCATION AND DIMENSIONS.

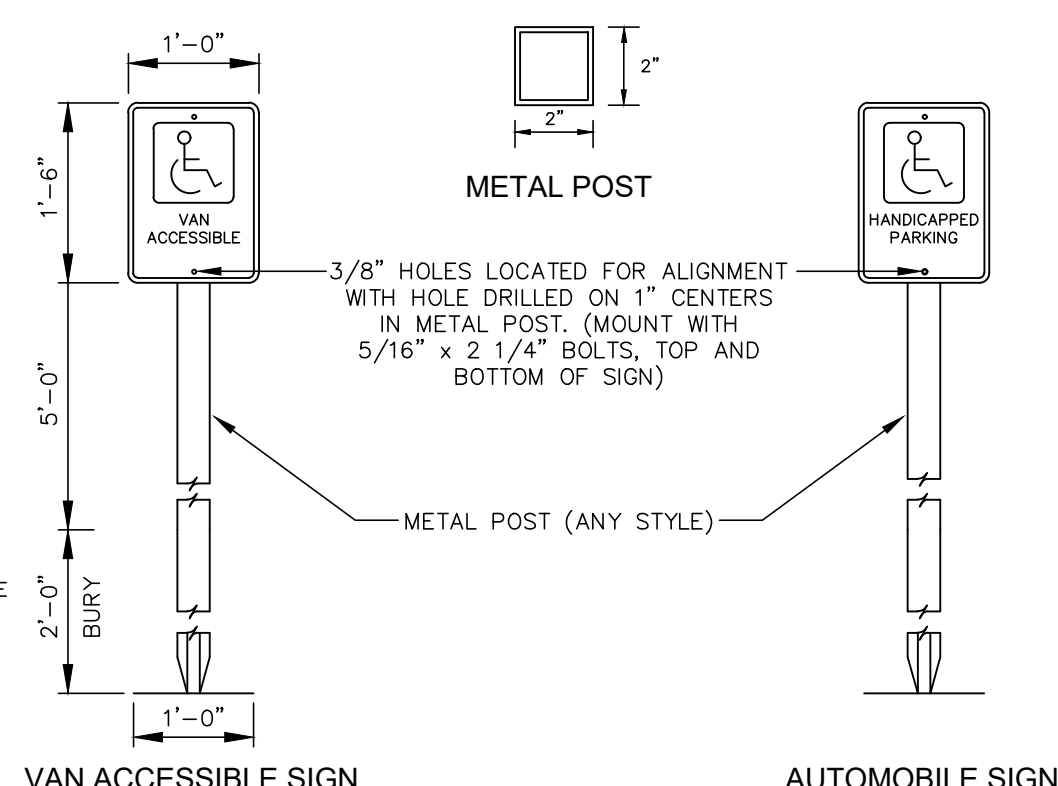

- NOTES:**
1. METAL POST TO BE 2"x2" GALVANIZED WITH 1/2" HOLES, 1" ON CENTER. ALL BOLTS, NUTS, WASHERS, AND SCREWS MUST BE RUSTPROOF. (POST MAY BE ANY STYLE.)
 2. SIGNS WILL BE FABRICATED BY USING A REFLECTING COATING IN THE SYMBOL, MESSAGE, AND BORDERS APPLIED TO A SHEET ALUMINUM BACKING (0.80 IN THICKNESS).
 3. MESSAGE LETTERING SHALL BE UPPERCASE (WHITE, SERIES B) IN ACCORDANCE WITH MANUAL ON UNIFORM TRAFFIC CONTROL DEVICES.
 4. THE SYMBOL IS COMPOSED OF TWO ELEMENTS: A WHITE WHEELCHAIR FIGURE (WHICH SHOULD ALWAYS FACE RIGHT) ON A SQUARE BACKGROUND, INTERNATIONAL BLUE IN COLOR (STD. 595A, COLOR #15180).
 5. SIGN POST SHALL BE MINIMUM OF 2'-0" CLEAR FROM BACK OF SIDEWALK. SEE PLANS FOR LOCATION OF SIGNS.
 6. BASIS OF DESIGN: ITEM 14503 FOR "VAN ACCESSIBLE" SIGN AND 14543B FOR "HANDICAP PARKING" SIGN BY SAFETYSIGN.COM

15
C5.1 **HANDICAP SIGN**
NOT TO SCALE

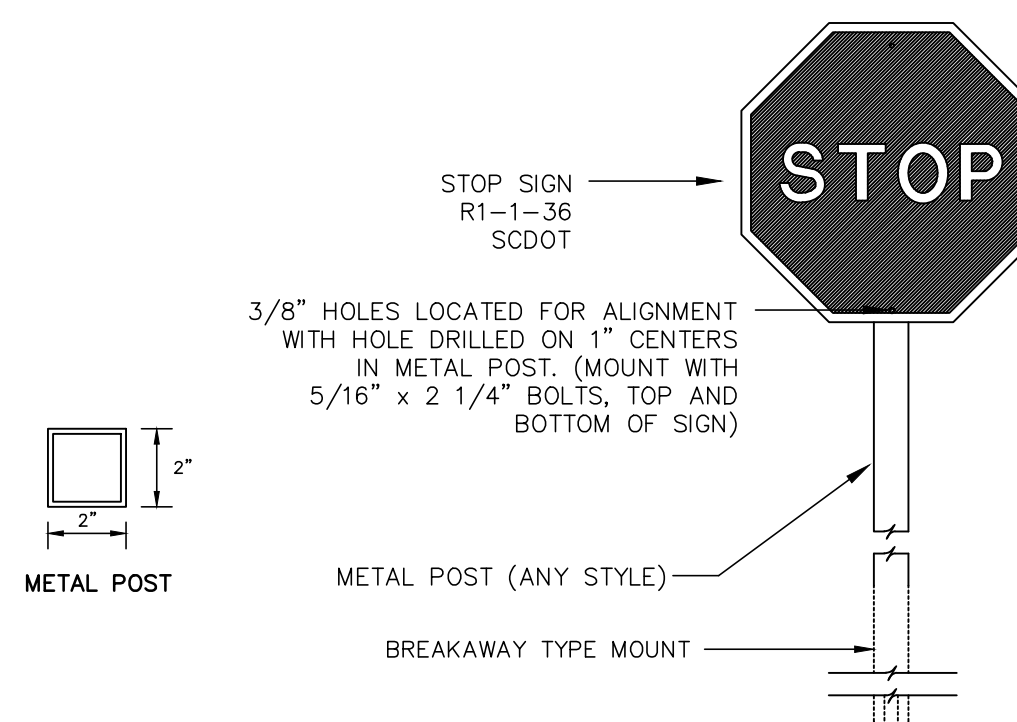

- NOTES:**
1. METAL POST TO BE 2"x2" GALVANIZED WITH 1/2" HOLES, 1" ON CENTER. ALL BOLTS, NUTS, WASHERS, AND SCREWS MUST BE RUSTPROOF. (POST MAY BE ANY STYLE.)
 2. CONCRETE FOR FOOTING SHALL BE OF PORTLAND CEMENT AND HAVE A MINIMUM COMPRESSIVE STRENGTH OF 3,000psi.
 3. SIGNS WILL BE FABRICATED BY USING A REFLECTING COATING IN THE SYMBOL, MESSAGE, AND BORDERS APPLIED TO A SHEET ALUMINUM BACKING (0.80 IN THICKNESS).
 4. MESSAGE LETTERING SHALL BE UPPERCASE (WHITE, SERIES B) IN ACCORDANCE WITH MANUAL ON UNIFORM TRAFFIC CONTROL DEVICES.
 5. SIGN TO BE MOUNTED ON BREAKAWAY TYPE MOUNT.

16
C5.1 **STOP SIGN**
NOT TO SCALE

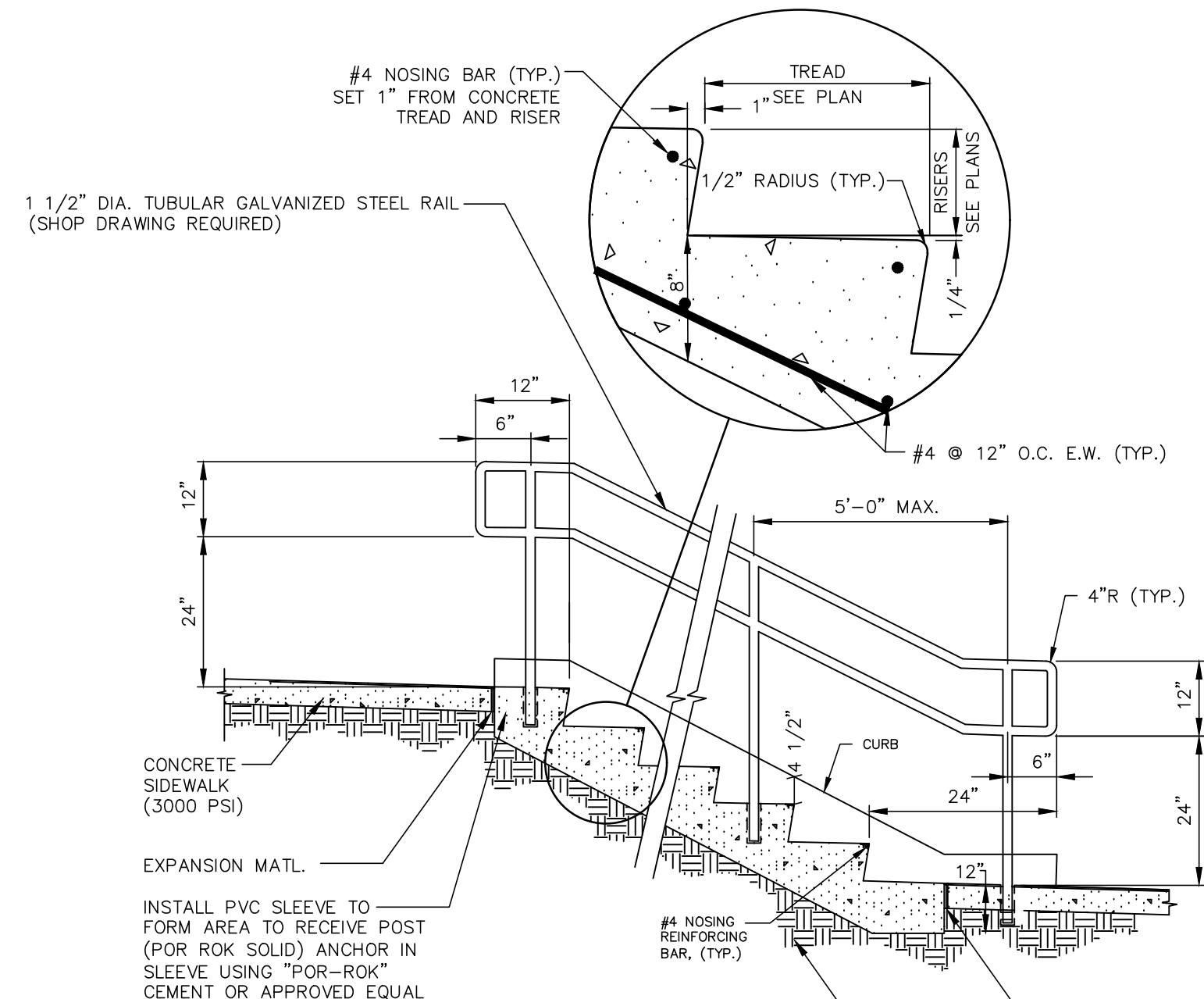

- NOTES:**
1. ALL HANDRAILS AND STEPS TO MEET ALL STANDARD BUILDING CODES AND A.D.A. REQUIREMENTS AND REGULATIONS.
 2. HANDRAILS TO BE INSTALLED AS SHOWN ON DRAWINGS.
 3. CENTERLINE OF POSTS SHALL BE 4" FROM EDGE OF STAIRS.
 4. HANDRAIL TO BE INSTALLED IN CURB.
 5. NUMBER OF STEPS VARIES. SEE PLAN.

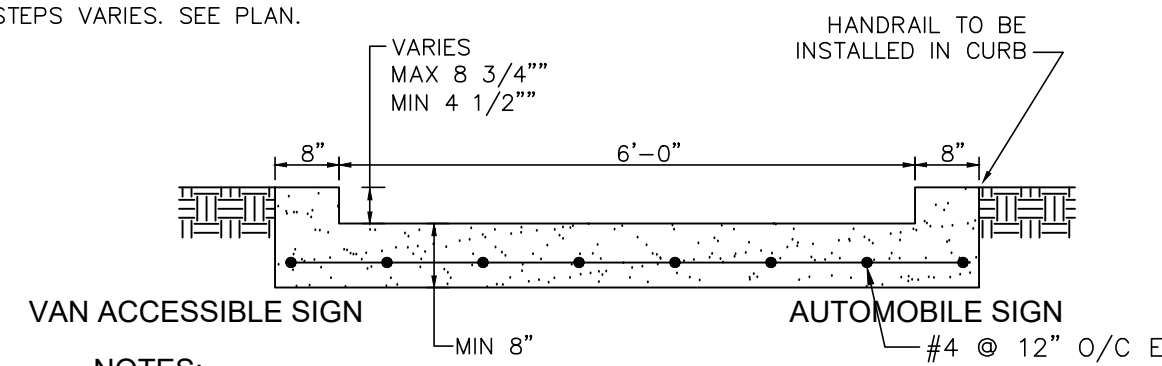

17
C5.1 **CONCRETE STEPS AND HANDRAIL**
NOT TO SCALE

University of South Carolina
Columbia, South Carolina

GREEK VILLAGE STUDENT
PARKING DEVELOPMENT
PROJECT # H27-Z414

COLUMBIA
SOUTH CAROLINA

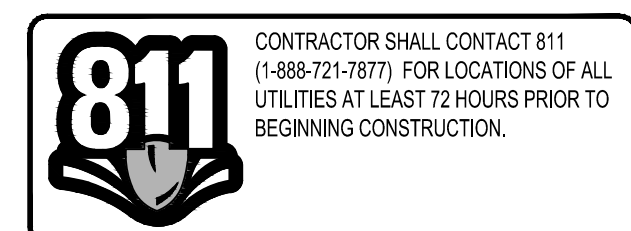
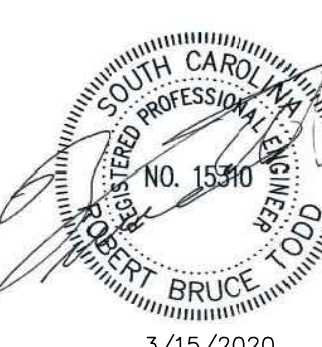
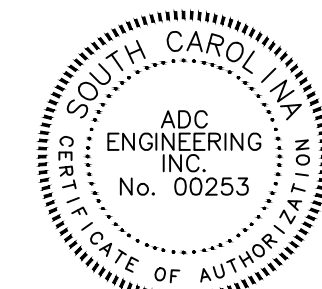

DATE:	03/13/2020
ADC PROJECT #:	20002.00
DESIGNED:	RBT
CHECKED:	RBT
DRAWN:	RPL
REVISION:	100% CD Review

MISC. DETAILS

C5.1

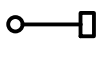
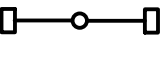
LIGHTING FIXTURE SCHEDULE							
SYMBOL	TYPE	DESCRIPTION	MANUFACTURER	MODEL NUMBER	MOUNTING	VOLTS	(L)UMENS / (W)ATTS / COLOR TEMP
	V1	LED AREA LIGHTING FIXTURE (SINGLE HEAD)	HUBBELL OD LTG.	ASL-A-16L-4K-210-3-208-DB-7PR-RPA	25' POLE	208V	18,000L / 170W / 4000K
	V2	LED AREA LIGHTING FIXTURES (DOUBLE HEAD - 180 DEGREES)	HUBBELL OD LTG.	(TWO) ASL-A-16L-4K-210-3-208-DB-7PR-RPA	25' POLE	208V	18,000L / 170W / 4000K
	POLE	25' (ABOVE GRADE) DIRECT BURIED FIBERGLASS POLE	ALLIANCE COMPOSITE UNITED LTG STANDARDS	DS30FSDN2 RTF-25-40-EMB-BRONZE			

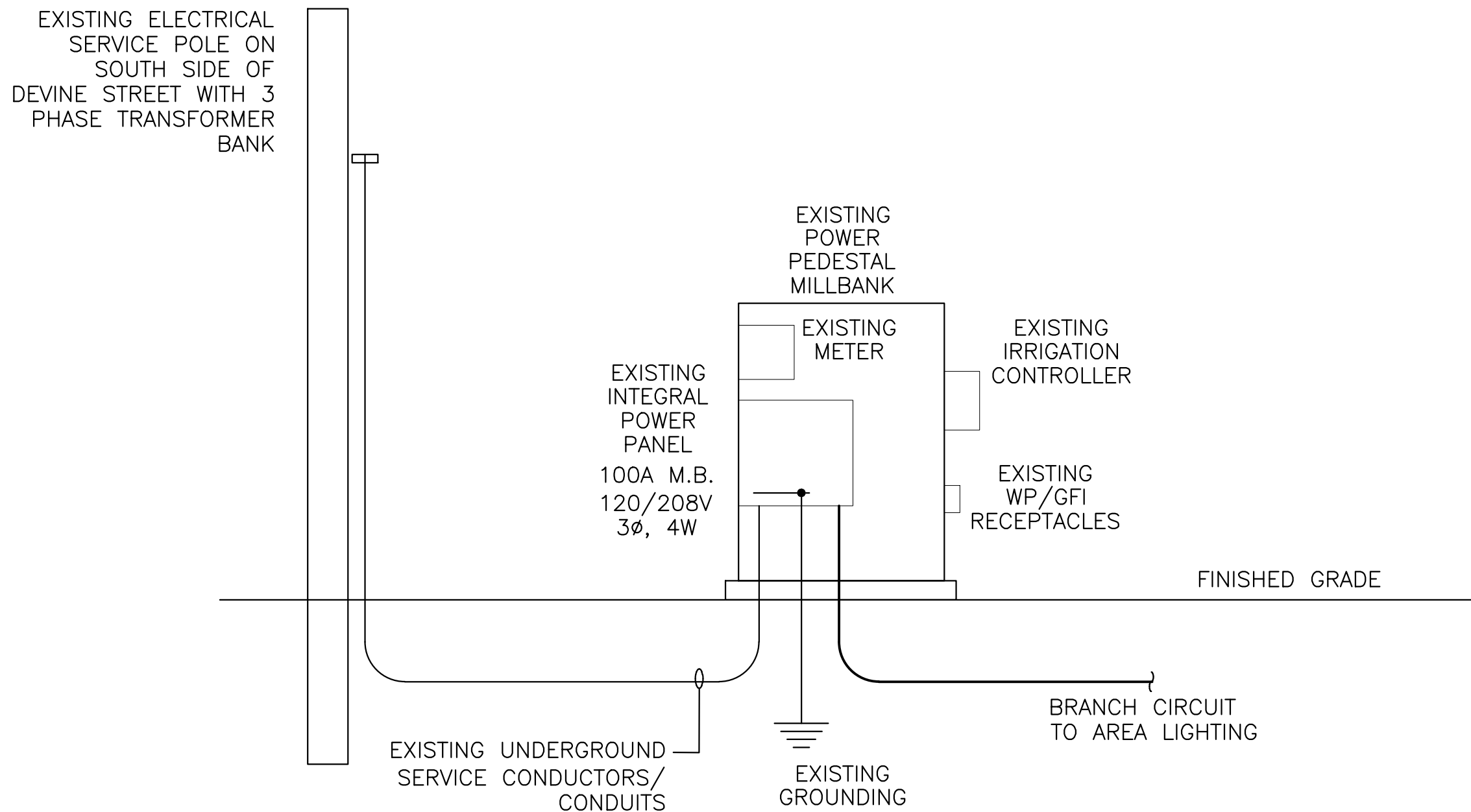
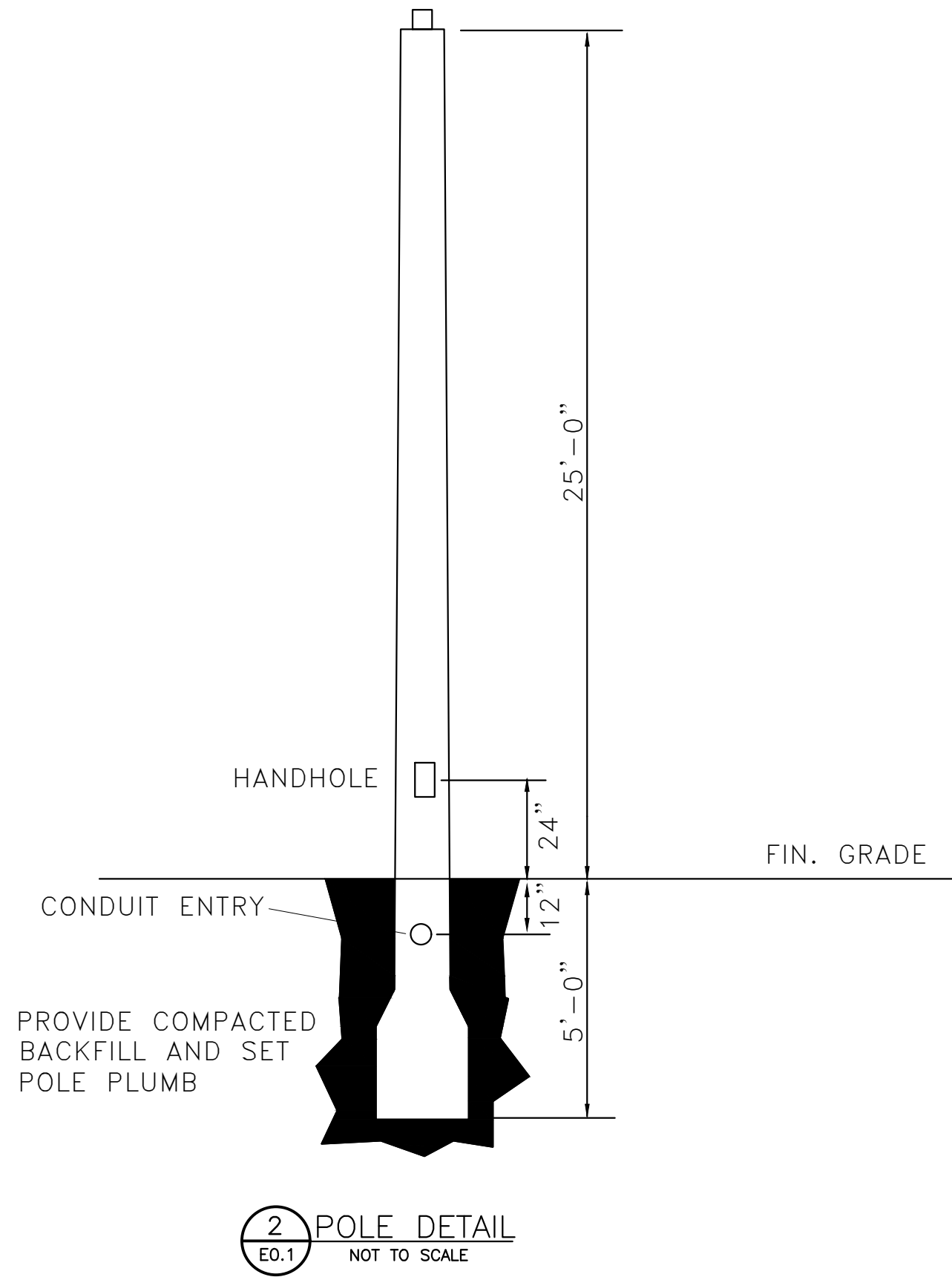

1 ELECTRICAL SINGLE-LINE DIAGRAM
E0.1 NOT TO SCALE

ELECTRICAL DRAWING INDEX	
E0.1	ELECTRICAL DETAILS AND SCHEDULES
E0.2	ELECTRICAL SITE PLAN

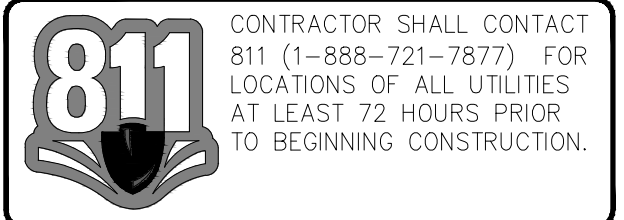
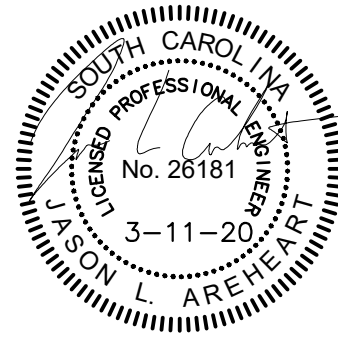
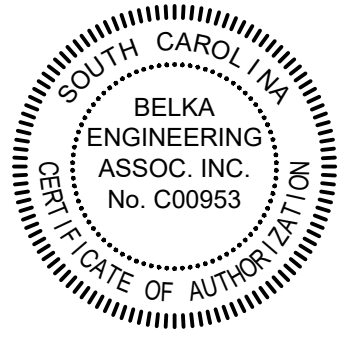

DATE:	03/13/2020
ADC PROJ#:	20002.00
DESIGNED:	CES
CHECKED:	JLA
DRAWN:	DMS
REVISION:	100% CD Review

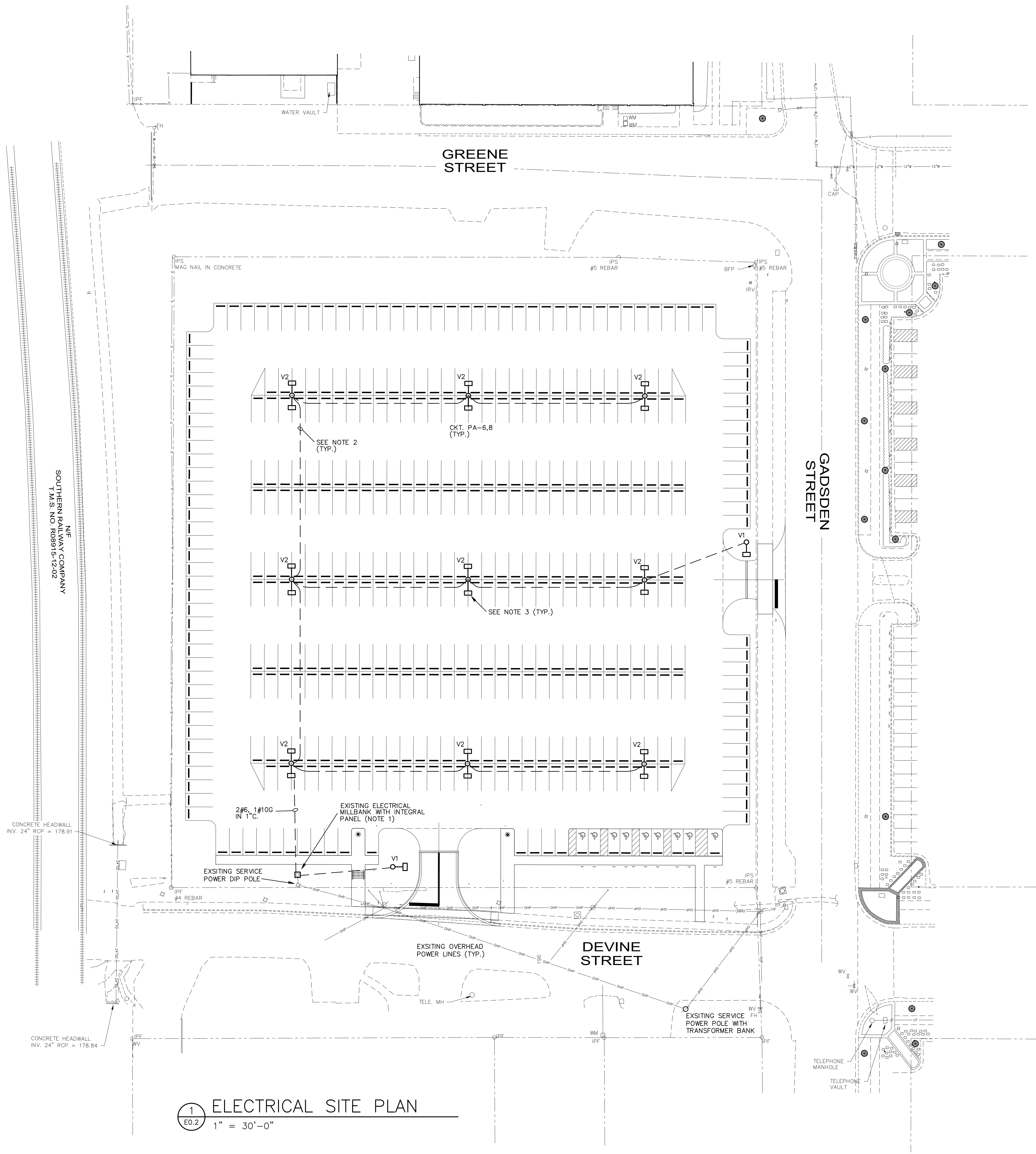

- ELECTRICAL NOTES
1. PROVIDE 30 AMP, 2 POLE BREAKER IN EXISTING POWER PEDESTAL PANEL "PA". SEE POWER SINGLE LINE DIAGRAM AND PANEL SCHEDULE ON DRAWING E0.1.
 2. PROVIDE 2#10, 1#10G, IN 1" C. (SCHEDULE 40 PVC) FOR ALL RUNS SHOWN ON THIS DRAWING UNLESS NOTED OTHERWISE. THE SITE HAS MANY EXISTING BURIED OBJECTS AND UNDERGROUND BUILDING FOUNDATIONS THAT MAY CONFLICT WITH CONDUIT ROUTING. PROVIDE NEC MINIMUM COVER OF 18 INCHES. NOTIFY USC PROJECT MANAGER IMMEDIATELY IF OBSTRUCTIONS CANNOT BE WORKED AROUND.
 3. PROVIDE DIRECT BURIED POLES AND AREA LIGHTING FIXTURES. SEE DRAWING E0.1 FOR LIGHTING FIXTURE SCHEDULE. FIXTURES AND POLES SHALL MATCH IN FINISH COLOR (DARK BRONZE). FIXTURES SHALL BE CONTROLLED WITH PHOTOCELL INTEGRAL TO EACH FIXTURE.
 4. ELECTRICAL LAYOUT DRAWINGS ARE DIAGRAMMATIC FOR CLARITY. EAST-WEST CONDUIT RUNS SHALL BE STRAIGHT FROM POLE TO POLE, BETWEEN TIRE STOPS. ADDITIONAL GRAVEL SHALL BE ADDED TO ACHIEVE MINIMUM COVER AS REQUIRED. COORDINATE ALL WORK WITH CIVIL DRAWINGS.
 5. COORDINATE CONDUIT INSTALLATION WITH OTHER UNDERGROUND UTILITIES. OBTAIN SERVICES OF AN UNDERGROUND UTILITY LOCATOR BEFORE DIGGING.
 6. COORDINATE EXACT LOCATION OF LIGHTING POLES/FIXTURES WITH PARKING LOT LAYOUT BEFORE INSTALL. LOCATE POLES IN LOCATIONS TO MINIMIZE POTENTIAL DAMAGE.
 7. UNDERGROUND CONDUIT SHALL BE SCHEDULE 40 PVC WITH LONG SWEEP RGS ELBOWS. ABOVE GRADE CONDUITS SHALL BE RGS.
 8. INSTALL POLES PLUMB AND ATTACH FIXTURES WITH MANUFACTURER RECOMMENDED BRACKETS. PROVIDE COVERS ON ALL OPENINGS ON POLE. PROVIDE FUSING ("HEB" TYPE FUSEHOLDERS WITH "FNB" TYPE 208V FUSES).
 9. ALL CONDUCTORS SHALL BE 600V RATED, THHN/THWN-2 INSULATED COPPER, AND INSTALLED IN SCHEDULE 40 PVC CONDUITS. PROVIDE RGS ELBOWS. ALL SPLICES SHALL BE INSIDE POLES AND SHALL BE WEATHERPROOF BUTT TYPE.

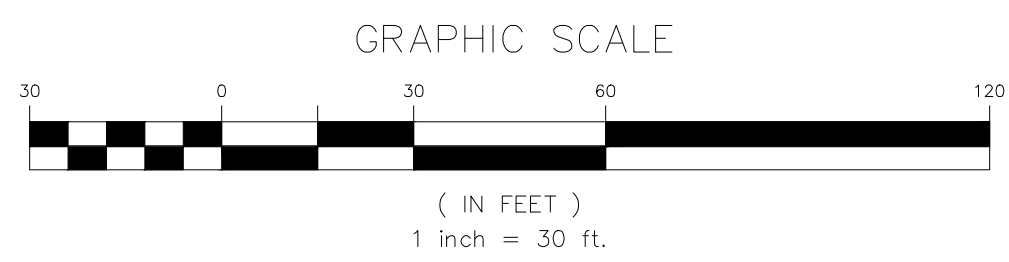

BELKA
ENGINEERING ASSOCIATES

7 CLUSTERS COURT, SUITE 201 | COLUMBIA, SC
(803) 731-0650 Office | (803) 960-6443 Cell
CONTACT: CLIFF STRINGFIELD
CSTRINGFIELD@BEA-Consulting.com

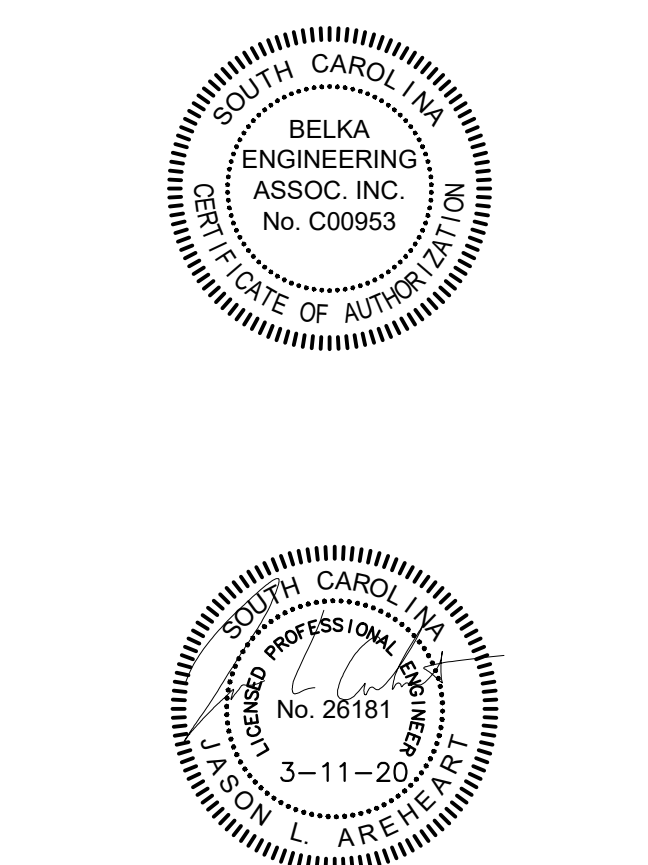

ADC
ENGINEERING

7436 BROAD RIVER ROAD, SUITE 212
IRMO, SC 29063
803-781-3141
ADCENGINEERING.COM

811

CONTRACTOR SHALL CONTACT 811 (1-888-721-7877) FOR LOCATIONS OF ALL UTILITIES AT LEAST 72 HOURS PRIOR TO BEGINNING CONSTRUCTION.

DATE:	03/13/2020
ADC PROJ#:	20002.00
DESIGNED:	CES
CHECKED:	JLA
DRAWN:	DMS
REVISION:	

ELECTRICAL SITE PLAN

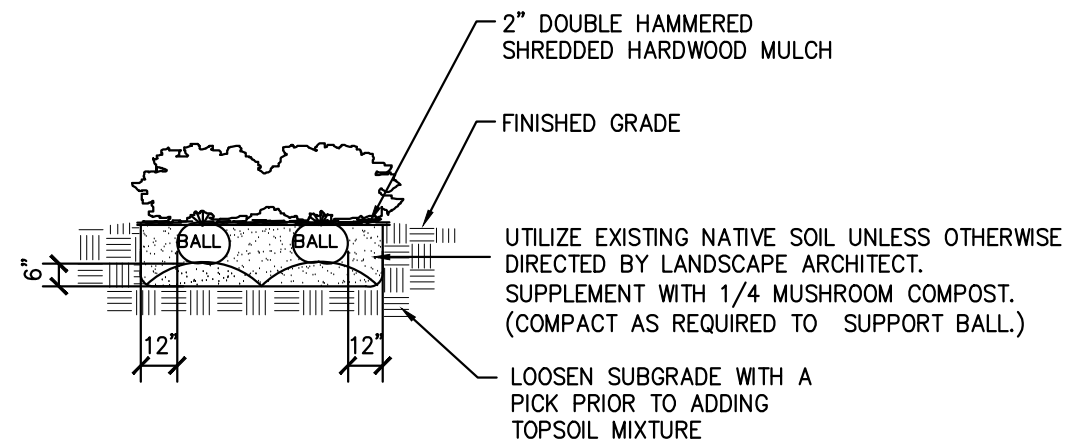
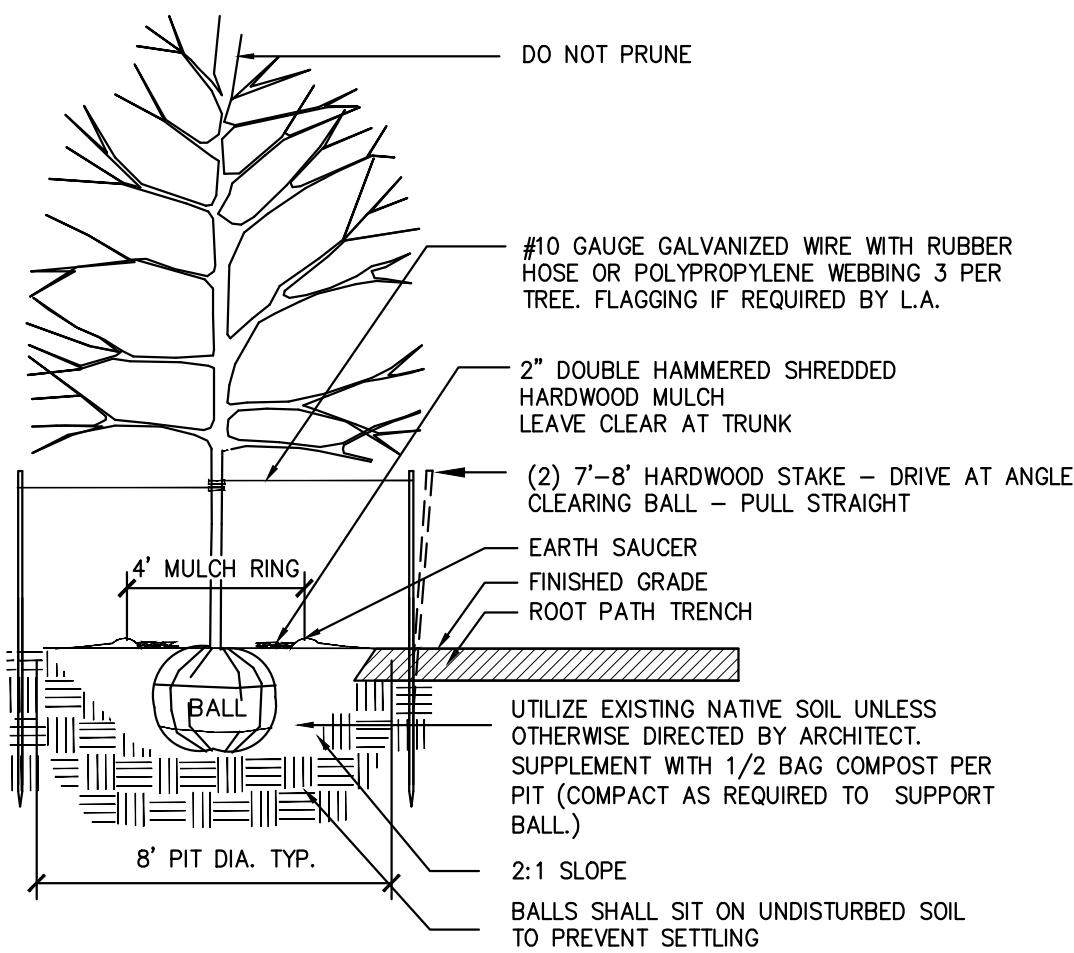

- NOTES:
1. TEST FOR PERCOLATION PRIOR TO PLANTING.
 2. REMOVE PAPER, PLASTIC OR METAL CONTAINER THAT MAY BE AROUND ROOTS
 3. WATER AFTER PLANTING
 4. DO BED PREPARATION ON ALL SHRUB & GROUNDCOVER AREAS

PLANT LIST

ABBR.	BOTANICAL NAME	COMMON NAME	CALIPER	SPREAD	MINIMUM HEIGHT	BALL DIA.	NO. CANES	COMMENTS	QTY.
QUER N	QUERCUS NUTTALLI	NUTTALL OAK	2"	6"	12-14'	36"	1	MATCHING, SPECIMEN	19
ABEL	ABELIA X 'ROSE CREEK'	'ROSE CREEK' ABELIA	18"	24"	3 GAL.	3-5		PLANT 3' O.C.	63
ILEX C	ILEX CORNUA 'CARISSA'	CARISSA HOLLY	18"	24"	3 GAL.	3-5		PLANT 3' O.C.	82

SEEDING SCHEDULE

TURF MIX #1 (PER 1,000 SF)	TURF MIX #2 (PER 1,000 SF)
HULLED BERMUDA 1 LB	HULLED BERMUDA 1 LB
BROWNTOP MILLET .25 LB	BROWNTOP MILLET .25 LB
WEeping LOVEGRASS .25 LB	10-10-10 FERTILIZER* 15 LB
10-10-10 FERTILIZER* 15 LB	
* FERTILIZER TO BE MINIMUM 50% SLOW-RELEASE NITROGEN	

A TREE PLANTING AND STAKING

L-7 SECTION

NOT TO SCALE

B SHRUB PLANTING

NOT TO SCALE

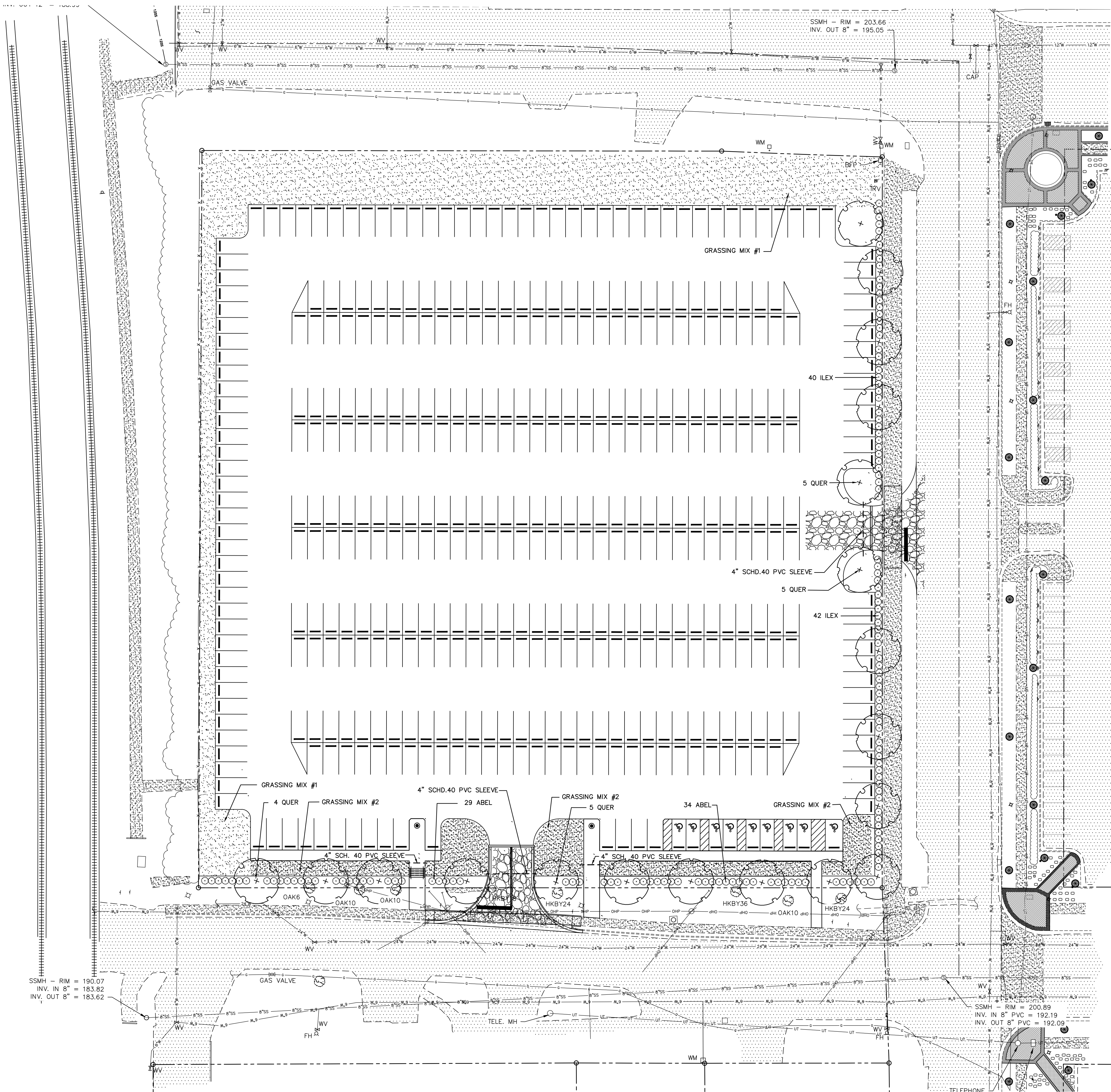

LANDSCAPE NOTES

1. EXISTING ECOLOGY AND AESTHETICS WILL OFTEN CAUSE ADJUSTMENT OF THESE PLANS TO FIT THE SITE. STAKE-OUT BY THE CONTRACTOR AND ADJUSTMENT BY THE LANDSCAPE ARCHITECT IS ABSOLUTELY NECESSARY.
2. LOCATIONS OF THOSE UTILITIES SHOWN ARE APPROXIMATE AND FOR INFORMATION PURPOSES ONLY. CONTRACTOR SHALL BE RESPONSIBLE FOR THE EXACT LOCATION OF ALL UTILITIES WHETHER SHOWN OR NOT SHOWN ON THESE PLANS, AND SHALL BE RESPONSIBLE FOR ANY AND ALL DAMAGE RESULTING FROM THE FAILURE TO DO SO. CONTACT PALMETTO UTILITY PROTECTION SERVICE AT 1-888-721-7877 AT LEAST 72 HOURS PRIOR TO COMMENCING CONSTRUCTION.
3. CONTRACTOR SHALL INFORM LANDSCAPE ARCHITECT IF PROPOSED DESIGN IS IN CONFLICT WITH EXISTING OR PROPOSED UTILITIES. CONTRACTOR SHALL COORDINATE WITH LANDSCAPE ARCHITECT PRIOR TO CONSTRUCTION TO ADJUST PROPOSED DESIGN OR UTILITIES AS NECESSARY TO RESOLVE CONFLICTS.
4. CONTRACTOR TO PROVIDE A SHOP DRAWING SUBMITTAL FOR THE DESIGN OF AN AUTOMATIC IRRIGATION SYSTEM TO MEET THE FOLLOWING CRITERIA:
 - A. ALL SHRUBS & TREES MATERIAL TO BE COVERED BY IRRIGATION.
 - B. TURFGRASS AREAS WITH TYPE #2 SEEDING TO BE COVERED BY IRRIGATION.
 - C. VALVES, HEADS AND ACCESSORIES TO BE BY RAINBIRD.
 - D. DRIP IRRIGATION SHALL USE INDIVIDUAL EMITTERS RATHER THAN IN-LINE EMITTER TUBING UNLESS SPECIFICALLY APPROVED.
 - E. AVOID TRENCHING AT TREE ROOTS.
 - F. EXISTING METER AND BACKFLOW PREVENTER ARE LOCATED AT THE CORNER OF GREENE & GADSDEN STREETS. CONTRACTOR TO VERIFY PRESSURE AND FLOW PRIOR TO DESIGNING IRRIGATION SYSTEM.
 - G. SYSTEM SHALL BE CONNECTED TO EXISTING RAINBIRD CONTROLLER AT SW CORNER OF PROJECT AREA.
 - H. COORDINATE PLACEMENT OF SLEEVES AT DRIVEWAYS AND SIDEWALKS WITH SITE CONTRACTOR.
5. SITE CONTRACTOR IS RESPONSIBLE FOR CLEARING ROCK/GRAVEL/DEBRIS FROM PLANTING AREAS.
6. LANDSCAPE CONTRACTOR SHALL PROVIDE & SPREAD 4\"/>
7. REFER TO PROJECT MANUAL FOR ADDITIONAL SPECIFICATIONS.

