

VICINITY MAP
NTS

APPROXIMATE LOCATION OF SITE:
LONGITUDE: 81° 17' 59"
LATITUDE: 33° 00' 42"

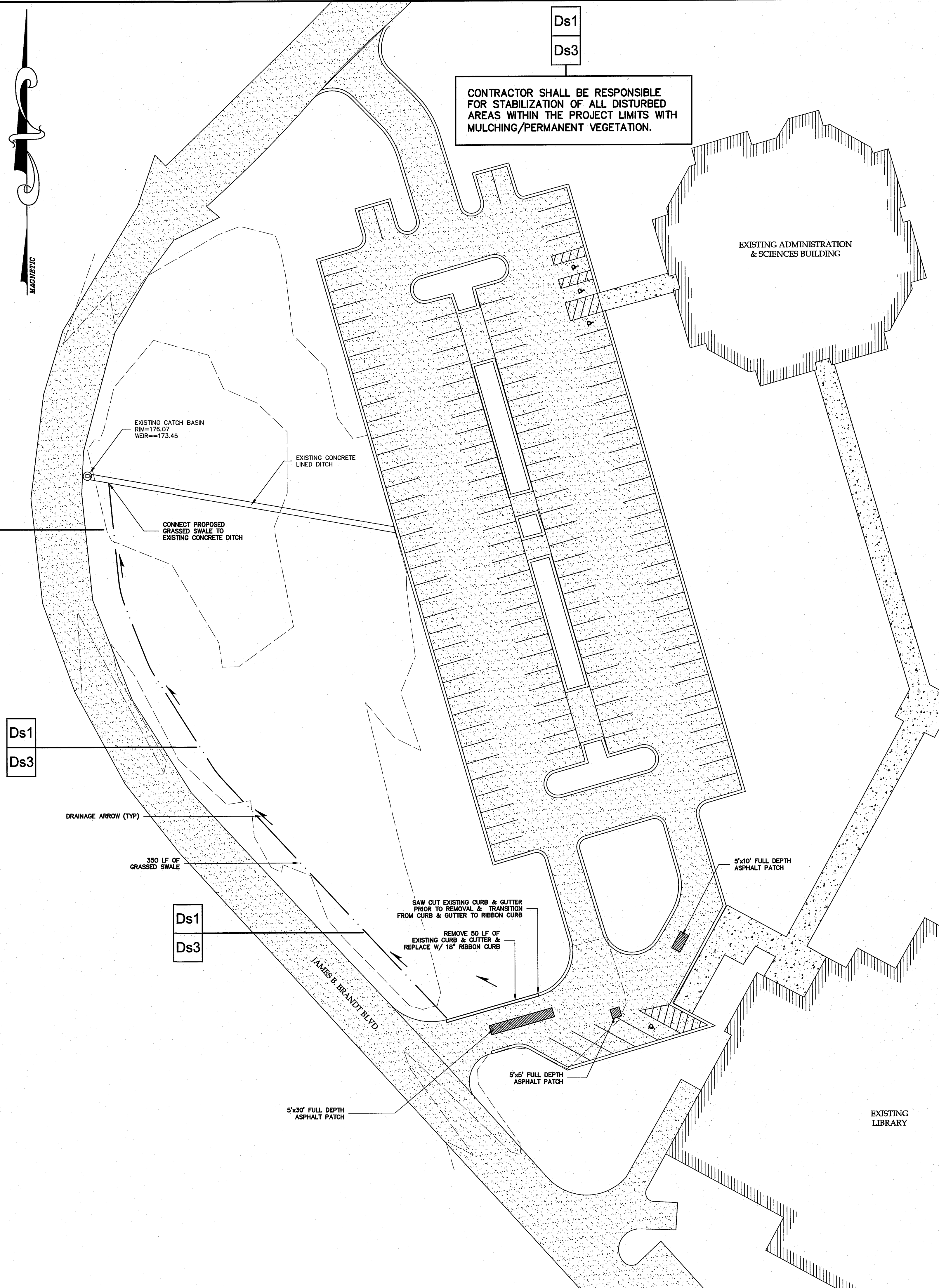

CONTRACTOR SHALL BE RESPONSIBLE FOR STABILIZATION OF ALL DISTURBED AREAS WITHIN THE PROJECT LIMITS WITH MULCHING/PERMANENT VEGETATION.

Ds1	DISTURBED AREA STABILIZATION W/MULCHING ONLY		Ds1	Establishing temporary protection for disturbed areas where seeding may not have a suitable growing season to produce an erosion retarding cover. See Carolina Engineering Consultants, Inc. Written Technical Specifications Section 02485 for further details.
Ds3	DISTURBED AREA STABILIZATION W/PERMANENT VEGETATION		Ds3	Establishing permanent vegetative cover such as trees, shrubs, vines, grasses, sod, or legumes on disturbed areas. See Carolina Engineering Consultants, Inc. Written Technical Specifications Section 02485 for further details.

Ds1 MULCHING NOTES

MULCHING:
USE MULCH ON ALL SLOPES STEEPER THAN 3% WHEN SEEDINGS ARE MADE SO LATE IN THE FALL AND WINTER THAT GERMINATION CANNOT BE EXPECTED UNTIL SPRING. IN THE BOTTOM OF SPILLWAYS, AND ON ROADBANKS, TEMPORARY VEGETATION SEEDED ALONE MAY BE ESTABLISHED ON GOOD SITES WITHOUT THE USE OF MULCH. MULCHING MATERIAL WILL CONSIST OF:

- USE DRY STRAW OR DRY HAY OF GOOD QUALITY AND FREE OF WEED SEEDS. DRY STRAW WILL BE APPLIED AT THE RATE OF 2 TONS PER ACRE. DRY HAY WILL BE USED AT A RATE OF 2.5 TONS PER ACRE; OR,
- FOR HYDRAULIC SEEDING, USE WOOD CELLULOSE MULCH OR WOOD PULP FIBER AT THE RATE OF 500 POUNDS PER ACRE AND DRY STRAW OR DRY HAY AT THE RATE LISTED IN "A" ABOVE; OR,
- FOR HYDRAULIC SEEDING ON SLOPES 3/4:1 OR STEEPER, 1,000 POUNDS OF WOOD CELLULOSE OR WOOD PULP FIBER WHICH INCLUDES A TACKIFIER MAY BE SUBSTITUTED FOR THE TREATMENT IN "B" ABOVE; OR,
- USE THREE TONS PER ACRE OF SERICEA LESPEDEZA HAY CONTAINING MATURE SEED; OR,
- APPLY PINE STRAW OR PINE BARK AT A THICKNESS OF 3 INCHES. OTHER SUITABLE MATERIALS IN SUFFICIENT QUANTITY MAY BE USED WHERE ORNAMENTALS OR OTHER GROUND COVERS ARE PLANTED; OR,
- SOIL RETENTION BLANKETS, EROSION CONTROL NETTING, OTHER MANUFACTURED MATERIALS, OR BLOCK SOD MAY BE REQUIRED IN ADDITION TO MULCH ON UNSTABLE SOILS AND CONCENTRATED FLOW AREAS. WOOD CELLULOSE AND WOOD PULP FIBERS SHALL NOT CONTAIN GERMINATION OR GROWTH INHIBITING FACTORS. THEY WILL HAVE THE PROPERTY TO BE EVENLY DISPERSED WHEN AGITATED IN WATER. THE FIBERS SHALL HAVE A CONTRASTING COLOR TO THE SOIL TO ALLOW VISUAL METERING AND AID IN UNIFORM APPLICATION DURING SEEDING.

APPLYING MULCH:
A. STRAW OR HAY MULCH WILL BE SPREAD UNIFORMLY WITHIN 24 HOURS AFTER SEEDING AND OR PLANTING. THE MULCH MAY BE SPREAD BY BLOWER TYPE SPREADING EQUIPMENT, OTHER SPREADING EQUIPMENT, OR BY HAND. ABOUT 75% OF THE SOIL SURFACE WILL BE COVERED.
B. WOOD CELLULOSE OR WOOD FIBER MULCH WILL BE APPLIED WITH HYDRAULIC SEEDING EQUIPMENT.

ANCHORING MULCH:
A. ANCHOR STRAW OR HAY MULCH IMMEDIATELY AFTER APPLICATION BY ONE OF THE FOLLOWING METHODS:
1. BY EMULSIFIED ASPHALT, (A) SPRAYED UNIFORMLY ONTO THE MULCH AS IT IS EJECTED FROM THE BLOWER MACHINE, OR (B) SPRAYED ON THE MULCH IMMEDIATELY FOLLOWING MULCH APPLICATION WHEN STRAW OR HAY IS SPREAD BY METHODS OTHER THAN SPECIAL BLOWER EQUIPMENT. THE COMBINATION OF ASPHALT EMULSION AND WATER SHALL CONSIST OF A HOMOGENEOUS MIXTURE SATISFACTORY FOR SPRAYING. THE MIXTURE SHALL CONSIST OF 100 GALLONS OF GRADE SS-1H OR CSS-1H EMULSIFIED ASPHALT AND 100 GALLONS OF WATER PER TON OF MULCH. CARE SHALL BE TAKEN AT ALL TIMES TO PROTECT THE PUBLIC, ADJACENT PROPERTY, PAVEMENTS, CURBS, SIDEWALKS, AND ALL OTHER STRUCTURES FROM ASPHALT DISCOLORATION.
2. PRESS THE MULCH INTO THE SOIL IMMEDIATELY AFTER THE MULCH IS SPREAD. A SPECIAL "PACKER DISK" OR DISK HARROW WITH THE DISKS SET STRAIGHT MAY BE USED. THE DISKS MAY BE SMOOTH OR SERRATED AND SHOULD BE 20 INCHES OR MORE IN DIAMETER AND 8 TO 12 INCHES APART. THE EDGES OF THE DISKS SHALL BE DULL ENOUGH TO PRESS THE MULCH INTO THE GROUND WITHOUT CUTTING IT, LEAVING MUCH OF IT IN AN ERECT POSITION.
3. APPLY SYNTHETIC TACKIFIERS OR BINDERS APPLIED IMMEDIATELY AFTER THE MULCH IS SPREAD. SYNTHETIC TACKIFIERS WILL BE MIXED AND APPLIED TO MANUFACTURER'S SPECIFICATIONS.
4. FALL AND WINTER PLANTINGS MAY INCLUDE 1/2 BUSHEL OF RYE OR WHEAT TO STABILIZE THE MULCH.
5. PLASTIC MESH OR NETTING WITH NO LARGER THAN ONE INCH BY ONE INCH MESH MAY BE NEEDED TO ANCHOR STRAW OR HAY MULCH ON UNSTABLE SOILS AND CONCENTRATED FLOW AREAS.
B. WHERE WOOD CELLULOSE OR WOOD PULP FIBER MULCH IS APPLIED ALONE, A TACKIFIER WILL BE USED.

LIME AND MAINTENANCE APPLICATION:
APPLY ONE TON OF AGRICULTURAL LIME EVERY 4 TO 6 YEARS.

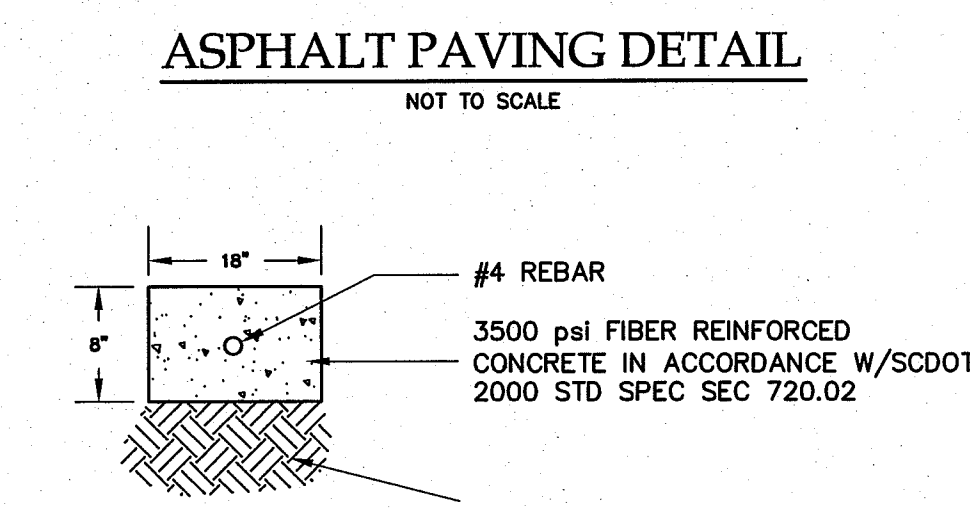
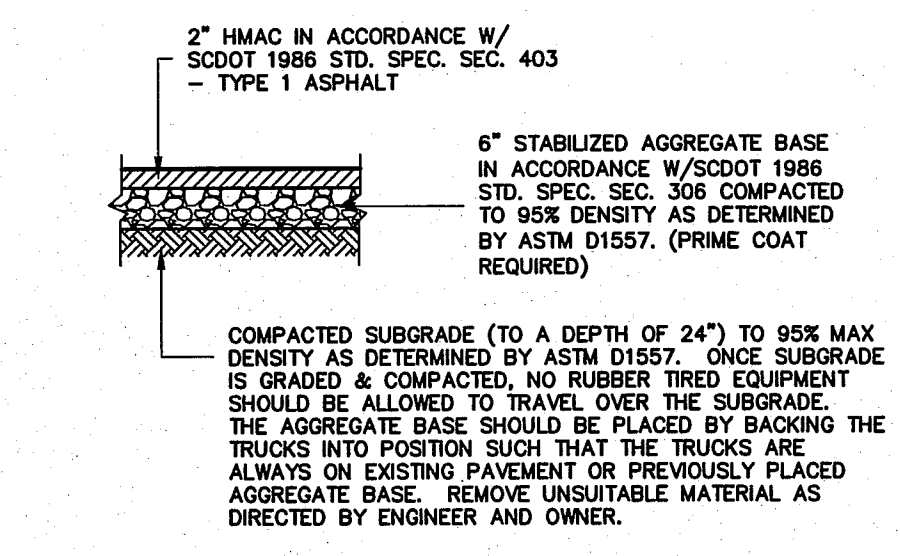
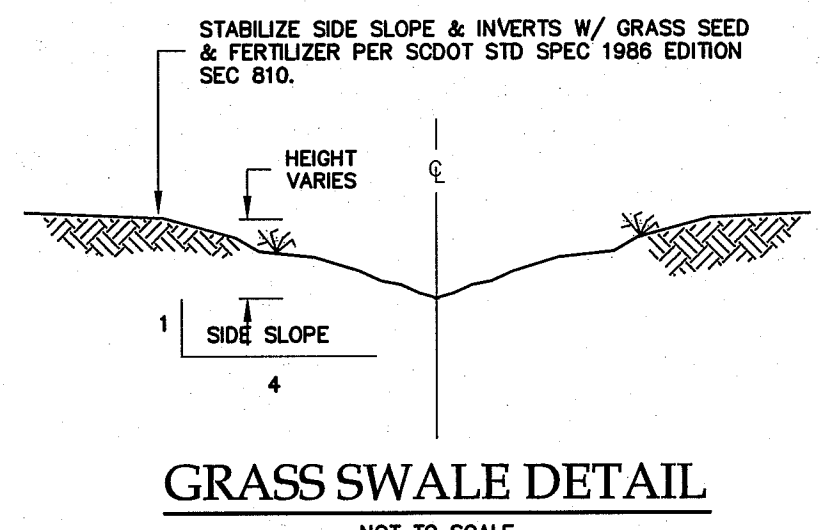

GENERAL NOTES:
PAVING, GRADING & DRAINAGE NOTES:
CAROLINA ENGINEERING CONSULTANTS, INC.'S WRITTEN CONSTRUCTION SPECIFICATIONS WILL BE FOLLOWED ON THIS JOB. IF CONTRACTOR NEEDS COPY OF THESE SPECIFICATIONS, PLEASE CONTACT CAROLINA ENGINEERING.
TOPOGRAPHY AND BASE INFORMATION RECREATED FROM CONSTRUCTION PLANS BY STEVENS & WILKINSON, INC. DATED 2-19-1990
BENCHMARKS ARE TO BE VERIFIED BY CONTRACTOR.
THE PARKING REPAIR PLAN IS BASED OFF OF CONSTRUCTION PLANS BY STEVENS & WILKINSON, INC. DATED 2-19-1990. CONTRACTOR SHALL VERIFY ALL EXISTING ELEVATIONS BEFORE STARTING WORK.
CONTRACTOR IS RESPONSIBLE FOR LOCATING ALL EXISTING UTILITIES.
WHERE NEW CONSTRUCTION IS NEAR THE EDGE OF AN EXISTING PAVED ROADWAY, A TRAFFIC LANE WILL BE TEMPORARILY CLOSED TO PROMOTE SAFETY TO THE PUBLIC AND TO THE WORKMEN. NO LANE CLOSURES DURING 7:00 AM TO 9:00 AM OR FROM 3:30 PM TO 6:00 PM ARE ALLOWED.
APPLICANT WILL REPAIR ALL DAMAGE DONE TO ROADSIDE AND RESEED WITH PERMANENT GRASS.
TRAFFIC CONTROLS FOR THIS INSTALLATION SHALL BE IN ACCORDANCE WITH S.C.M.U.T.C.D.
ALL PROPOSED SIGNAGE AND PAVEMENT MARKINGS SHOULD BE IN ACCORDANCE WITH THE 2003 EDITION OF THE MUTCD.

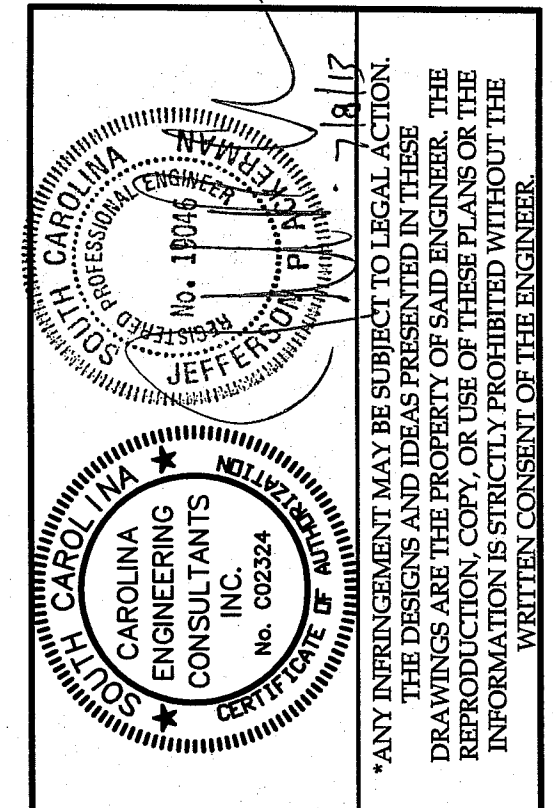
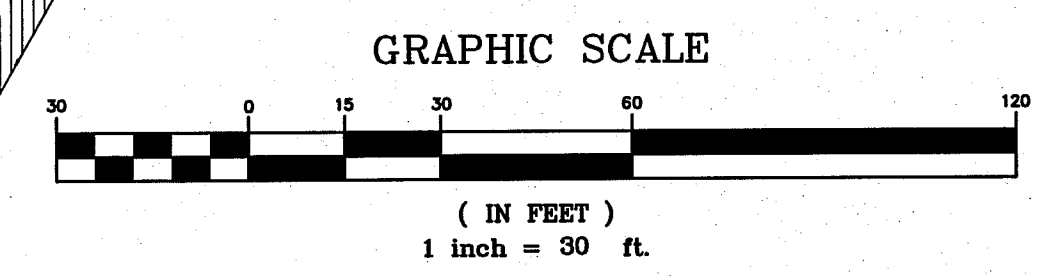

NO.	DESCRIPTION	DATE
1		
2		
3		
4		
5		
6		
7		
8		

USC SALKHEHATCHIE LIBRARY PARKING REPAIR ALLENDALE, SC

CAROLINA ENGINEERING CONSULTANTS, INC.
843/322-0553
843/322-0556 (FAX)
WWW.CAROLINAENGINEERING.COM
PO BOX 294
BEAUFORT, SC 29901

PROJECT:	1612
DATE:	04/19/13
REVISED:	07/8/13
DRAWN BY:	TAB
ENGINEER:	JPA
SCALE:	1"=30'

PARKING REPAIR PLAN

1
OF 1