

1 DOOR ELEVATIONS
3/4" = 1'-0"

DOOR SCHEDULE

MARK	DOOR				FRAME				FIRE RATING	HARDWARE SET	REMARKS	ELEVATION
	WD	HGT	THK	MATL	FINISH	MATL	HEAD	JAMB				
108A	3' - 0"	7' - 0"	1 3/4"	WD/GLASS	STN	HM	*	*	*	0		D2
108B	3' - 0"	7' - 0"	1 3/4"	WD/GLASS	STN	HM	*	*	*	0		D2
204B	3' - 0"	7' - 0"	1 3/4"	WD/GLASS	STN	HM	*	*	*	0		D2
204C	3' - 0"	7' - 0"	1 3/4"	WD/GLASS	STN	HM	*	*	*	0		D2
204D	3' - 0"	7' - 0"	1 3/4"	WD/GLASS	STN	HM	*	*	*	0		D2
206D	3' - 0"	7' - 0"	1 3/4"	WD	STN	HM	*	*	*	0		D1
208A	3' - 0"	7' - 0"	1 3/4"	WD/GLASS	STN	HM	*	*	*	0		D1
208B	3' - 0"	7' - 0"	1 3/4"	WD/GLASS	STN	HM	*	*	*	0		D1
421A	5' - 0"	7' - 0"	1 1/2"	WD	STN	HM	*	*	*	0	SEE ELEVATION	D3
422	3' - 0"	7' - 0"	1 3/4"	WD	STN	HM	*	*	*	0		D1
422A	3' - 0 1/4"	7' - 0"	1 3/4"	WD	STN	HM	*	*	*	0		D1
422B	3' - 0 1/4"	7' - 0"	1 3/4"	WD	STN	HM	*	*	*	0		D1
422C	3' - 0"	7' - 0"	1 3/4"	WD/GLASS	STN	HM	*	*	*	0	FRAME F-1	D2
423	3' - 0"	7' - 0"	1 3/4"	WD	STN	HM	*	*	*	0		D1
425	3' - 0"	7' - 0"	1 3/4"	WD	STN	HM	*	*	*	0		D1

* REFER TO FRAME ELEVATIONS ON A1.01 & A1.02

DOOR SCHEDULE NOTES:
1. PROVIDE GUIDES & TRACK WITH 400 LB LIMIT MIN. PROVIDE AN ADA COMPLIANT RECESSED STAINLESS PULL

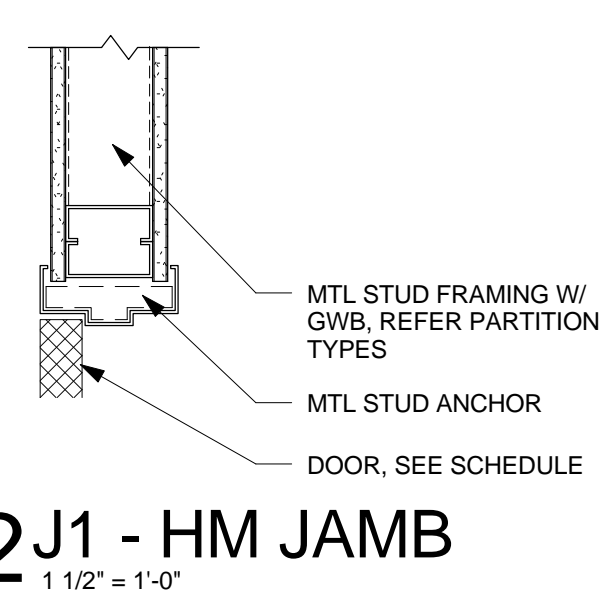

2J1 - HM JAMB
1 1/2" = 1'-0"

ROOM FINISH SCHEDULE

Number	Name	ROOM FINISH SCHEDULE				Comments
		Base Finish	Floor Finish	Wall Finish	Ceiling Finish	
107	CLASSROOM	NA	NA	NA	NA	NOTE#3
108	OFFICE	RB-1	CPT-1	PNT-1/PNT-4	ACT-1	
108A	OFFICE	RB-1	CPT-3	PNT-1/PNT-2	ACT-1	
108B	OFFICE	RB-1	CPT-3	PNT-1/PNT-2	ACT-1	
109	STORAGE	NA	NA	NA	NA	NOTE#3
204	OFFICE	RB-1	CPT-1	PNT-1/PNT-4	ACT-1	
204A	EQUIP	NA	NA	NA	NA	NOTE#3
204B	OFFICE	RB-1	CPT-3	PNT-1/PNT-2	ACT-1	
204C	OFFICE	RB-1	CPT-3	PNT-1/PNT-2	ACT-1	
204D	OFFICE	RB-1	CPT-3	PNT-1/PNT-2	ACT-1	
205	RECYCLE	NA	NA	NA	ACT-1	
206	OFFICE	RB-1	CPT-1	PNT-1/PNT-4	ACT-1	
206A	ELEC	NA	NA	NA	NA	NOTE#3
206B	OFFICE	NA	NA	NA	NA	NOTE#3
206C	OFFICE	NA	NA	NA	NA	NOTE#3
206D	OFFICE	RB-1	CPT-3	PNT-1/PNT-2	ACT-1	
207	WORKROOM	RB-1	RUB-1	PNT-1/PNT-2	ACT-1	
208	GRAPHICS	RB-1	RUB-1	PNT-1/PNT-4	ACT-1	
208A	OFFICE	RB-1	CPT-3	PNT-1/PNT-2	ACT-1	
208B	OFFICE	RB-1	CPT-3	PNT-1/PNT-2	ACT-1	
421	CONF. RM	RB-1	CPT-2	PNT-1/PNT-4	ACT-1/PNT-3	
422	REC.	RB-1	CPT-2	PNT-1	ACT-1/PNT-3	
422A	OFFICE	RB-1	CPT-2	PNT-1	ACT-1/PNT-3	
422B	OFFICE	RB-1	CPT-2	PNT-1	ACT-1/PNT-3	
422C	BUS. MGR.	RB-1	CPT-2	PNT-1/PNT-2	ACT-1	
423	MEN	TILE 1	NA	PNT-1/CT-1/CT-2/CT-3	PNT-3	NOTE#4
424	JAN	NA	NA	NA	NA	NOTE#3
425	WOMEN	TILE 1	NA	PNT-1/CT-1/CT-2/CT-3	PNT-3	NOTE#4
EV01	ELEV	NA	NA	NA	NA	NOTE#3
EV02	ELEV	NA	NA	NA	NA	NOTE#3
H105	CORRIDOR	NA	NA	NA	ACT-1/PNT	NOTE#1
H203	CORRIDOR	NA	NA	NA	ACT-1/PNT	NOTE#1
H401	LOBBY	RES-1	RES-1	PNT-1	ACT-1/PNT-3	NOTE#1,2
V202	VESTIBULE	NA	NA	NA	ACT-1	NOTE#1
V401	VESTIBULE	RES-1	RES-1	PNT-1	PNT-3	

GENERAL FINISH NOTES:

- REFER TO FLOOR PLANS ON A1.01 & A1.02 FOR PAINT ACCENT COLOR LOCATIONS
- REFER TO SPECIFICATIONS FOR PRODUCT INFORMATION
- NO WORK IN THIS AREA UNLESS NOTED OTHERWISE OR IF WORK IS REQUIRED IN THE AREA AS PART OF MEPFP RELATED SCOPE
- EXISTING FLOOR TILE IS DISCONTINUED. IF ADDITIONAL FLOOR TILE IS REQUIRED FOR REPAIR, CONSIDER REUSING SALVAGED TILE FROM DEMOLITION OF THIS AREA. WALL TILE SHALL MEET HEIGHT, DESIGN & COLOR OF ADJACENT WALLS.

FINISH SCHEDULE NOTES:

- REFER TO MEPFP DRAWINGS FOR WORK IN THIS ROOM. CONTRACTOR SHALL REPAIR AND REFINISH WALLS, CEILINGS, FLOORS, ETC. TO THE ORIGINAL CONDITION AND FINISH AS REQUIRED.
- PAINT ENTIRELY ALL NEW WALLS AND ANY WALLS THAT ARE MODIFIED DURING CONSTRUCTION.
- NO WORK IN THIS AREA UNLESS NOTED OTHERWISE OR IF WORK IS REQUIRED IN THE AREA AS PART OF MEPFP RELATED SCOPE
- EXISTING FLOOR TILE IS DISCONTINUED. IF ADDITIONAL FLOOR TILE IS REQUIRED FOR REPAIR, CONSIDER REUSING SALVAGED TILE FROM DEMOLITION OF THIS AREA. WALL TILE SHALL MEET HEIGHT, DESIGN & COLOR OF ADJACENT WALLS.

FINISH SCHEDULE LEGEND

Item	Manufacturer	Style Number	Description	Color	Notes
CPT-1	Shaw Contract	59366	Jekyll II Tile, 24" x 24", EcoWorx tile backing with lifetime warranty, monolithic install with LokDots	To be selected from standard colors	
CPT-2	Shaw Contract	5A178	Core broadloom (12') with Ultraloc Pattern backing	To be selected from standard colors	
CPT-3	Shaw Contract	50462	Venture Capital broadloom (12') with ClassicBac.	To be selected from standard colors	
RUB-1	Johnsonite	RT-rd	24" x 24" Round Raised Disk Pattern Rubber Tile, 0.125" thick	To be selected from all solid colors available	
PNT-1	Sherwin Williams		Wall Paint	TBD	Typical Wall Color unless noted otherwise
PNT-2, 4	Sherwin Williams		Wall Paint	TBD	
PNT-3	Sherwin Williams		Ceiling Paint	TBD	
PNT-5	Sherwin Williams		Hollow Metal Frames - Semi-Gloss	TBD	
Doors	Marshfield Door	Enviroclad	Select White maple, plain sliced, grade "AA" facess,	Factory semigloss finish; stain color to match existing	matching wood window lite mouldings; fully welded 16 ga. HM frames
RB-1	Johnsonite	Rubber Base	4" x 1/8" Rubber Cove Base	Match existing	
PLAM-1	Fornica, Wilsonart, Nevamar		Plastic Laminate; provide PVC edge banding, 3 mm thick, matching laminate in color, pattern and finish	To be selected from manufacturer's full range of solid colors and patterns, in gloss or matte finish	For built in millwork, Verticle surfaces (door and drawer fronts)
PLAM-2	Fornica, Wilsonart, Nevamar		Plastic Laminate; provide PVC edge banding, 3 mm thick, matching laminate in color, pattern and finish	To be selected from manufacturer's full range of solid colors and patterns, in gloss or matte finish	For built in millwork, Horizontal surfaces (counter tops)
PLAM-3	Fornica, Wilsonart, Nevamar		Plastic Laminate; provide PVC edge banding, 3 mm thick, matching laminate in color, pattern and finish	To be selected from manufacturer's full range of solid colors and patterns, in gloss or matte finish	For built in millwork, Verticle surfaces (door and drawer fronts)
ACT-1	Armstrong		24" x 24" x 3/4", Mineral Based Acoustical Panel with reveal edge	White	
CG-1	Arden		48" high, surface mount vinyl acrylic corner guard, 2" legs, and continuous retainer; top and bottom HDPE color matching end caps	Match Existing	
RES-1	Tnemec Co		Epoxy Resin Flooring	Color, texture and gloss to match existing	Integral cove base
GRAN-1			3 cm. granite, eased edges; provide 4" high matching side and back splashes	Blue Pearl Granite from Norway	No seams allowed
CT-1, 2, 3	Da-Tile	Natural Hues	6" x 6" glazed quarry tile, cushion-edged	CT-1: Almond - QH02; CT-2: Midnight Blue - QH57; CT-3: Pine - QH64	Provide matching trim units as req'd to maintain existing pattern
Roller Shade	MechoShade Systems	Mecho/5 DoubleShade Bracket #15 with Lift-Assist Mechanism	Manual operating interior, chain drive "double" solar and room darkening blackout roller shades, operating independently of each other, and related mounting systems and accessories.		Provide optional removable closure mount
Horizontal Louver Blinds	Levelor Contract		Riviera Classic 1" wide slats, 0.008 inch thick	Match Existing	



PUBLIC HEALTH RESEARCH CENTER - RELOCATION RENOVATIONS

USC PROJECT # H27-1988

TAG	DESCRIPTION	DATE

Project: 11USC396
Drawn By: BKM
Checked By: BDB
Date: 08 March 2012
Jenkins • Peer Architects © copyright 2012

FINISH SCHEDULE & DOOR SCHEDULE

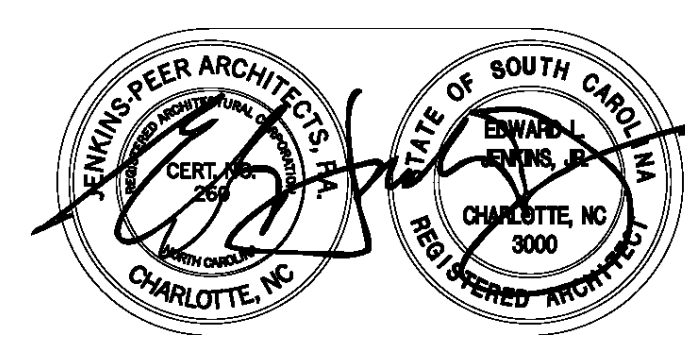

ISSUED FOR CONSTRUCTION

A9.01